

PROJECT REFERENCE NO. R-3100B	SHEET NO. 5
RW SHEET NO.	
ROADWAY DESIGN ENGINEER NOT CERTIFIED AS TO THE ORIGINAL DOCUMENT BUT ONLY AS TO THE REVISIONS	HYDRAULICS ENGINEER NOT CERTIFIED AS TO THE ORIGINAL DOCUMENT BUT ONLY AS TO THE REVISIONS
THIS DOCUMENT ORIGINALLY ISSUED AND SEALED BY: EDWARD GLENN EDWARDS, JR., PE 018470 ON APRIL 26, 2017	THIS DOCUMENT ORIGINALLY ISSUED AND SEALED BY: MEME D. BUSCEMI PE 037863 ON APRIL 27, 2017
THIS DOCUMENT ONLY CERTIFIED AS TO THE REVISIONS	THIS DOCUMENT ONLY CERTIFIED AS TO THE REVISIONS
DOCUMENT NOT CONSIDERED FINAL UNLESS ALL SIGNATURES COMPLETED	

-L-
 $PI\ Sta\ 22+04.68$
 $\Delta = 32' 22" (2.2' LT)$
 $D = 2' 4" (0.1')$
 $L = 1206.20'$
 $T = 619.67'$
 $R = 2135.00'$
 $e = 3\%$
 $Runoff = 108'$

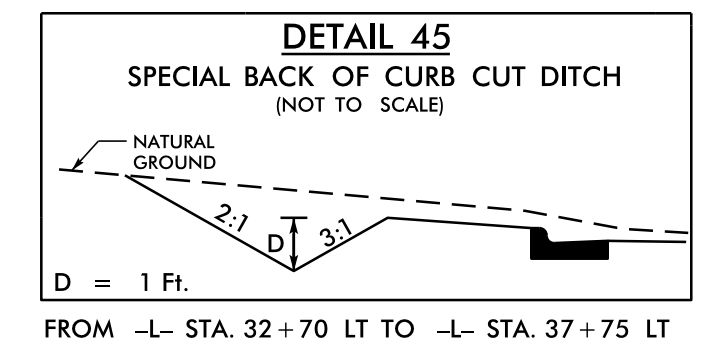
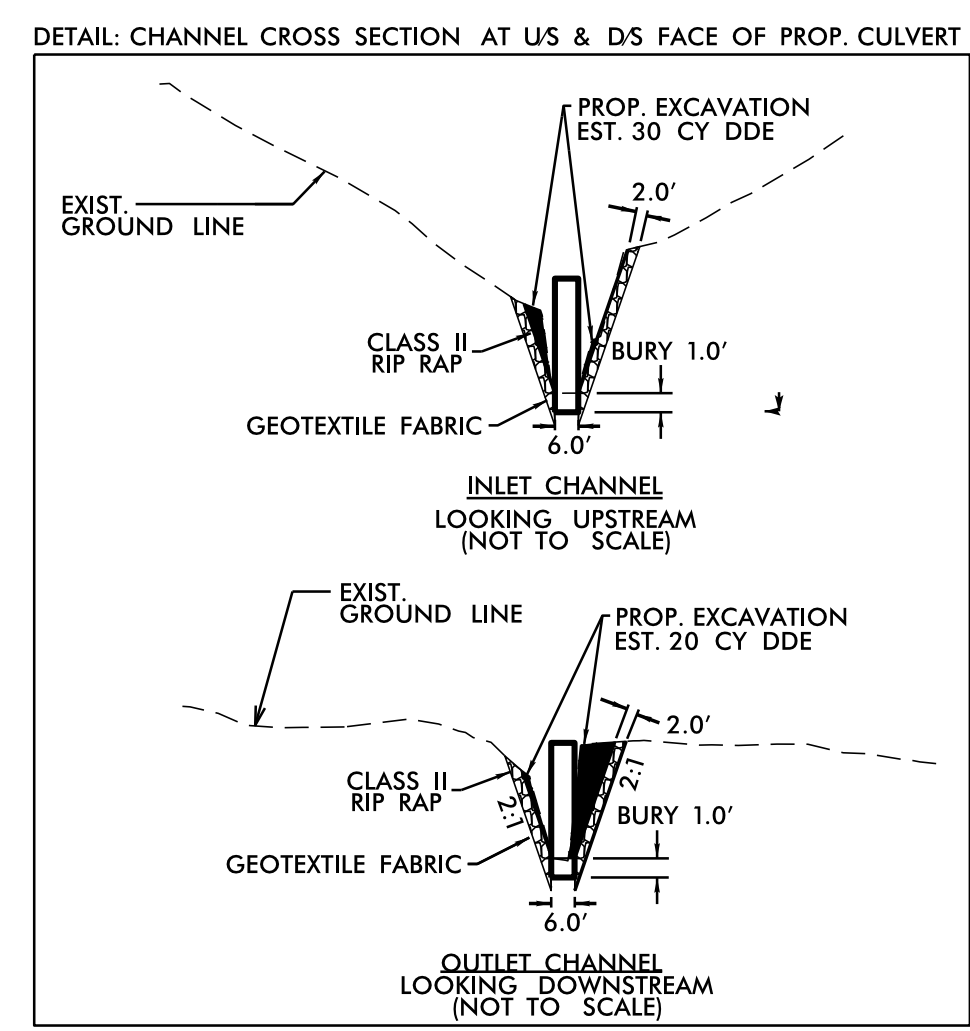

MAP 8 / NSRS 2007

REVISIONS
 FROM REV. ON LET PROJECT - APRIL 27 2017 - REVISED PUE ALONG PARCEL 2 (EGE)
 FROM REV. ON LET PROJECT - FEBRUARY 18 2019 - MOVED ACCESS POINT ON PARCEL FROM STA. 34+48 TO STA. 32+05 (+/- EGE)
 FROM REV. ON LET PROJECT - SEPTEMBER 11 2020 - INCREASED THE ACCESS POINT AT -L- STATION 25+45 FROM 60 TO 80 ON PARCEL 2 (TLW)

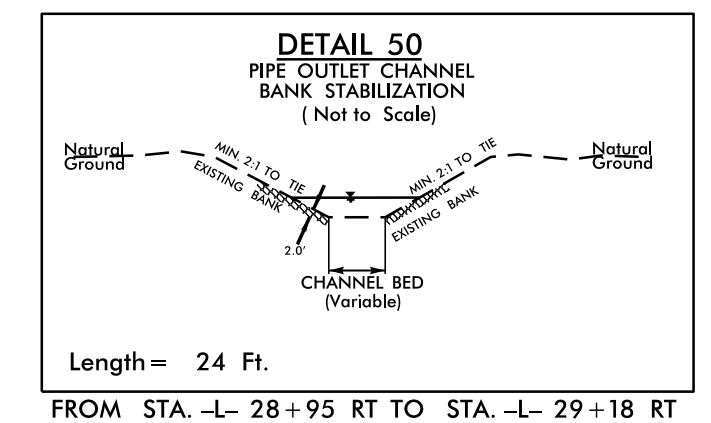
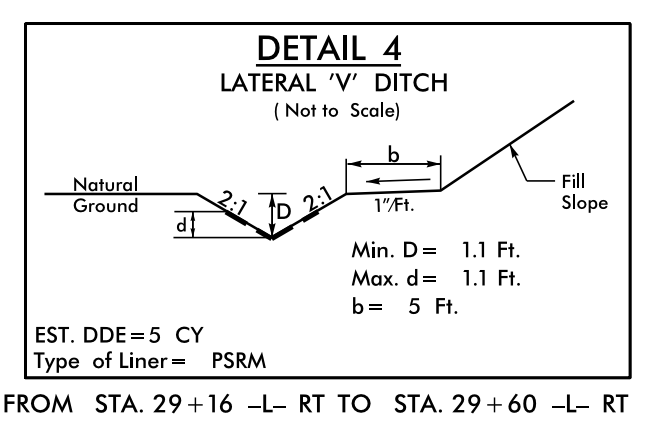
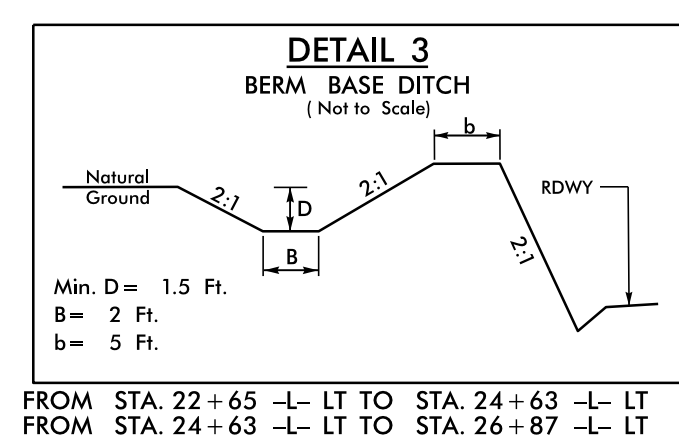
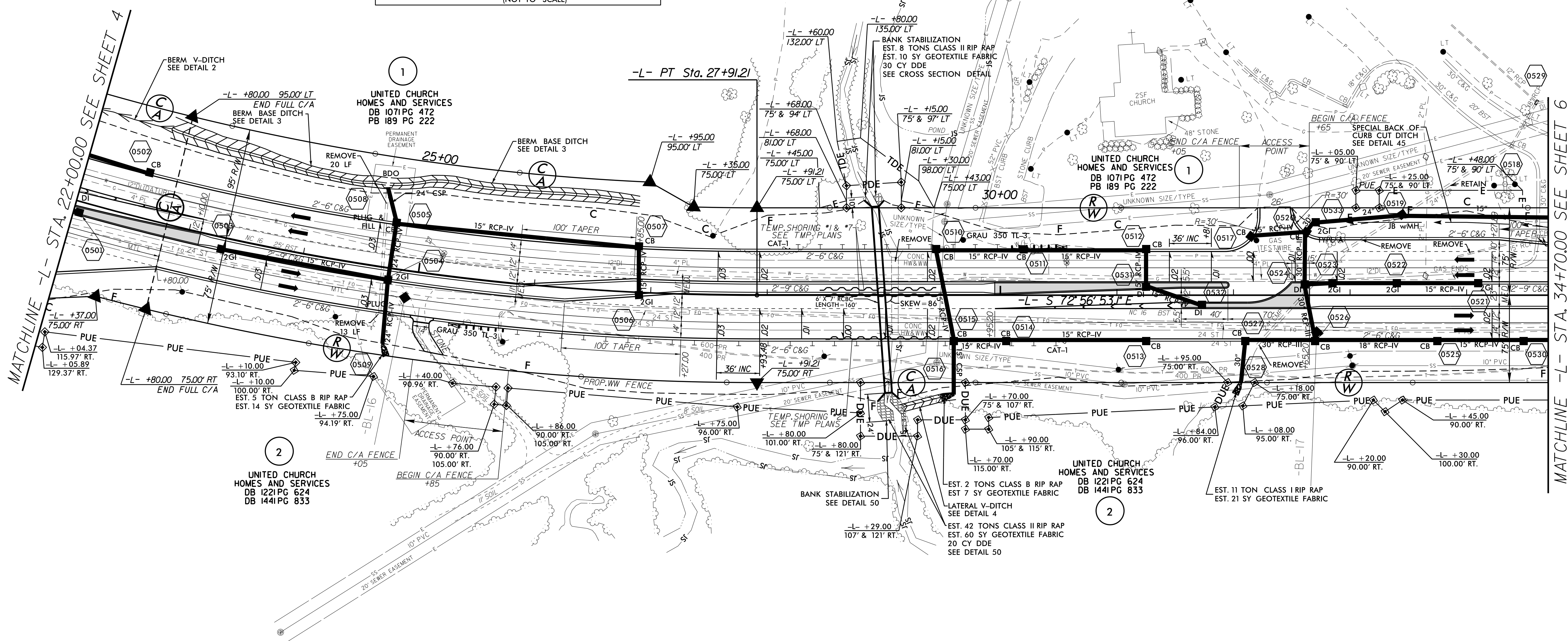

FOR -L- PROFILE SEE SHEET 18
 FOR CONC. MONO. ISLAND DETAIL SEE SHEET 2B-1