

See Sheet 1-A For Index of Sheets
See Sheet 1-B For Conventional Symbols

STATE OF NORTH CAROLINA
DIVISION OF HIGHWAYS

CATAWBA COUNTY

**LOCATION: NC 16 FROM NORTH OF SR 1801 (CLAREMONT RD)
TO NORTH OF SR 1814 (CALDWELL RD)**

**TYPE OF WORK: GRADING, DRAINAGE, RETAINING WALL,
CULVERTS, PAVING & SIGNALS**

STATE	STATE PROJECT REFERENCE NO.	SHEET NO.	TOTAL SHEETS
N.C.	R-3100B	1	
STATE PROJ. NO.	F.A. PROJ. NO.	DESCRIPTION	
34522.1.4	STP-0016(53)	PE	
34522.2.FR4	STP-0016(53)	ROW	
34522.2.FRU4	STP-0016(53)	UTIL.	
34522.3.5	STP-0016(52)	CONST.	

PART 2 OF 2

TIP PROJECT: R-3100B

CONTRACT: C203800

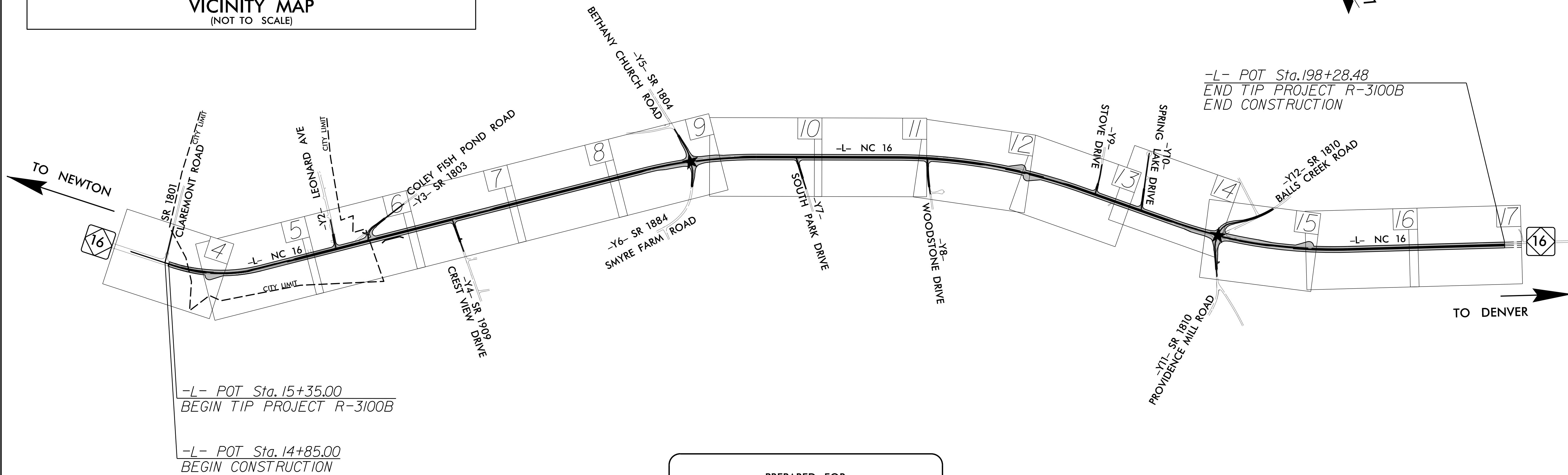
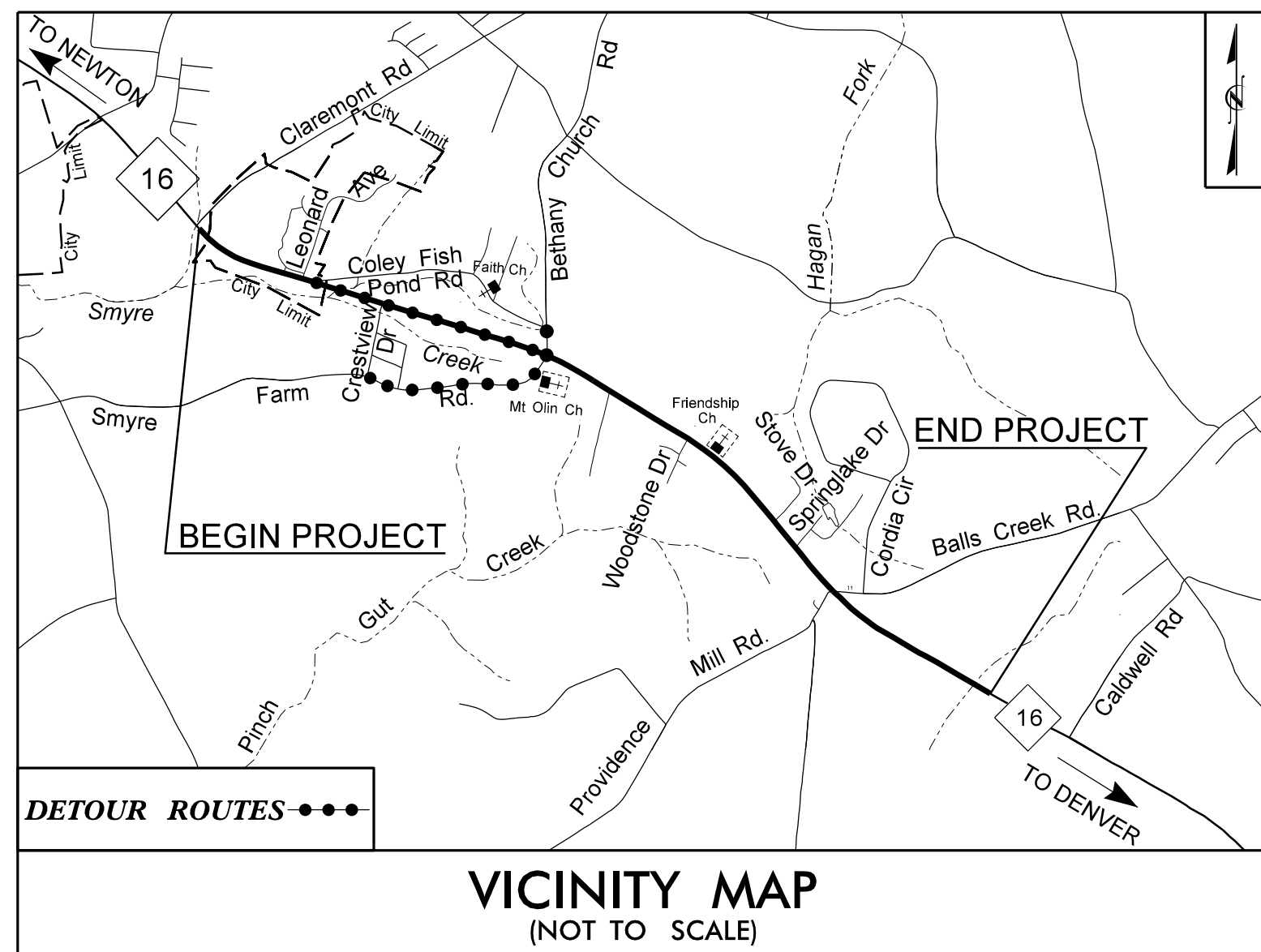

-L- POT Sta. 198+28.48
END TIP PROJECT R-3100B
END CONSTRUCTION

PREPARED FOR
DEPARTMENT OF TRANSPORTATION
RALEIGH, NC

NCDOT CONTACT: GARY LOVERING, PE

★ PROPOSED SIGNAL

**DOCUMENT NOT CONSIDERED FINAL
UNLESS ALL SIGNATURES COMPLETED**

THIS PROJECT IS PARTIAL CONTROL-ACCESS, WITH ACCESS BEING LIMITED TO POINTS AS SHOWN ON PLANS.

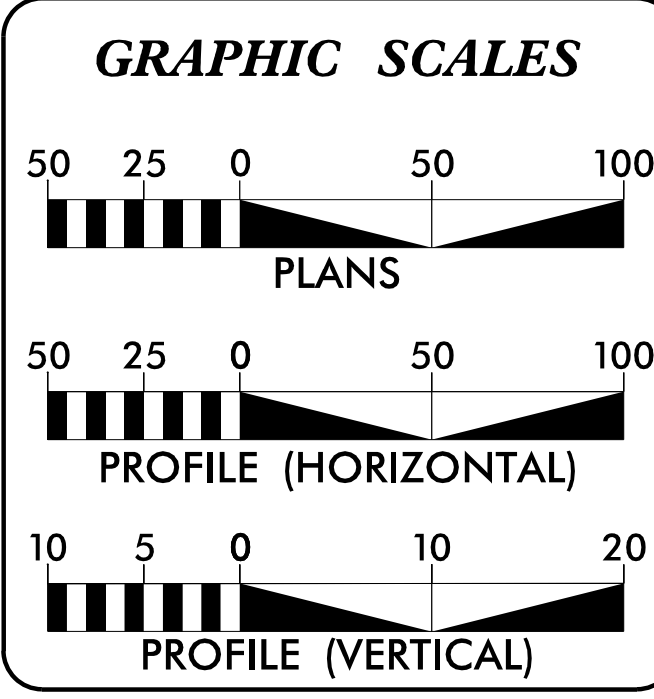

DESIGN DATA

ADT 2017	=	13,408
ADT 2037	=	20,558
K	=	10 %
D	=	65 %
T	=	9 % *
V	=	50 MPH
*(TTST 4% + DUAL 5%)		
FUNC CL	=	RURAL ARTERIAL
REGIONAL TIER		

PROJECT LENGTH

LENGTH ROADWAY TIP PROJECT R-3100B	=	3.465 Miles
TOTAL LENGTH TIP PROJECT R-3100B	=	3.465 Miles

Prepared in the Office of:
URS
URS Corporation - North Carolina
1600 Perimeter Park Drive
Morrisville, North Carolina 27560
TELEPHONE (919) 461-1100 FAX (919) 461-1415
NC LICENSE # C-2243

2012 STANDARD SPECIFICATIONS

RIGHT OF WAY DATE:
JANUARY 30, 2015

LETTING DATE:
APRIL 18, 2017

EDWARD G. EDENS, PE
PROJECT ENGINEER

KEVIN J. VAN METRE, PE
PROJECT DESIGN ENGINEER

HYDRAULICS ENGINEER

DocuSigned by:
Memo Buscemi
SEAL 037863
P.E. 3/16/2017

ROADWAY DESIGN ENGINEER

DocuSigned by:
Edward G. Edens, Jr.
SEAL 18470
P.E. 3/16/2017

