

TIP PROJECT: B-5333

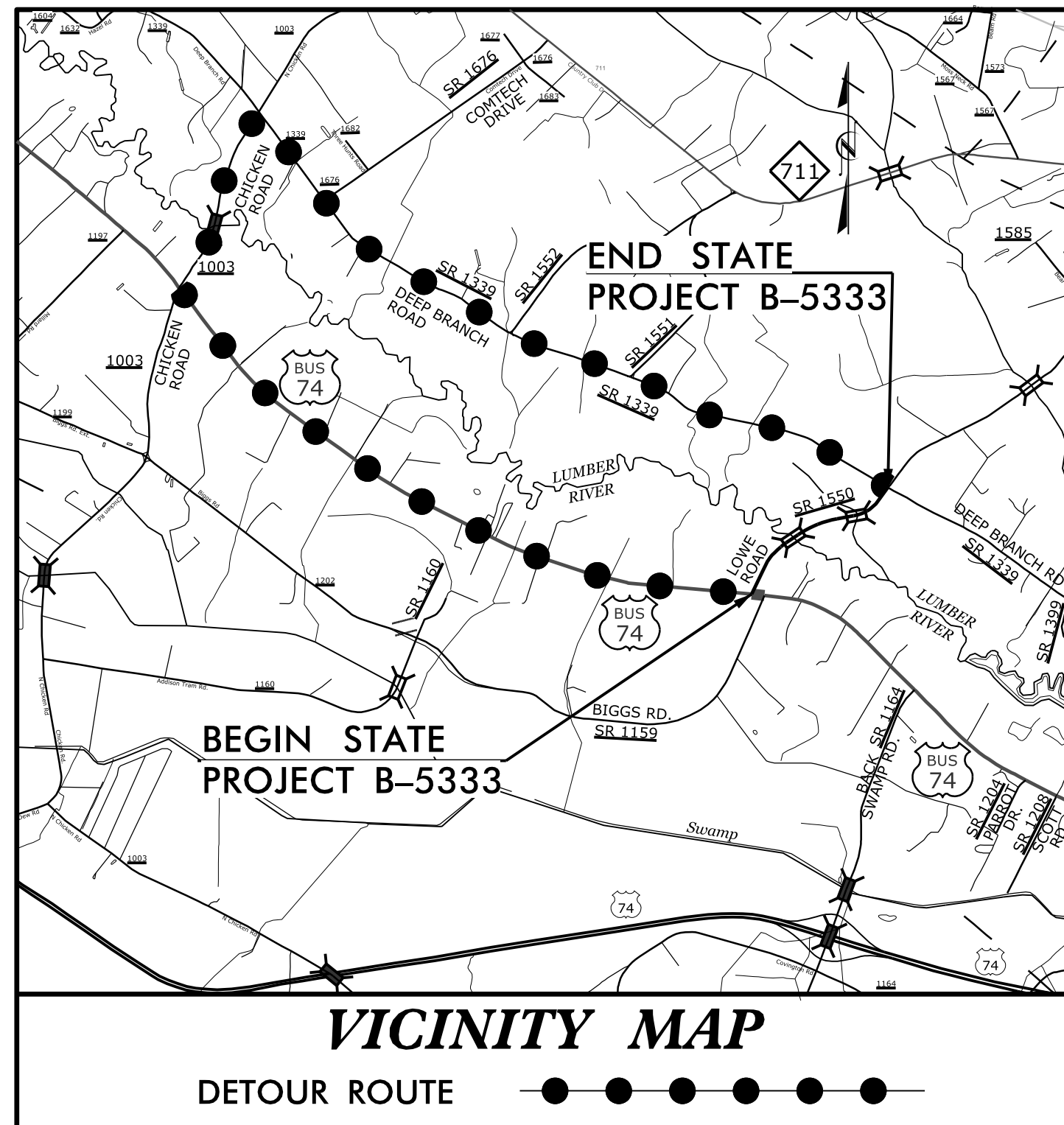

STATE OF NORTH CAROLINA
DIVISION OF HIGHWAYS

ROBESON COUNTY

**LOCATION: BRIDGE NO. 173 OVER LUMBER RIVER AND
BRIDGE NO. 174 OVER OVERFLOW ON SR 1550 (LOWE ROAD)**

**TYPE OF WORK: GRADING, PAVING, RESURFACING, DRAINAGE,
AND STRUCTURES**

STATE	STATE PROJECT REFERENCE NO.	SHEET NO.	TOTAL SHEETS
N.C.	B-5333	1	
STATE PROJ. NO.	F.A. PROJ. NO.	DESCRIPTION	
46047.1.1	BRZ-1550(2)	P.E.	

STRUCTURE

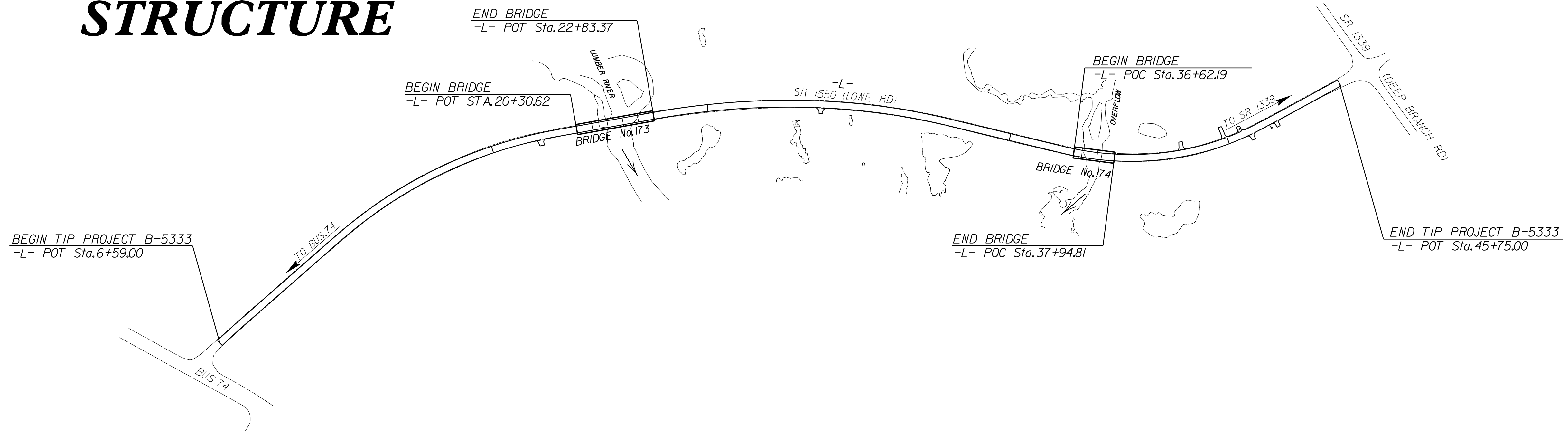

CONTRACT:

DESIGN DATA

ADT 2017 =	1,700
ADT 2037 =	2,300
K =	9 %
D =	60 %
T =	6 % *
V =	60 MPH
* TTST =	1% DUAL 5%
FUNC CLASS =	MINOR COLLECTOR
	SUB REGIONAL TIER

PROJECT LENGTH

LENGTH ROADWAY TIP PROJECT B-5333 =	0.669 MILES
LENGTH STRUCTURE TIP PROJECT B-5333 =	0.073 MILES
TOTAL LENGTH TIP PROJECT B-5333 =	0.742 MILES

NCDOT CONTACT: REKHA PATEL, P.E.
NCDOT TPMU

PLANS PREPARED FOR NCDOT BY:

Dewberry
2601 WYCLIFF ROAD
SUITE 410
RALEIGH, NC 27607
PHONE: 919.881.9939
NC COA No. F-0929

2012 STANDARD SPECIFICATIONS

RIGHT OF WAY DATE: MARCH 18, 2016
PROJECT ENGINEER: LLOYD M. PEARSON, P.E.

LETTING DATE: MARCH 21, 2017
PROJECT DESIGN ENGINEER: JENNIFER R. McROY, P.E.

BRIDGE ENGINEER

DocuSigned by:
Jennifer R. McRoy 6/6/2016
E1114C791288475
SIGNATURE: _____ P.E.

SEAL
032076
NORTH CAROLINA PROFESSIONAL ENGINEER
JENNIFER R. McROY

