

STATE OF NORTH CAROLINA  
DIVISION OF HIGHWAYS

**UTILITY CONSTRUCTION PLANS  
ROBESON COUNTY**

**LOCATION: BRIDGE NO. 173 OVER LUMBER RIVER AND  
BRIDGE NO. 174 OVER OVERFLOW ON SR 1551 (LOWE ROAD)**  
**TYPE OF WORK: UTILITY RELOCATION OF WATER MAIN**

**TIP PROJECT: B-5333**

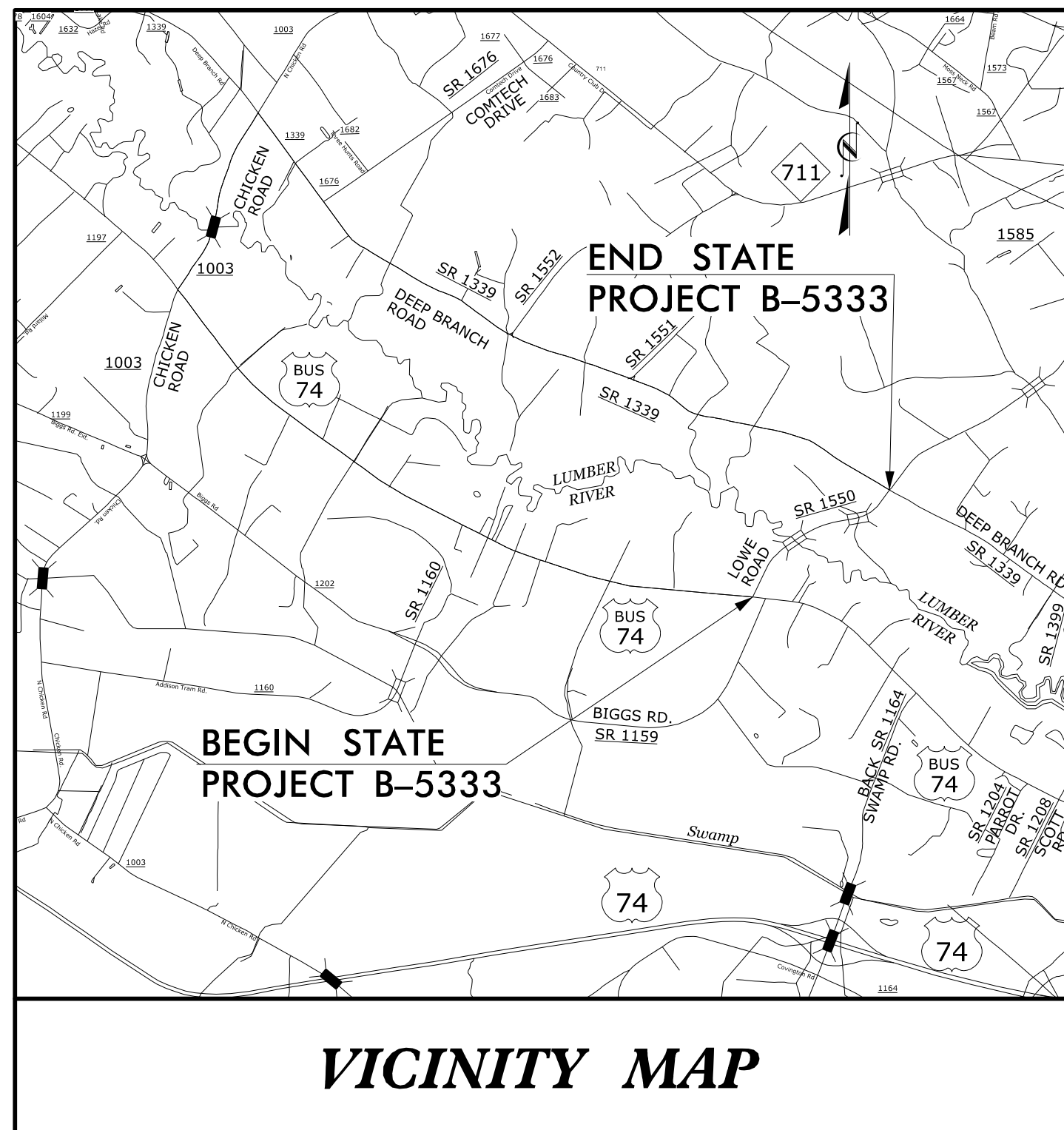

**VICINITY MAP**

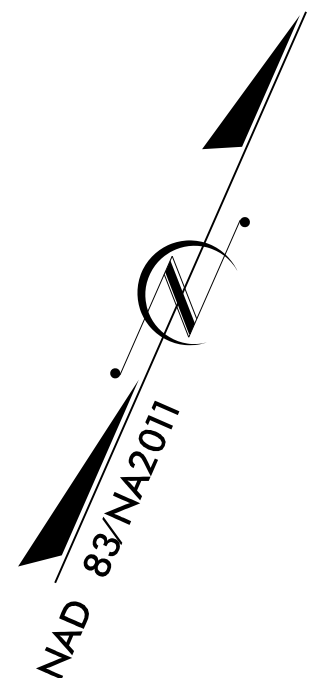
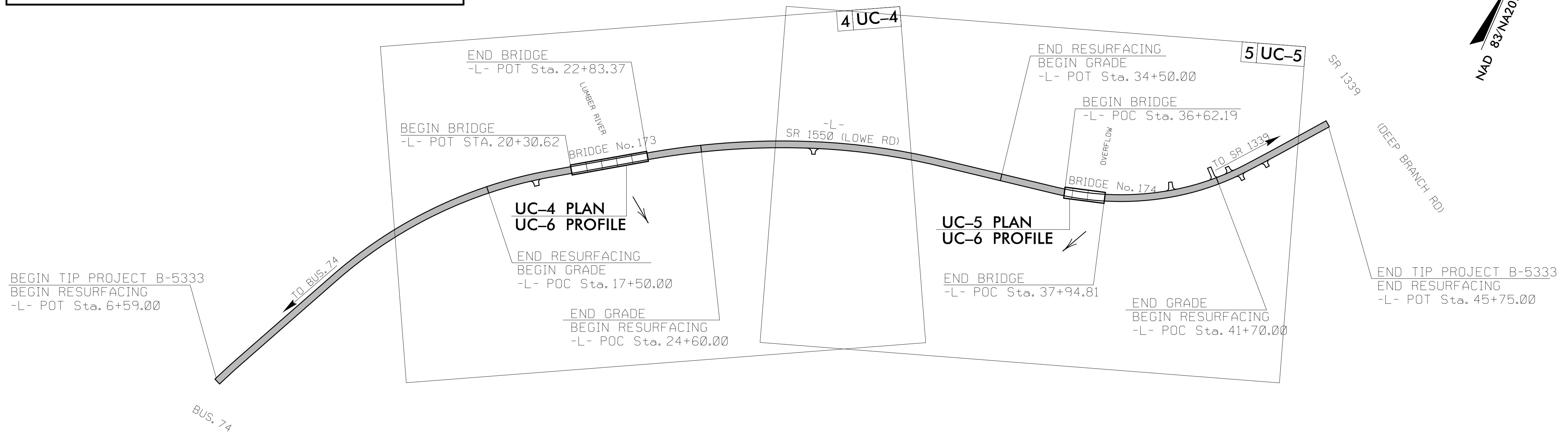

THIS PROJECT IS NOT WITHIN ANY MUNICIPAL BOUNDARIES.  
CLEARING ON THIS PROJECT SHALL BE PERFORMED TO  
THE LIMITS ESTABLISHED BY METHOD II.

DOCUMENT NOT CONSIDERED FINAL  
UNTIL ALL SIGNATURES ARE COMPLETED

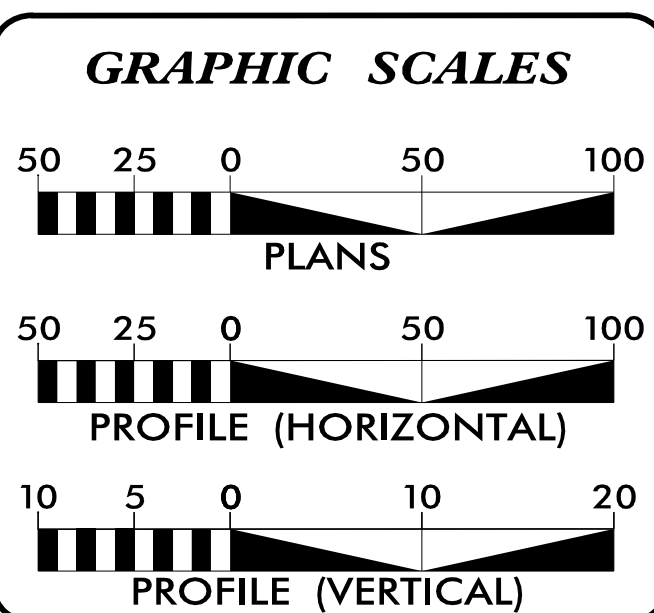

**INDEX OF SHEETS**

SHEET NO.:	DESCRIPTION:
UC-1	TITLE SHEET
UC-2	UTILITY SYMBOLOGY
UC-3	NOTES
UC-3A	DETAILS
UC-4 THRU UC-5	UTILITY PLAN SHEETS
UC-6	UTILITY PROFILE SHEETS

**WATER AND SEWER OWNERS ON PROJECT**

(A) WATER - ROBESON COUNTY

PREPARED IN THE OFFICE OF

**THE WOOTEN COMPANY**  
120 North Boylan Avenue, Raleigh, NC 27603-1423  
919-828-0531 Fax 919-834-3589  
License Number: F-9115

James R. Gregg, P.E. PROJECT ENGINEER  
\_\_\_\_ CONSULTANT CONTACT #2  
\_\_\_\_ CONSULTANT CONTACT #3

SEAL

**DIVISION OF HIGHWAYS UTILITIES UNIT**  
1555 MAIL SERVICES CENTER  
RALEIGH, NC 27699-1555  
PHONE (919) 707-6690  
FAX (919) 250-4151

BO HEMPHILL, P.E. UTILITIES REGIONAL ENGINEER  
KELVIN MARTIN UTILITIES ENGINEER  
ED REAMS UTILITIES AREA COORDINATOR  
LARRY JAMES UTILITIES COORDINATOR

09.08/99  
\$\$\$\$\$ SYSTEMS \$\$\$  
\$\$\$\$\$ USE PRINTING \$\$\$