

SIDE VIEW
NORTH FACE

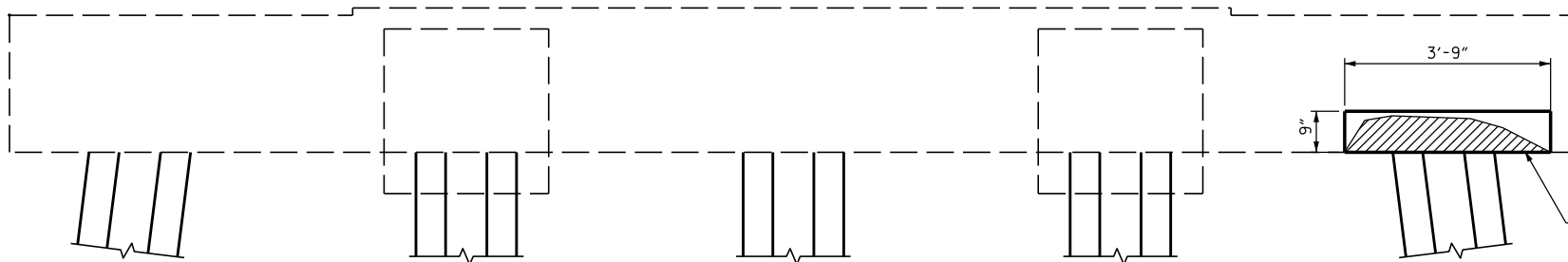

ELEVATION
WEST FACE

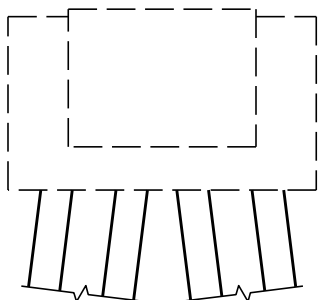

SIDE VIEW
SOUTH FACE

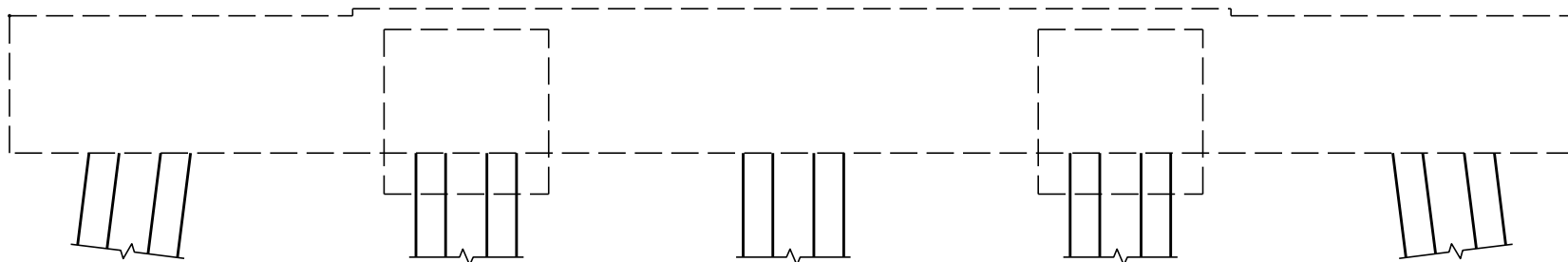

ELEVATION
EAST FACE

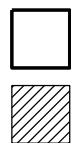

PROPOSED REPAIR AREAS

SUBSTRUCTURE SPALL/DELAMINATION

PROJECT NO. B-5937
CURRITUCK/DARE COUNTY
 STATION: BRIDGE NO. 16

DocuSigned by:
Samuel Cullum
 19C97095C75A467...

 12/13/2016

STATE OF NORTH CAROLINA DEPARTMENT OF TRANSPORTATION RALEIGH						SHEET NO.
SUBSTRUCTURE CONC. REPAIR - BENT 244						S-263
REVISIONS						TOTAL SHEETS
NO.	BY:	DATE:	NO.	BY:	DATE:	
1			3			3
2			4			4

DRAWN BY : T. S. CHILDRESS DATE : -
 CHECKED BY : S. L. CULLUM DATE : -
 DESIGN ENGINEER OF RECORD: S. L. CULLUM DATE : -

DOCUMENT NOT CONSIDERED
 FINAL UNLESS ALL
 SIGNATURES COMPLETED