

PHASING DIAGRAM

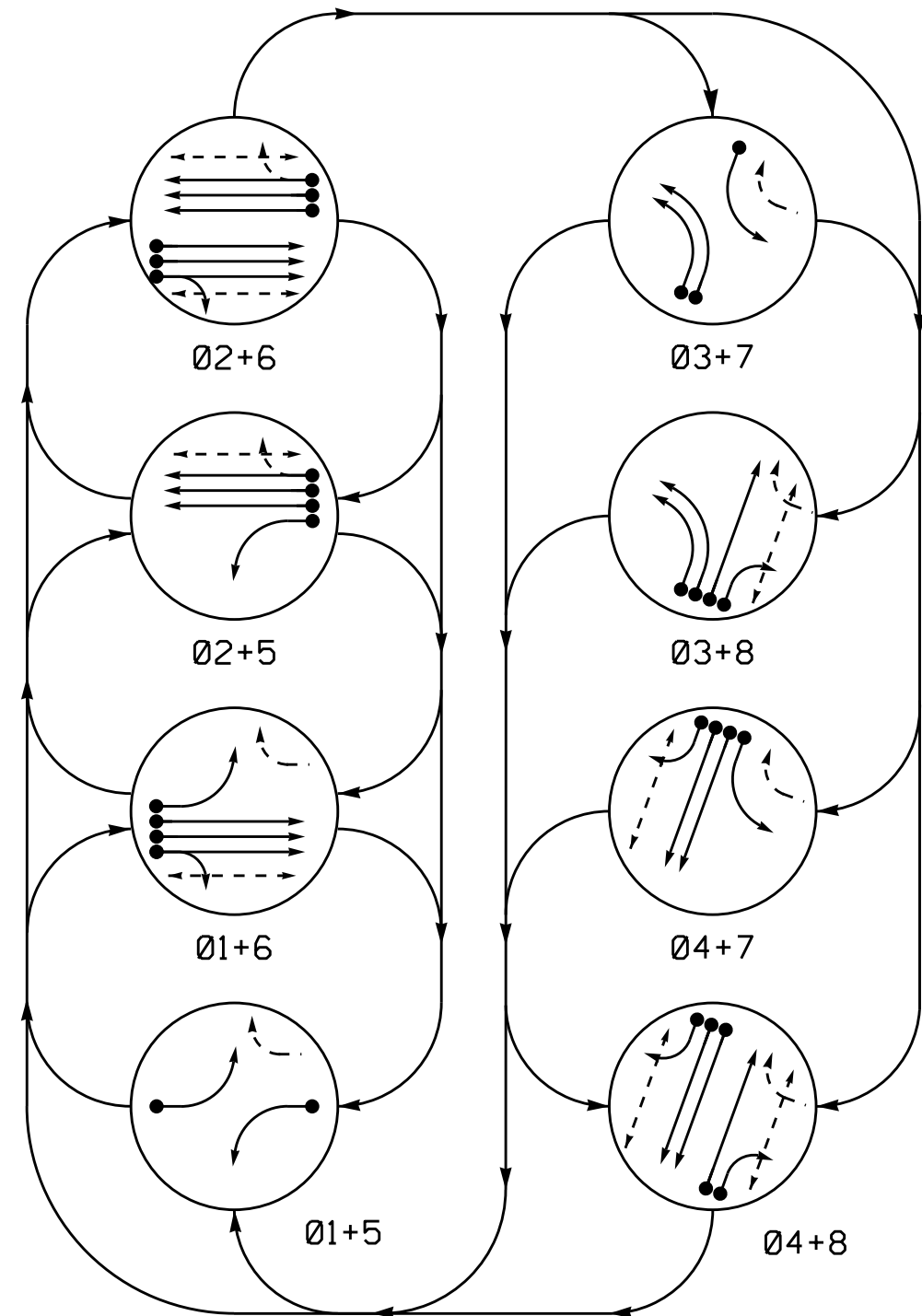

PHASING DIAGRAM DETECTION LEGEND

- ← ● → DETECTED MOVEMENT
- ← ○ → UNDETECTED MOVEMENT (OVERLAP)
- UNSIGNALIZED MOVEMENT
- PEDESTRIAN MOVEMENT

SIGNAL FACE	PHASE							
	Ø 1+5	Ø 2+6	Ø 3+7	Ø 4+8	Ø 1+5	Ø 2+6	Ø 3+7	Ø 4+8
11	---	---	---	---	---	---	---	---
21, 22, 23	R	R	G	G	R	R	R	Y
31, 32	---	---	---	---	---	---	---	---
41, 42, 43	R	R	R	R	R	R	G	G
51	---	---	---	---	---	---	---	---
61, 62, 63	R	G	R	G	R	R	R	Y
71	---	---	---	---	---	---	---	---
81, 82, 83	R	R	R	R	R	G	R	G
P21, P22	DW	DW	W	DW	DW	DW	DW	DRK
P41, P42	DW	DW	DW	DW	DW	W	W	DRK
P61, P62	DW	W	DW	W	DW	DW	DW	DRK
P81, P82	DW	DW	DW	DW	W	DW	W	DRK

SIGNAL FACE I.D.

All Heads L.E.D.

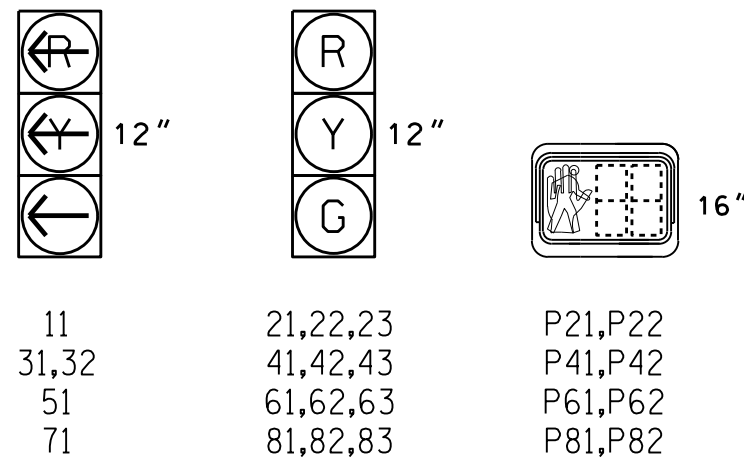

ASC/3 DETECTOR INSTALLATION CHART										
DETECTOR					PROGRAMMING					
LOOP	SIZE (FT)	DISTANCE FROM STOPBAR (FT)	TURNS	NEW LOOP	PHASE	CALLING	EXTEND TIME	DELAY TIME	TYPE	NEW CARD
1A	6X40	0	2-4-2	-	1	Yes	-	-	S	X
2A/S2A	6X6	300	4	-	2	Yes	-	-	N	X
2B/S2B	6X6	300	4	-	2	Yes	-	-	N	X
2C/S2C	6X6	300	4	-	2	Yes	-	-	N	X
3A	6X40	0	2-4-2	-	3	Yes	-	-	S	X
3B	6X40	0	2-4-2	-	3	Yes	-	-	S	X
4A	6X40	0	2-4-2	-	4	Yes	-	-	S	X
4B	6X40	0	2-4-2	-	4	Yes	-	-	S	X
4C	6X40	0	2-4-2	-	4	Yes	-	15	S	X
5A	6X40	0	2-4-2	-	5	Yes	-	-	S	X
6A/S6A	6X6	300	4	-	6	Yes	-	-	N	X
6B/S6B	6X6	300	4	-	6	Yes	-	-	N	X
6C/S6C	6X6	300	4	-	6	Yes	-	-	N	X
7A	6X40	0	2-4-2	-	7	Yes	-	-	S	X
8A	6X40	0	2-4-2	-	8	Yes	-	-	S	X
8B	6X40	0	2-4-2	-	8	Yes	-	15	S	X

8 Phase Fully Actuated Fayetteville Signal System

NOTES

- Refer to "Roadway Standard Drawings NCDOT" dated January 2012 and "Standard Specifications for Roads and Structures" dated January 2012.
- Do not program signal for late night flashing operation unless otherwise directed by the Engineer.
- Phase 1 and/or phase 5 may be lagged.
- Phase 3 and/or phase 7 may be lagged.
- Set all detector units to presence mode.
- Locate new cabinet so as not to obstruct sight distance of vehicles turning right on red.
- Omit "WALK" and flashing "DON'T WALK" with no pedestrian calls.
- Program pedestrian heads to countdown the flashing "Don't Walk" time only.
- Pavement markings are existing.
- Maximum times shown in timing chart are for free-run operation only. Coordinated signal system timing values supersede these values.

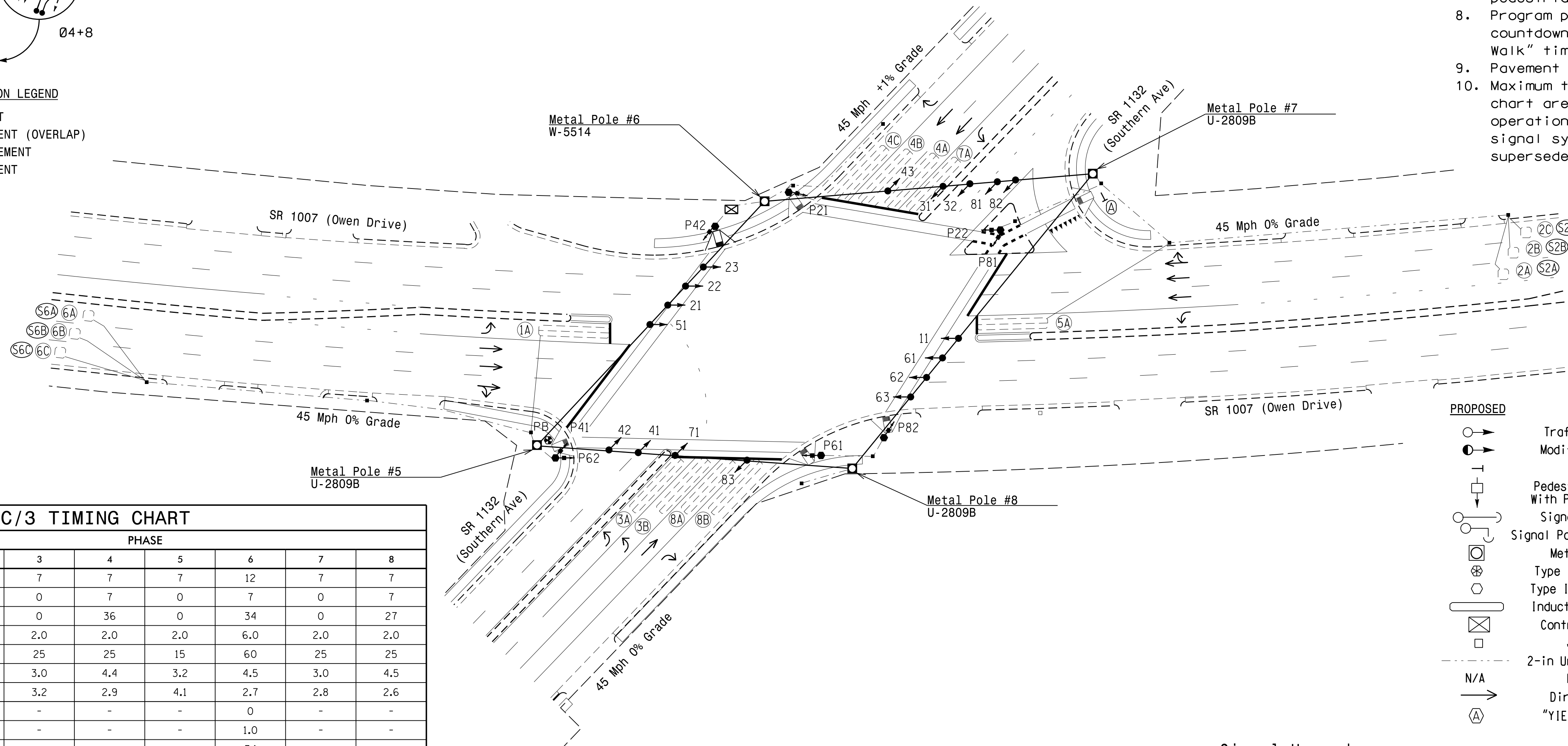

ASC/3 TIMING CHART								
FEATURE	PHASE							
	1	2	3	4	5	6	7	8
Min Green *	7	12	7	7	7	12	7	7
Walk *	0	7	0	7	0	7	0	7
Ped Clear	0	24	0	36	0	34	0	27
Veh. Extension *	2.0	6.0	2.0	2.0	2.0	6.0	2.0	2.0
Max 1 *	24	60	25	25	15	60	25	25
Yellow	3.2	4.5	3.0	4.4	3.2	4.5	3.0	4.5
Red Clear	4.0	2.6	3.2	2.9	4.1	2.7	2.8	2.6
Actuations B4 Add *	-	0	-	-	-	0	-	-
Seconds / Actuation *	-	1.0	-	-	-	1.0	-	-
Max Initial *	-	34	-	-	-	34	-	-
Time Before Reduction *	-	15	-	-	-	15	-	-
Time To Reduce *	-	30	-	-	-	30	-	-
Minimum Gap	-	3.0	-	-	-	3.0	-	-
Locking Detector	-	X	-	-	-	X	-	-
Recall Position	-	VEH. RECALL	-	-	-	VEH. RECALL	-	-
Dual Entry	-	-	-	-	-	-	-	-
Simultaneous Gap	X	X	X	X	X	X	X	X

* These values may be field adjusted. Do not adjust Min Green and Extension times for phases 2 and 6 lower than what is shown. Min Green for all other phases should not be lower than 4 seconds.

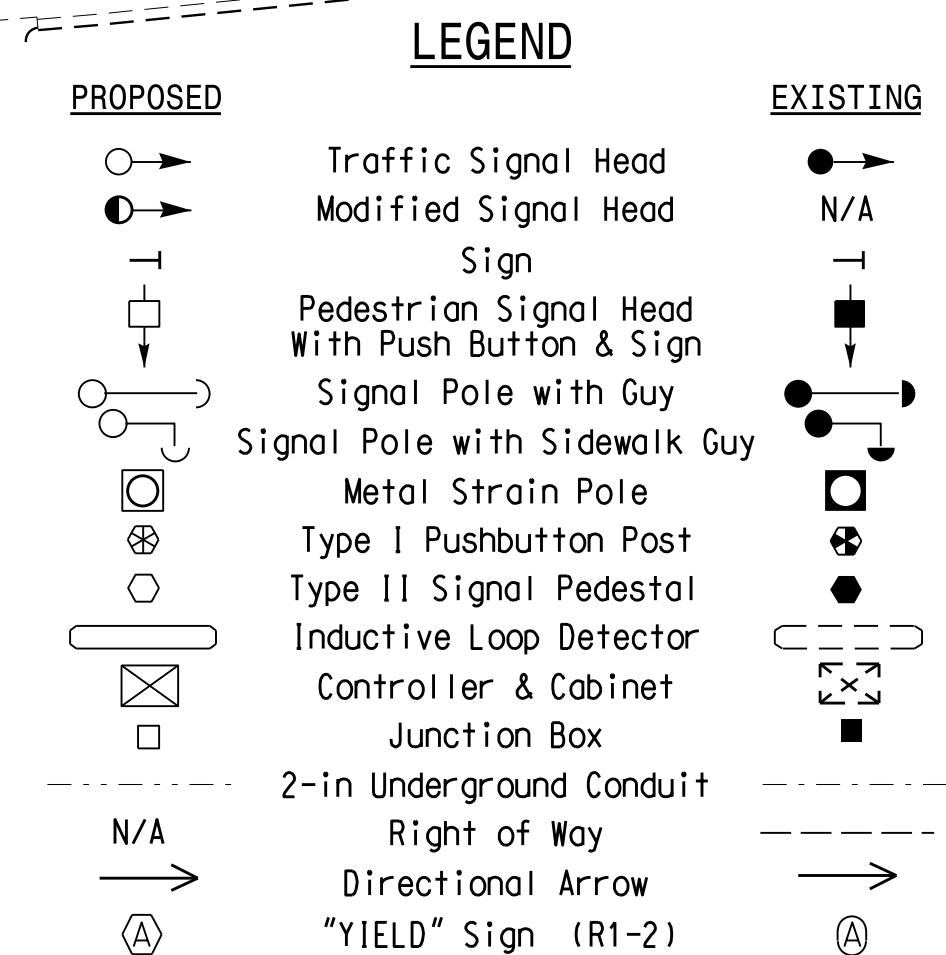

Signal Upgrade

750 N. Greenfield Pkwy, Garner, NC 27529

SR 1007 (Owen Drive) at SR 1132 (Southern Avenue)

Division 6 Cumberland County Fayetteville

PLAN DATE: May 2016 REVIEWED BY: JPG

PREPARED BY: KGP, Jr. REVIEWED BY:

DOCUMENT NOT CONSIDERED FINAL UNLESS ALL SIGNATURES COMPLETED

SEAL

DATE: 6/14/2016

SIG. INVENTORY NO. 06-0075

