

**This electronic collection of documents is provided
for the convenience of the user
and is Not a Certified Document –**

**The documents contained herein were originally issued
and sealed by the individuals whose names and license
numbers appear on each page, on the dates appearing
with their signature on that page.**

**This file or an individual page
shall not be considered a certified document.**

PROJECT REFERENCE NO.	SHEET NO.
U-4910B	SGN-1
APPROVED: _____	
DATE: _____	
SEAL	
	

**STATE OF NORTH CAROLINA
DEPARTMENT OF TRANSPORTATION**

**SIGNING PLAN
CABARRUS COUNTY**

**LOCATION: DERITA ROAD (SR 1445) FROM AVIATION BLVD
TO POPLAR TENT ROAD (SR 1394)**

T.I.P.: U-4910B

ROADWAY STANDARD DRAWING

THE FOLLOWING ROADWAY STANDARDS AS APPEAR IN "ROADWAY STANDARD DRAWINGS" - PROJECT SERVICES UNIT - N.C. DEPARTMENT OF TRANSPORTATION - RALEIGH, N.C., DATED JANUARY 2012 ARE APPLICABLE TO THIS PROJECT AND BY REFERENCE HEREBY ARE CONSIDERED A PART OF THESE PLANS:

STD. NO.	TITLE
904.10	ORIENTATION OF GROUND MOUNTED SIGNS
904.50	MOUNTING OF TYPE 'D', 'E' AND 'F' SIGNS ON 'U' CHANNEL POSTS

GENERAL NOTES

- . SIGNS FURNISHED BY STATE
- . IF REMOVAL OR RELOCATION OF SIGNS ON PRIVATE STREET (NON-STATE MAINTAINED) IS REQUIRED DUE TO CONSTRUCTION, THE CONTRACTOR SHALL INFORM THE ENGINEER. THE WORK WILL BE COMPLETED BY OTHERS.
- . WHEN NOT STATIONED OR DIMENSIONED ON PLANS, ALL 'E' AND 'F' SIGNS SHALL BE FIELD LOCATED BY THE ENGINEER
- . ALL EXISTING SIGNS ON "U" CHANNEL POST WITHIN THE PROJECT LIMITS SHALL BE REMOVED AND DISPOSED OF UNLESS OTHERWISE NOTED ON PLANS.
- . WHEN EXISTING SIGNS ARE REMOVED AND INSTALLED ON NEW SUPPORTS, THE RE-ERECTION SHALL IMMEDIATELY FOLLOW THE REMOVAL.
- . THE BACKGROUND FOR TYPE E & F SIGNS SHALL BE TYPE C REFLECTIVE SHEETING.
- . SEE ROADWAY PLANS FOR GUARD/GUIDE RAIL DETAILS.
- . REMOVE ALL EXISTING SIGNS WITHIN THE PROJECT LIMITS UNLESS OTHERWISE NOTED ON THE PLANS.

SUMMARY OF QUANTITIES

ITEM NO.		ITEM DESCRIPTION	QUANTITY	UNIT
DESC. NO.	SECT. NO.			
4072000000	903	SUPPORTS, 3 LB STEEL U-CHANNEL	1114	L.F.
4102000000	904	SIGN ERECTION, TYPE E	82	E.A.
4108000000	904	SIGN ERECTION, TYPE F	1	E.A.
4155000000	907	DISPOSAL OF SIGN SYSTEM, U-CHANNEL	29	E.A.

INDEX

SHEET NO.	DESCRIPTION
SGN-1	TITLE SHEET
SGN-2	TYPE E SIGNS
SGN-3	TYPE F SIGNS
SGN-4 - SGN-10	SIGN ROADWAY SHEETS

PLAN REVIEWED BY: N.C.D.O.T. SIGNING AND DELINEATION UNIT

Kelvin L. Jordan SIGNING & DELINEATION REGIONAL ENGINEER
Jon Robert Navarrete SIGNING & DELINEATION PROJECT DESIGN ENGINEER

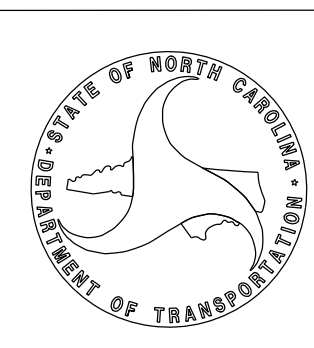

PLAN PREPARED BY: DAVENPORT

M. Scott Clark, PE PROJECT ENGINEER

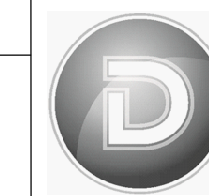

DAVENPORT
TRANSPORTATION CONSULTING
HOME OFFICE:
335 WEST FOURTH STREET, SUITE 2A
WINSTON-SALEM, NC 27101
336.744.9100 www.davenportnc.com
NCELS FIRM LICENSE NO. C-2322

CONTRACT:

PROJECT REFERENCE NO.	SHEET NO.
U-4910B	SGN-2
APPROVED: _____	
DATE: _____	
SEAL	

401 QUANTITY REQ'D 1

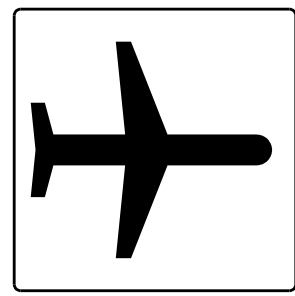

30 X 30
I-5

ONE "U" POST PER SIGN

406 QUANTITY REQ'D 7

54 X 18
R6-1L



TWO "U" POSTS PER SIGN

411 QUANTITY REQ'D 4

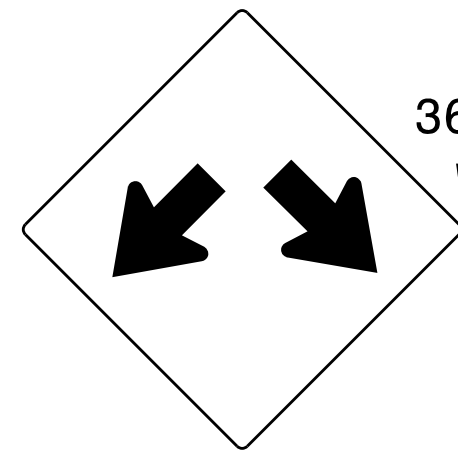

36 X 36
W12-1

ONE "U" POST PER SIGN

416 QUANTITY REQ'D 1

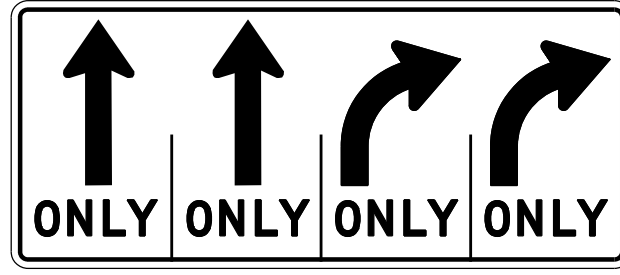

60 X 30
R3-8b

TWO "U" POSTS PER SIGN

402 QUANTITY REQ'D 15

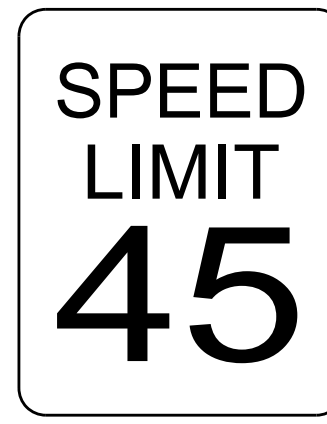

36 X 48
R2-1

ONE "U" POST PER SIGN

407 QUANTITY REQ'D 2

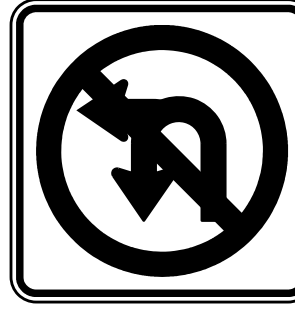

24 X 24
R3-18

ONE "U" POST PER SIGN

412 QUANTITY REQ'D 9

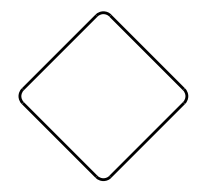

18 x 18
OM1-3

MOUNT BELOW SIGN 404
IN 9 INSTALLATIONS

403 QUANTITY REQ'D 6

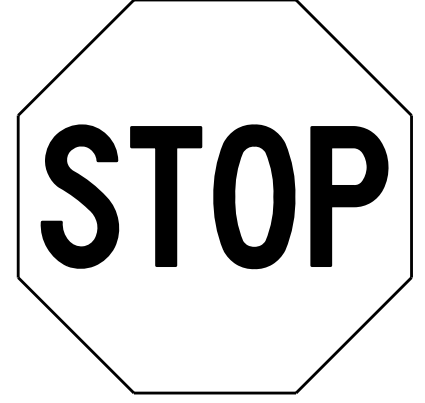

36 X 36
R1-1

MOUNT BELOW SIGN 414
IN 4 INSTALLATIONS
ONE "U" POST PER SIGN

408 QUANTITY REQ'D 6



30 X 30
R5-1

ONE "U" POSTS PER SIGN

413 QUANTITY REQ'D 1

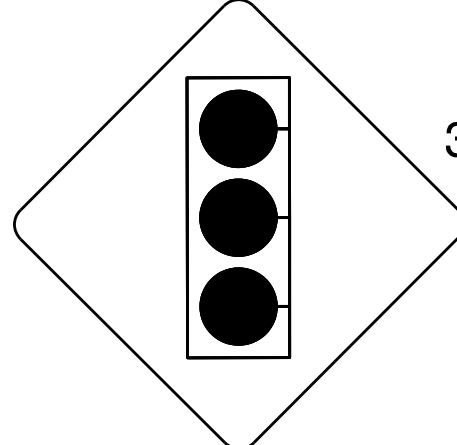

30 X 30
W3-3

ONE "U" POST PER SIGN

404 QUANTITY REQ'D 9

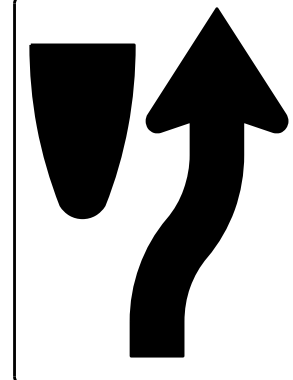

24 X 30
R4-7

ONE "U" POST PER SIGN

409 QUANTITY REQ'D 6

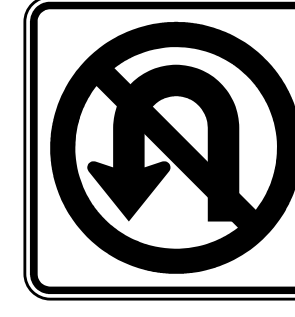

24 X 24
R3-4

ONE "U" POST PER SIGN

414 QUANTITY REQ'D 4

36 X 12



R6-1R

MOUNT ABOVE SIGN 403
IN 4 INSTALLATIONS

405 QUANTITY REQ'D 1



36 X 36
W14-2

ONE "U" POST PER SIGN

410 QUANTITY REQ'D 6

54 X 18



R6-1R

TWO "U" POSTS PER SIGN

415 QUANTITY REQ'D 4



36 X 24
R5-1a





ONE "U" POST PER SIGN

TYPE "E" SIGNS

1/5/2017 11:55:08 AM NCDOT - U-4910B Cabarrus County\CAD\RDWY\PLANS\SGN\U-4910B_sgn_psh_a02.dgn
 D:\ENR\PORT\scloak

PROJECT REFERENCE NO.	SHEET NO.
U-4910B	SGN-3
APPROVED: _____	
DATE: _____	
SEAL	
	

(501) QUANTITY REQ'D .1__

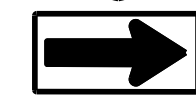
- | | | | |
|------------|---|---|------------|
| 1- 24 X 12 |  |  | 1- 24 X 12 |
| 1- 30 X 24 |  |  | 1- 30 X 24 |
| 1- 21 X 15 |  |  | 1- 21 X 15 |

TWO "U" POSTS PER SIGN

TYPE "F" SIGNS

1/5/2017 11:15:30 AM N:\15-308-NCDOT - U-4910B Cabarrus County\CAD\RDWY\PLANS\SGN\U-4910B_sgn_psh_a03 .dgn
DAVENPORT/scloak

PROJECT REFERENCE NO.	SHEET NO.
U-4910B	SGN-4
APPROVED: _____	
DATE: _____	
SEAL	



NOTE:
1. DISPOSAL OF SIGN SYSTEM, U-CHANNEL

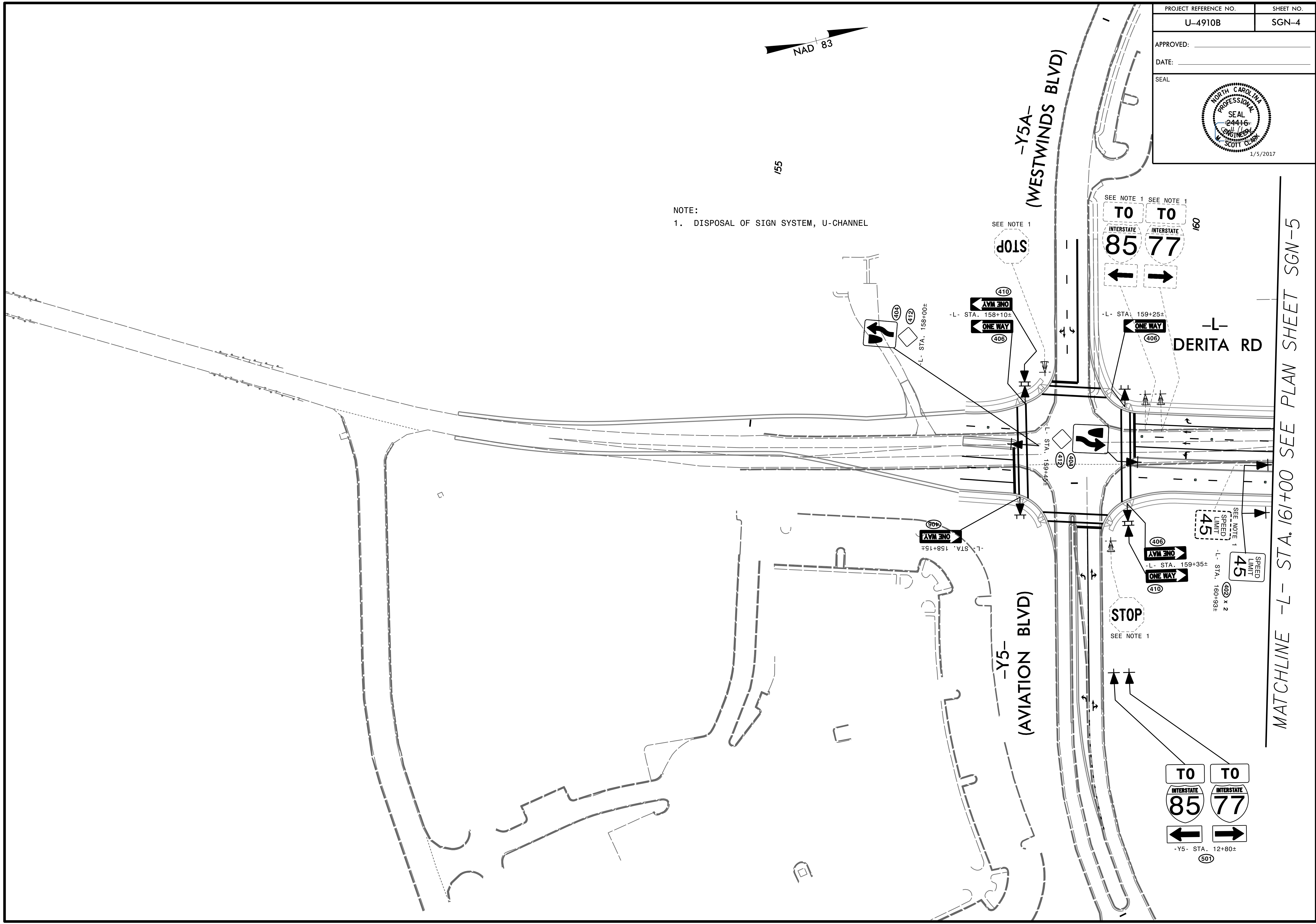

MATCHLINE -L- STA. 161+00 SEE PLAN SHEET SGN-5

PROJECT REFERENCE NO.	SHEET NO.
U-4910B	SGN-5
APPROVED: _____	
DATE: _____	
SEAL	
	

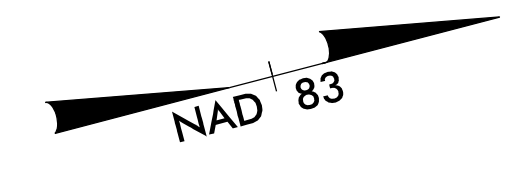

MATCHLINE -L- STA. 161+00 SEE PLAN SHEET SGN-4

MATCHLINE -L- STA. 171+00 SEE PLAN SHEET SGN-6

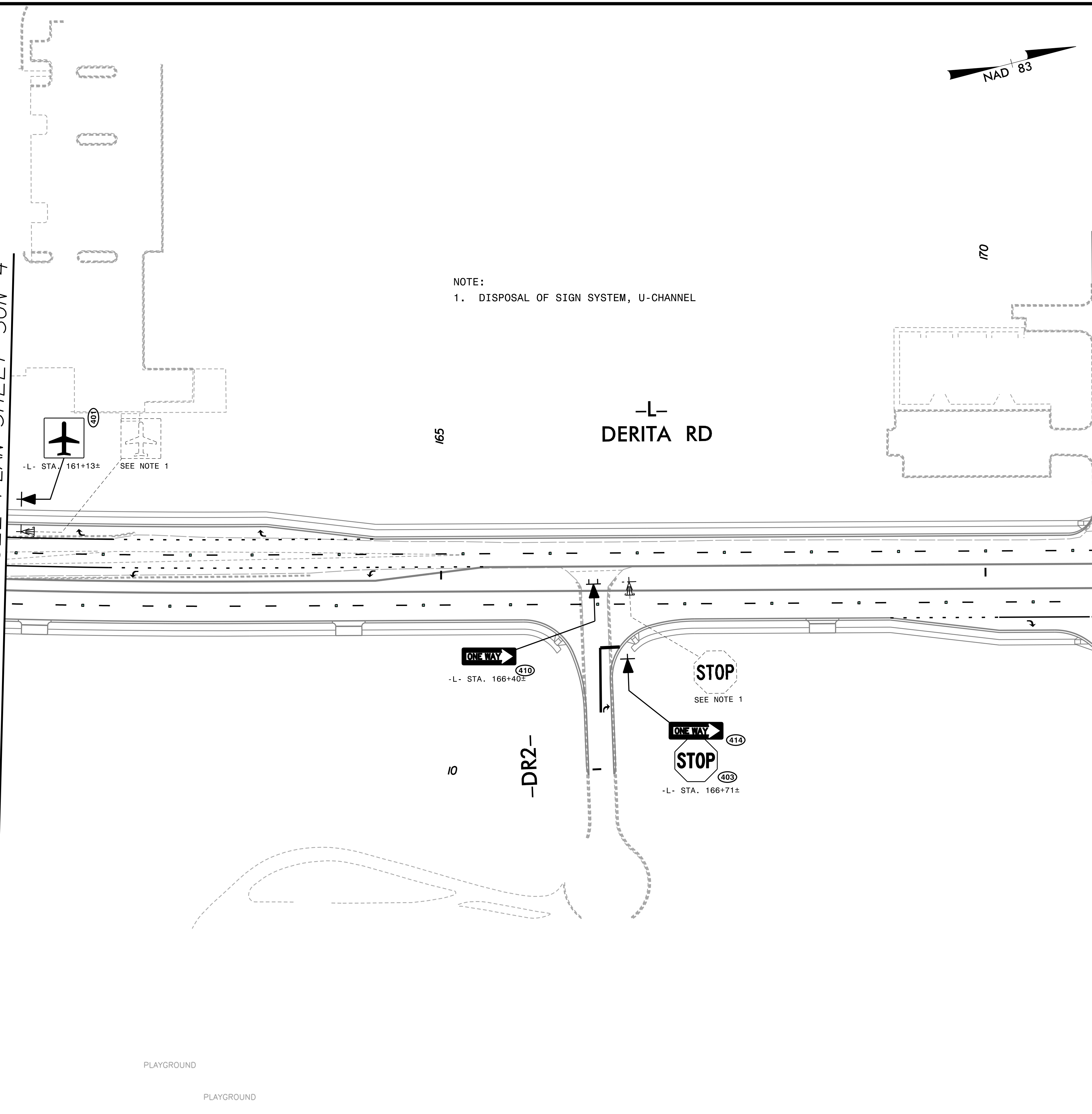

NOTE:
1. DISPOSAL OF SIGN SYSTEM, U-CHANNEL

-L-
DERITA RD

-DR2-

PLAYGROUND
PLAYGROUND

PROJECT REFERENCE NO.	SHEET NO.
U-4910B	SGN-6
APPROVED: _____	
DATE: _____	
SEAL	



NOTE:
1. DISPOSAL OF SIGN SYSTEM, U-CHANNEL

MATCHLINE -L- STA. 171+00 SEE PLAN SHEET SGN-5

MATCHLINE -L- STA. 184+00 SEE PLAN SHEET SGN-7

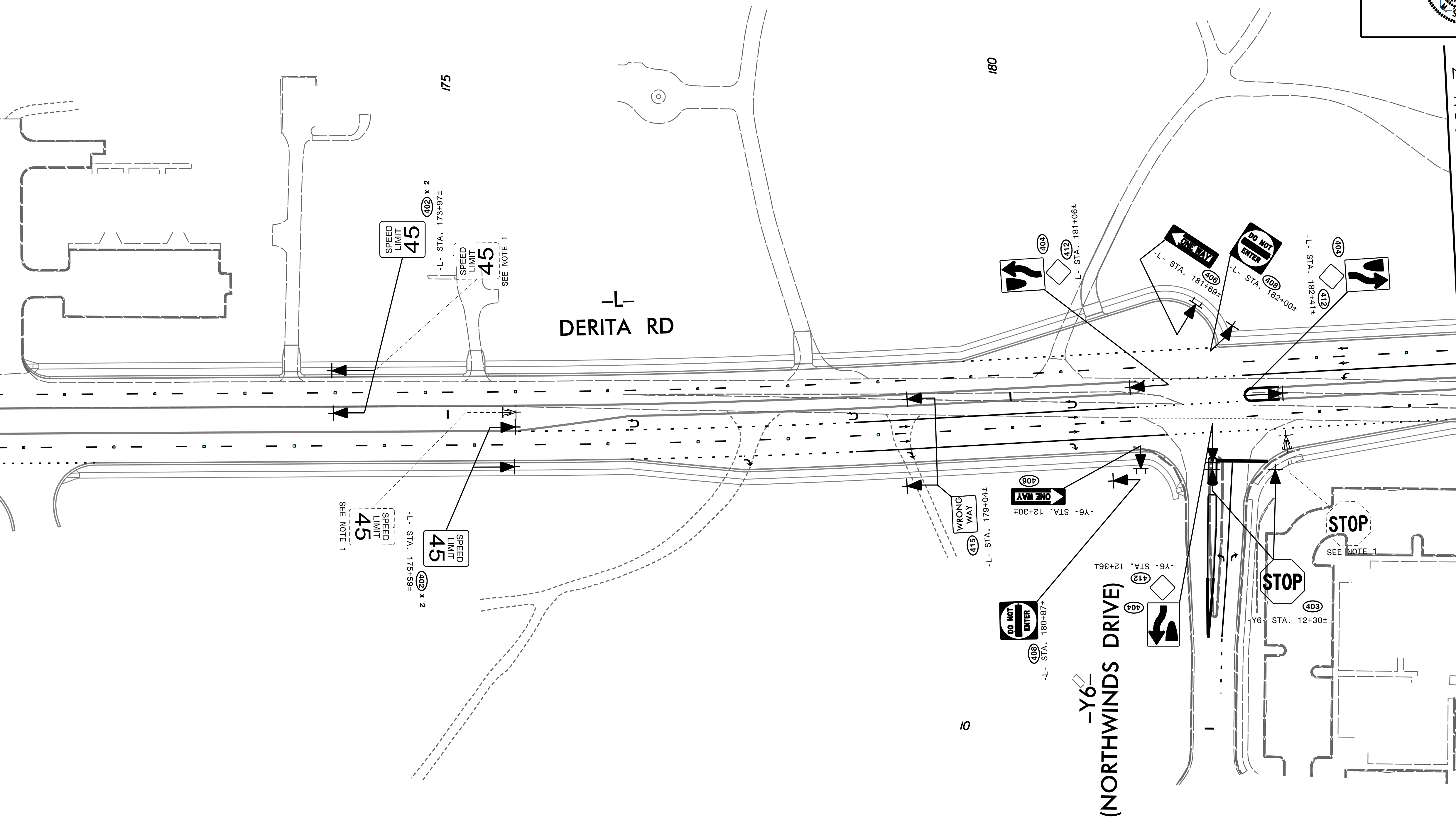

SPEED LIMIT 45
SEE NOTE 1

SPEED LIMIT 45
L- STA. 175+59±
(402) x 2

SPEED LIMIT 45
L- STA. 173+97±
(402) x 2

SPEED LIMIT 45
SEE NOTE 1

DO NOT ENTER
L- STA. 180+87±
(408)

WRONG WAY
L- STA. 179+04±
(415)

(NORTHWINDS DRIVE)
-Y6-
L- STA. 180+87±
(404)

ONE WAY
-Y6- STA. 12+30±
(409)

STOP
-Y6- STA. 12+30±
(403)

ONE WAY
L- STA. 181+06±
(408)

DO NOT ENTER
L- STA. 182+00±
(408)

ONE WAY
L- STA. 182+11±
(417)

STOP
L- STA. 182+12±
(403)

STOP
L- STA. 184+12±
(403)

SEE NOTE 1

PROJECT REFERENCE NO.	SHEET NO.
U-4910B	SGN-7
APPROVED: _____	
DATE: _____	
SEAL	

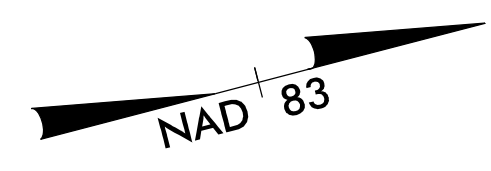

MATCHLINE -L- STA. 184+00 SEE PLAN SHEET SGN-6

MATCHLINE -L- STA. 198+00 SEE PLAN SHEET SGN-8

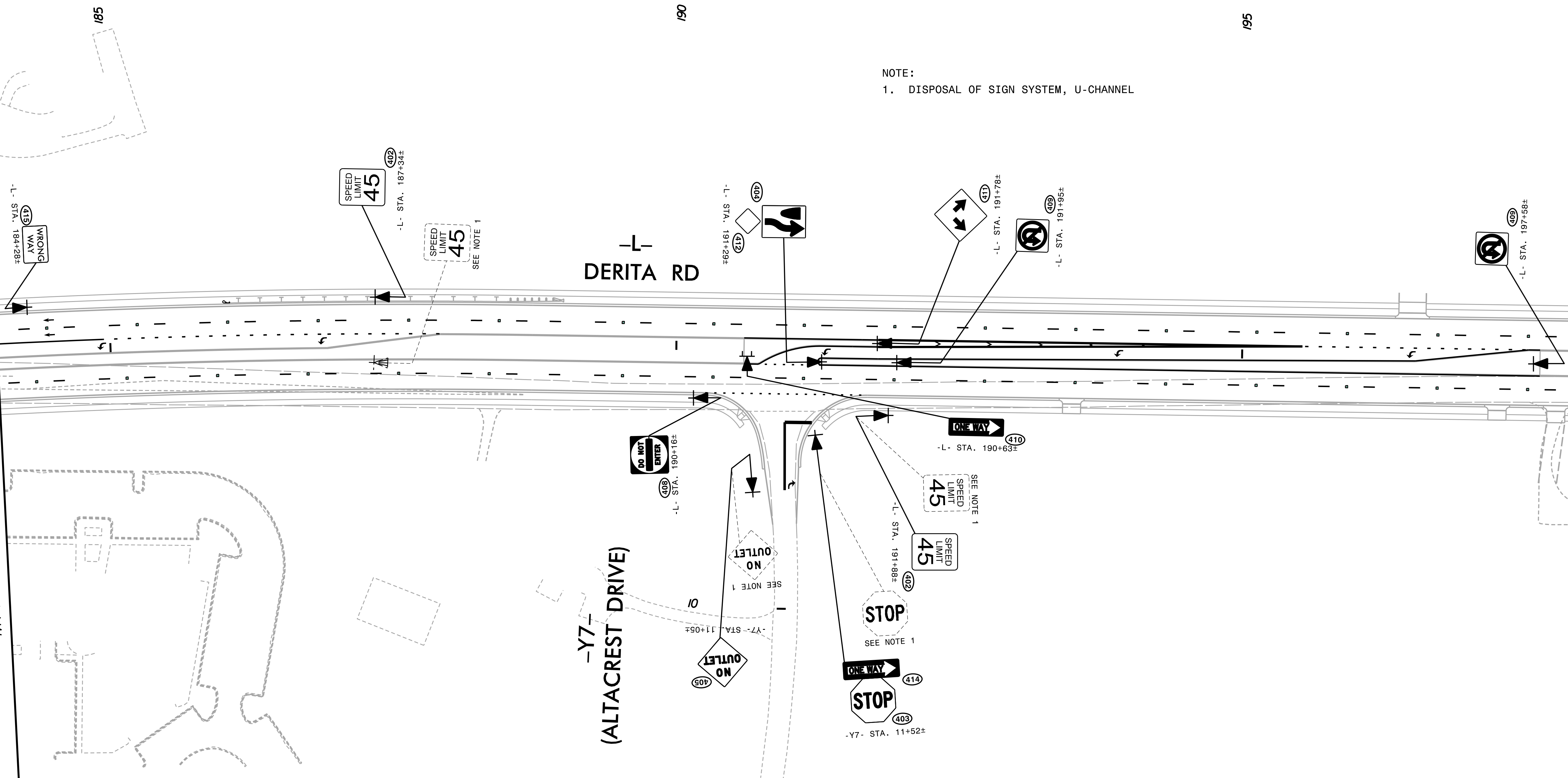

NOTE:
1. DISPOSAL OF SIGN SYSTEM, U-CHANNEL

PROJECT REFERENCE NO.	SHEET NO.
U-4910B	SGN-8
APPROVED: _____	
DATE: _____	
SEAL	
	

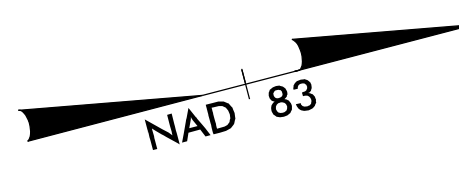

MATCHLINE -L- STA. 198+00 SEE PLAN SHEET SGN-7

MATCHLINE STA. 212+00 SEE PLAN SHEET SGN-9

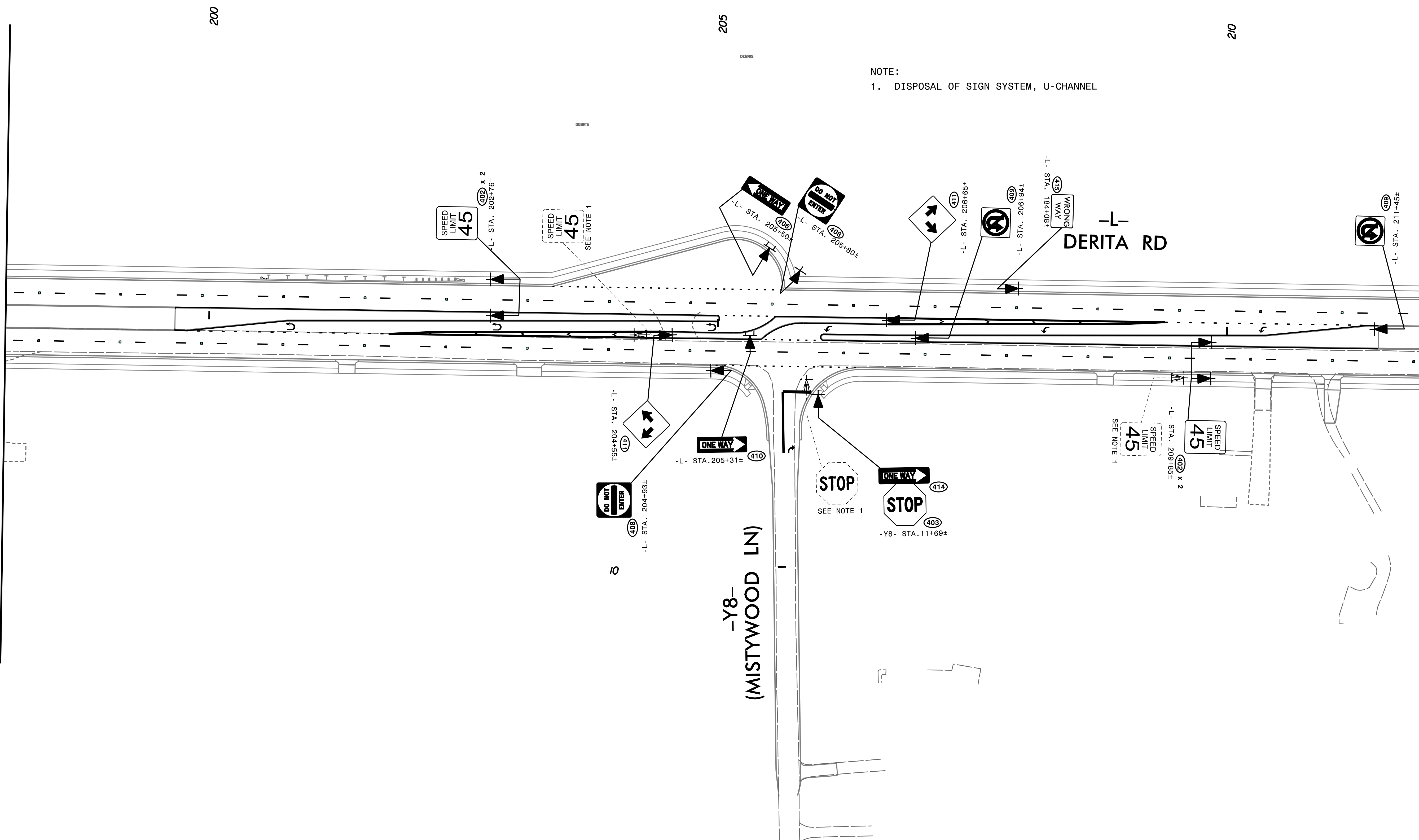

NOTE:
1. DISPOSAL OF SIGN SYSTEM, U-CHANNEL

200

205

210

DEBRIS

DEBRIS

10

-Y8-
(MISTYWOOD LN)

-L-
DERITA RD

PROJECT REFERENCE NO.	SHEET NO.
U-4910B	SGN-9
APPROVED: _____	
DATE: _____	
SEAL	
	

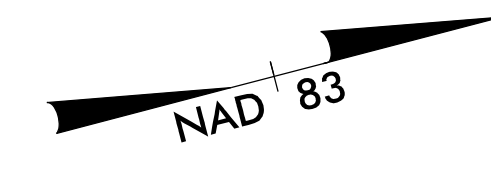

MATCHLINE -L- STA. 212+00 SEE PLAN SHEET SGN-8

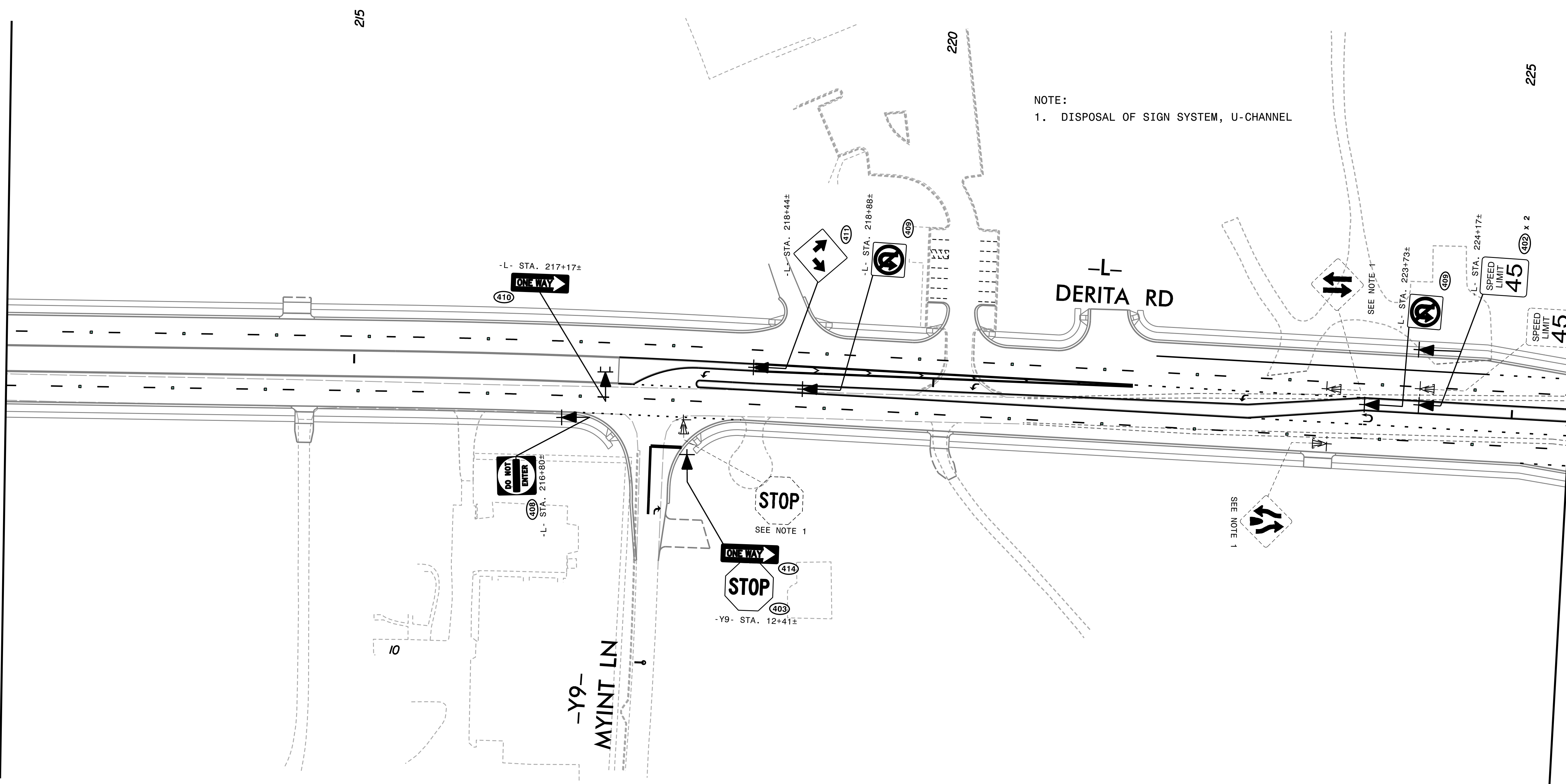

NOTE:
1. DISPOSAL OF SIGN SYSTEM, U-CHANNEL

MATCHLINE -L- STA. 225+50 SEE PLAN SHEET SGN-10

PROJECT REFERENCE NO.	SHEET NO.
U-4910B	SGN-10
APPROVED: _____	
DATE: _____	
SEAL	

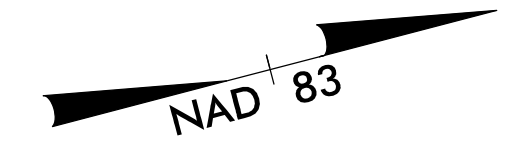
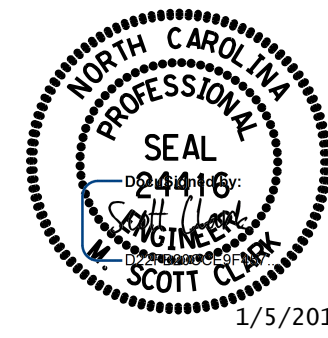

MATCHLINE -L- STA. 225+50 SEE PLAN SHEET SGN-9

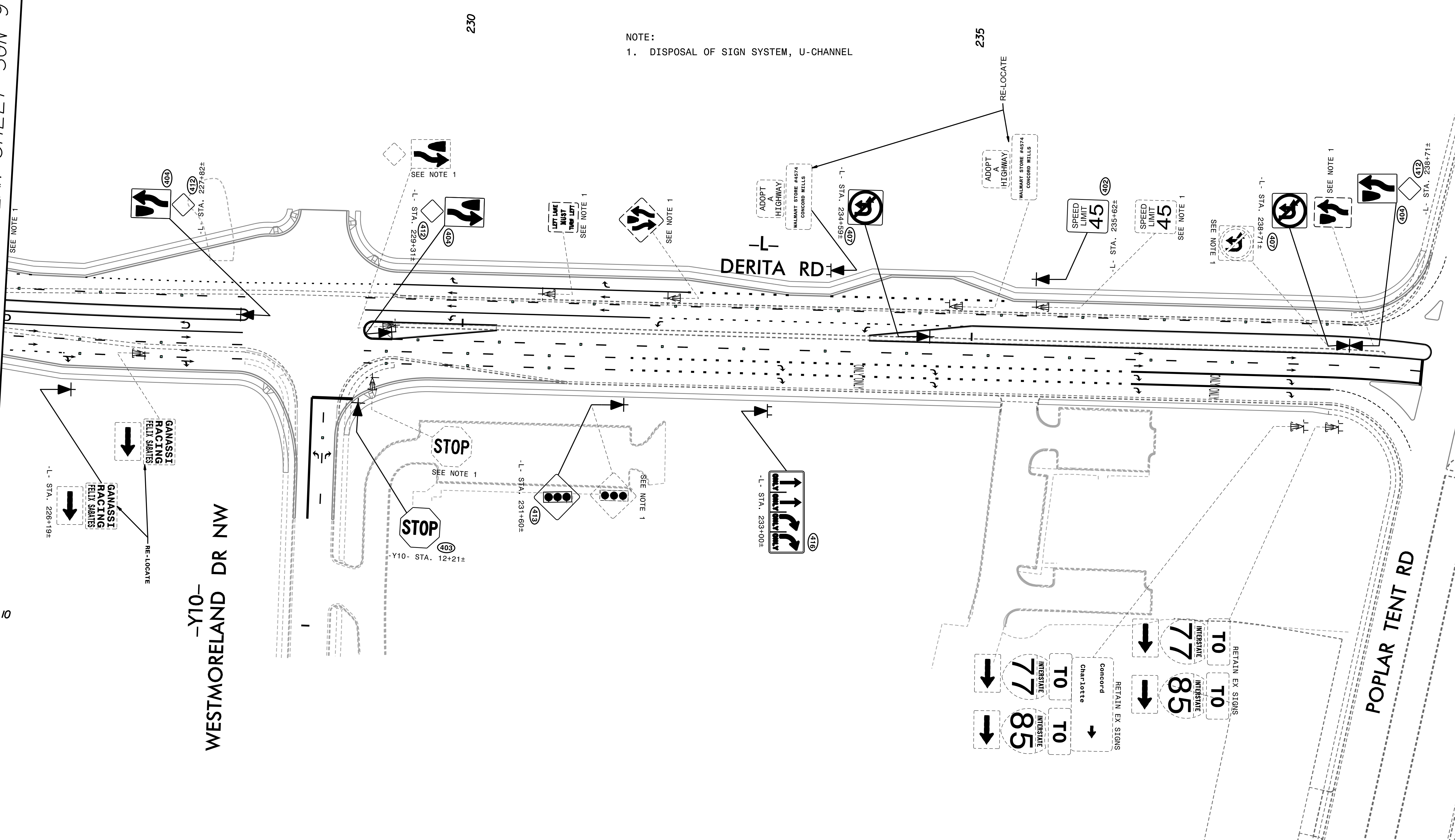

NOTE:
1. DISPOSAL OF SIGN SYSTEM, U-CHANNEL

-Y10-
WESTMORELAND DR NW

POPLAR TENT RD

DERITA RD

230

235

-L- STA. 226+19±

-L- STA. 227+82±

-L- STA. 229+31±

Y10 - STA. 12+21±

-L- STA. 231+60±

-L- STA. 233+00±

-L- STA. 234+59±

-L- STA. 235+62±

-L- STA. 238+71±

-L- STA. 238+71±

GANASSI RACING FELIX SHAMTES

ADOPT A HIGHWAY
WALMART STORE #8574
CONCORD N.C.

ADOPT A HIGHWAY
WALMART STORE #8574
CONCORD N.C.

RETAIN EX SIGNS
77 INTERSTATE TO Concord
77 INTERSTATE TO Charlotte
85 INTERSTATE TO

RETAIN EX SIGNS
77 INTERSTATE TO
85 INTERSTATE TO

