

PROJECT REFERENCE NO. <b>U-4910B</b>	SHEET NO. <b>11</b>
RW SHEET NO.	
ROADWAY DESIGN ENGINEER 	HYDRAULICS ENGINEER 
Prepared in the Office of: <b>AECOM</b> NC FIRM LICENSE No. F-0342 701 Corporate Center Drive, Suite 475 Raleigh, NC 27607 (919) 854-6200 • (919) 854-6259(FAX)	
<b>DOCUMENT NOT CONSIDERED FINAL UNLESS ALL SIGNATURES COMPLETED</b>	

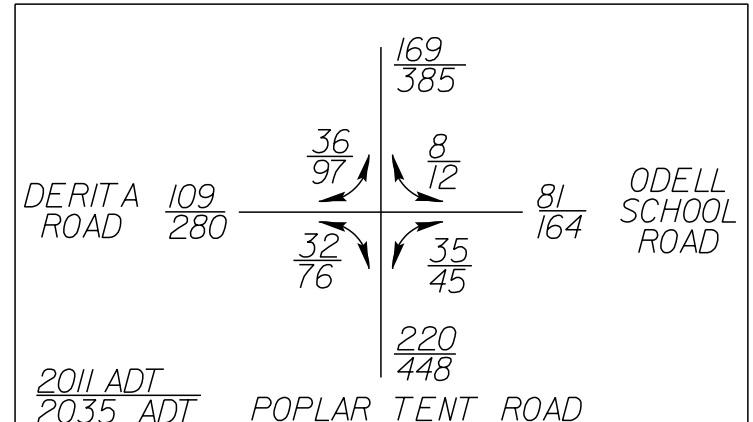

NAD 83/NSRS 2007

MATCHLINE -L- STA. 238+50 SEE PLAN SHEET 10

-L-	-YII-
PI Sta 239+91.37	PI Sta 214+62.20
$\Delta = 11' 46' 30.9''$ (RT)	$\Delta = 2' 36' 42.2''$ (RT)
D = 3' 49' 11.0"	D = 0' 29' 59.9"
L = 308.28'	L = 522.38'
T = 154.68'	T = 261.24'
R = 1,500.00'	R = 11,460.00'
DS = 50 MPH	DS = 40 MPH
S.E. = 04	S.E. = NC
RO = 66'	RO = N/A

CROSSWALKS AND RESURFACING FOR CHANNELIZATION ISLANDS IN -L- / -YII- INTERSECTION NOT SHOWN

REVISIONS

Revisions:

Drawn: R:\Roadway\U-4910B\U-4910B.dwg  
 User: scheid  
 Date: 12/15/2016  
 Time: 4:20:07 PM

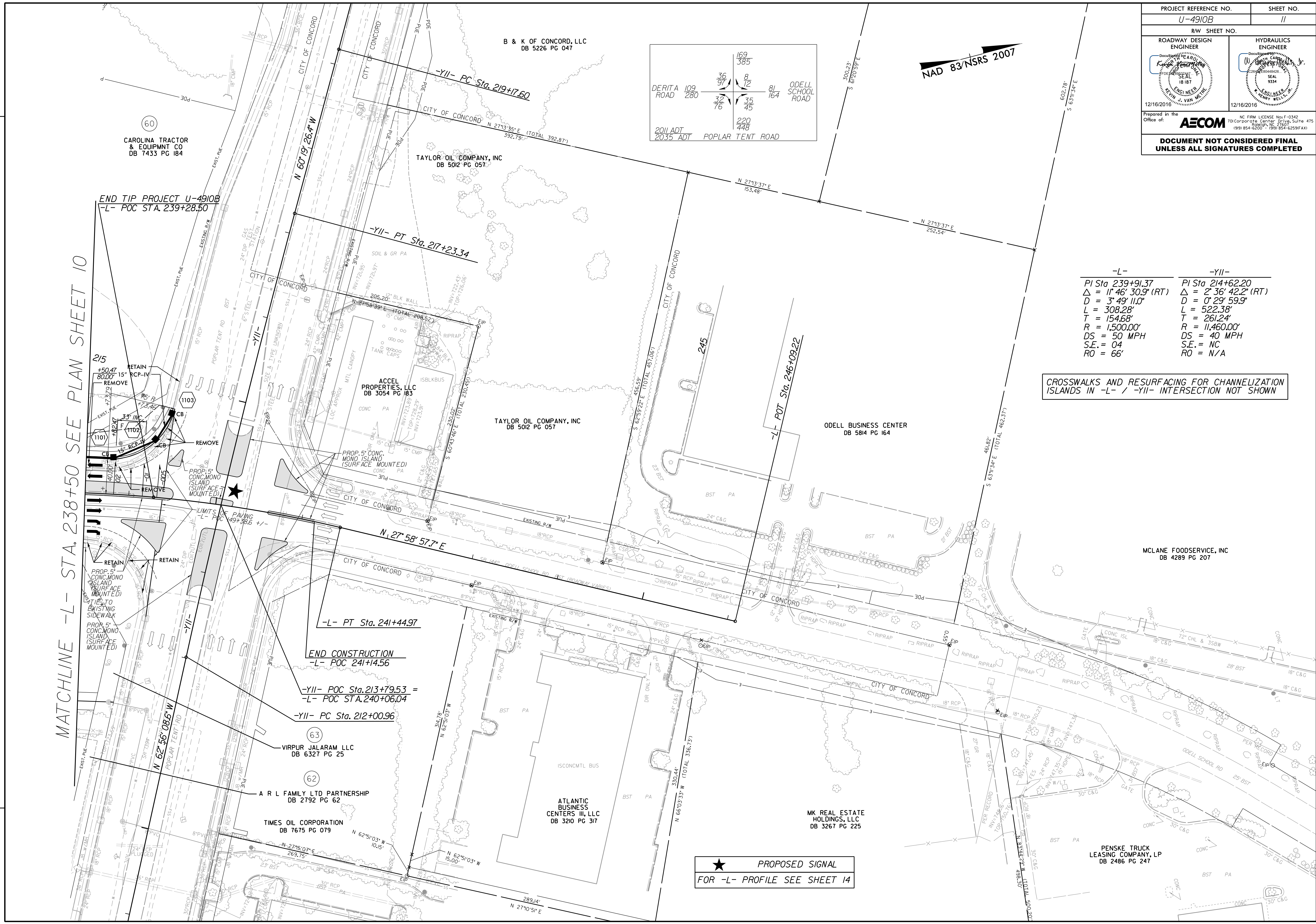

★ PROPOSED SIGNAL  
 FOR -L- PROFILE SEE SHEET 14