

PLAN VIEW

NOTE:
 BED MATERIAL PLACED BETWEEN SILLS IN THE CULVERT SHALL PROVIDE A CONTINUOUS LOW FLOW CHANNEL BETWEEN THE LOWER SILLS. THE MATERIAL SHALL BE NATURAL STONE WITH A GRADATION SIZE SIMILAR TO THAT OF CLASS B RIP RAP. STONES LARGER THAN 9 INCHES SHALL NOT BE PLACED WITHIN THE LOW FLOW CHANNEL. BED MATERIAL IS SUBJECT TO APPROVAL BY THE ENGINEER.

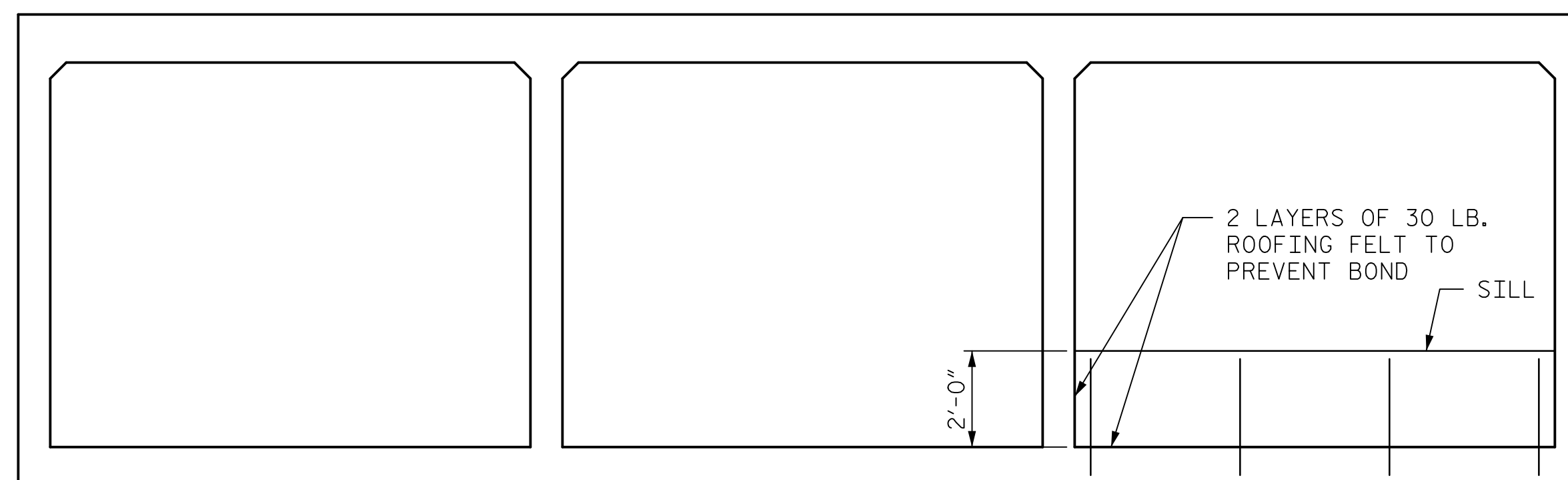

ELEVATION - LOOKING UPSTREAM

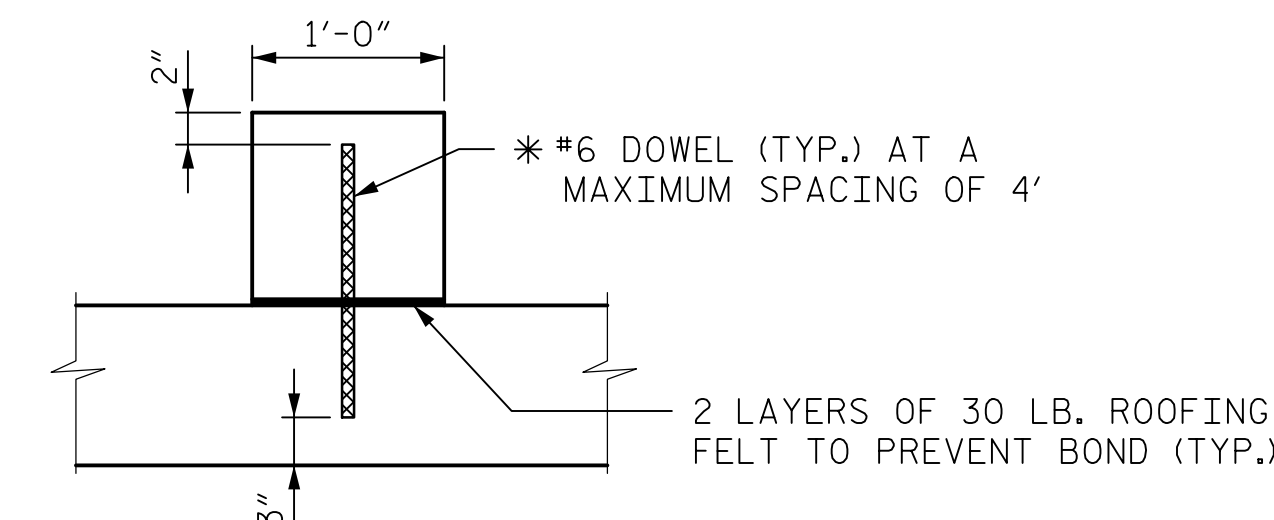

*DOWELS MAY BE PUSHED INTO GREEN CONCRETE AFTER SLAB HAS BEEN FLOAT FINISHED.

SECTION THROUGH SILL

CULVERT SILL DETAILS

PROJECT NO. U-4910A
CABARRUS COUNTY
 STATION: 124+11.00 -L-

DRAWN BY : N. K. BROWN DATE : 07/16
 CHECKED BY : N. K. BROWN DATE : 07/16
 DESIGNED BY : J. C. MORRISON DATE : 07/16

DOCUMENT NOT CONSIDERED
 FINAL UNLESS ALL
 SIGNATURES COMPLETED

AECOM
AECOM TECHNICAL SERVICES, INC.
 701 CORPORATE CENTER DRIVE, SUITE 475
 RALEIGH, NC 27607
 (919) 854-6200 www.aecom.com
 AECOM License No. F-6342

11/30/2016

SEAL
 030474
 JOHN C. MORRISON
 ENGINEER

STATE OF NORTH CAROLINA
DEPARTMENT OF TRANSPORTATION
 RALEIGH

SR 1445 (DERITA ROAD)
 OVER ROCKY RIVER
 TRIPLE 10 FT. X 8 FT.
 CONCRETE BOX CULVERT
 90° SKEW

REVISIONS						SHEET NO.
NO.	BY:	DATE:	NO.	BY:	DATE:	C-06
						TOTAL SHEETS
						7

DATE: 11/30/2016 TIME: 9:45:54 AM
 USER: C:\63500171\1001_Technical\408_Structural\Comp\Culvert\10_01_L14910A_SML.DWG