

NOTE :  
FOR QUANTITY BREAKDOWN, SEE  
"BILL OF MATERIAL" SHEET

\* RADIAL DIMINSION

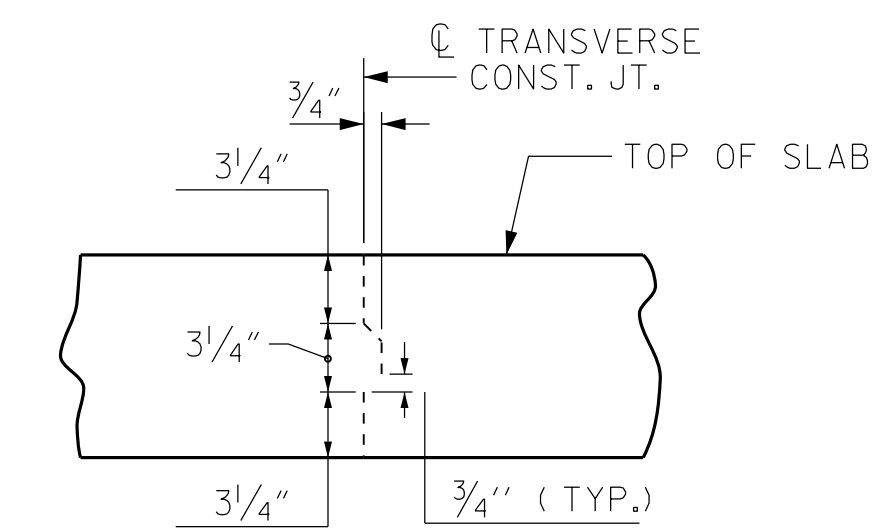
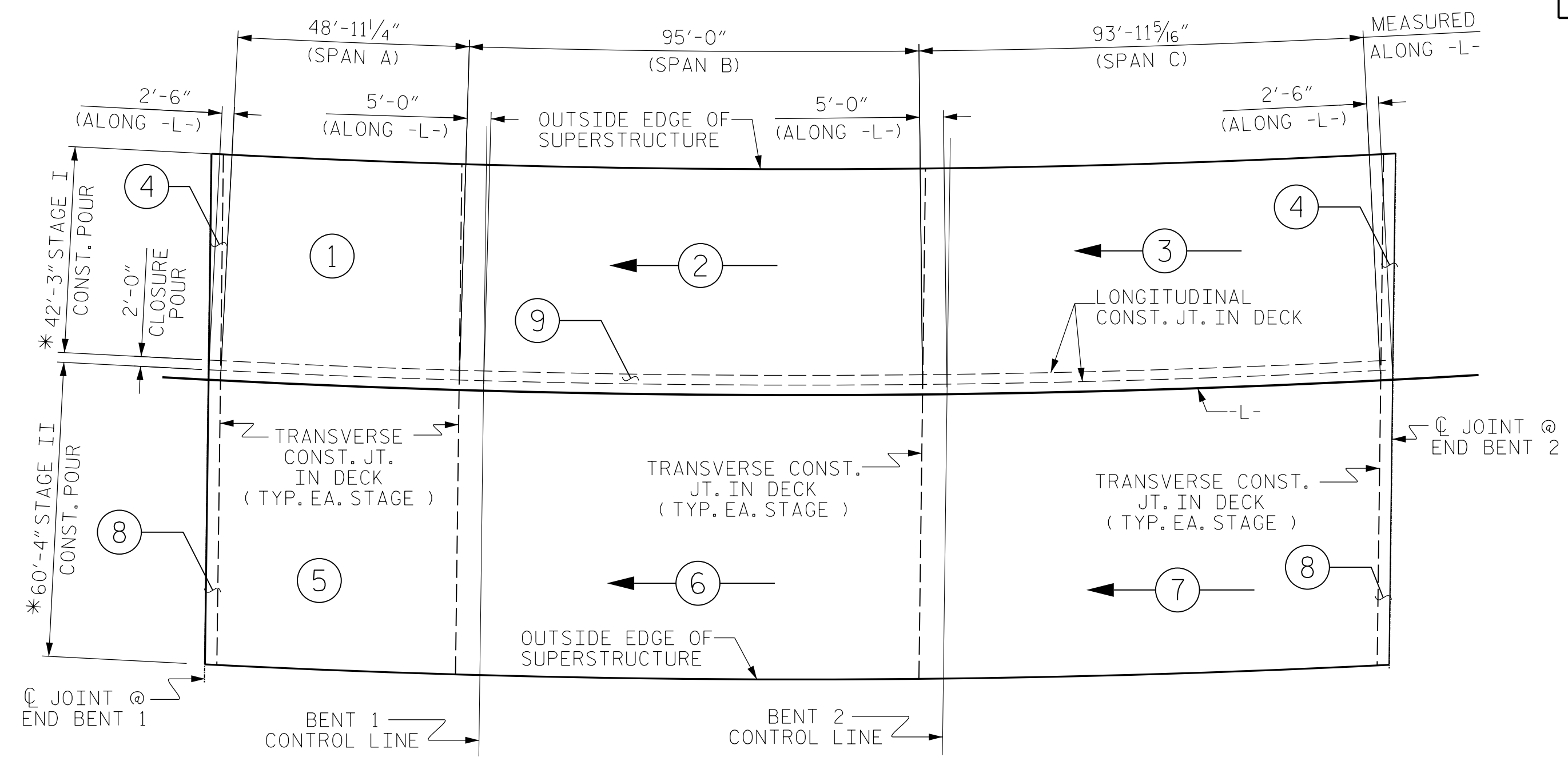

**POUR SEQUENCE**

← # INDICATES POUR NUMBER AND DIRECTION OF POUR

**TRANSVERSE CONSTRUCTION JOINT DETAIL**

NOTE: REINFORCING STEEL IN SLAB NOT SHOWN. LONGITUDINAL AND LATERAL REINFORCING STEEL SHALL BE CONTINUOUS THRU JOINT

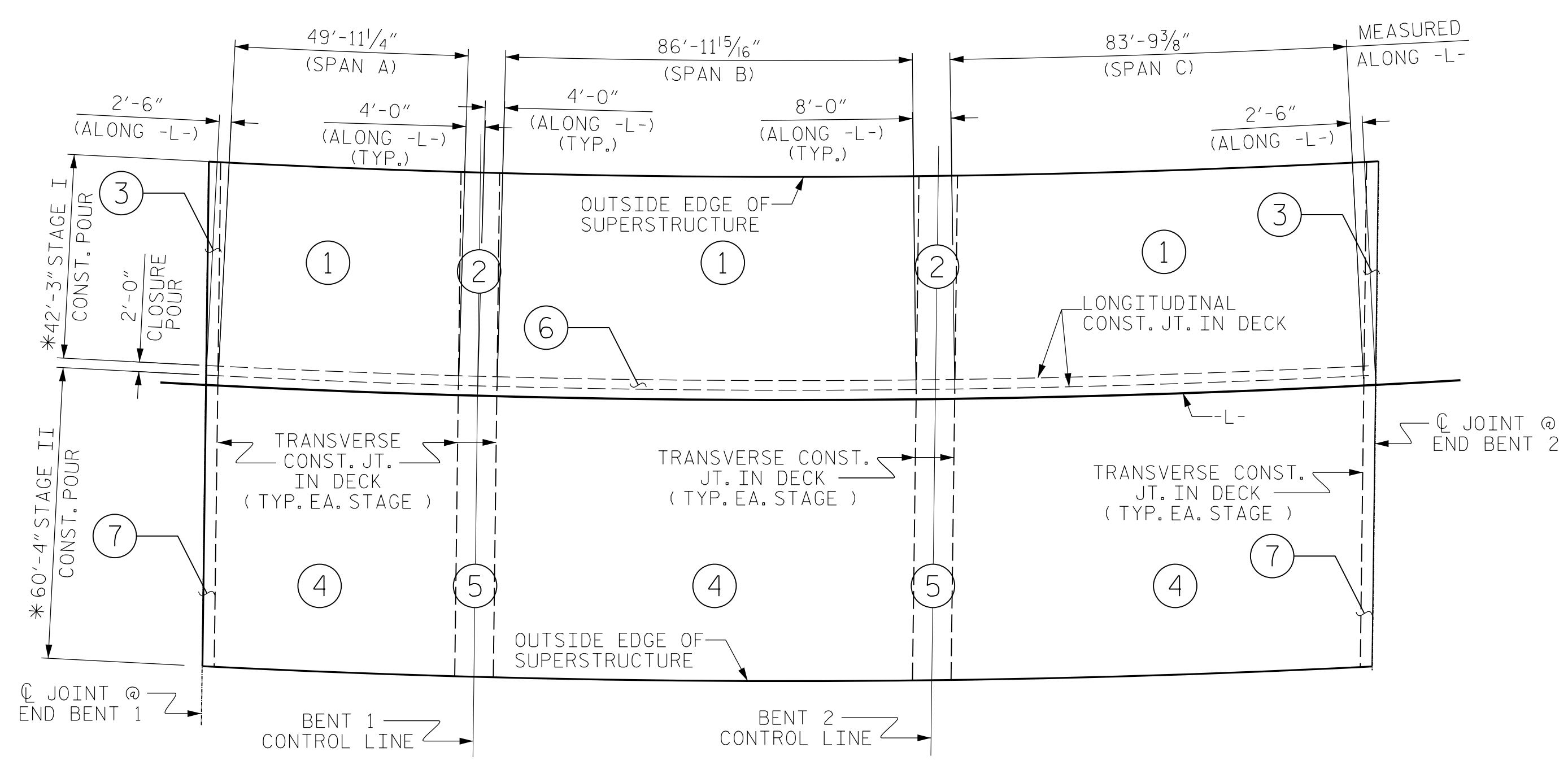

**OPTIONAL POURING SEQUENCE**

IN EACH STAGE, POUR 2 OR 5 SHALL NOT BE STARTED UNTIL BOTH ADJACENT 1 OR 4 POURS REACH A MINIMUM OF 3000 PSI. POUR 6 IS A 2'-0\"/>

PROJECT NO. U-4910A  
CABARRUS COUNTY  
STATION: 147+80.00 -L-

**AECOM**  
AECOM TECHNICAL SERVICES, INC.  
701 CORPORATE CENTER DRIVE, SUITE 475  
RALEIGH, NC 27607  
(919) 854-6200 www.aecom.com  
AECOM License No. F-6342

11/30/2016

NORTH CAROLINA PROFESSIONAL SEAL  
030474  
J.C. MORRISON  
ENGINEER  
A2FDE142C82F4A8

STATE OF NORTH CAROLINA  
DEPARTMENT OF TRANSPORTATION  
RALEIGH

**SUPERSTRUCTURE DECK POURING SEQUENCE**

REVISIONS						SHEET NO.
NO.	BY:	DATE:	NO.	BY:	DATE:	
1			3			S-33
2			4			TOTAL SHEETS 55

DRAWN BY : K.H. COMPTON DATE : 7/2016  
CHECKED BY : J.C. MORRISON DATE : 7/2016  
DESIGNED BY : K.H. COMPTON DATE : 7/2016

DOCUMENT NOT CONSIDERED FINAL UNLESS ALL SIGNATURES COMPLETED

DATE: 11/30/2016  
TIME: 10:13:35 AM

USER: H:\aecom\p03\06630007\1400\_Structural\408\_Structural\Comp\408\_Structural\SMU\_533\_BDM.dwg