

DATE: 11/30/2016  
TIME: 10:07:54 AM

USER: N:\s\2016\11\30\11001\_Technical\408\_Structural\408\_Structural\408\_L027\_LAB00A\_SML\_S14\_P504.dgn

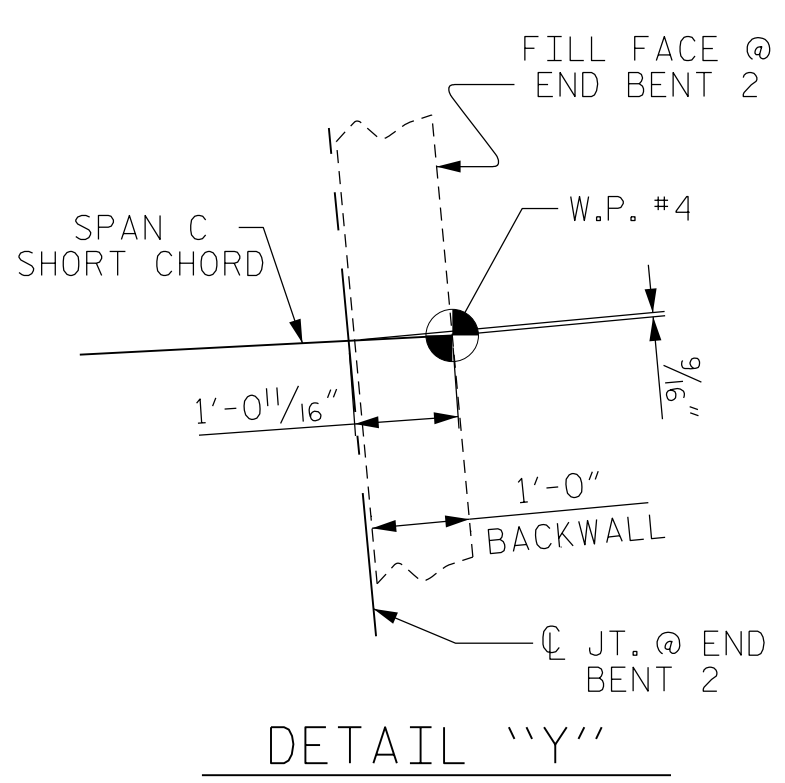
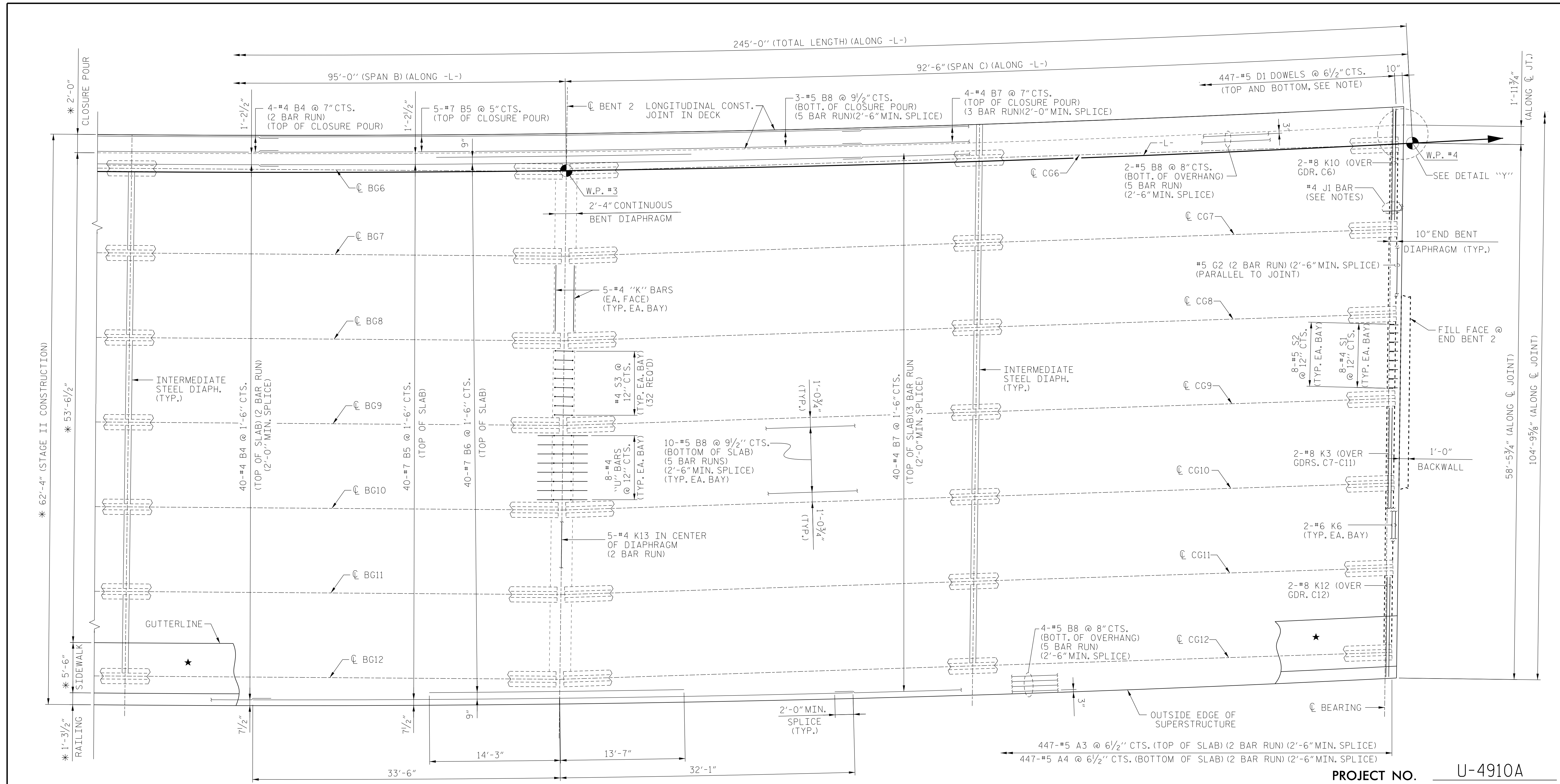

PARTIAL PLAN OF SPAN B AND PLAN OF SPAN C  
(STAGE II)  
\* RADIAL DIMENSION

- NOTES**
- FOR TRANSVERSE CONSTRUCTION JOINT DETAIL AND LOCATION, SEE "POURING SEQUENCE" SHEET.
  - FOR 3 BAR METAL RAIL REINFORCING, SEE "3 BAR METAL RAIL" SHEET.
  - \* FOR SIDEWALK REINFORCING, SEE "SIDEWALK DETAILS" SHEET.
  - #5 "A" BARS ARE TO BE PLACED PERPENDICULAR TO AND ALONG THE LONG CHORD
  - #5 D1 DOWELS SHALL BE PLACED IN THE SAME HORIZONTAL PLANE AS THE TOP AND BOTTOM SLAB REINFORCING STEEL.
  - FOR PLACEMENT OF #4 J1 BAR, SEE "EXPANSION JOINT SEAL DETAILS" SHEETS.

DRAWN BY : N.K. BROWN      DATE : 7/2016  
 CHECKED BY : K.H. COMPTON      DATE : 7/2016  
 DESIGNED BY : N.K. BROWN      DATE : 2/2016

PROJECT NO. U-4910A  
 CABARRUS COUNTY  
 STATION: 147+80.00 -L-  
 SHEET 4 OF 4

**AECOM**  
 AECOM TECHNICAL SERVICES, INC.  
 701 CORPORATE CENTER DRIVE, SUITE 475  
 RALEIGH, NC 27607  
 (919) 854-6200      www.aecom.com  
 AECOM License No. F-0342

11/30/2016

NORTH CAROLINA  
 PROFESSIONAL  
 SEAL  
 030474  
 JOHN C. MORRISON  
 ENGINEER

STATE OF NORTH CAROLINA  
 DEPARTMENT OF TRANSPORTATION  
 RALEIGH

SUPERSTRUCTURE  
 PLAN OF SPANS  
 STAGE II

REVISIONS						SHEET NO.
NO.	BY:	DATE:	NO.	BY:	DATE:	S-14
1			3			TOTAL SHEETS
2			4			55

DOCUMENT NOT CONSIDERED  
 FINAL UNLESS ALL  
 SIGNATURES COMPLETED