

ANGLES

- ① 90°-43'-53"
- ② 88°-26'-45"
- ③ 90°-18'-17"
- ④ 92°-35'-26"
- ⑤ 2°-15'-19"

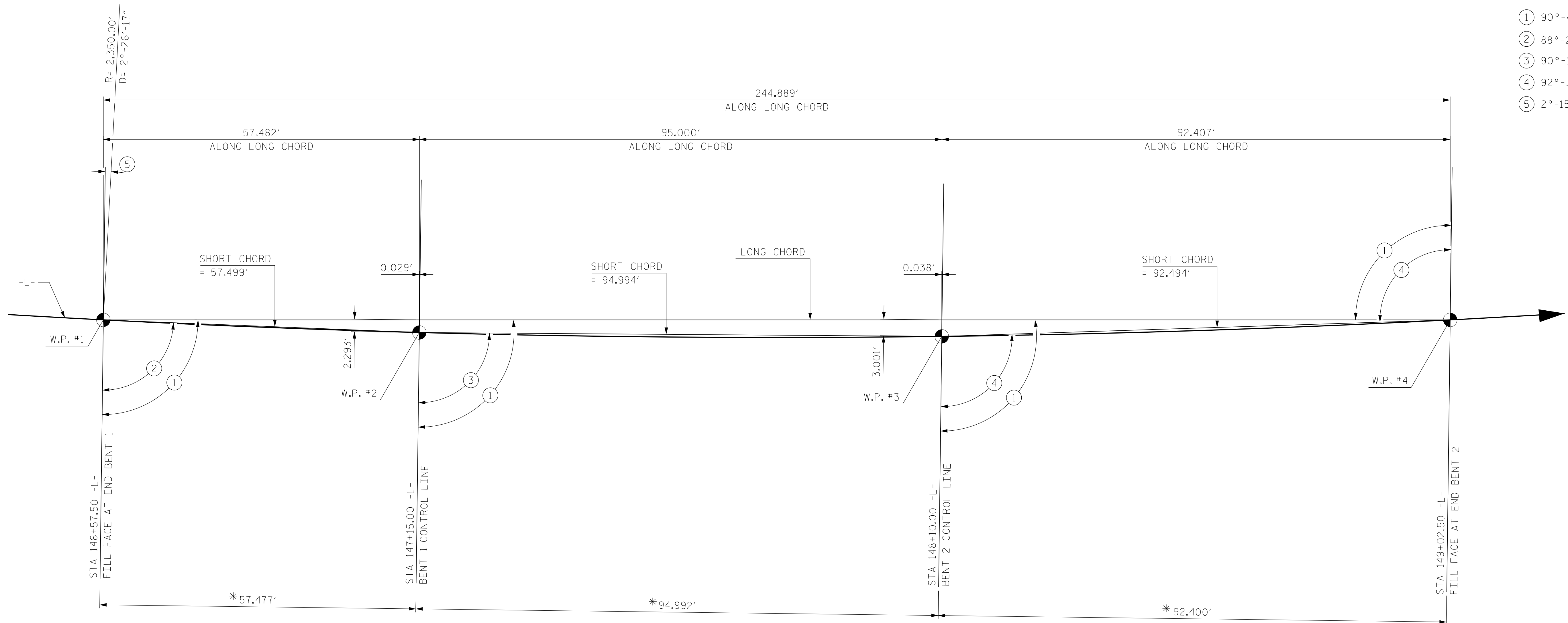

LONG CHORD LAYOUT

ALL BENTS ARE PARALLEL

HORIZONTAL CURVE DATA -L-

PI STA.=144+20.22 -L-
 $\Delta=34^{\circ}-36'-26.3"$ LT.
 $D=2^{\circ}-26'-17.2"$
 $L=1,419.43'$
 $T=732.11'$
 $R=2,350.00'$
 $DS=50$ MPH
 $S.E.=03$

* DIMENSION MEASURED NORMAL TO BENT CONTROL LINE

PROJECT NO. U-4910A
CABARRUS COUNTY
 STATION: 147+80.00 -L-

SHEET 3 OF 4

DRAWN BY : K.H. COMPTON DATE : 2/2016
 CHECKED BY : J.C. MORRISON DATE : 7/2016
 DESIGNED BY : K.H. COMPTON DATE : 2/2016

DOCUMENT NOT CONSIDERED
 FINAL UNLESS ALL
 SIGNATURES COMPLETED

AECOM
 AECOM TECHNICAL SERVICES, INC.
 701 CORPORATE CENTER DRIVE, SUITE 475
 RALEIGH, NC 27607
 (919) 854-6200 www.aecom.com
 AECOM License No. F-0342

11/30/2016

NORTH CAROLINA
 PROFESSIONAL
 SEAL
 030474
 ENGINEER
 JOHN C. MORRISON
 A2FDE142C82F44B

STATE OF NORTH CAROLINA
 DEPARTMENT OF TRANSPORTATION
 RALEIGH

GENERAL DRAWING

BRIDGE OVER ROCKY RIVER
 ON DERITA RD. (SR 1445)
 BETWEEN SR 1447 & SR 1394

REVISIONS						SHEET NO.
NO.	BY:	DATE:	NO.	BY:	DATE:	S-03
1			3			TOTAL SHEETS
2			4			55

DATE: 11/30/2016
 TIME: 10:54:05 AM

USER: H:\60808000
 DGN: C:\603000\71\001_Technical\408_Structural\408_005_U4910A_SMU_503_LC.dgn