

| | |
|---|---------------------|
| PROJECT REFERENCE NO. | SHEET NO. |
| R-5023B | EC-24/CONST.10 |
| RW SHEET NO. | |
| ROADWAY DESIGN ENGINEER | HYDRAULICS ENGINEER |
| HNTB | |
| HNTB NORTH CAROLINA, P.C. 343 E. SIX FORKS ROAD, SUITE 200 RALEIGH, NORTH CAROLINA 27609 NC LICENSE NO: C-1554 | |

MATCHLINE PLAN SHEET 9
-L- STA. 58 + 00.00

MATCHLINE PLAN SHEET 10
-L- STA. 66 + 00.00

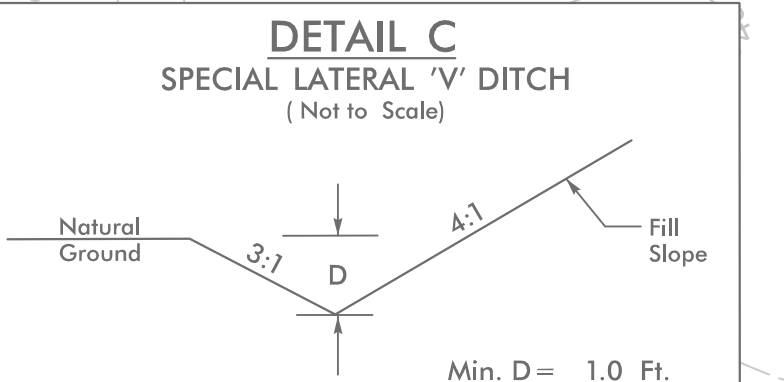
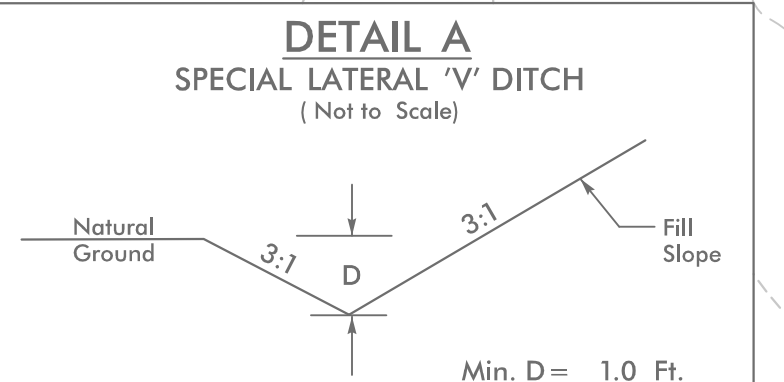
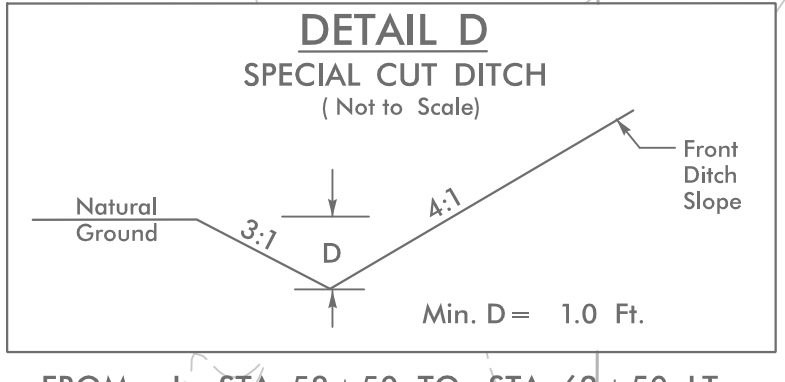
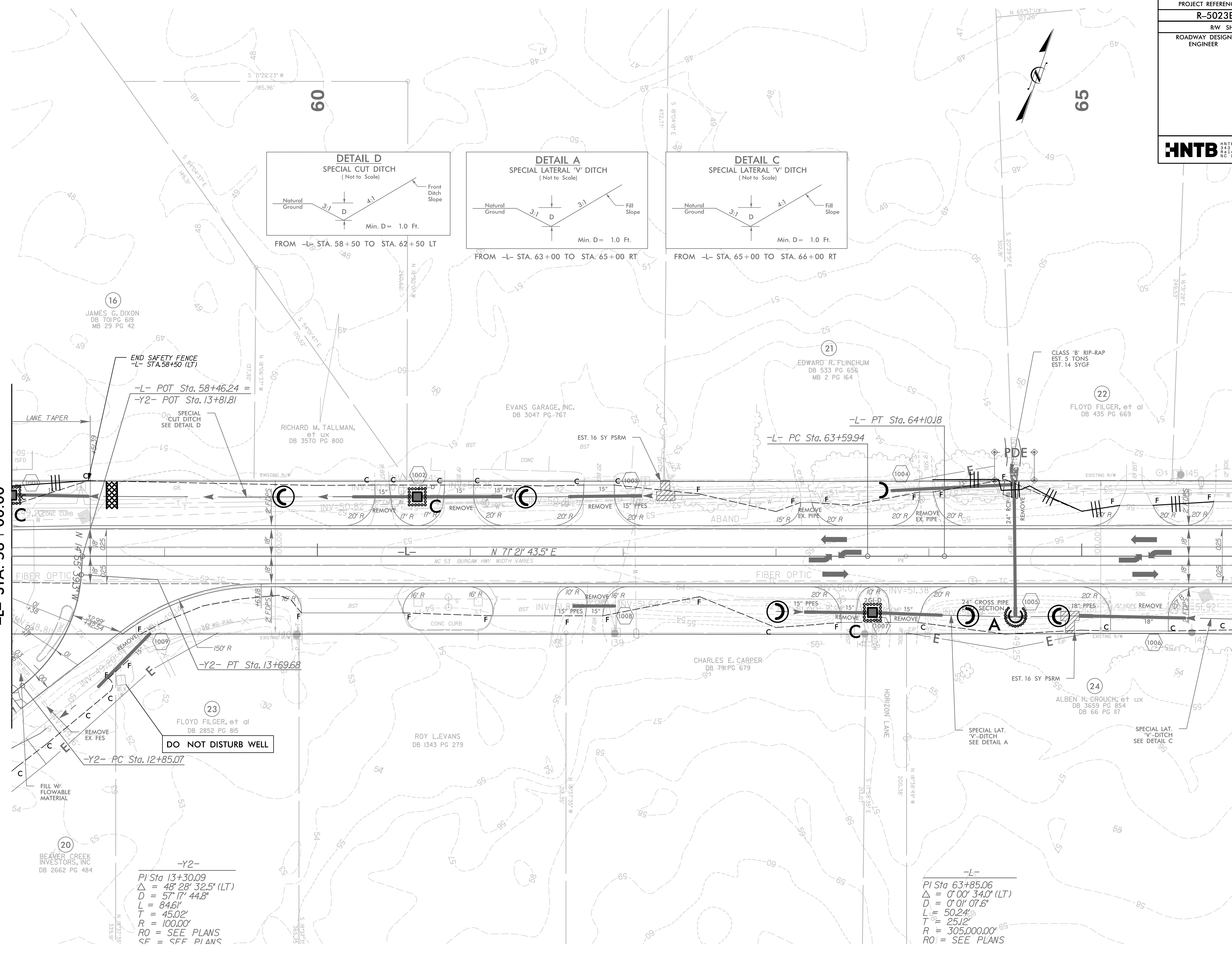

FROM -L- STA. 58+50 TO STA. 62+50 LT

FROM -L- STA. 63+00 TO STA. 65+00 RT

FROM -L- STA. 65+00 TO STA. 66+00 RT

-Y2-
 PI Sta 13+30.09
 $\Delta = 48^\circ 28' 32.5''$ (LT)
 $D = 57' 17.44.8''$
 $L = 84.61'$
 $T = 45.02'$
 $R = 100.00'$
 RO = SEE PLANS
 SF = SFF PLANS

-L-
 PI Sta 63+85.06
 $\Delta = 0^\circ 00' 34.0''$ (LT)
 $D = 0^\circ 01' 07.6''$
 $L = 50.24'$
 $T = 25.12'$
 $R = 305,000.00'$
 RO = SEE PLANS

REVISIONS

8/17/99

4/14/05 PM
R-5023B.ec.psh_10.dgn
HNTB