

PROJECT REFERENCE NO.	SHEET NO.
R-5023B	EC-11/CONST.11
RW SHEET NO.	
ROADWAY DESIGN ENGINEER	HYDRAULICS ENGINEER
HNTB	
<small>HNTB NORTH CAROLINA, P.C. 343 E. SIX FORKS ROAD, SUITE 200 RALEIGH, NORTH CAROLINA 27609 NC License No. 0-1954</small>	

CLEARING AND GRUBBING
EROSION CONTROL FOR
CONSTRUCTION SHEET 11

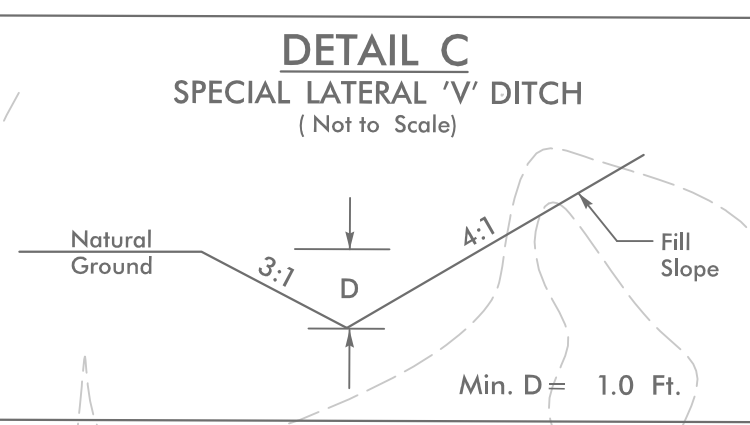
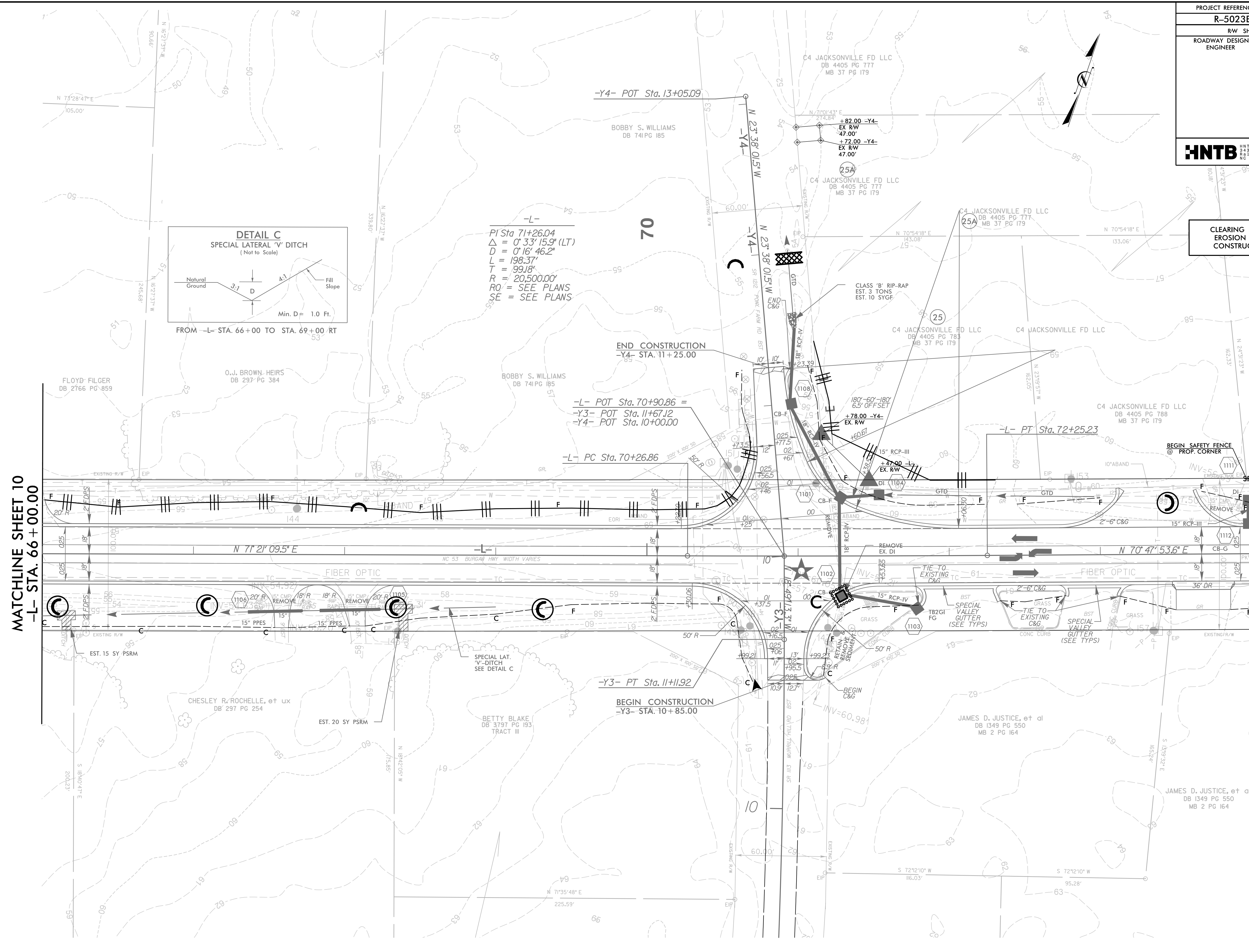

-L-
 PI Sta 71+26.04
 $\Delta = 0^{\circ} 33' 15.9''$ (LT)
 $D = 0^{\circ} 16' 46.2''$
 $L = 198.37'$
 $T = 99.18'$
 $R = 20,500.00'$
 RO' = SEE PLANS
 SE = SEE PLANS

FROM -L- STA. 66+00 TO STA. 69+00 RT

-L- POT Sta. 70+90.86 =
 -Y3- POT Sta. 11+67.12
 -Y4- POT Sta. 10+00.00

-L- PC Sta. 70+26.86

-L- PT Sta. 72+25.23

-Y3- PT Sta. 11+11.92
 BEGIN CONSTRUCTION
 -Y3- STA. 10+85.00

MATCHLINE SHEET 10
 -L- STA. 66+00.00

MATCHLINE SHEET 12
 -L- STA. 74+00.00

REVISIONS

8/17/99

4:08:48 PM
 R:\023B\C-eg.psh_11.dgn
 HNTB