

- ① **DETOUR** M4-8 24" X 12"
EAST M3-2 24" X 12"
53 M1-5
→ M6-1 21" X 15"
- ② **DETOUR** M4-8 24" X 12"
EAST M3-2 24" X 12"
53 M1-5
← M6-1 L 21" X 15"
- ③ **DETOUR** M4-8 24" X 12"
EAST M3-2 24" X 12"
53 M1-5
↶ M5-1 21" X 15"
- ④ **DETOUR** M4-8 24" X 12"
WEST M3-4 24" X 12"
53 M1-5
→ M6-1 21" X 15"
- ⑤ **DETOUR** M4-8 24" X 12"
WEST M3-4 24" X 12"
53 M1-5
← M6-1 L 21" X 15"
- ⑥ **DETOUR** M4-8 24" X 12"
WEST M3-4 24" X 12"
53 M1-5
↷ M5-1 R 21" X 15"
- ⑦ **END
DETOUR** M4-8 A 24" X 18"

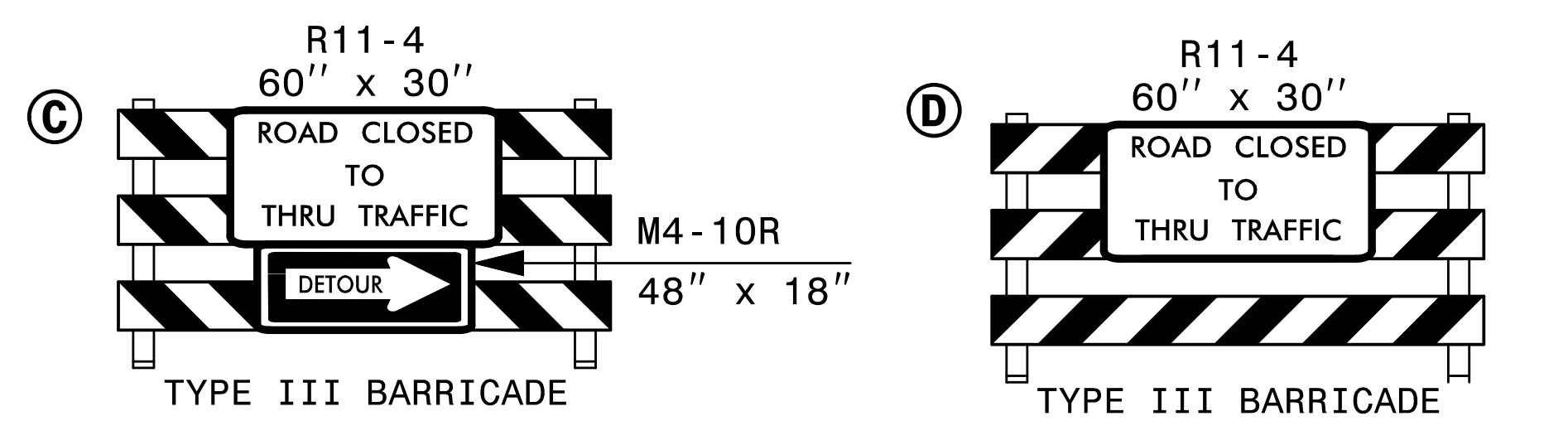
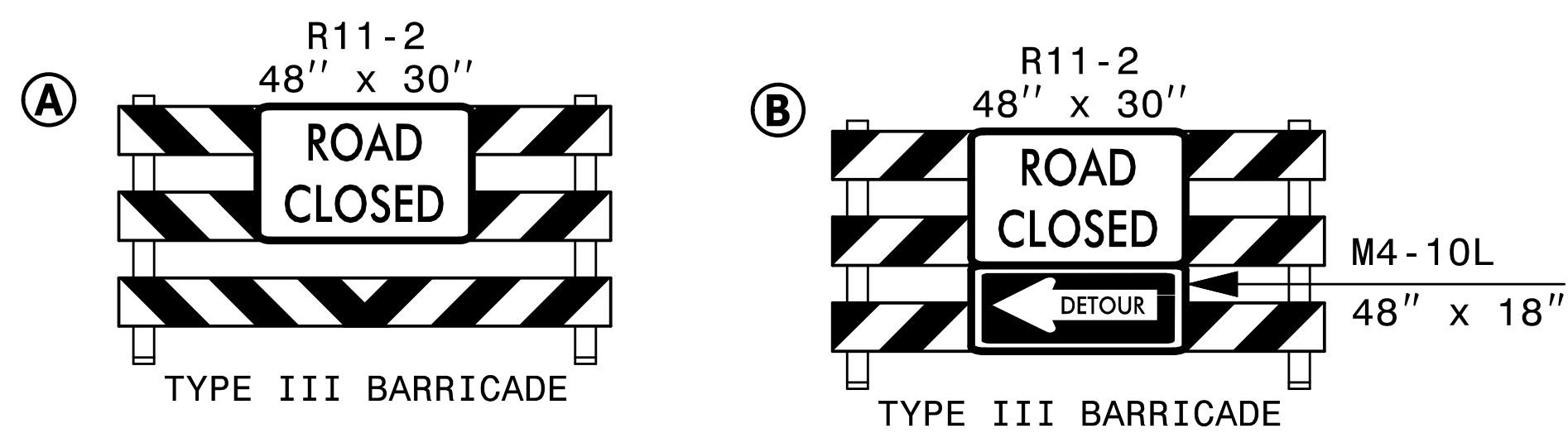

E

MESSAGE NO. 1	MESSAGE NO. 2
NC 53 CLOSED AHEAD	DETOUR NEXT RIGHT/LEFT

CHANGEABLE MESSAGE SIGN

* F

MESSAGE NO. 1	MESSAGE NO. 2
NC 53 TO BE CLOSED	XX/XX/XX TO XX/XX/XX

CHANGEABLE MESSAGE SIGN

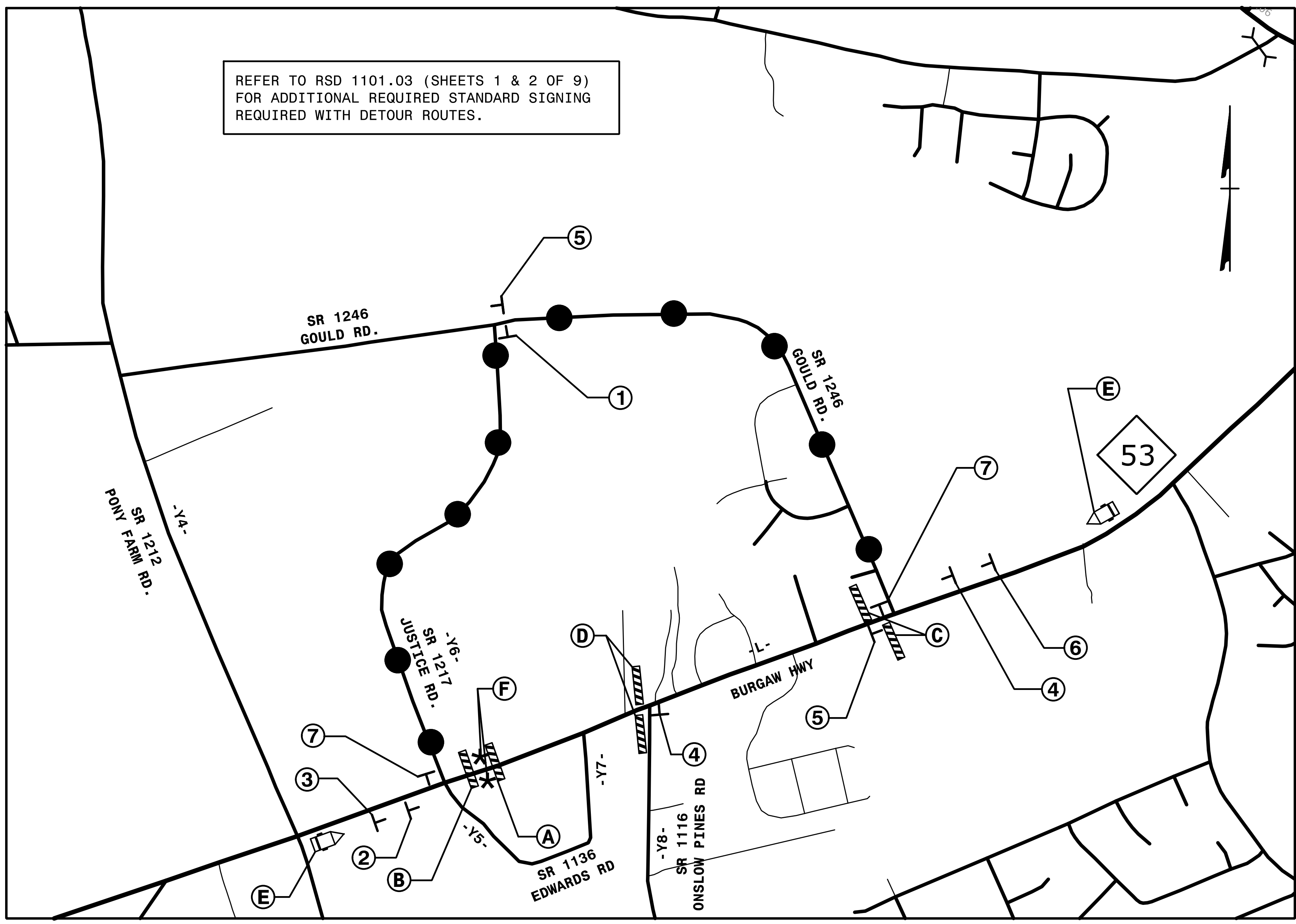

DETOUR USED IN AREA 2, PHASE I, STEP 8 FOR BOX CULVERT REPLACEMENT

NOTE: REFER TO ROADWAY PLANS FOR DETOUR ROUTE IMPROVEMENT DETAILS.

* TWO WEEKS PRIOR TO CLOSURE, USE CMS BOARDS TO ALERT MOTORIST OF UPCOMING ROAD CLOSURE. PLACE BOARDS AT POINT OF CLOSURE OR AS DIRECTED BY THE ENGINEER (UP TO 1/2 MILE FROM CLOSURE). RELOCATE BOARDS AS SHOWN WHEN CLOSURE IS IMPLEMENTED.

HNTB HNTB NORTH CAROLINA, P.C.
 343 E. SIX FORKS ROAD, SUITE 200
 RALEIGH, NORTH CAROLINA 27609
 NC LICENSE NO: C-1554

DOCUMENT NOT CONSIDERED FINAL UNLESS ALL SIGNATURES COMPLETED

APPROVED BY: Rhonda B. Early
 ENGINEER
 SEAL 023521
 DATE: 9/22/2016

DIVISION OF HIGHWAYS
 STATE OF NORTH CAROLINA
 DEPARTMENT OF TRANSPORTATION
 WORK ZONE TRAFFIC CONTROL

TRANSPORTATION MANAGEMENT PLAN
 DETOUR #3
 -L- FROM -Y6- TO GOULD RD

...NR5023BC...TMP_02Bdetour.dgn

8/17/99
 REVISIONS
 9/22/2016
 12:56:48 PM
 R-5023BC...TMP_02Bdetour.dgn
 QA/QC STAGE:
 REVIEW:
 CONCUR:
 REVISE:
 VERIFY: