

SURVEY CONTROL SHEET R-5023B

PROJECT REFERENCE NO.	SHEET NO.
R-5023B	1C-1
Location and Surveys	

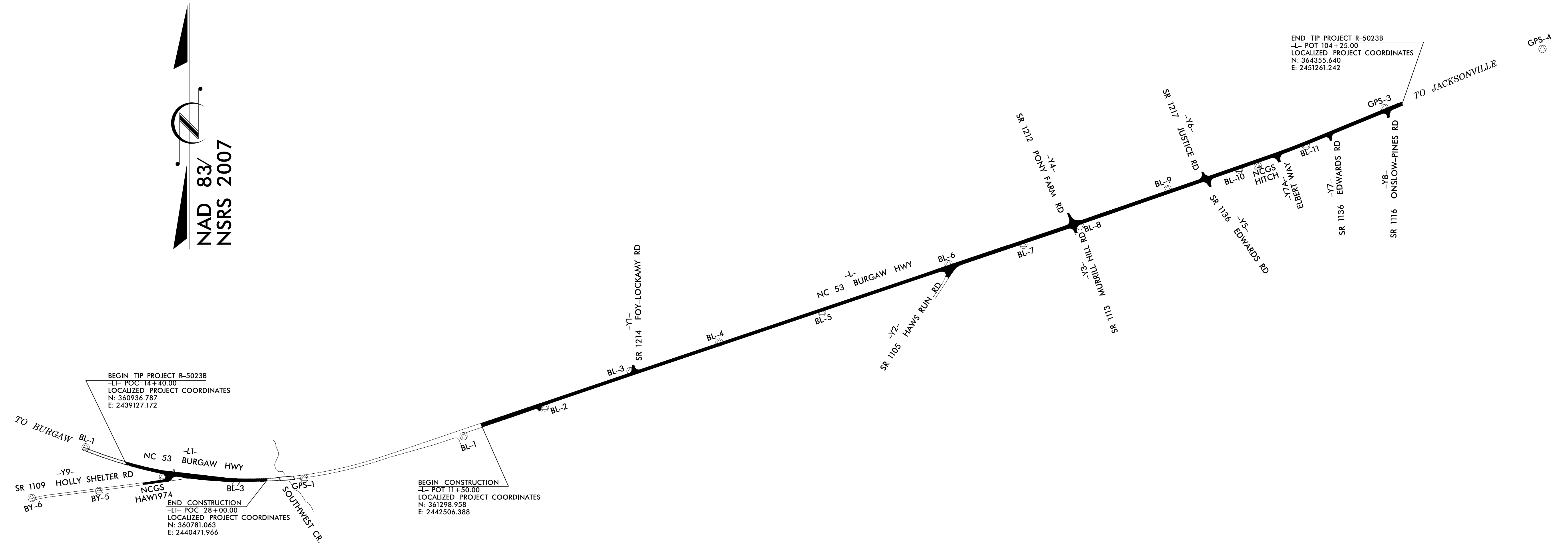
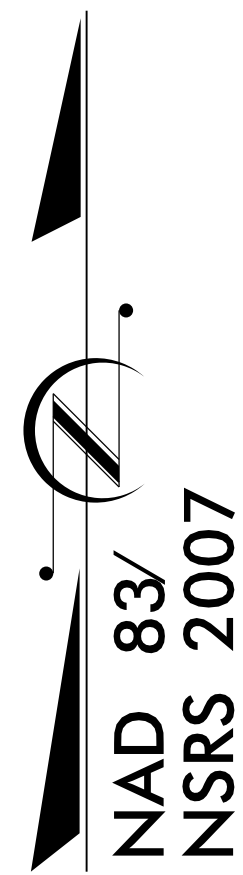

BEGIN TIP PROJECT R-5023B
 -L- POC 14+40.00
 LOCALIZED PROJECT COORDINATES
 N: 360936.787
 E: 2439127.172

BEGIN CONSTRUCTION
 -L- POT 11+50.00
 LOCALIZED PROJECT COORDINATES
 N: 361298.958
 E: 2442506.388

END TIP PROJECT R-5023B
 -L- POT 104+25.00
 LOCALIZED PROJECT COORDINATES
 N: 364355.640
 E: 2451261.242

DATUM DESCRIPTION

THE LOCALIZED COORDINATE SYSTEM DEVELOPED FOR THIS PROJECT IS BASED ON THE STATE PLANE COORDINATES ESTABLISHED BY NCDOT FOR MONUMENT "BL-1"

WITH NAD 83/NSRS 2007 STATE PLANE GRID COORDINATES OF
 NORTHING: 361194.826(ft) EASTING: 2442336.952 (ft)
 ELEVATION: 33.03(ft)

THE AVERAGE COMBINED GRID FACTOR USED ON THIS PROJECT (GROUND TO GRID) IS: 0.999916540

THE N.C. LAMBERT GRID BEARING AND LOCALIZED HORIZONTAL GROUND DISTANCE FROM "BL-1" TO -L1- STATION 14+40.00 IS
 S 85°24'13.7" W 3220.14'

ALL LINEAR DIMENSIONS ARE LOCALIZED HORIZONTAL DISTANCES
 VERTICAL DATUM USED IS NAVD 88

NOTES:

1. THE CONTROL DATA FOR THIS PROJECT CAN BE FOUND ELECTRONICALLY BY SELECTING PROJECT CONTROL DATA AT:
[HTTPS://CONNECT.NCDOT.GOV/RESOURCES/LOCATION](https://connect.ncdot.gov/resources/location)
 THE FILES TO BE FOUND ARE AS FOLLOWS:
 R5023B_LS_CONTROL.TXT
- SITE CALIBRATION INFORMATION HAS NOT BEEN PROVIDED FOR THIS PROJECT. IF FURTHER INFORMATION IS NEEDED, PLEASE CONTACT THE LOCATION AND SURVEYS UNIT.
- ⊕ INDICATES GEODETIC CONTROL MONUMENTS USED OR SET FOR HORIZONTAL PROJECT CONTROL BY THE NCDOT LOCATION AND SURVEYS UNIT.
 PROJECT CONTROL ESTABLISHED USING GLOBAL POSITIONING SYSTEM.
 NETWORK ESTABLISHED FROM NCGS REAL TIME NETWORK

NOTE: DRAWING NOT TO SCALE

07-Nov-2016 12:00
 C:\Users\jgibson\Documents\Projects\Roadway\Task Order 02 - NC 53\Roadway\Proj\R5023B.LS.1C-1.dgn
 6/2/99
 Environmental Outsourcing