

PHASING DIAGRAM

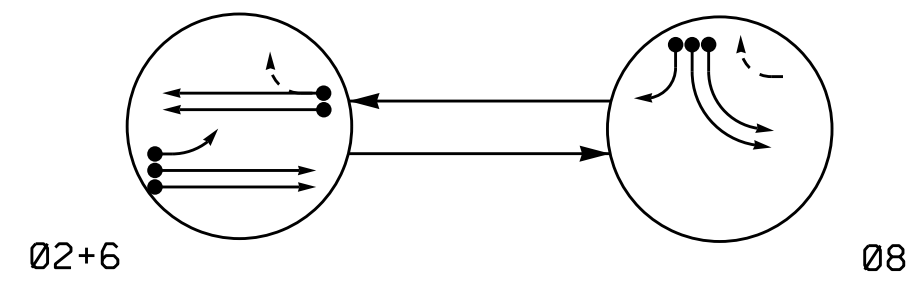

PHASING DIAGRAM DETECTION LEGEND

- DETECTED MOVEMENT
- ← UNDETECTED MOVEMENT (OVERLAP)
- UNSIGNALIZED MOVEMENT
- PEDESTRIAN MOVEMENT

SIGNAL FACE	PHASE		
	2	6	8
21, 22	G	R	Y
61, 62	G	R	Y
81	R	G	R
82, 83	R	←	→
84	R	→	R

SIGNAL FACE I.D.

All Heads L.E.D.

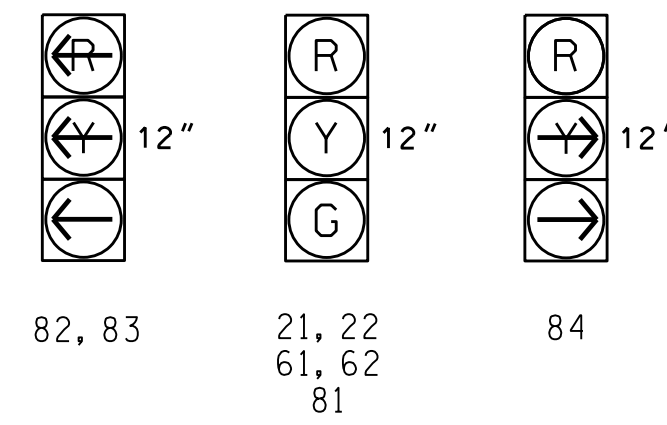

LOOP	SIZE (FT)	DISTANCE FROM STOPBAR (FT)	TURNS	NEW LOOP	DETECTOR PROGRAMMING						SYSTEM LOOP	NEW CARD
					PHASE	CALLING	EXTENSION	FULL TIME DELAY	STRETCH TIME	DELAY TIME		
2A	6X6	420	5	Y	2	Y	Y	-	-	-	-	-
2B	6X6	420	5	Y	2	Y	Y	-	-	-	-	-
6A	6X6	420	5	Y	6	Y	Y	-	-	-	-	-
6B	6X6	420	5	Y	6	Y	Y	-	-	-	-	-
6C	6X40	+5	2-4-2	Y	6	Y	Y	-	-	-	-	Y
8A	6X40	0	2-4-2	Y	8	Y	Y	-	-	-	-	-
8B	6X40	0	2-4-2	Y	8	Y	Y	-	-	-	-	-
8C	6X40	+5	2-4-2	Y	8	Y	Y	-	-	15	-	-

2 Phase Fully Actuated Isolated

NOTES

- Refer to "Roadway Standard Drawings NCDOT" dated January 2012 and "Standard Specifications for Roads and Structures" dated January 2012.
- Do not program signal for late night flashing operation unless otherwise directed by the Engineer.
- Run all lead-in cable overhead on existing utility poles where possible.
- Set all detector units to presence mode.

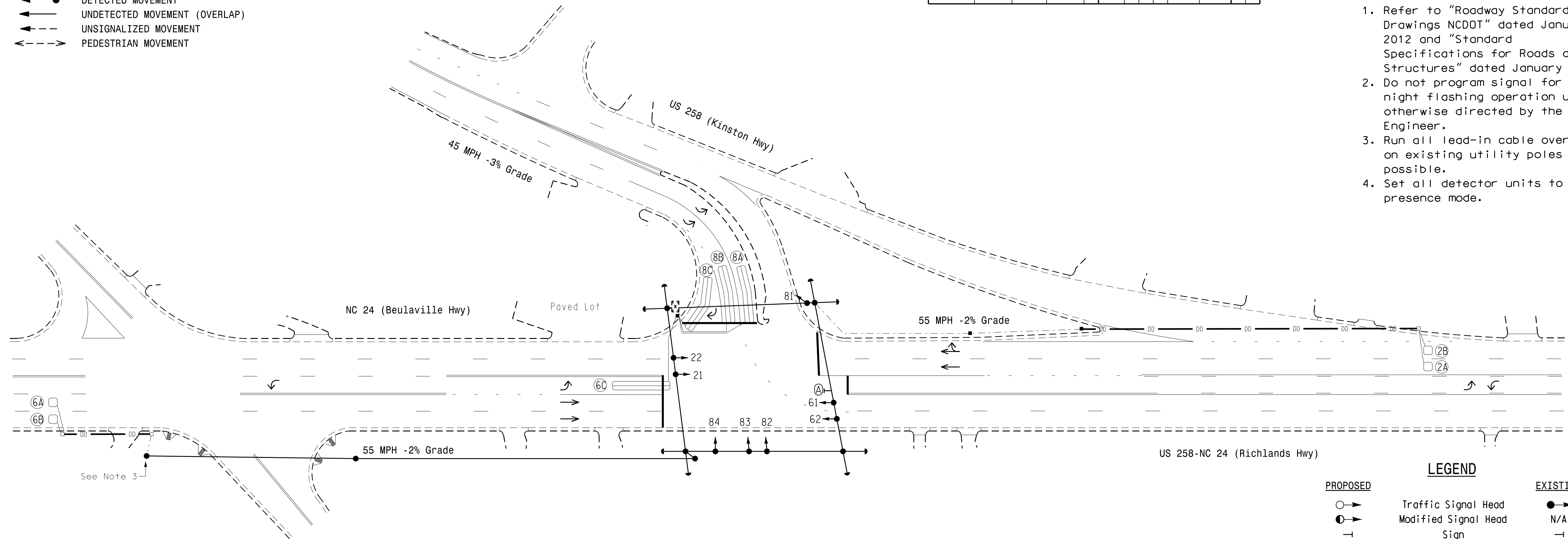

FEATURE	PHASE		
	2	6	8
Min Green 1 *	14	14	7
Extension 1 *	6.0	6.0	2.0
Max Green 1 *	90	90	25
Yellow Clearance	5.4	5.4	3.0
Red Clearance	1.1	1.2	2.8
Red Revert	-	-	-
Walk 1 *	-	-	-
Don't Walk 1	-	-	-
Seconds Per Actuation *	1.8	1.8	-
Max Variable Initial *	46	46	-
Time Before Reduction *	15	15	-
Time To Reduce *	30	30	-
Minimum Gap	3.4	3.4	-
Recall Mode	MIN RECALL	MIN RECALL	-
Vehicle Call Memory	YELLOW	YELLOW	-
Dual Entry	-	-	-
Simultaneous Gap	ON	ON	ON

* These values may be field adjusted. Do not adjust Min Green and Extension times for phases 2 and 6 lower than what is shown. Min Green for all other phases should not be lower than 4 seconds.

LEGEND

- | PROPOSED | EXISTING |
|----------|----------|
| ○ | ● |
| ○ | N/A |
| ⊥ | ⊥ |
| ⊥ | ⊥ |
| ○ | ○ |
| ○ | ○ |
| ⊗ | ⊗ |
| □ | □ |
| --- | --- |
| N/A | --- |
| → | → |
| --- | N/A |
| ⊙ | ⊙ |

Signal Upgrade

Prepared In the Offices of:

750 N. Greenfield Pkwy, Garner, NC 27529

US 258-NC 24 (Richlands Hwy) at US 258 (Kinston Hwy) / NC 24 (Beulaville Hwy)

Division 3 Onslow County Richlands

PLAN DATE: February 2016 REVIEWED BY: PLA

PREPARED BY: Devin Smith REVIEWED BY:

DOCUMENT NOT CONSIDERED FINAL UNLESS ALL SIGNATURES COMPLETED

SEAL

4/21/2016

SIG. INVENTORY NO. 03-0261

201608-2016_08-159
 S:\MT\2550\15_Signal\Signal Design\Section\Eastern Region\03-0261\03-0261_Sig.dwg, 2016madd.dgn
 d:\sm\1188