

5/28/99

PROJECT REFERENCE NO. R-3826	SHEET NO. 19
ROADWAY DESIGN ENGINEER GARY R. LOVERING 15842016 025873 ENGINEER GARY R. LOVERING	HYDRAULICS ENGINEER JAMES R. REE 11/88/016 031986 ENGINEER JAMES R. REE

DITCH LEGEND

LEFT DITCH - - - - -

RIGHT DITCH - - - - -

**DOCUMENT NOT CONSIDERED FINAL
UNLESS ALL SIGNATURES COMPLETED**

PI = 106+00.00
EL = 79.18'
VC = 400'
K = 349

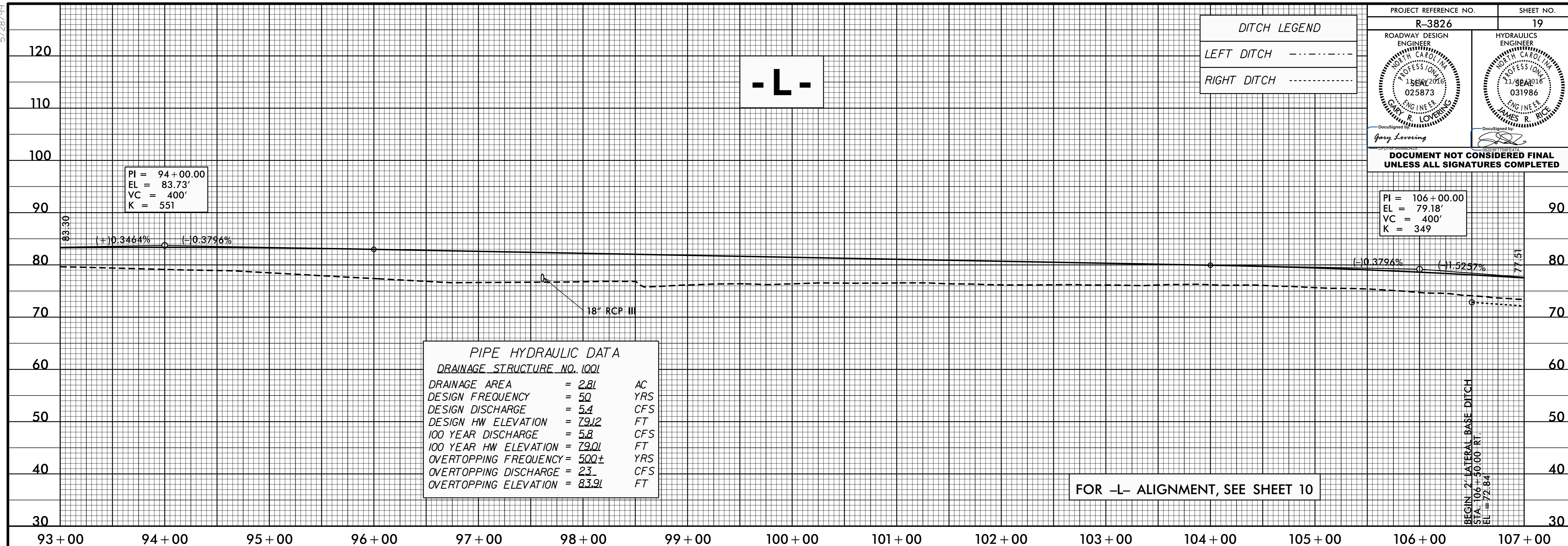

PIPE HYDRAULIC DATA
DRAINAGE STRUCTURE NO. 1001

DRAINAGE AREA	= 2.81	AC
DESIGN FREQUENCY	= 50	YRS
DESIGN DISCHARGE	= 5.4	CFS
DESIGN HW ELEVATION	= 79.12	FT
100 YEAR DISCHARGE	= 5.8	CFS
100 YEAR HW ELEVATION	= 79.01	FT
OVERTOPPING FREQUENCY	= 500±	YRS
OVERTOPPING DISCHARGE	= 23	CFS
OVERTOPPING ELEVATION	= 83.91	FT

FOR -L- ALIGNMENT, SEE SHEET 10

BEGIN 2" LATERAL BASE DITCH
STA. 106+30.00 RT.
EL = 72.84

22-NOV-2016 10:56 03826.Rdy.pfl.psh.19.dgn

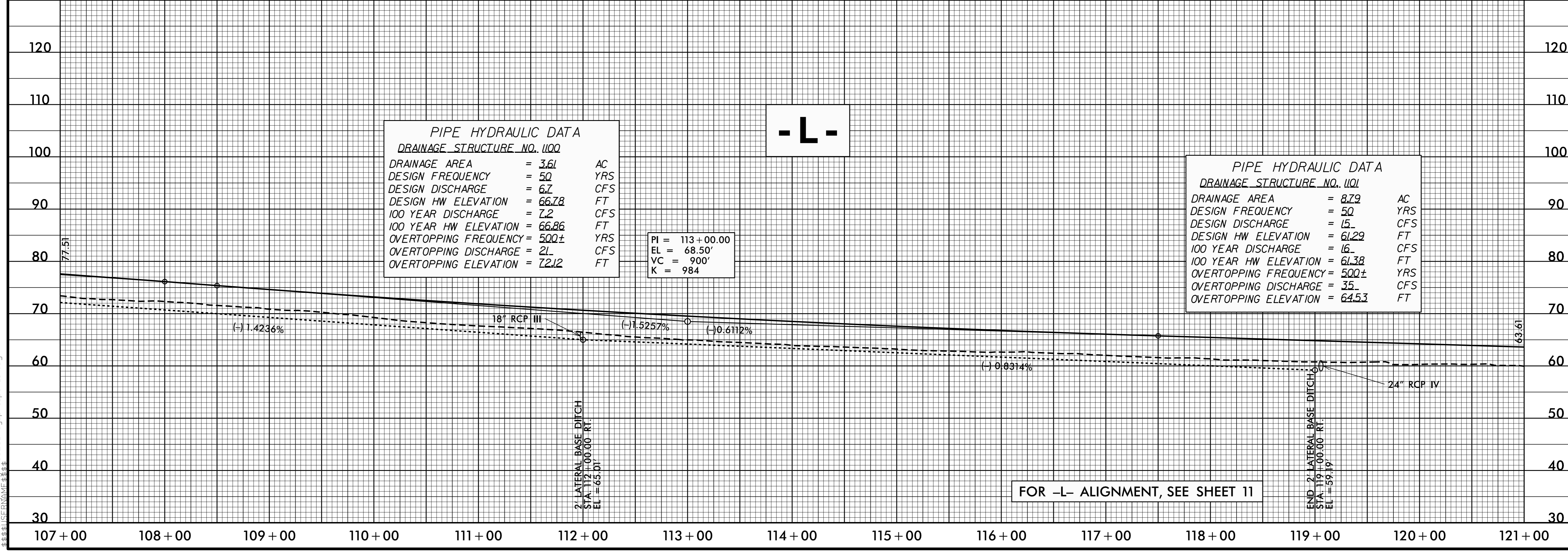

PIPE HYDRAULIC DATA
DRAINAGE STRUCTURE NO. 1100

DRAINAGE AREA	= 3.61	AC
DESIGN FREQUENCY	= 50	YRS
DESIGN DISCHARGE	= 6.7	CFS
DESIGN HW ELEVATION	= 66.78	FT
100 YEAR DISCHARGE	= 7.2	CFS
100 YEAR HW ELEVATION	= 66.86	FT
OVERTOPPING FREQUENCY	= 500±	YRS
OVERTOPPING DISCHARGE	= 21	CFS
OVERTOPPING ELEVATION	= 72.12	FT

PI = 113+00.00
EL = 68.50'
VC = 900'
K = 984

PIPE HYDRAULIC DATA
DRAINAGE STRUCTURE NO. 1101

DRAINAGE AREA	= 8.79	AC
DESIGN FREQUENCY	= 50	YRS
DESIGN DISCHARGE	= 15	CFS
DESIGN HW ELEVATION	= 61.29	FT
100 YEAR DISCHARGE	= 16	CFS
100 YEAR HW ELEVATION	= 61.38	FT
OVERTOPPING FREQUENCY	= 500±	YRS
OVERTOPPING DISCHARGE	= 35	CFS
OVERTOPPING ELEVATION	= 64.53	FT

FOR -L- ALIGNMENT, SEE SHEET 11

END 2" LATERAL BASE DITCH
STA. 119+00.00 RT.
EL = 59.19