

SURVEY CONTROL SHEET B-5398 FINAL

PROJECT REFERENCE NO. B-5398	SHEET NO. 1C-1
Location and Surveys	

BL	POINT	DESC.	NORTH	EAST	ELEVATION	L STATION	OFFSET
1	BL-1		714339.7463	1272580.4496	1002.46	11+57.53	13.42 RT
2	BL-2		714939.1035	1272679.0848	977.76	17+63.29	16.82 RT
3	BL-3		715501.1480	1272724.2726	991.89	23+24.55	17.36 LT
GPS1	B-5398-1		713521.9030	1272341.7500	1044.34	OUTSIDE PROJECT LIMITS	
GPS2	B-5398-2		713445.9000	1272775.3630	1033.07	OUTSIDE PROJECT LIMITS	

.....
 BM1 ELEVATION = 998.94
 N 714382 E 1272559
 L STATION 11+92.62 18.83' LEFT
 BOLT ON BOTTOM FLANGE ON BACK OF FIRE
 HYDRANT

 BM2 ELEVATION = 988.73
 N 715456 E 1272715
 L STATION 22+80.29 18.37' LEFT
 BOLT ON BOTTOM FLANGE ON BACK OF FIRE
 HYDRANT

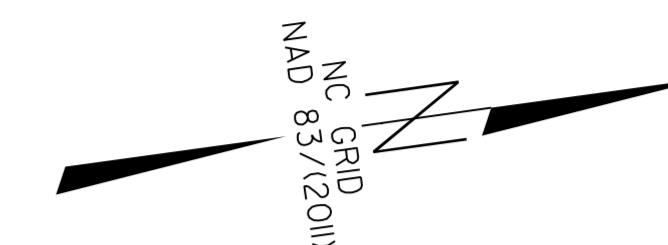

**NCDOT GPS MONUMENT (B5398-1)
LOCALIZED PROJECT COORDINATES**

N = 713521.9030
E = 1272341.7500

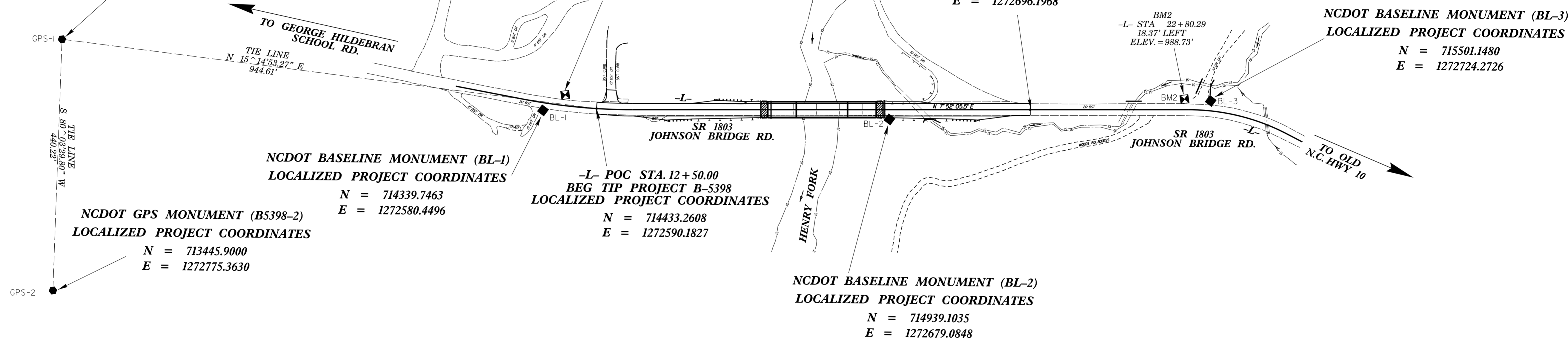

NOTES:

1. THE CONTROL DATA FOR THIS PROJECT CAN BE FOUND ELECTRONICALLY BY SELECTING PROJECT CONTROL DATA AT:
[HTTP://WWW.DOH.DOT.STATE.NC.US/PRECONSTRUCT/HIGHWAY/LOCATION/PROJECT/](http://www.doh.dot.state.nc.us/preconstruct/highway/location/project/)

THE FILES TO BE FOUND ARE AS FOLLOWS:
B5398_LS_CONTROL.TXT

SITE CALIBRATION INFORMATION HAS NOT BEEN PROVIDED FOR THIS PROJECT. IF FURTHER INFORMATION IS NEEDED, PLEASE CONTACT THE LOCATION AND SURVEYS UNIT.

- INDICATES GEODETIC CONTROL MONUMENTS USED OR SET FOR HORIZONTAL PROJECT CONTROL BY THE NCDOT LOCATION AND SURVEYS UNIT.
PROJECT CONTROL ESTABLISHED USING GLOBAL POSITIONING SYSTEM.
NETWORK ESTABLISHED FROM NGS ONLINE POSITIONING SERVICE (OPUS)

DATUM DESCRIPTION

THE LOCALIZED COORDINATE SYSTEM DEVELOPED FOR THIS PROJECT IS BASED ON THE STATE PLANE COORDINATES ESTABLISHED BY NCDOT FOR MONUMENT "B5398-1" WITH NAD 83/2011 STATE PLANE GRID COORDINATES OF
 NORTHING: 713521.9030(ft) EASTING: 1272341.7500(ft)
 ELEVATION: 1044.34(ft)
 THE AVERAGE COMBINED GRID FACTOR USED ON THIS PROJECT (GROUND TO GRID) IS: 0.999834166
 THE N.C. LAMBERT GRID BEARING AND LOCALIZED HORIZONTAL GROUND DISTANCE FROM "B5398-1" TO -L- STATION 12+50.00 IS
 N 15°14'53.27" E 944.61'
 ALL LINEAR DIMENSIONS ARE LOCALIZED HORIZONTAL DISTANCES
 VERTICAL DATUM USED IS NAVD 88

NOTE: DRAWING NOT TO SCALE

6/2/09
10/19/2016
I:\Roadway\Proj\B5398_1s_1C-1.dgn
USER:MMF