

**SECOND FLOOR LAYOUT**  
SCALE: 1/2" = 1'-0"

**SYMBOL:**  
 FLOOR PENETRATION (SEE NOTE 5)

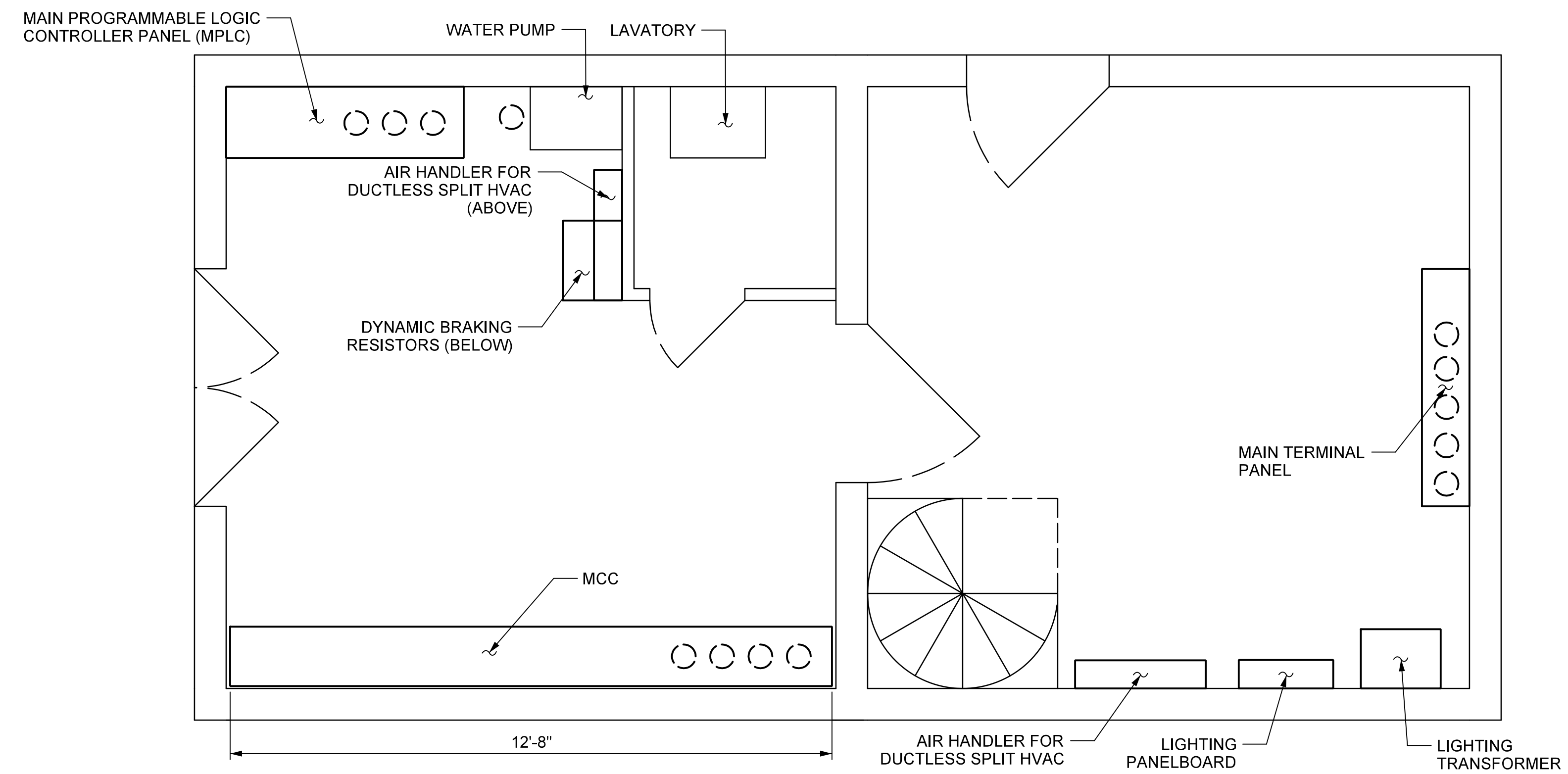

**FIRST FLOOR LAYOUT**  
SCALE: 1/2" = 1'-0"

- NOTES:**
1. THE CONTRACTOR SHALL VERIFY ALL FIELD CONNECTIONS PRIOR TO INSTALLATION OF ANY ELECTRICAL EQUIPMENT. ANY ADDITIONAL WORK REQUIRED TO ADJUST AND MODIFY THE ELECTRICAL WORK SPECIFIED DUE TO THE FIELD CONDITIONS SHALL BE COMPLETED AT NO ADDITIONAL COST TO NCDOT.
  2. THE CONTRACTOR SHALL REFER TO DRAWINGS E-43-E-47 FOR CONDUIT AND WIRE REQUIREMENTS.
  3. THE CONTRACTOR SHALL REMOVE AND DISPOSE ALL EXISTING EQUIPMENT WHICH IS TO BE REPLACED AS SPECIFIED.
  4. COORDINATE ALL WORK IN CONTROL HOUSE WITH ARCHITECTURAL INTERIOR RENOVATIONS.
  5. THE CONTRACTOR WILL BE REQUIRED TO MAKE FLOOR PENETRATIONS AS REQUIRED ON THIS SHEET FOR CONDUIT ROUTINGS TO ELECTRICAL ENCLOSURES. REFER TO SHEET E-45 FOR CONDUIT DIAMETERS.

PROJECT NO. B-5936  
TYRRELL COUNTY  
 BRIDGE NO: 7

STATE OF NORTH CAROLINA  
 DEPARTMENT OF TRANSPORTATION  
 RALEIGH

**CONTROL HOUSE:  
 ELECTRICAL EQUIPMENT  
 LAYOUT**

**ALLIGATOR RIVER  
 SWING SPAN**

DocuSigned by:  
 Scott Reynolds  
 BFECS720F9F148D...  
 9/14/2016

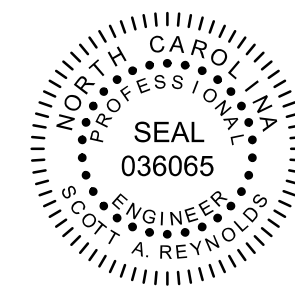

DRAWN BY: \_QIV DATE: 8/8/2016  
 CHECKED BY: \_MJT DATE: 8/8/2016  
 DESIGN ENGINEER OF RECORD: \_CHS DATE: 8/8/2016

DWG NUMBER	TOTAL DWGS
46	90

DOCUMENT NOT CONSIDERED  
 FINAL UNLESS ALL  
 SIGNATURES COMPLETED

REVISIONS						SHEET NO.
NO	BY	DATE	NO	BY	DATE	E-30
1			3			TOTAL SHEETS
2			4			51

\*\*\*\*\*DTG\*\*\*\*\*  
 \*\*\*\*\*DGN\*\*\*\*\*  
 \*\*\*\*\*USERNAME\*\*\*\*\*