

NOTES: ANY DEVIATION FROM OPTIONS GIVEN WILL REQUIRE PRIOR APPROVAL BY ENGINEER.

ADDITIONAL EROSION CONTROL DEVICES MAY NEED TO BE INSTALLED AS DIRECTED BY THE ENGINEER.

NOTE: PERIMETER EROSION CONTROL MEASURES SHALL BE INSTALLED DURING CLEARING AND GRUBBING PHASE.

# EROSION CONTROL PLAN

CLEARING AND GRUBBING  
EROSION CONTROL FOR  
CONSTRUCTION SHEET 04

PROJECT REFERENCE NO. 17BP.3.R.28	SHEET NO. EC-03/CONST.04
RW SHEET NO.	
ROADWAY DESIGN ENGINEER	HYDRAULICS ENGINEER

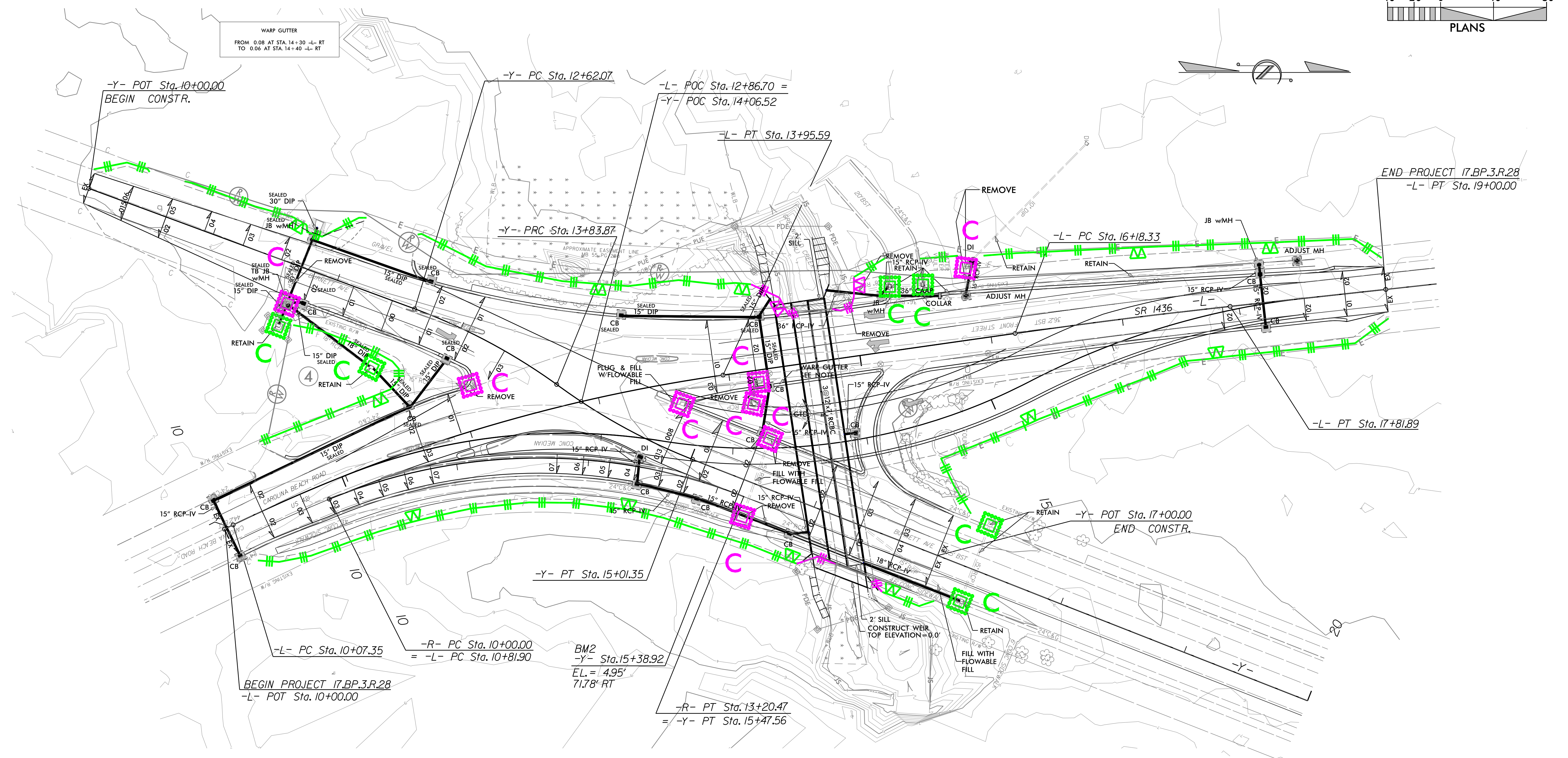
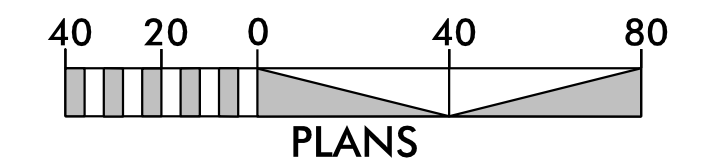

WARP GUTTER  
FROM 0.08 AT STA. 14+30 -L- RT  
TO 0.06 AT STA. 14+40 -L- RT

-Y- POT Sta. 10+00.00  
BEGIN CONSTR.

-Y- PC Sta. 12+62.07

-L- POC Sta. 12+86.70 =  
-Y- POC Sta. 14+06.52

-L- PT Sta. 13+95.59

-Y- PRC Sta. 13+83.87

-L- PC Sta. 16+18.33

END PROJECT 17.BP.3.R.28  
-L- PT Sta. 19+00.00

-L- PC Sta. 10+07.35

-R- PC Sta. 10+00.00  
-L- PC Sta. 10+81.90

BM2  
-Y- Sta. 15+38.92  
EL. = 4.95'  
71.78' RT

-R- PT Sta. 13+20.47  
-Y- PT Sta. 15+47.56

BEGIN PROJECT 17.BP.3.R.28  
-L- POT Sta. 10+00.00

-Y- POT Sta. 17+00.00  
END CONSTR.

-Y- PT Sta. 15+01.35

-L- PT Sta. 17+81.89