

12-SEP-2016 17:56 C:\p\proj\17\156\17BP.3.R.28\17BP.3.R.28-TMP-6.dgn

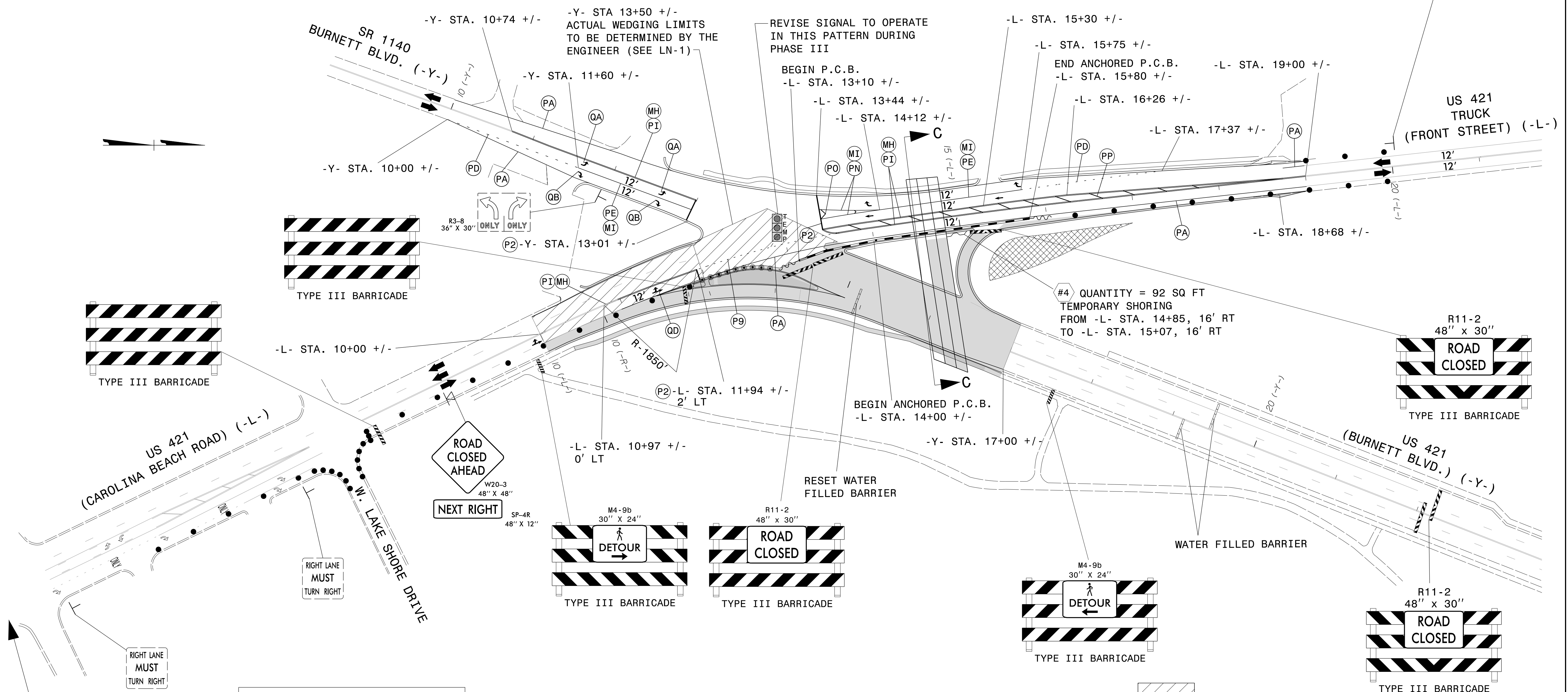

FOLLOWING THE TRAFFIC SHIFT BEGINNING MORNING OF SHIFT

NEW TRAFFIC PATTERN	USE CAUTION
---------------------	-------------

CMS '1' MESSAGE

SEE INSET 'A' THIS SHEET FOR ADDITIONAL WARNING SIGN AND CMS PLACEMENT SOUTH OF SOUTH CAROLINA AVENUE

**ATKINS** 1616 EAST MILLBROOK ROAD, SUITE 310 RALEIGH, NORTH CAROLINA 27609 (919) 876-8888 NCBEES #F-0326

APPROVED: [Signature] DATE: 10/11/2016

NORTH CAROLINA PROFESSIONAL SEAL 017586 ENGINEER J. TODD BROOKS

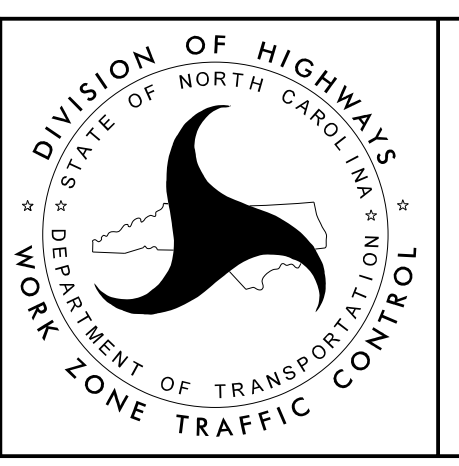

PHASE III DETAIL  
-L- FRONT ST., DETOUR -D1- & -Y- BURNETT AVE.