

R-2915C 2 @ 15' X 11' RCBC PHASING -L- 374+56
 US 221 OVER OLD FIELD CREEK
 ASHE COUNTY

HNTB HNTB NORTH CAROLINA, P.C.
 343 E. Six Forks Road, Suite 200
 Raleigh, North Carolina 27609
 NC License No: C-1554

| | |
|-----------------------|----------------|
| PROJECT REFERENCE NO. | SHEET NO. |
| R-2915C | EC-13A/CONST13 |
| RW SHEET NO. | |

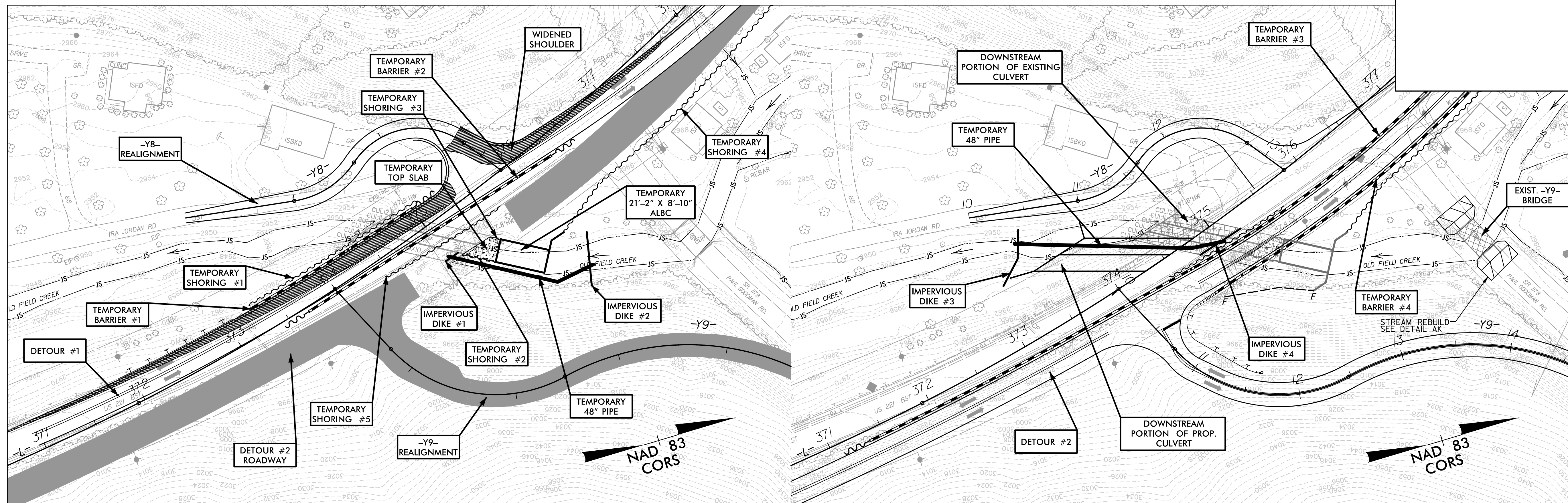

PHASE I

1. INSTALL TEMPORARY SHORING #1, WIDEN EXISTING SHOULDER AND CONSTRUCT -Y8- REALIGNMENT.
2. INSTALL TEMPORARY BARRIERS #1 & #2.
3. SHIFT TRAFFIC TO DETOUR #1.
4. INSTALL IMPERVIOUS DIKE #1 & #2 AND TEMPORARY 48" PIPE.
5. INSTALL TEMPORARY SHORING #2 & #3.
6. INSTALL TEMPORARY 21'-2" X 8'-10" ALBC.
7. INSTALL TEMPORARY TOP SLAB OVER TEMPORARY SHORING #2 & #3.
8. REMOVE IMPERVIOUS DIKE #1 & #2 AND TEMPORARY 48" PIPE.
9. CONSTRUCT REMAINDER OF TEMPORARY ALBC HEADWALL.
10. INSTALL TEMPORARY SHORING #4 & #5. CONSTRUCT DETOUR #2 ROADWAY AND -Y9- REALIGNMENT .

PHASE II

1. INSTALL TEMPORARY BARRIER #3, & #4, AND SHIFT TRAFFIC ONTO DETOUR #2.
2. REMOVE EXIST. -Y9- BRIDGE AND LAY BACK SLOPES AS SHOWN.
3. REMOVE TEMPORARY SHORING #1 AND TEMPORARY BARRIER #1 & #2.
4. REMOVE DOWNSTREAM PORTION OF THE EXISTING CULVERT AS SHOWN.
5. INSTALL IMPERVIOUS DIKE #3 & #4, AND TEMPORARY 48" PIPE AS SHOWN.
6. CONSTRUCT DOWNSTREAM PORTION OF PROP. CULVERT AND WINGWALLS AS SHOWN.

DEWATER CONSTRUCTION AREAS INTO SPECIAL STILLING BASINS AS REQUIRED.

