

R-2915C 60" SPP/ WSP PHASING -L- 302+47
 US 221 OVER UT TO OLD FIELD CREEK
 ASHE COUNTY

HNTB HNTB NORTH CAROLINA, P.C.
 343 E. Six Forks Road, Suite 200
 Raleigh, North Carolina 27609
 NC License No: C-1554

PROJECT REFERENCE NO.	SHEET NO.
R-2915C	EC-07B/CONST.7&8
RW SHEET NO.	

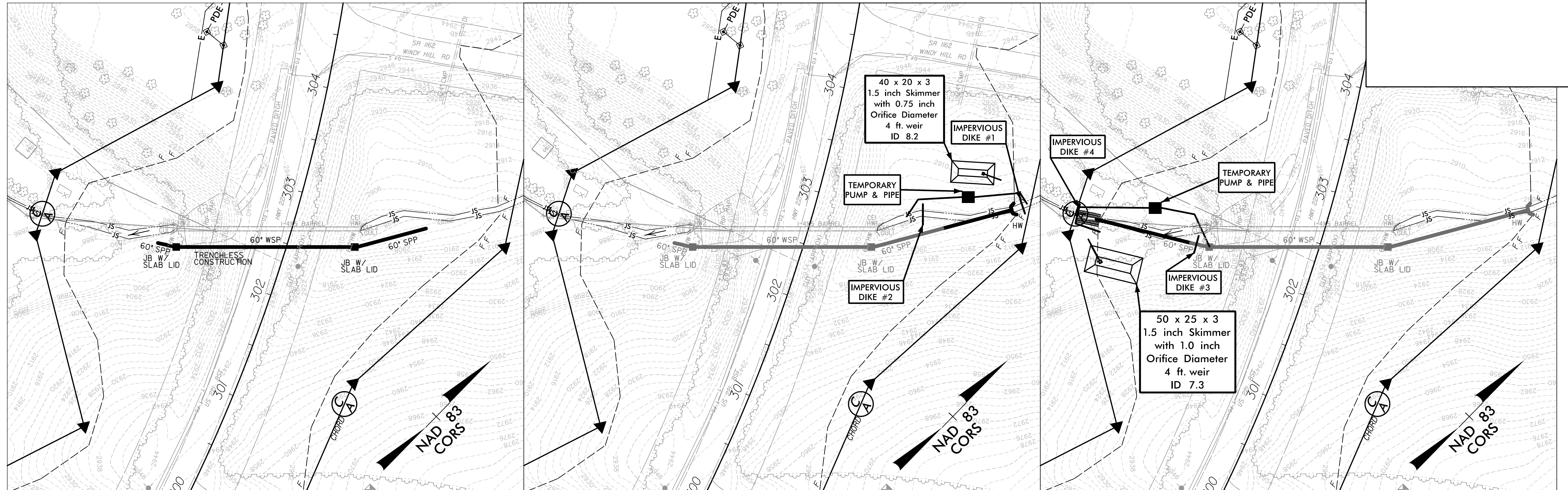

PHASE I

WHILE MAINTAINING CURRENT TRAFFIC PATTERNS.

1. INSTALL 60" WSP VIA TRENCHLESS CONSTRUCTION.
2. INSTALL UPSTREAM & DOWNSTREAM JUNCTION BOXS WITH SLAB LIDS (DON'T INSTALL TOP SLAB OF DOWNSTREAM JB UNTIL COMPLETION OF PHASE III).
3. INSTALL 64' OF UPSTREAM 60" SPP AND 16' OF DOWNSTREAM 60" SPP.

ALL CONSTRUCTION SHOULD BE COMPLETED AWAY FROM NORMAL STREAM FLOW.

PHASE II

WHILE MAINTAINING CURRENT TRAFFIC PATTERNS.

1. INSTALL IMPERVIOUS DIKES #1 & #2, PUMP, AND TEMPORARY PIPE AS SHOWN.
2. INSTALL THE REMAINDER OF THE UPSTREAM 60" SPP.
3. REMOVE IMPERVIOUS DIKES #1 & #2, PUMP, AND TEMPORARY PIPE.

DEWATER CONSTRUCTION AREAS INTO SKIMMER BASIN OR SPECIAL STILLING BASINS AS REQUIRED.

PHASE III

WHILE MAINTAINING CURRENT TRAFFIC PATTERNS.

1. INSTALL IMPERVIOUS DIKES #3 & #4, PUMP, AND TEMPORARY PIPE AS SHOWN (FROM DOWNSTREAM JUNCTION BOX).
2. INSTALL THE REMAINDER OF THE DOWNSTREAM 60" SPP.
3. REMOVE IMPERVIOUS DIKES #3 & #4, PUMP, AND TEMPORARY PIPE.
4. INSTALL TOP SLAB OF DOWNSTREAM JUNCTION BOX.
5. FILL EXISTING RBCB WITH FLOWABLE FILL.
6. CONSTRUCT PROPOSED ROADWAY IMPROVEMENTS & SHIFT TRAFFIC TO FINAL PATTERN.

DEWATER CONSTRUCTION AREAS INTO SKIMMER BASIN OR SPECIAL STILLING BASINS AS REQUIRED.