

**T.I.P.: R-2915C**

**CONTRACT:**

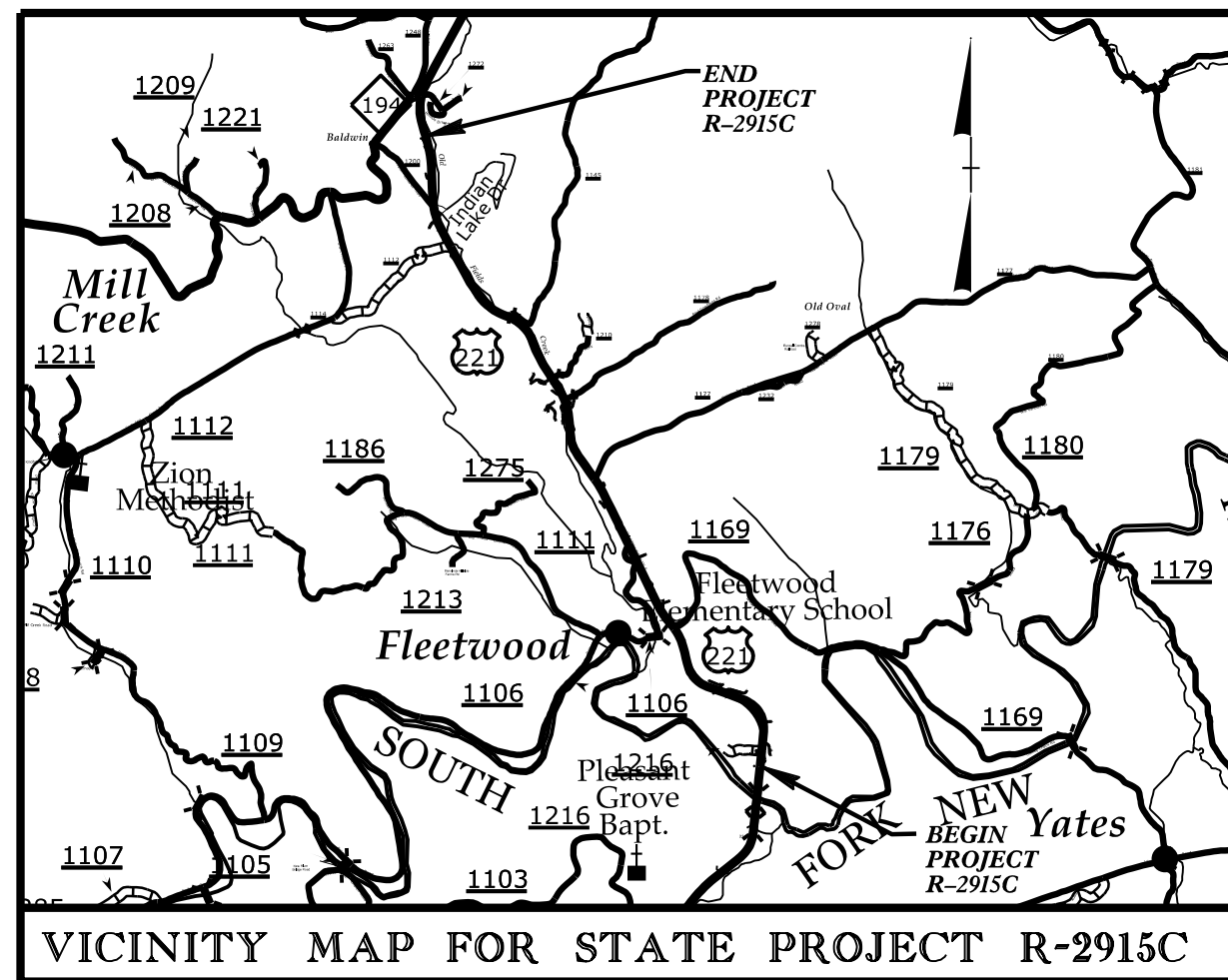

**STATE OF NORTH CAROLINA  
DEPARTMENT OF TRANSPORTATION**

**PAVEMENT MARKING PLAN  
ASHE COUNTY**

**LOCATION: US 221 FROM NORTH OF SOUTH FORK NEW RIVER  
TO SOUTH OF NC 194.**

TIP NO. R-2915C	SHEET NO. PMP-1
APPROVED: <i>Joseph Kopaskie</i> 6/29/2016	
DOCUMENT NOT CONSIDERED FINAL UNLESS ALL SIGNATURES COMPLETED	

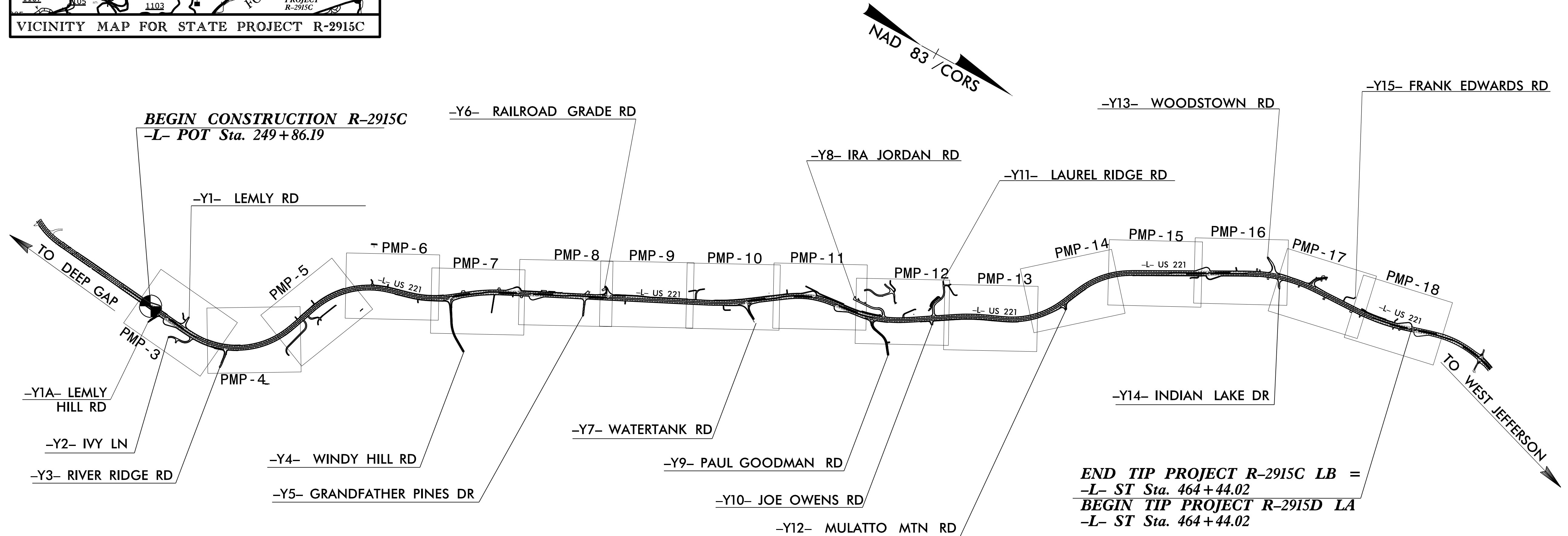

**SEPI**  
ENGINEERING & CONSTRUCTION

1025 Wade Avenue  
Raleigh, NC 27605  
Tel: 919-789-9977  
Fax: 919-789-9591  
License: C-2197

PLAN PREPARED FOR: N.C.D.O.T. SIGNING AND DELINEATION UNIT	
<u>KELVIN L. JORDAN</u>	SIGNING & DELINEATION REGIONAL ENGINEER
<u>DERRICK H. BEARD</u>	SIGNING & DELINEATION PROJECT DESIGN ENGINEER/TECHNICIAN

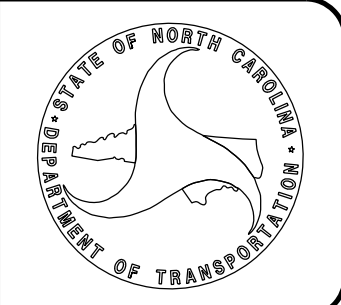

PLAN PREPARED BY: SEPI ENGINEERING & CONSTRUCTION	
<u>JOSEPH B. KOPASKIE, PE</u>	SIGNING & DELINEATION PROJECT ENGINEER
<u>RICHARD DRAYTON</u>	SIGNING & DELINEATION PROJECT DESIGN ENGINEER

<b>INDEX</b>	
SHEET NO.	DESCRIPTION
PMP-1	PAVEMENT MARKING PLAN TITLE AND INDEX SHEET
PMP-2	PAVEMENT MARKING SCHEDULE, GENERAL NOTES AND ROADWAY STANDARD DRAWING SCHEDULE SHEET
PMP-3 THRU PMP-18	PAVEMENT MARKING DETAIL