

**TIP PROJECT: R-2915C**

See Sheet 1A For Index of Sheets  
See Sheet 1B For Conventional Symbols  
See Sheet 1C-1 - 1C-3 For Survey Control Sheets

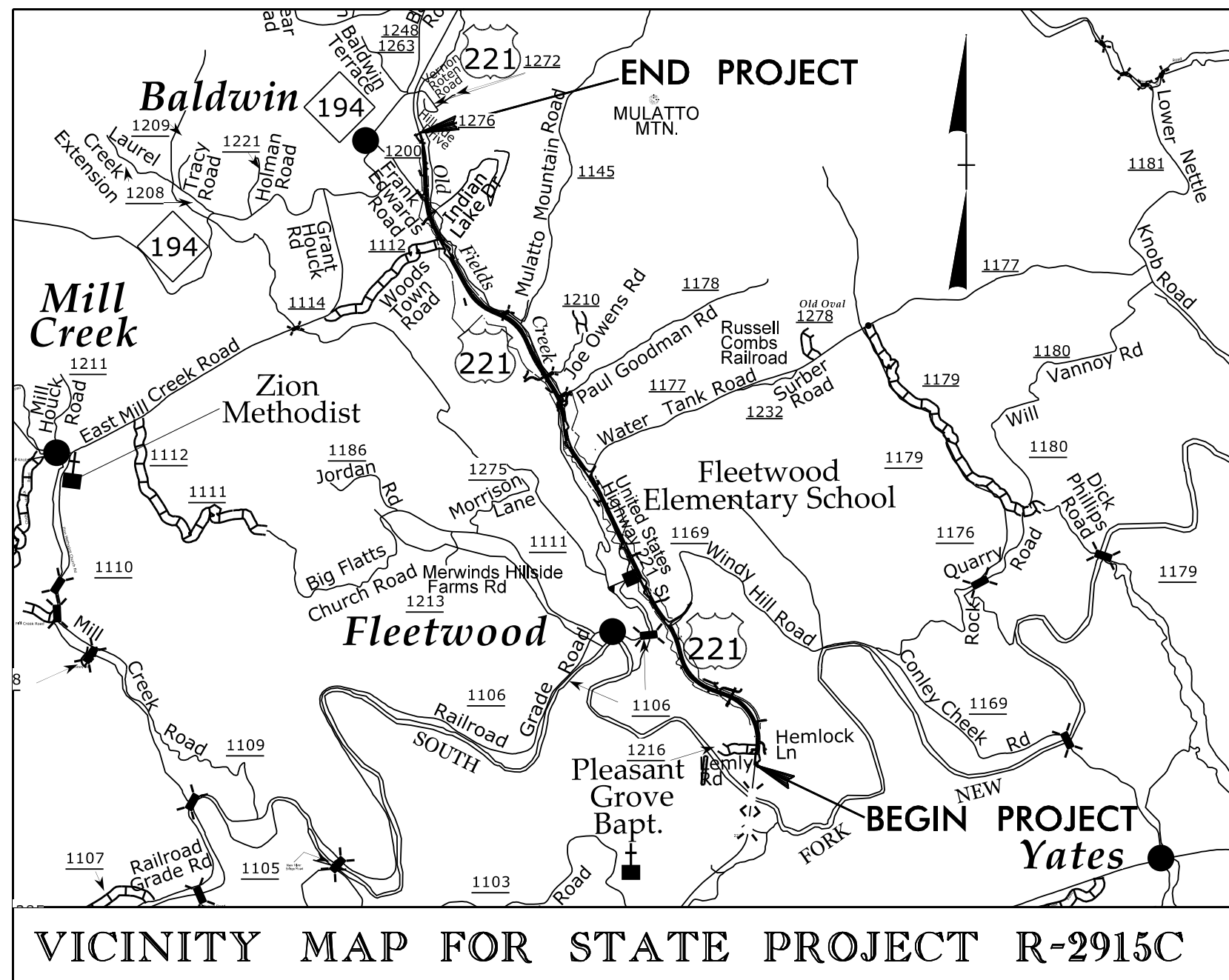

VICINITY MAP FOR STATE PROJECT R-2915C

# STATE OF NORTH CAROLINA DIVISION OF HIGHWAYS

## ASHE COUNTY

**LOCATION: US 221 FROM NORTH OF SOUTH FORK NEW RIVER  
TO SOUTH OF NC 194.**

**TYPE OF WORK: GRADING, DRAINAGE, PAVING, CULVERTS, AND  
RETAINING WALLS**

STATE	STATE PROJECT REFERENCE NO.	SHEET NO.	TOTAL SHEETS
N.C.	R-2915C	1	
STATE PROJ. NO.	F.A. PROJ. NO.	DESCRIPTION	
34518.1.4	STP-0221(41)	P.E.	
34518.2.FR3	STP-0221(41)	RW	
34518.2.FR3	STP-0221(41)	UTILITIES	
34518.3.FR3	STP-0221(41)	CONSTR.	

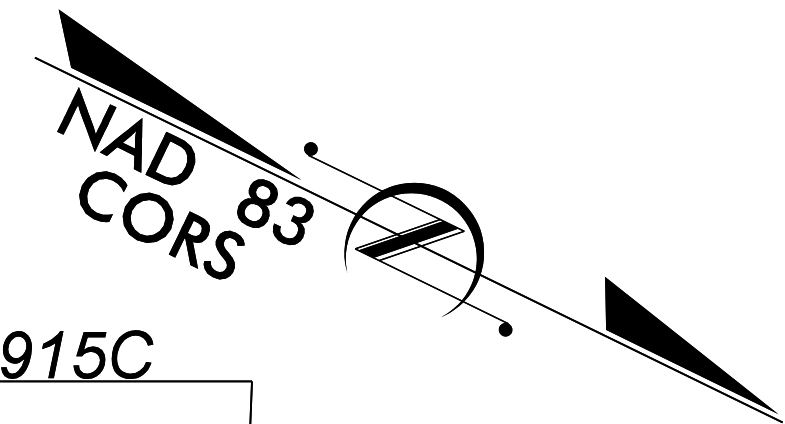

-L- STA. 464+44.02  
END TIP PROJECT R-2915C  
-L- STA. 464+44.02  
BEGIN TIP PROJECT R-2915D

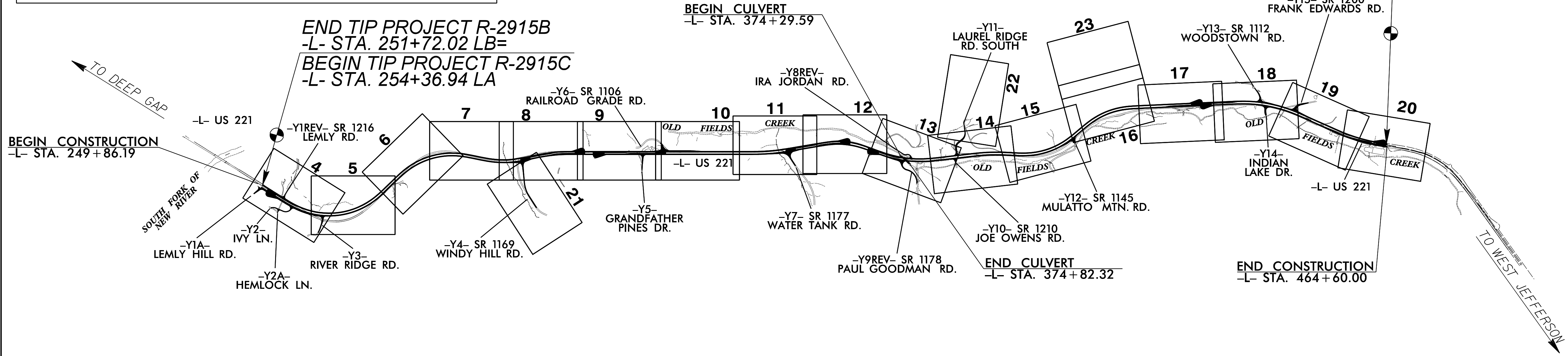

BEGIN CONSTRUCTION  
-L- STA. 249+86.19

END TIP PROJECT R-2915B  
-L- STA. 251+72.02 LB=  
BEGIN TIP PROJECT R-2915C  
-L- STA. 254+36.94 LA

END CULVERT  
-L- STA. 374+82.32

END CONSTRUCTION  
-L- STA. 464+60.00

PREPARED FOR  
DEPARTMENT OF TRANSPORTATION  
DIVISION OF HIGHWAYS  
RALEIGH, NC  
PLANS COORDINATED BY:  
Tatia L. White, PE, PLS  
Roadway Design Project Design Engineer (NCDOT)

**THIS IS A PARTIAL CONTROLLED ACCESS PROJECT WITH  
ACCESS BEING LIMITED TO POINTS SHOWN ON PLANS.**  
\*\* DESIGN EXCEPTION REQUIRED FOR MAXIMUM GRADE

DOCUMENT NOT CONSIDERED FINAL  
UNLESS ALL SIGNATURES COMPLETED

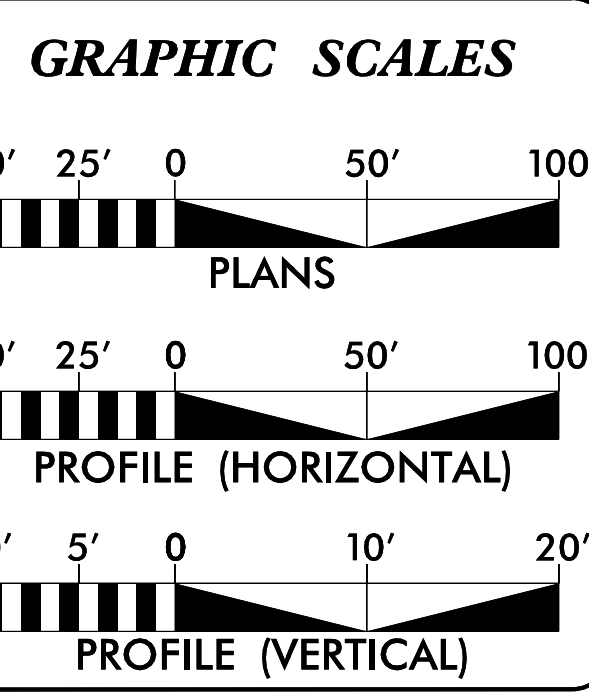

**DESIGN DATA**

ADT 2016 =	12,329
ADT 2036 =	20,615
K =	9 %
D =	60 %
T =	9 % *
V =	60 MPH**

\* = (TTST 2% + DUAL 7%)  
\*\* = (TTST 2% + DUAL 7%)

FUNC CLASS =  
RURAL ARTERIAL  
STATEWIDE TIER

**PROJECT LENGTH**

LENGTH ROADWAY TIP PROJECT R-2915C	= 3.969 Miles
LENGTH STRUCTURES TIP PROJECT R-2915C	= 0.010 Miles
TOTAL LENGTH TIP PROJECT R-2915C	= 3.979 Miles

Prepared In the Office of:

**LOCHNER**  
H. W. LOCHNER, INC.  
2840 PLAZA PLACE, SUITE 202  
RALEIGH, NC 27612  
(919) 571-7111

**HNTB**  
HNTB  
243 E SIX FORKS ROAD, SUITE 200  
RALEIGH, NC 27609

2012 STANDARD SPECIFICATIONS

**RIGHT OF WAY DATE:**  
November 21, 2014

**LETTING DATE:**  
November 15, 2016

**Brian K. Eason, PE**  
PROJECT ENGINEER

**Bill Bollman**  
PROJECT DESIGN ENGINEER

**HYDRAULICS ENGINEER**

DocuSigned by:  
**James A. Byrd**  
SIGNATURE: 23592959E54F47C... P.E. 9/7/2016

**ROADWAY DESIGN ENGINEER**

DocuSigned by:  
**Brian K. Eason**  
SIGNATURE: 0AF045AD7ACC48F... P.E. 9/1/2016

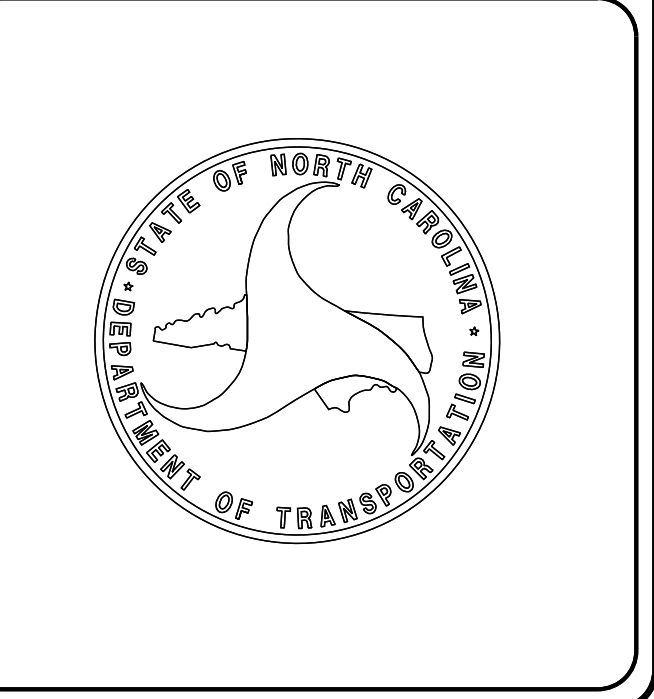

**CONTRACT: C203801**