

SURVEY CONTROL SHEET B-5546

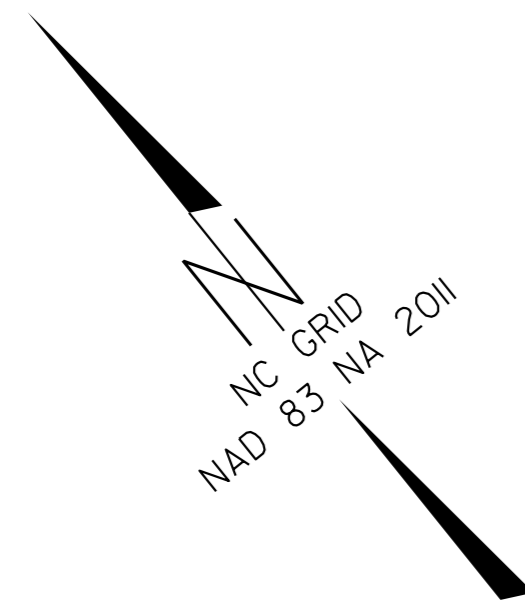

LOCALIZED PROJECT COORDINATES
 -L- STA. 11+25.00 BEGIN TIP PROJECT B-5546
 N = 742367.5941
 E = 1807154.8694

LOCALIZED PROJECT COORDINATES
 -L- STA. 17+25.00 END TIP PROJECT B-5546
 N = 742067.8834
 E = 1807664.1151

NCDOT BASELINE STATION "BL-101"
 LOCALIZED PROJECT COORDINATES
 N = 742502.5160
 E = 1807008.0030

NCDOT BASELINE STATION "BL-103"
 LOCALIZED PROJECT COORDINATES
 N = 742040.1730
 E = 1807721.3060

BMI ELEVATION = 514.36'
 N 742262 E 1807406
 L STATION 13+87.00 75' LEFT
 RR SPIKE IN BASE OF 15IN POPLAR TREE

NCDOT BASELINE STATION "BL-102"
 LOCALIZED PROJECT COORDINATES
 N = 742194.5180
 E = 1807350.2640

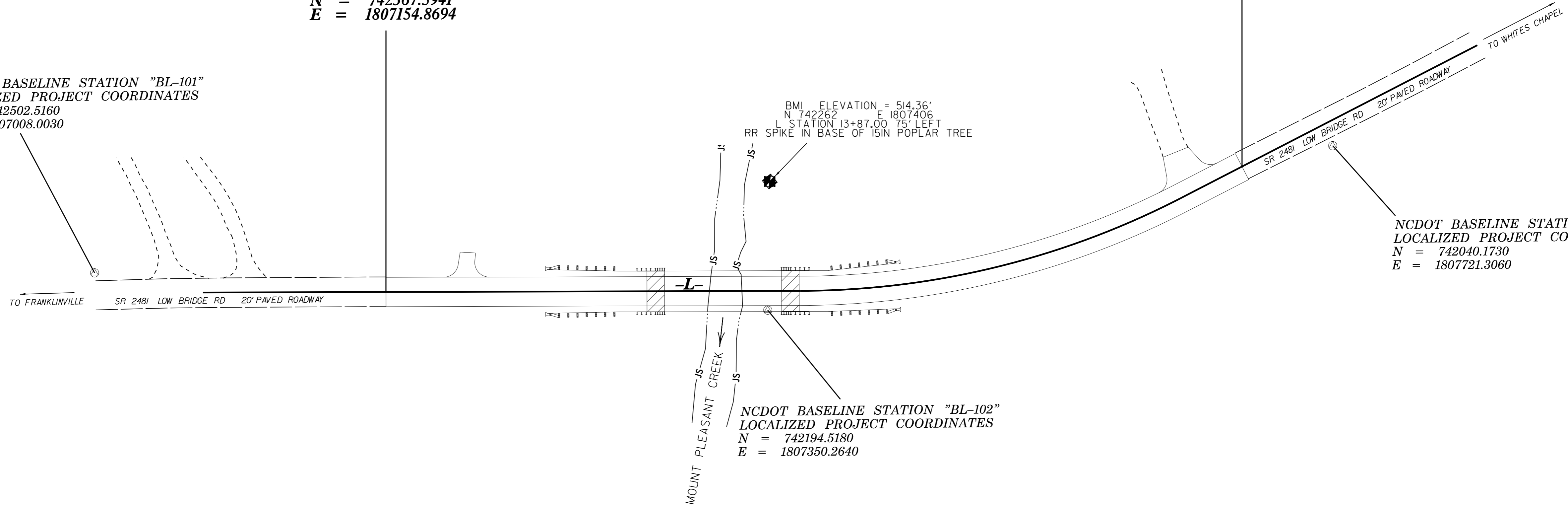

DATUM DESCRIPTION

THE LOCALIZED COORDINATE SYSTEM DEVELOPED FOR THIS PROJECT IS BASED ON THE STATE PLANE COORDINATES ESTABLISHED BY NCDOT FOR MONUMENT "B5546-1" WITH NAD 83/NA 2011 STATE PLANE GRID COORDINATES OF NORTHING: 741985.730(±) EASTING: 1808002.531(±) ELEVATION: 559.113(±) THE AVERAGE COMBINED GRID FACTOR USED ON THIS PROJECT (GROUND TO GRID) IS: 0.99989418 THE N.C. LAMBERT GRID BEARING AND LOCALIZED HORIZONTAL GROUND DISTANCE FROM "B5546-1" TO -L- STATION 11+25.00 IS N 65° 44' 55.9" W 929.704' ALL LINEAR DIMENSIONS ARE LOCALIZED HORIZONTAL DISTANCES VERTICAL DATUM USED IS NAVD 88

NOTES:

1. THE CONTROL DATA FOR THIS PROJECT CAN BE FOUND ELECTRONICALLY BY SELECTING PROJECT CONTROL DATA AT:
[HTTPS://CONNECT.NCDOT.GOV/RESOURCES/LOCATION/](https://connect.ncdot.gov/resources/location/)

THE FILES TO BE FOUND ARE AS FOLLOWS:
 b5546_ls_control.txt

SITE CALIBRATION INFORMATION HAS NOT BEEN PROVIDED FOR THIS PROJECT. IF FURTHER INFORMATION IS NEEDED, PLEASE CONTACT THE LOCATION AND SURVEYS UNIT.

⊙ INDICATES GEODETIC CONTROL MONUMENTS USED OR SET FOR HORIZONTAL PROJECT CONTROL BY THE NCDOT LOCATION AND SURVEYS UNIT.

PROJECT CONTROL ESTABLISHED USING GLOBAL POSITIONING SYSTEM.

BL POINT	DESC.	NORTH	EAST	ELEVATION	L STATION	OFFSET
101	BL-101	742502.5160	1807008.0030	535.43	OUTSIDE PROJECT LIMITS	
102	BL-102	742194.5180	1807350.2640	518.11	13+85.70	13.12 RT
103	BL-103	742040.1730	1807721.3060	539.63	17+86.58	15.70 RT
.....						
BMI	ELEVATION = 514.36					
N 742262	E 1807406					
L STATION	13+87.00 75' LEFT					
	RR SPIKE IN THE BASE OF 15 INCH POPLAR					
.....						

NOTE: DRAWING NOT TO SCALE

6/12/99

25 JUL 2016 16:12 \\s05546-1s-1c-1.dgn