

**BEGIN TIP PROJECT B-5360**  
**-L- POT STA. 13 + 00.00**

CLEARING AND GRUBBING  
 EROSION CONTROL FOR  
 CONSTRUCTION SHEET 04

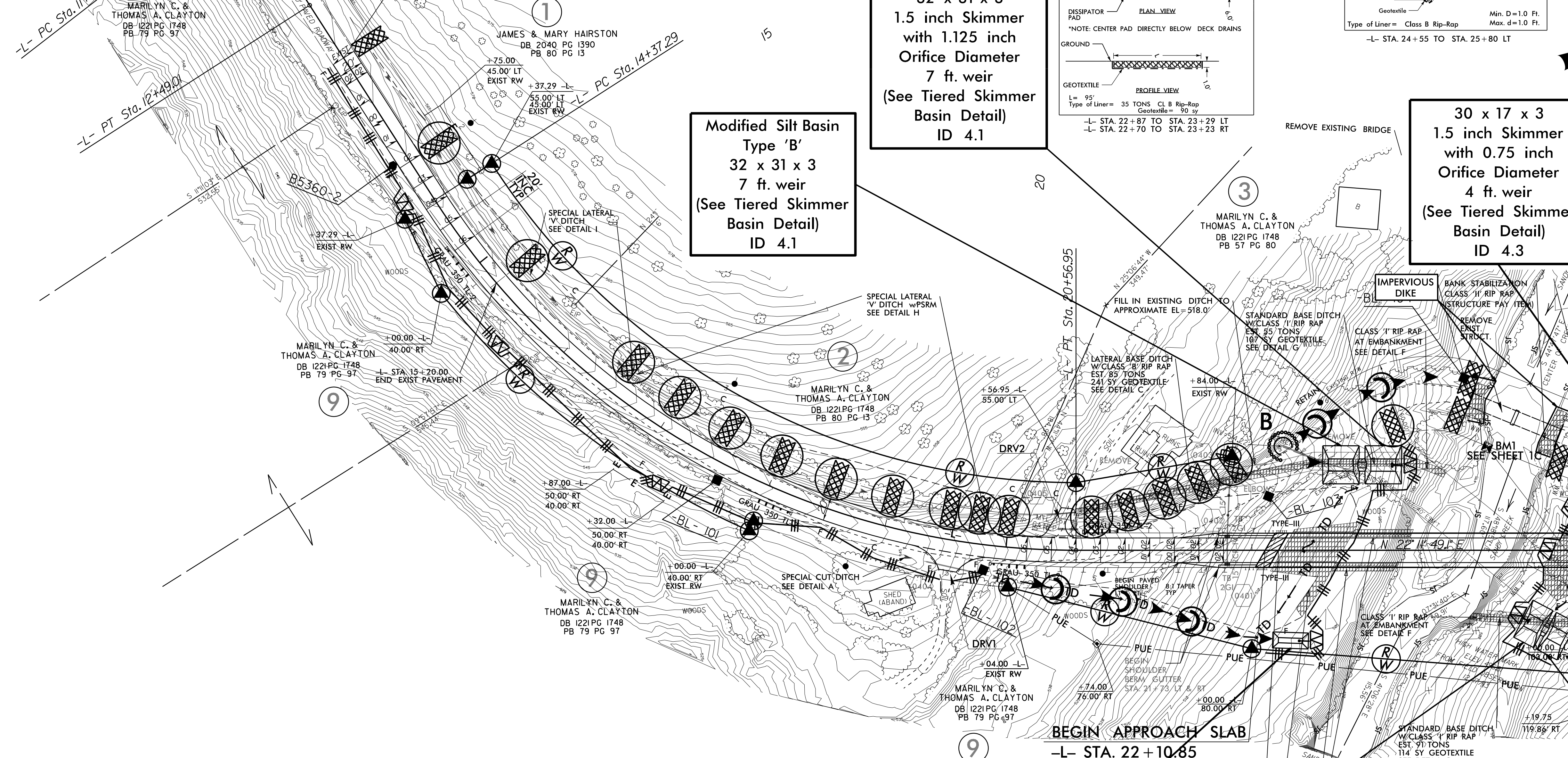
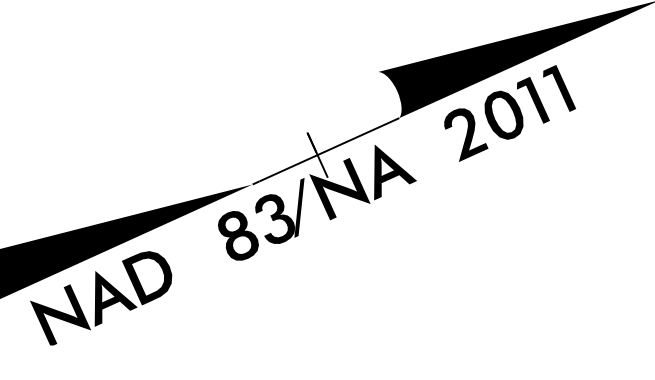

**Modified Silt Basin**  
 Type 'B'  
 32 x 31 x 3  
 7 ft. weir  
 (See Tiered Skimmer  
 Basin Detail)  
 ID 4.1

**32 x 31 x 3**  
 1.5 inch Skimmer  
 with 1.125 inch  
 Orifice Diameter  
 7 ft. weir  
 (See Tiered Skimmer  
 Basin Detail)  
 ID 4.1

**30 x 17 x 3**  
 1.5 inch Skimmer  
 with 0.75 inch  
 Orifice Diameter  
 4 ft. weir  
 (See Tiered Skimmer  
 Basin Detail)  
 ID 4.3

**Modified Silt Basin**  
 Type 'B'  
 30 x 17 x 3  
 4 ft. weir  
 (See Tiered Skimmer  
 Basin Detail)  
 ID 4.3

**29 x 13 x 3**  
 1.5 inch Skimmer  
 with 0.375 inch  
 Orifice Diameter  
 4 ft. weir  
 ID 4.2

**20 x 34 x 3**  
 1.5 inch Skimmer  
 with 0.875 inch  
 Orifice Diameter  
 5 ft. weir  
 (See Tiered Skimmer  
 Basin Detail)  
 ID 4.4

**Modified Silt Basin**  
 Type 'B'  
 20 x 34 x 3  
 5 ft. weir  
 (See Tiered Skimmer  
 Basin Detail)  
 ID 4.4

NOTE:  
 PLACE TEMPORARY ROCK SEDIMENT DAMS TYPE - B  
 AND TEMPORARY ROCK SILT CHECKS TYPE - A AT  
 DRAINAGE OUTLETS.

NOTE:  
 UTILIZE SPECIAL STILLING BASIN WHERE APPLICABLE.

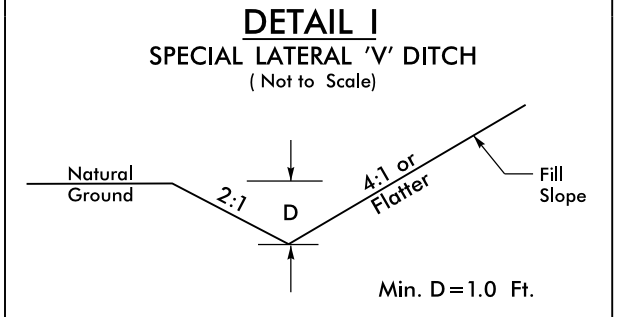
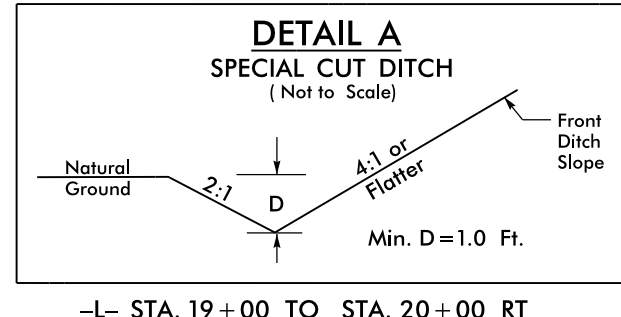

30 JUN 2016 09:15  
 R:\Projects\Design\B-5360\_EC\_psh4.dgn  
 AT: BRENDA

MATCHLINE -L- STA. 25 + 40.00 SEE SHEET 5

ALEXANDER J. TRENT  
 DB 1223 PG 2055