

**This electronic collection of documents is provided  
for the convenience of the user  
and is Not a Certified Document –**

**The documents contained herein were originally issued  
and sealed by the individuals whose names and license  
numbers appear on each page, on the dates appearing  
with their signature on that page.**

**This file or an individual page  
shall not be considered a certified document.**

09/08/99  
 7:30:37 AM  
 290\_001\_B5125\_ut-1-sh\_u001\_psh.dgn  
 Joshua Barbour - Division: P007 Utility Services Emp

**CONTRACT: 42271.1.1**      **TIP PROJECT: B-5125**

See Sheet 1-A For Index of Sheets

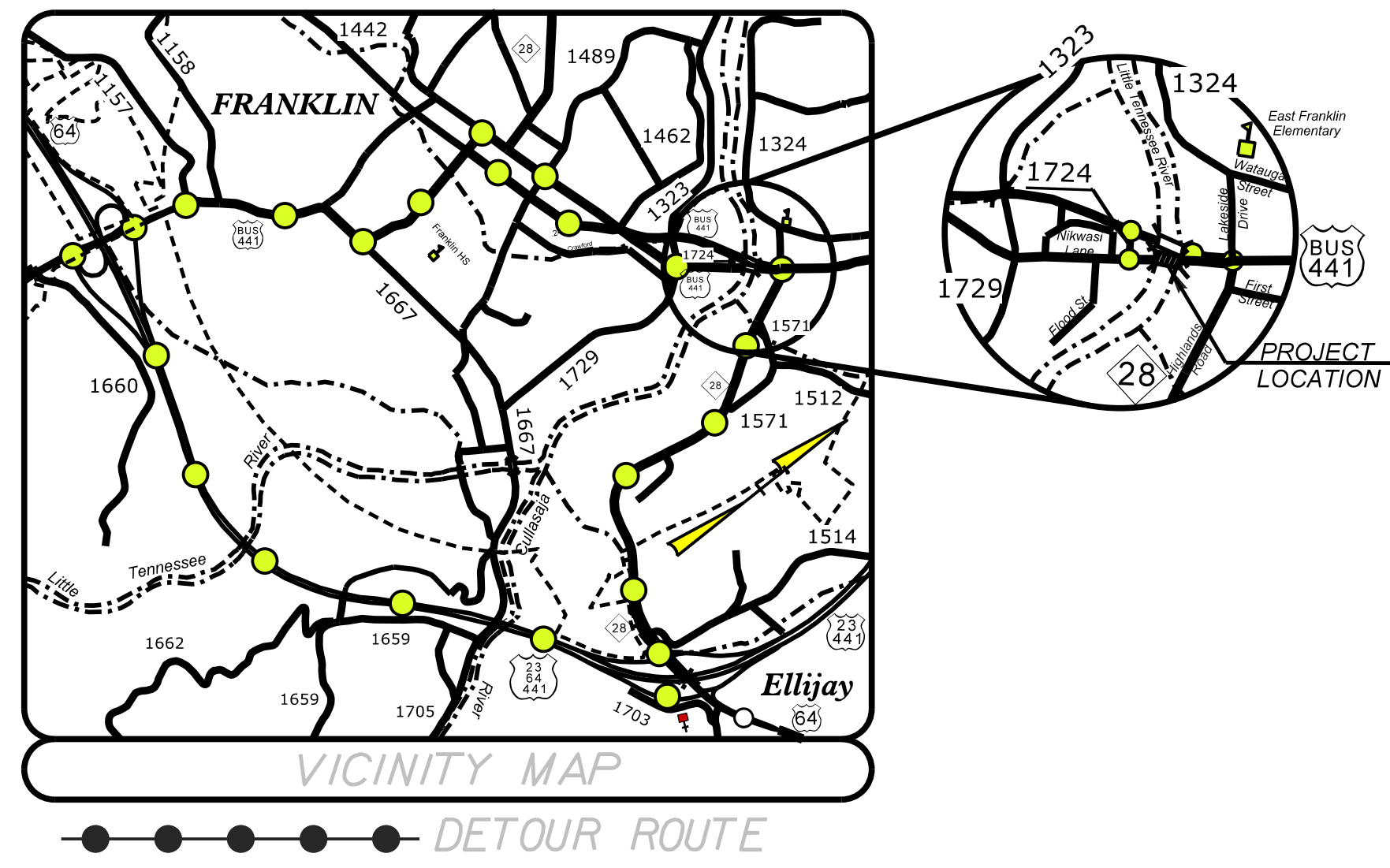

STATE OF NORTH CAROLINA  
 DIVISION OF HIGHWAYS  
**UTILITIES BY OTHERS**  
**MACON COUNTY**

**LOCATION: REPLACEMENT OF BRIDGE No. 22 OVER LITTLE TENNESSEE RIVER ON US 441 BUSINESS**  
**TYPE OF WORK: OVERHEAD AND UNDERGROUND POWER & TELECOMMUNICATIONS RELOCATION**

T.I.P. NO.	SHEET NO.
B-5125	UO-01

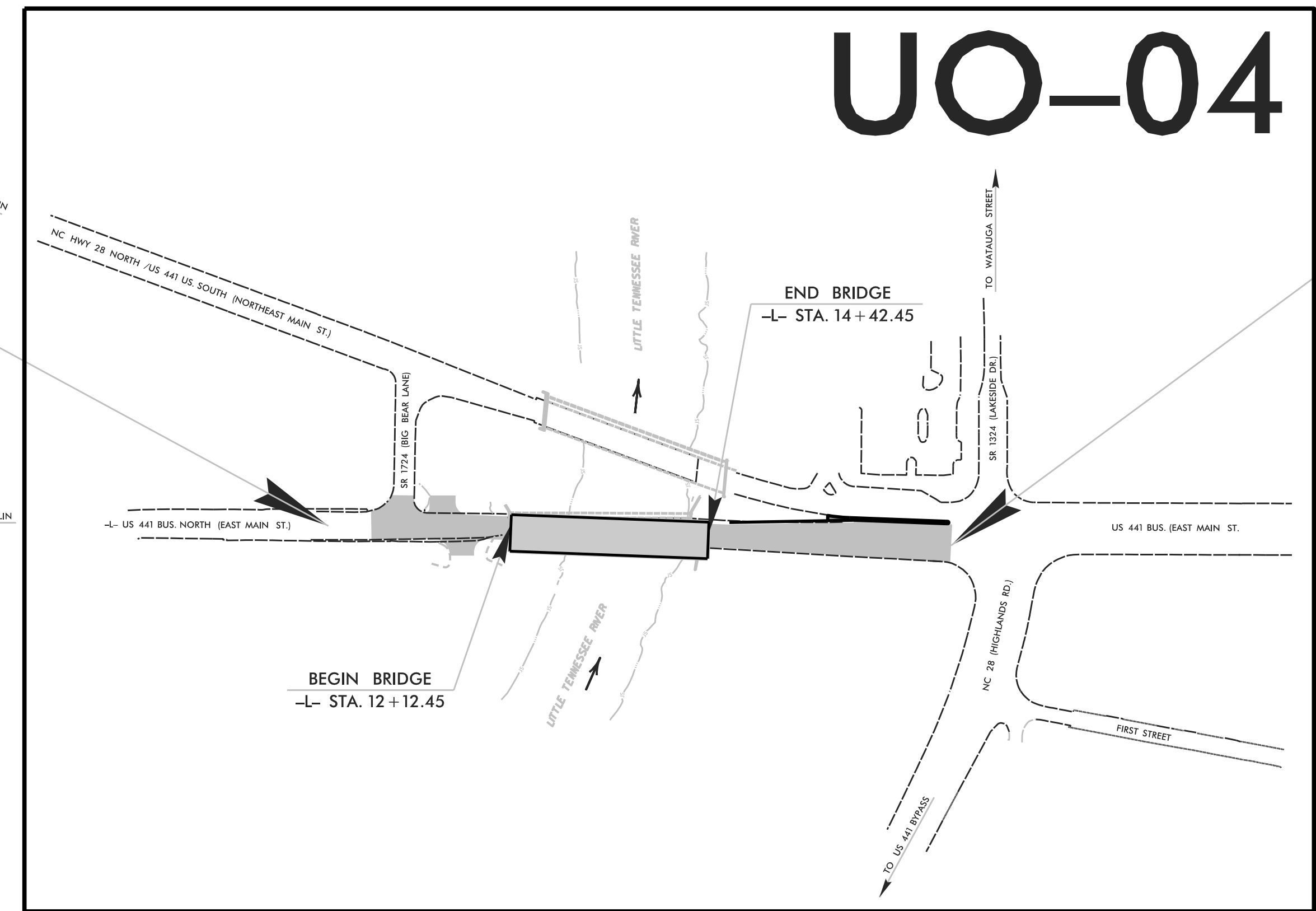
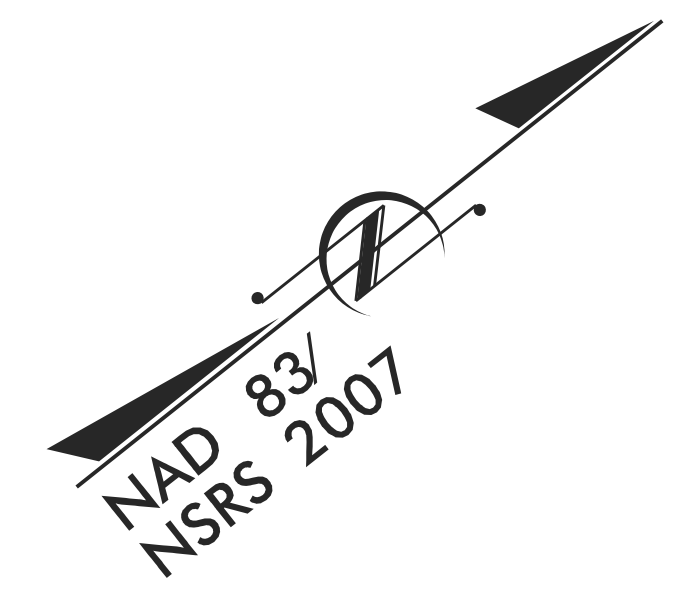

END TIP PROJECT B-5125  
 -L- STA. 17+25.00

**THIS PROJECT IS WITHIN THE MUNICIPAL BOUNDARIES OF THE TOWN OF FRANKLIN.**  
**CLEARING ON THIS PROJECT SHALL BE PERFORMED TO LIMITS ESTABLISHED BY METHOD \_\_\_\_\_.**

FINAL PLANS

CIVIL ENGINEERS  
 ENVIRONMENTAL - CEI  
 LAND SURVEYING  
 SUBSURFACE UTILITY ENGINEERING  
**KCI**  
 ASSOCIATES OF N.C.  
 SUITE 220, LANDMARK CENTER II,  
 4601 SIX FORKS ROAD  
 RALEIGH, NORTH CAROLINA 27609  
 (919) 783-9214  
 WWW.KCI.COM

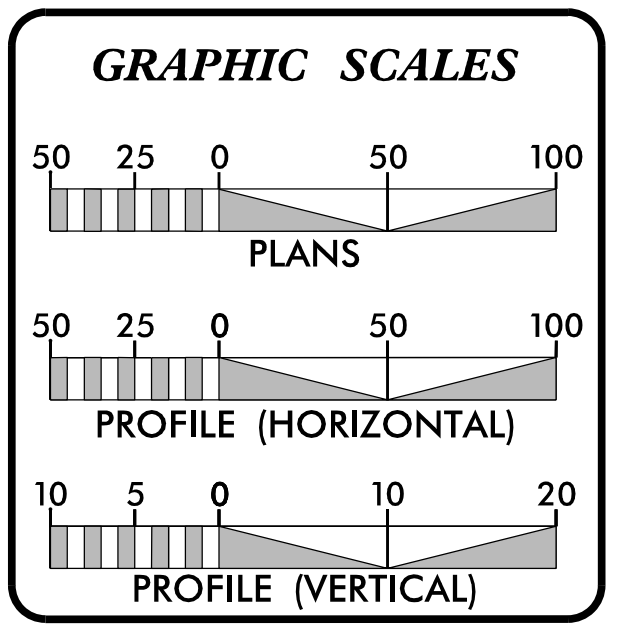

SHEET NO.	DESCRIPTION
UO-01	TITLE SHEET
UO-02	GENERAL NOTES
UO-03	CONVENTIONAL PLAN SHEET SYMBOLS
UO-04	UTILITIES BY OTHERS PLAN SHEET

UTILITY OWNERS ON PROJECT	
(A)	DUKE ENERGY - POWER (DISTRIBUTION)
(B)	DUKE ENERGY - POWER (TRANSMISSION)
(C)	FRONTIER COMMUNICATIONS (COMMUNICATIONS)
(D)	MORRIS BROADBAND - (COMMUNICATIONS)
(E)	TOCCOA NATURAL GAS - (GAS DISTRIBUTION)

PREPARED IN THE OFFICE OF:  
**DIVISION OF HIGHWAYS**  
**UTILITIES UNIT**  
**UTILITIES ENGINEERING SECTION**  
 1555 MAIL SERVICES CENTER  
 RALEIGH, NC 27699-1555  
 PHONE (919) 707-6690  
 FAX (919) 250-4119

<b>Roger Worthington, P.E.</b>	UTILITIES SECTION ENGINEER
<b>Carl Barclay, P.E.</b>	UTILITIES SQUAD LEADER PROJECT ENGINEER
<b>Michael R. Bright</b>	UTILITIES PROJECT DESIGNER



Note: Not to Scale

\*S.U.E. = Subsurface Utility Engineering

# CONVENTIONAL PLAN SHEET SYMBOLS

## BOUNDARIES AND PROPERTY:

State Line	-----
County Line	-----
Township Line	-----
City Line	-----
Reservation Line	-----
Property Line	-----
Existing Iron Pin	○ EP
Property Corner	-----
Property Monument	□ ECM
Parcel/Sequence Number	⑫③
Existing Fence Line	-x-x-x-
Proposed Woven Wire Fence	○
Proposed Chain Link Fence	□
Proposed Barbed Wire Fence	◇
Existing Wetland Boundary	----- WLB
Proposed Wetland Boundary	----- WLB
Existing Endangered Animal Boundary	----- EAB
Existing Endangered Plant Boundary	----- EPB
Known Soil Contamination: Area or Site	☠ ☠
Potential Soil Contamination: Area or Site	☠ ☠

## BUILDINGS AND OTHER CULTURE:

Gas Pump Vent or U/G Tank Cap	○
Sign	○
Well	○
Small Mine	✕
Foundation	□
Area Outline	□
Cemetery	⊕
Building	□
School	□
Church	⊕
Dam	□

## HYDROLOGY:

Stream or Body of Water	-----
Hydro, Pool or Reservoir	-----
Jurisdictional Stream	----- JS
Buffer Zone 1	----- BZ 1
Buffer Zone 2	----- BZ 2
Flow Arrow	←
Disappearing Stream	-----
Spring	○
Wetland	-----
Proposed Lateral, Tail, Head Ditch	-----
False Sump	-----

## RAILROADS:

Standard Gauge	-----
RR Signal Milepost	○
Switch	□
RR Abandoned	-----
RR Dismantled	-----

## RIGHT OF WAY:

Baseline Control Point	◆
Existing Right of Way Marker	△
Existing Right of Way Line	-----
Proposed Right of Way Line	-----
Proposed Right of Way Line with Iron Pin and Cap Marker	○
Proposed Right of Way Line with Concrete or Granite RW Marker	○
Proposed Control of Access Line with Concrete CA Marker	○
Existing Control of Access	○
Proposed Control of Access	○
Existing Easement Line	----- E
Proposed Temporary Construction Easement	----- E
Proposed Temporary Drainage Easement	----- TDE
Proposed Permanent Drainage Easement	----- PDE
Proposed Permanent Drainage / Utility Easement	----- DUE
Proposed Permanent Utility Easement	----- PUE
Proposed Temporary Utility Easement	----- TUE
Proposed Aerial Utility Easement	----- AUE
Proposed Permanent Easement with Iron Pin and Cap Marker	◆

## ROADS AND RELATED FEATURES:

Existing Edge of Pavement	-----
Existing Curb	-----
Proposed Slope Stakes Cut	----- C
Proposed Slope Stakes Fill	----- F
Proposed Curb Ramp	○ CR
Existing Metal Guardrail	-----
Proposed Guardrail	-----
Existing Cable Guiderail	-----
Proposed Cable Guiderail	-----
Equality Symbol	⊕
Pavement Removal	-----
VEGETATION:	
Single Tree	☼
Single Shrub	☼
Hedge	-----
Woods Line	-----

Orchard	-----
Vineyard	-----

## EXISTING STRUCTURES:

MAJOR:	
Bridge, Tunnel or Box Culvert	----- CONC
Bridge Wing Wall, Head Wall and End Wall	----- CONC WW
MINOR:	
Head and End Wall	----- CONC HW
Pipe Culvert	-----
Footbridge	-----
Drainage Box: Catch Basin, DI or JB	□ CB
Paved Ditch Gutter	-----
Storm Sewer Manhole	○
Storm Sewer	-----

## UTILITIES:

POWER:	
Existing Power Pole	●
Proposed Power Pole	○
Existing Joint Use Pole	●
Proposed Joint Use Pole	○
Power Manhole	⊕
Power Line Tower	⊗
Power Transformer	⊗
U/G Power Cable Hand Hole	□
H-Frame Pole	●
Recorded U/G Power Line	----- P
Designated U/G Power Line (S.U.E.*)	----- P

## TELEPHONE:

Existing Telephone Pole	●
Proposed Telephone Pole	○
Telephone Manhole	⊕
Telephone Booth	□
Telephone Pedestal	⊕
Telephone Cell Tower	⊗
U/G Telephone Cable Hand Hole	□
Recorded U/G Telephone Cable	----- T
Designated U/G Telephone Cable (S.U.E.*)	----- T
Recorded U/G Telephone Conduit	----- TC
Designated U/G Telephone Conduit (S.U.E.*)	----- TC
Recorded U/G Fiber Optics Cable	----- T FO
Designated U/G Fiber Optics Cable (S.U.E.*)	----- T FO

## WATER:

Water Manhole	⊕
Water Meter	○
Water Valve	⊗
Water Hydrant	⊕
Recorded U/G Water Line	-----
Designated U/G Water Line (S.U.E.*)	-----
Above Ground Water Line	----- A/G Water

## TV:

TV Satellite Dish	⊗
TV Pedestal	⊕
TV Tower	⊗
U/G TV Cable Hand Hole	□
Recorded U/G TV Cable	----- TV
Designated U/G TV Cable (S.U.E.*)	----- TV
Recorded U/G Fiber Optic Cable	----- TV FO
Designated U/G Fiber Optic Cable (S.U.E.*)	----- TV FO

## GAS:

Gas Valve	◇
Gas Meter	⊕
Recorded U/G Gas Line	----- G
Designated U/G Gas Line (S.U.E.*)	----- G
Above Ground Gas Line	----- A/G Gas

## SANITARY SEWER:

Sanitary Sewer Manhole	⊕
Sanitary Sewer Cleanout	⊕
U/G Sanitary Sewer Line	----- SS
Above Ground Sanitary Sewer	----- A/G Sanitary Sewer
Recorded SS Forced Main Line	----- FSS
Designated SS Forced Main Line (S.U.E.*)	----- FSS

## MISCELLANEOUS:

Utility Pole	●
Utility Pole with Base	□
Utility Located Object	○
Utility Traffic Signal Box	⊕
Utility Unknown U/G Line	----- U/UL
U/G Tank; Water, Gas, Oil	□
Underground Storage Tank, Approx. Loc.	⊕
A/G Tank; Water, Gas, Oil	□
Geoenvironmental Boring	⊕
U/G Test Hole (S.U.E.*)	⊕
Abandoned According to Utility Records	AATUR
End of Information	E.O.I.

**UTILITY BY OTHERS**

NOTE:  
ALL PROPOSED UTILITY WORK SHOWN ON THIS SHEET WILL BE DONE BY OTHERS. NO PAYMENT WILL BE MADE TO THE CONTRACTOR FOR PROPOSED UTILITY WORK SHOWN ON THIS SHEET.

PROPERTY OWNERS		
② J.H. DUNCAN OIL, INC. DB A-23 PG 343	④ ABDUL M. WALIANY, ET. UX. DB G-14 PG 163	⑧ MACON COUNTY DB A-27 PG 17H
③ MLC, INCORPORATED DB T-24 PG 867	⑤ "NOW OR FORMERLY" TOWN OF FRANKLIN DB K-8 PG 306	ROBERT P. REVIS, ET. UX. DB T-29 PG 2040
MACON COUNTY DB Y-26 PG 1219 PLAT CARD #38H	DUKE ENERGY CORPORATION DB X-26 PG 2125	JAMES H. PARRISH, ET. UX. DB L-14 PG H9

TELEPHONE  
VERIZON  
ATTN: TINA RUTHERFORD  
84 ALLEN STREET  
SYLVA, N.C. 28779  
828.631.4058

FIBER OPTIC  
BALSAM WEST FIBERNET  
ATTN: ED TERRY  
20 COLONIAL SQUARE  
SYLVA, N.C. 28779  
828.586.6141

POWER  
DUKE ENERGY  
ATTN: ROGER BISHOP  
301 NPL LOOP  
FRANKLIN, N.C. 28734  
828.586.6393

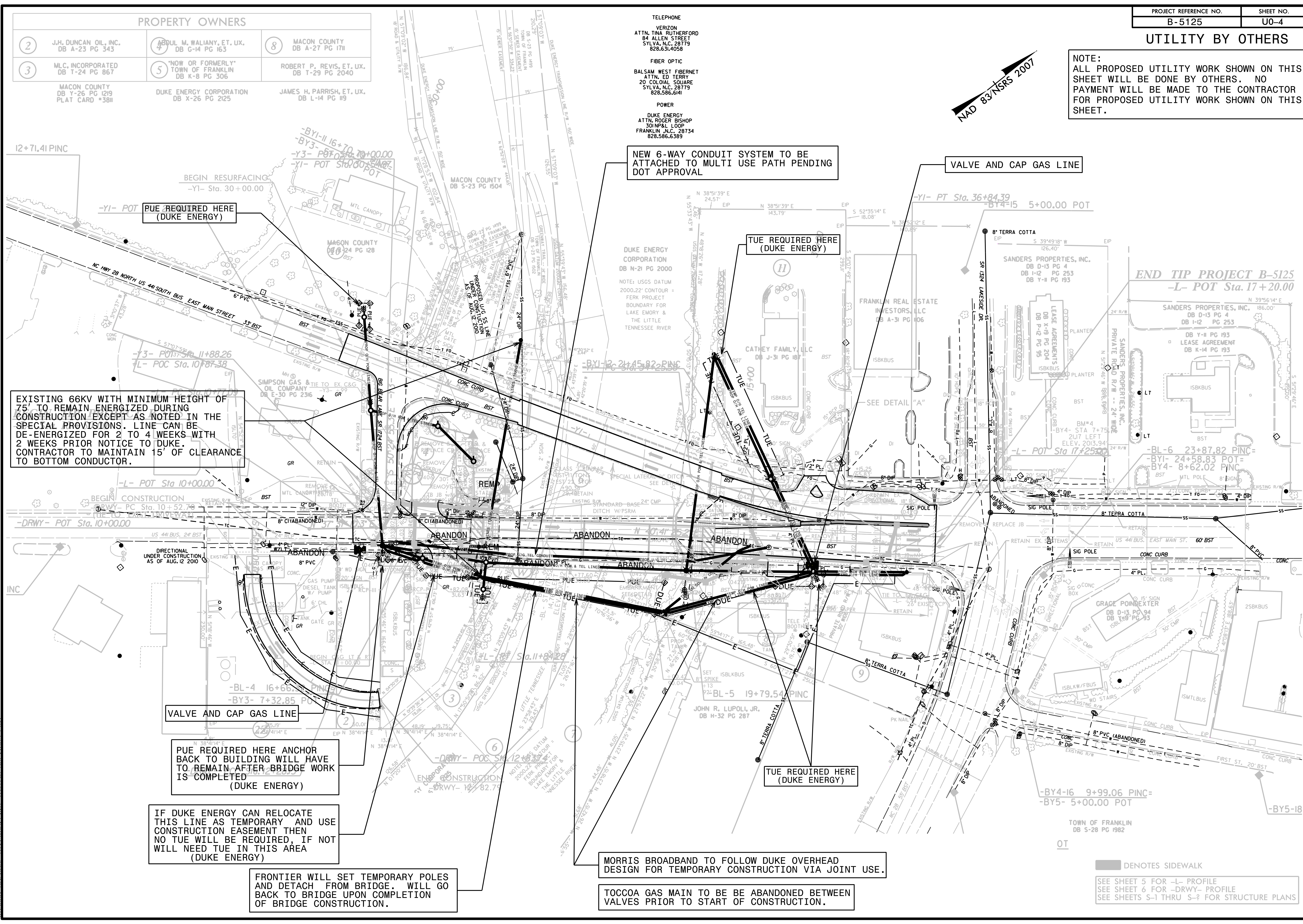
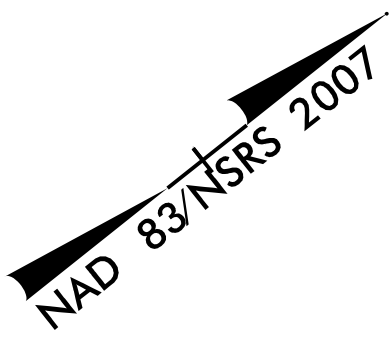

NEW 6-WAY CONDUIT SYSTEM TO BE ATTACHED TO MULTI USE PATH PENDING DOT APPROVAL

VALVE AND CAP GAS LINE

PUE REQUIRED HERE (DUKE ENERGY)

TUE REQUIRED HERE (DUKE ENERGY)

EXISTING 66KV WITH MINIMUM HEIGHT OF 75' TO REMAIN ENERGIZED DURING CONSTRUCTION EXCEPT AS NOTED IN THE SPECIAL PROVISIONS. LINE CAN BE DE-ENERGIZED FOR 2 TO 4 WEEKS WITH 2 WEEKS PRIOR NOTICE TO DUKE. CONTRACTOR TO MAINTAIN 15' OF CLEARANCE TO BOTTOM CONDUCTOR.

VALVE AND CAP GAS LINE

PUE REQUIRED HERE ANCHOR BACK TO BUILDING WILL HAVE TO REMAIN AFTER BRIDGE WORK IS COMPLETED (DUKE ENERGY)

IF DUKE ENERGY CAN RELOCATE THIS LINE AS TEMPORARY AND USE CONSTRUCTION EASEMENT THEN NO TUE WILL BE REQUIRED, IF NOT WILL NEED TUE IN THIS AREA (DUKE ENERGY)

FRONTIER WILL SET TEMPORARY POLES AND DETACH FROM BRIDGE. WILL GO BACK TO BRIDGE UPON COMPLETION OF BRIDGE CONSTRUCTION.

MORRIS BROADBAND TO FOLLOW DUKE OVERHEAD DESIGN FOR TEMPORARY CONSTRUCTION VIA JOINT USE.

TOCCOA GAS MAIN TO BE ABANDONED BETWEEN VALVES PRIOR TO START OF CONSTRUCTION.

■ DENOTES SIDEWALK

SEE SHEET 5 FOR -L- PROFILE  
SEE SHEET 6 FOR -DRWY- PROFILE  
SEE SHEETS S-1 THRU S-2 FOR STRUCTURE PLANS

8/17/09  
 13:20 PM  
 250.004\_B5125-ut\_rdy4\_u004\_gsh.dgn  
 Joshua, B4404-Division:2007-Utility\_Services\_Emo