

TIP NO. I-5710	SHEET NO. SIGN-4
APPROVED: <i>Melissa B. Toth</i> 0860CF8E94004AF	
DATE: 6/8/2016	
SEAL NORTH CAROLINA PROFESSIONAL ENGINEER SEAL 025892 MELISSA B. TOTH	
DOCUMENT NOT CONSIDERED FINAL UNLESS ALL SIGNATURES COMPLETED	

NOTE: SEE SIGNAL PLAN FOR
ADDITIONAL SIGNS MOUNTED ON
PEDESTALS WITH SIGNALS

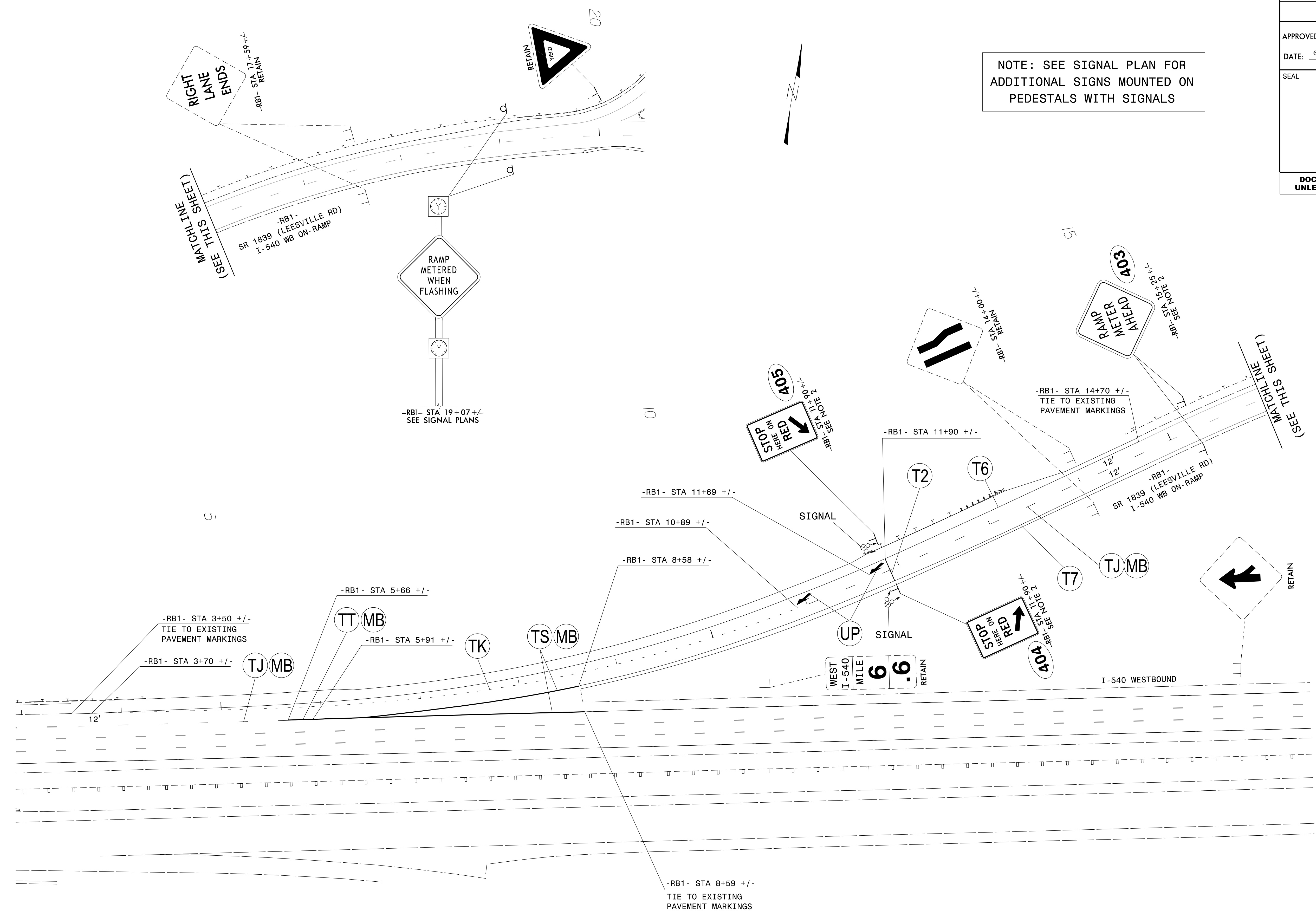

PAY ITEM NOTES

1. DISPOSAL OF SIGN SYSTEM, U CHANNEL
2. SIGN ERECTION, TYPE 'E'

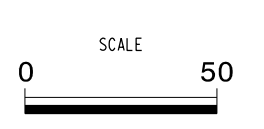

ATKINS 1616 EAST MILLBROOK ROAD, SUITE 310
RALEIGH, NORTH CAROLINA 27609
(919) 876-6888 NCBES #F-0326

**PAVEMENT MARKING AND
SIGNING**
I-540 WB ON-RAMP AT
SR 1839 (LEESVILLE RD)

08-JUN-2016 09:53
0: TransporTation\Production\Trans\NCDD01\I-540 Ramp Metering\Traffic\Signing& Delinication\15710_SGN_Sign_04.dgn
MILE2054 AT DU5300019