

TIP PROJECT: I-5710

CONTRACT: C203791

See Sheet 1-A For Index of Sheets
See Sheet 1-B For Conventional Symbols

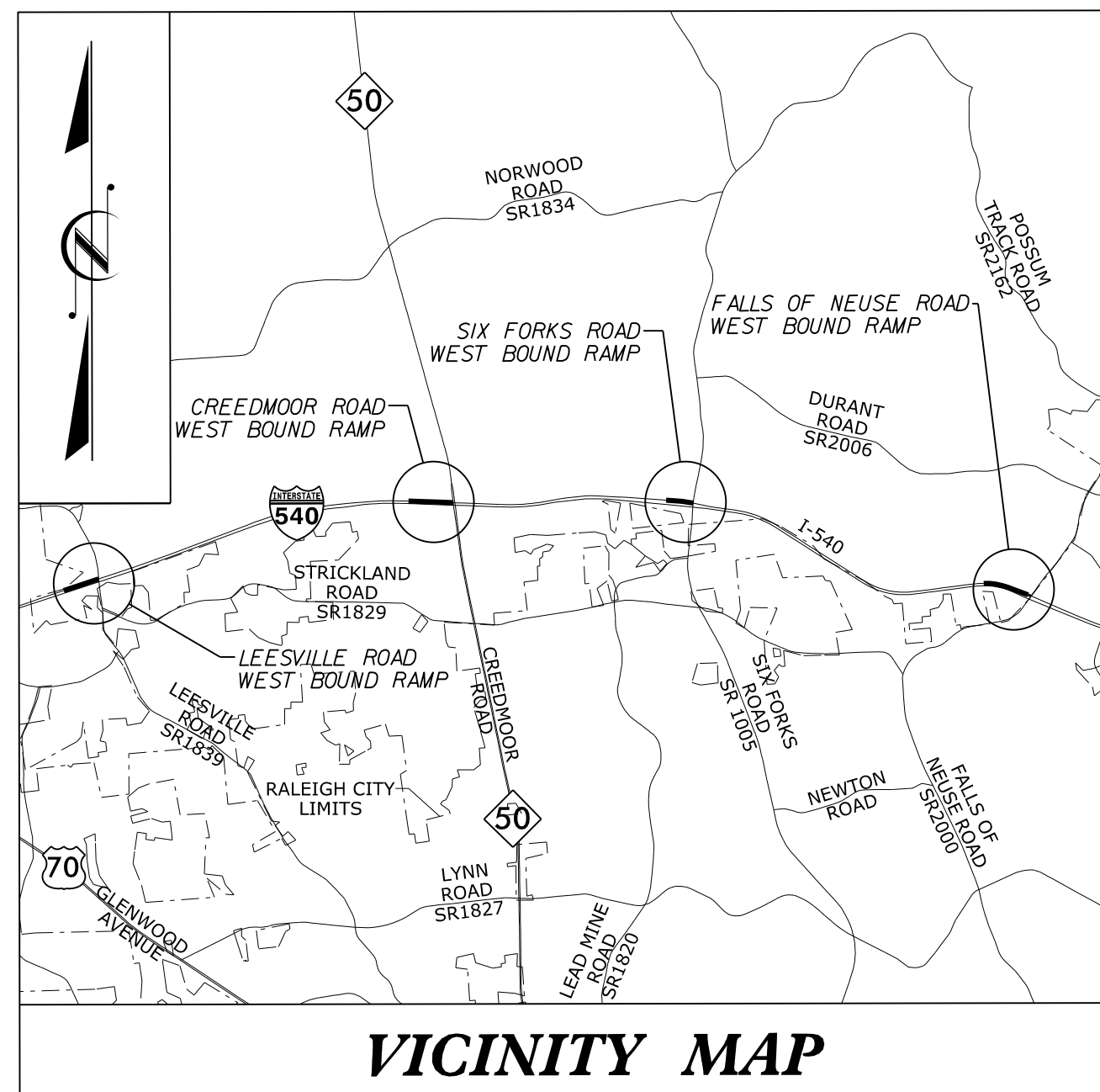

BEGIN TIP PROJECT I-5710
-RBI- STA. 3+50.00

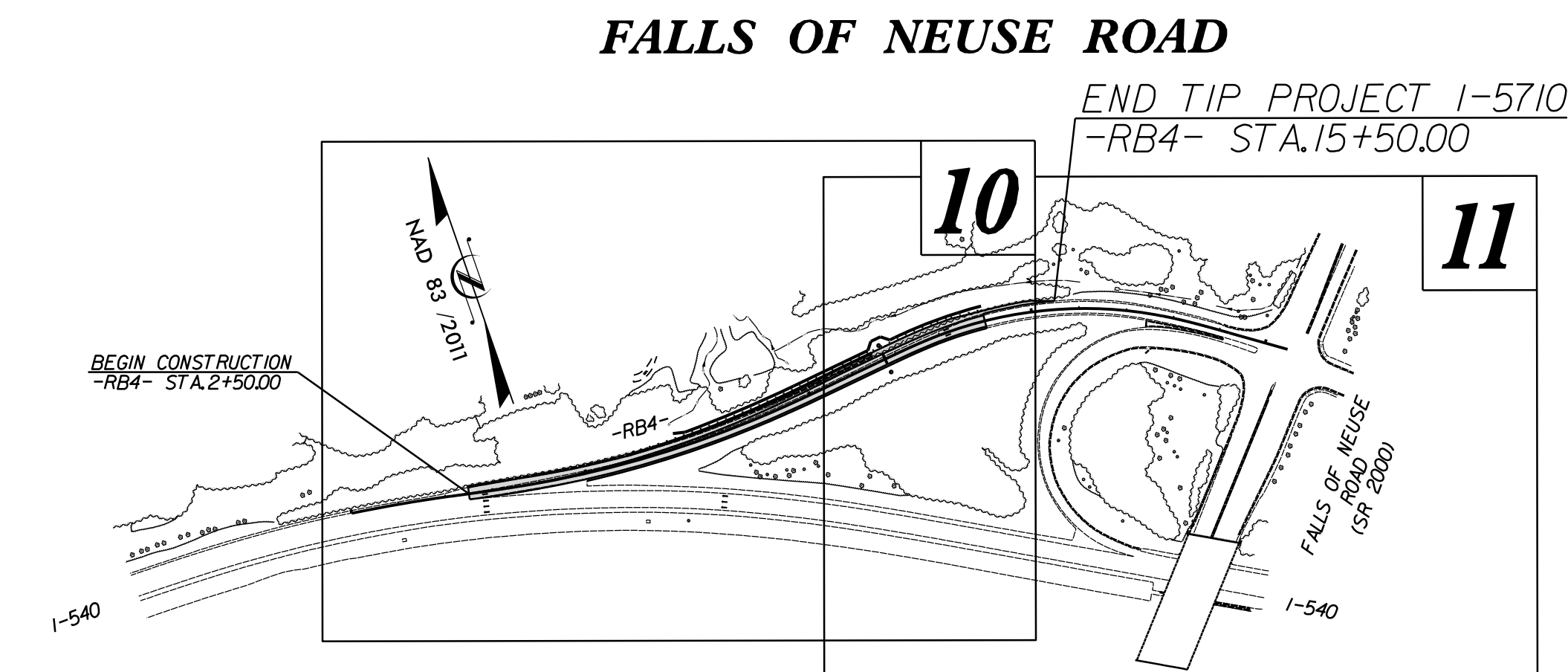
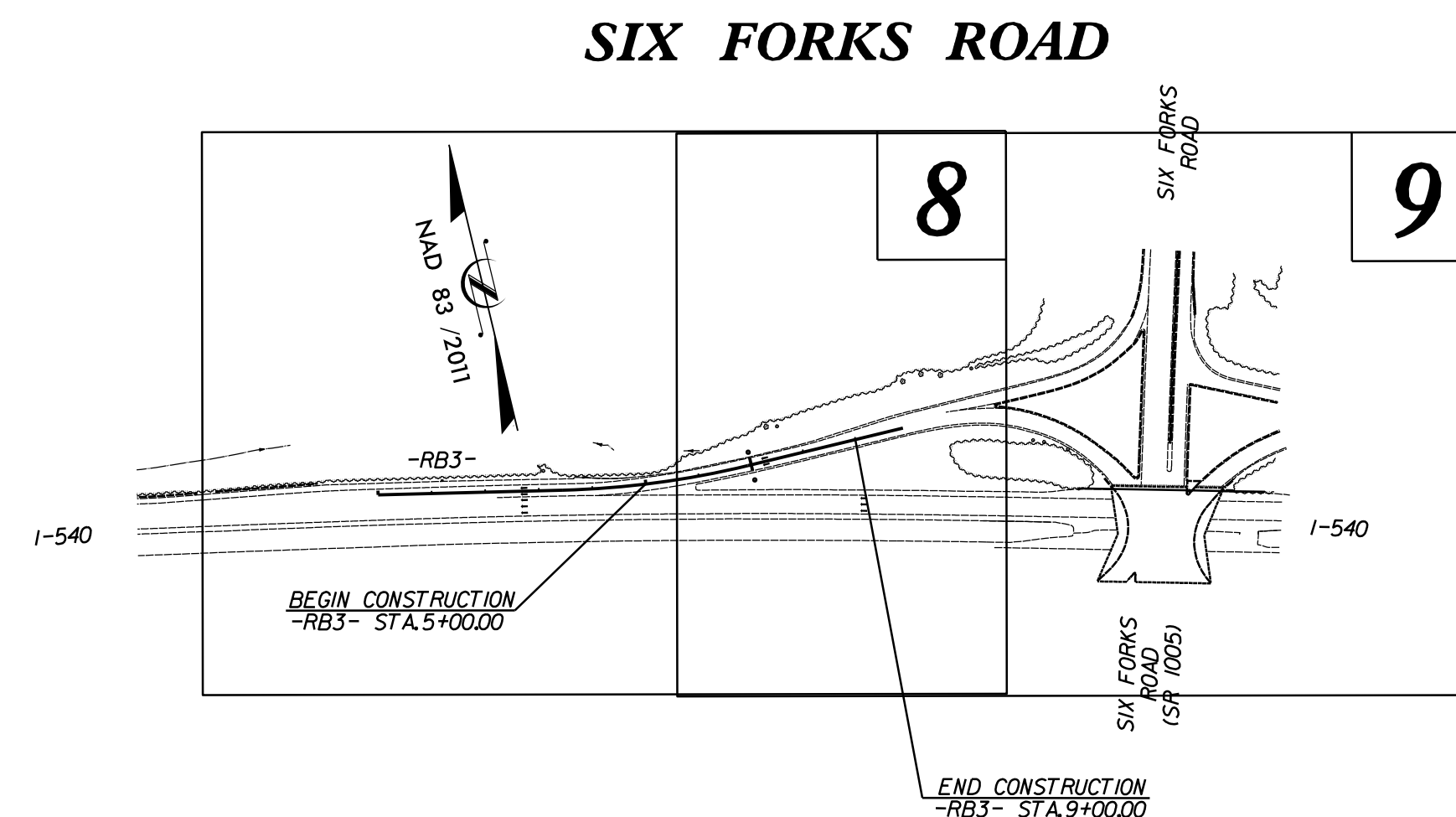
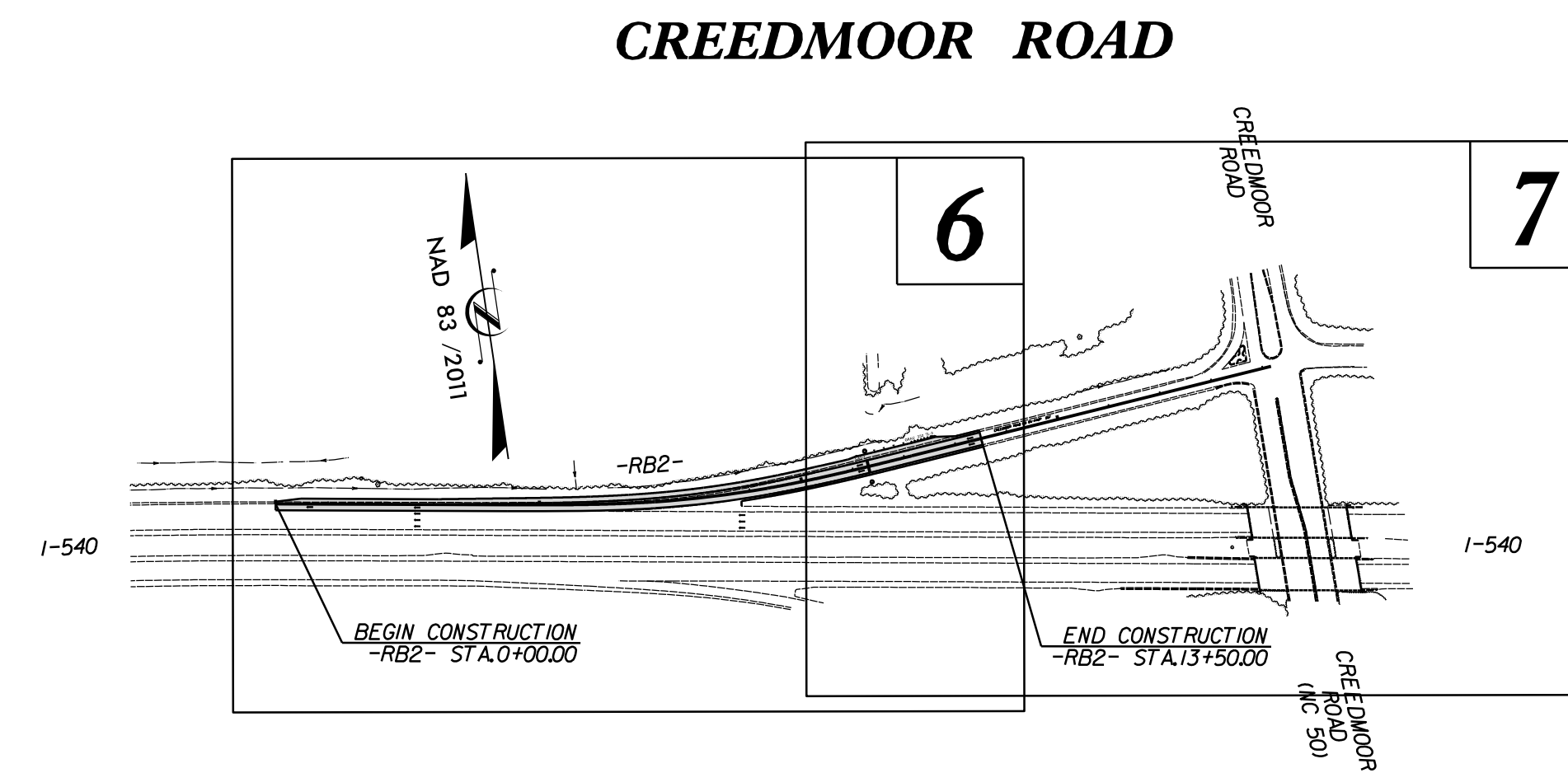
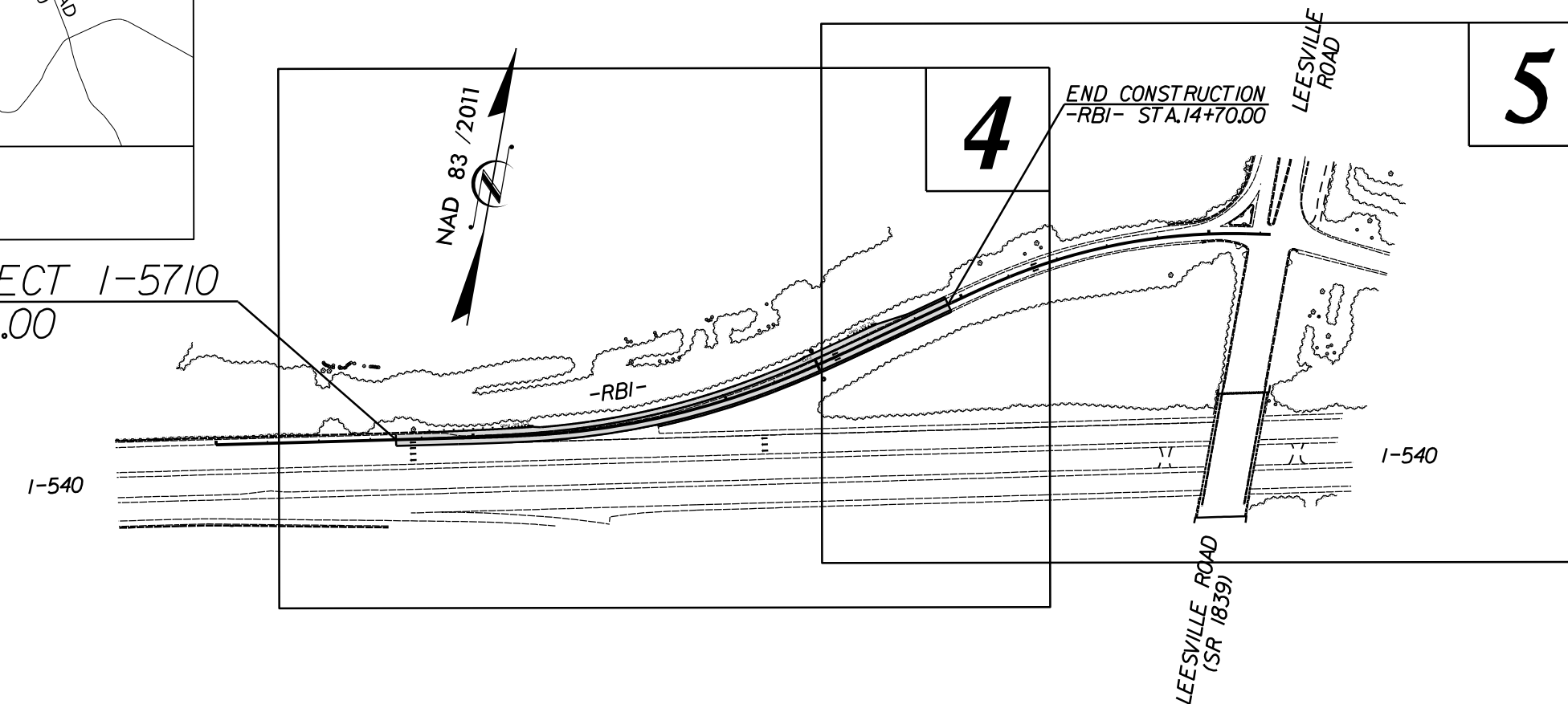

STATE OF NORTH CAROLINA DIVISION OF HIGHWAYS

WAKE COUNTY

LOCATION: WEST BOUND RAMP ALONG I-540 AT SR 1839 (LEESVILLE ROAD), NC 50 (CREEDMOOR ROAD), SR 1005 (SIX FORKS ROAD), AND SR 2000 (FALLS OF NEUSE ROAD).

TYPE OF WORK: INSTALLING RAMP METERS - WIDENING, GRADING, PAVING, DRAINAGE, RETAINING WALL, ITS, AND SIGNALS

STATE	STATE PROJECT REFERENCE NO.	SHEET NO.	TOTAL SHEETS
N.C.	I-5710	1	
STATE PROJ. NO.	F.A. PROJ. NO.	DESCRIPTION	
50125.1.FS1	NHPP-0540(030)	P.E.	
50125.3.1	NHPP-0540(030)	CONST.	

THIS IS A FULL CONTROLLED-ACCESS PROJECT WITH ACCESS BEING LIMITED TO INTERCHANGES.

DOCUMENT NOT CONSIDERED FINAL
UNLESS ALL SIGNATURES COMPLETED

GRAPHIC SCALES

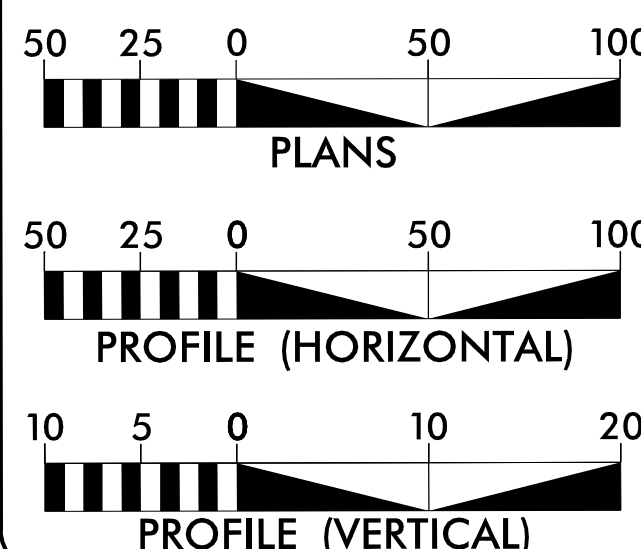

DESIGN DATA

ADT 2016 = 6,700-13,900
ADT 2036 = 7,300-15,200
DHV = 11-20 %
D = 100 %
* T = 3-7 %
V = 60 MPH
* (TTST 1% + DUAL 2-6%)
FUNC. CLASS. = INTERSTATE
STATEWIDE TIER

PROJECT LENGTH

LENGTH ROADWAY T.I.P. PROJECT I-5710 = 0.790 MILE
TOTAL LENGTH T.I.P. PROJECT I-5710 = 0.790 MILE

Prepared in the Office of:
ATKINS 1616 E. MILLBROOK ROAD, SUITE #310
RALEIGH, NORTH CAROLINA 27609
(919) 876-6888 NCBES #F-0326

2012 STANDARD SPECIFICATIONS

RIGHT OF WAY DATE:
N/A

LETTING DATE:
SEPTEMBER 20, 2016

CLINTON MORGAN, P.E.
PROJECT ENGINEER

IAN BERDEAU, E.I.
PROJECT DESIGN ENGINEER

TONY HOUSER, P.E.
NCDOT CONTACT

HYDRAULICS ENGINEER

DocuSigned by:
Clinton J. Morgan 6/28/2016
SIGNATURE: P.E.

DocuSigned by:
Clinton J. Morgan 6/28/2016
SIGNATURE: P.E.

ROADWAY DESIGN ENGINEER