

UTILITIES BY OTHERS

- NOTES:
1. ALL DUKE ENERGY UNDERGROUND POWER WITHIN THE CONSTRUCTION LIMITS IS TO BE ABANDONED IN PLACE
 2. ALL UNDERGROUND AT&T TELECOMMUNICATIONS WITHIN THE CONSTRUCTION LIMITS IS TO BE ABANDONED IN PLACE
 3. ALL UNDERGROUND TIME WARNER CATV WITHIN THE CONSTRUCTION LIMITS IS TO BE ABANDONED IN PLACE

NOTE:
 ALL PROPOSED UTILITY WORK SHOWN ON THIS SHEET WILL BE DONE BY OTHERS. NO PAYMENT WILL BE MADE TO THE CONTRACTOR FOR PROPOSED UTILITY WORK SHOWN ON THIS SHEET.

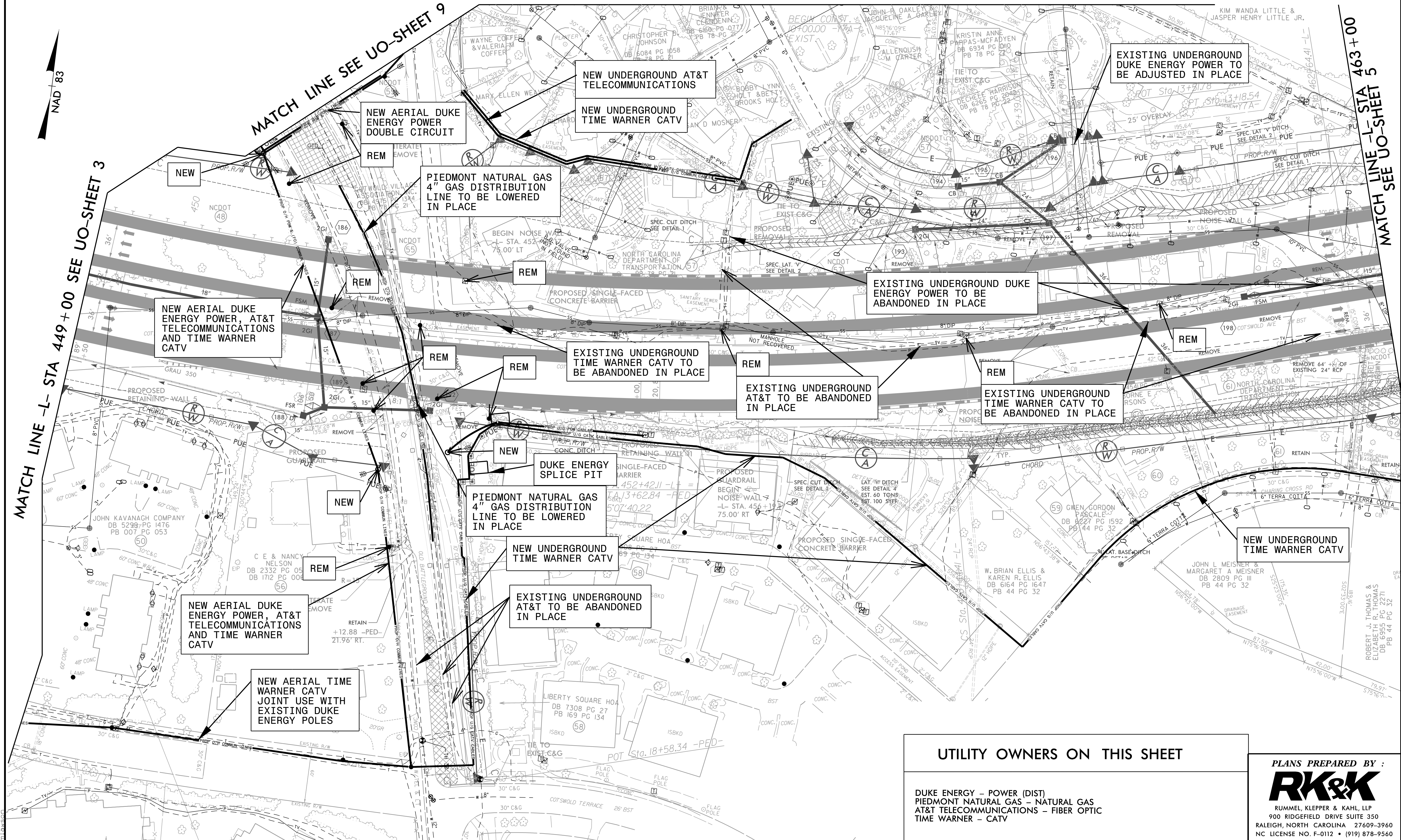

UTILITY OWNERS ON THIS SHEET

DUKE ENERGY - POWER (DIST)
PIEDMONT NATURAL GAS - NATURAL GAS
AT&T TELECOMMUNICATIONS - FIBER OPTIC
TIME WARNER - CATV

PLANS PREPARED BY:
RK&K
 RUMMEL, KLEPPER & KAHL, LLP
 900 RIDGEFIELD DRIVE SUITE 350
 RALEIGH, NORTH CAROLINA 27609-3960
 NC LICENSE NO. F-0112 • (919) 878-9560

8/17/99
 5/11/2016
 C:\Users\13111\Utilities\Coordination\NCDOT\U-2524D\Utilities\Engineering\UB0\Pre\Option_2\U2524D_U0-4.psd.dgn