

CLEARING AND GRUBBING
 EROSION CONTROL FOR
 CONSTRUCTION SHEET 06

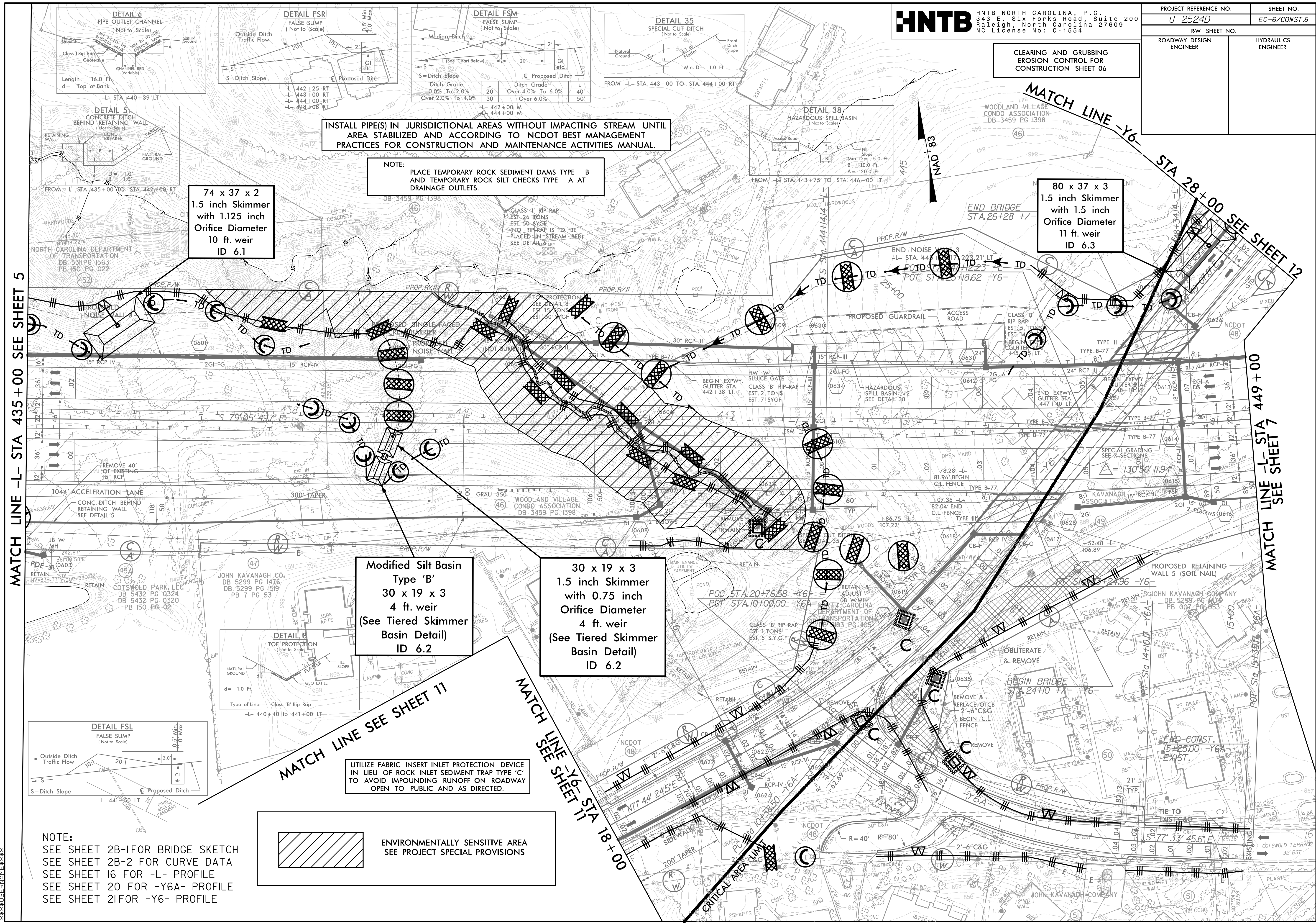

MATCH LINE -L- STA 435+00 SEE SHEET 5

MATCH LINE -L- STA 449+00 SEE SHEET 7

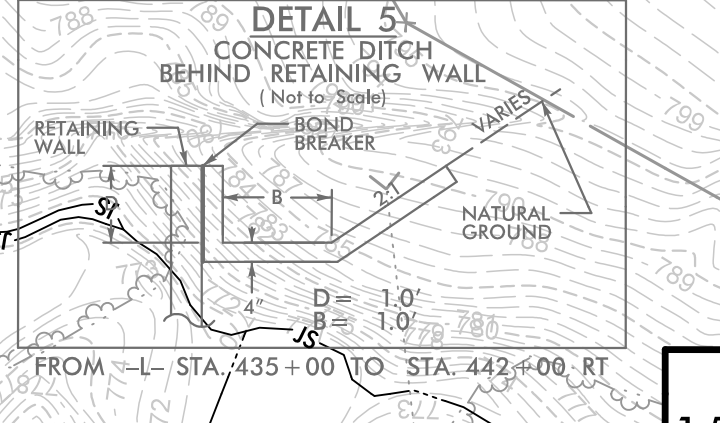
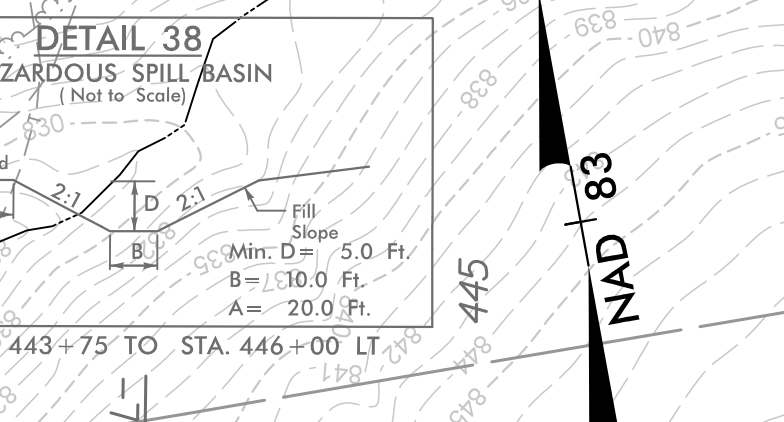
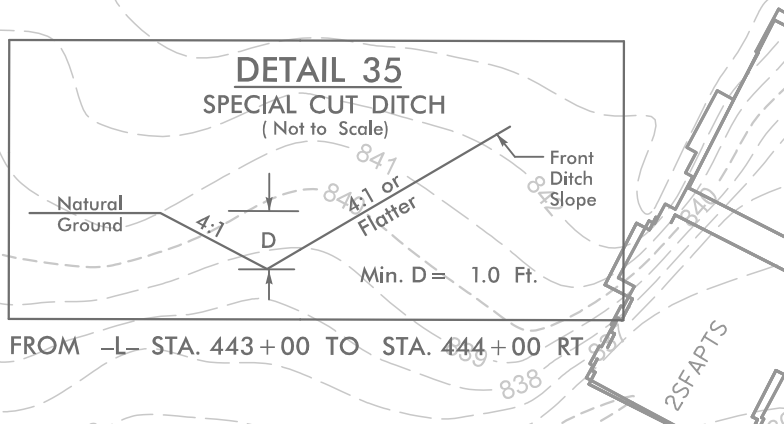
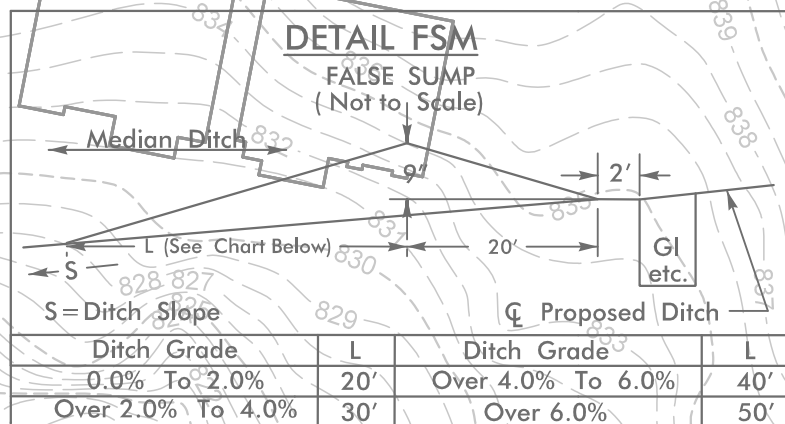
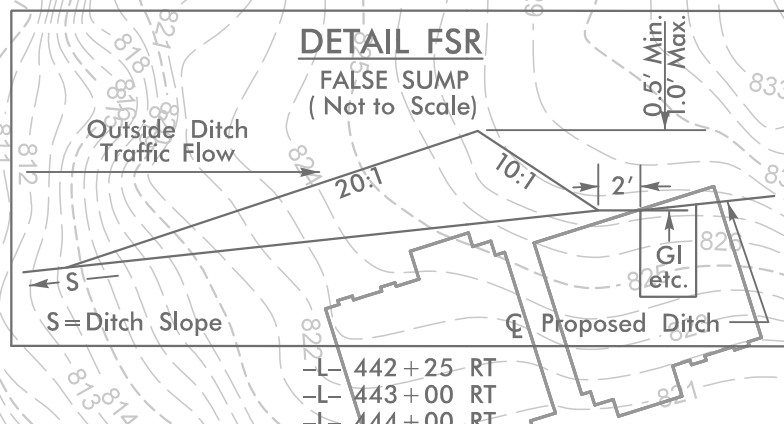
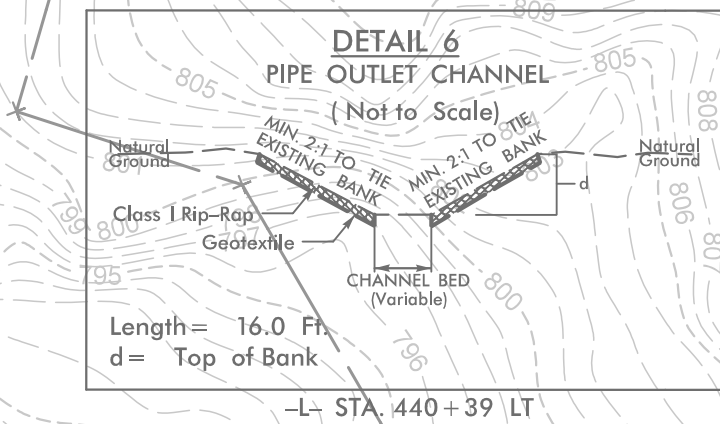

74 x 37 x 2
 1.5 inch Skimmer
 with 1.125 inch
 Orifice Diameter
 10 ft. weir
 ID 6.1

INSTALL PIPE(S) IN JURISDICTIONAL AREAS WITHOUT IMPACTING STREAM UNTIL AREA STABILIZED AND ACCORDING TO NCDOT BEST MANAGEMENT PRACTICES FOR CONSTRUCTION AND MAINTENANCE ACTIVITIES MANUAL.

NOTE:
 PLACE TEMPORARY ROCK SEDIMENT DAMS TYPE - B AND TEMPORARY ROCK SILT CHECKS TYPE - A AT DRAINAGE OUTLETS.

CLASS 'I' RIP-RAP
 EST. 26 TONS
 EST. 50 SYG
 INO RIP-RAP IS TO BE PLACED IN STREAM BED. SEE DETAIL 6.

80 x 37 x 3
 1.5 inch Skimmer
 with 1.5 inch
 Orifice Diameter
 11 ft. weir
 ID 6.3

Modified Silt Basin
 Type 'B'
 30 x 19 x 3
 4 ft. weir
 (See Tiered Skimmer Basin Detail)
 ID 6.2

30 x 19 x 3
 1.5 inch Skimmer
 with 0.75 inch
 Orifice Diameter
 4 ft. weir
 (See Tiered Skimmer Basin Detail)
 ID 6.2

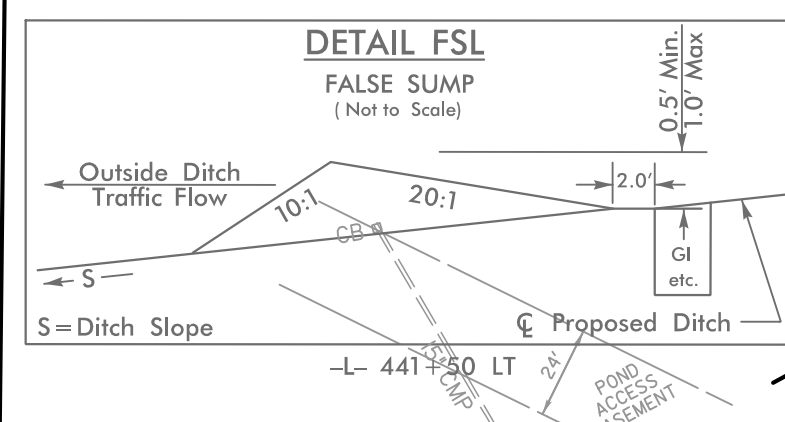

MATCH LINE SEE SHEET 11

UTILIZE FABRIC INSERT INLET PROTECTION DEVICE IN LIEU OF ROCK INLET SEDIMENT TRAP TYPE 'C' TO AVOID IMPOUNDING RUNOFF ON ROADWAY OPEN TO PUBLIC AND AS DIRECTED.

NOTE:
 SEE SHEET 2B-1 FOR BRIDGE SKETCH
 SEE SHEET 2B-2 FOR CURVE DATA
 SEE SHEET 16 FOR -L- PROFILE
 SEE SHEET 20 FOR -Y6A- PROFILE
 SEE SHEET 21 FOR -Y6- PROFILE

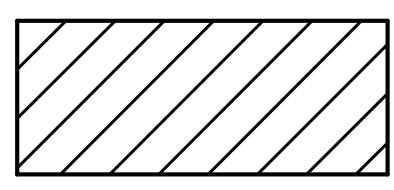

ENVIRONMENTALLY SENSITIVE AREA
 SEE PROJECT SPECIAL PROVISIONS

MATCH LINE SEE SHEET 11