

5/28/99

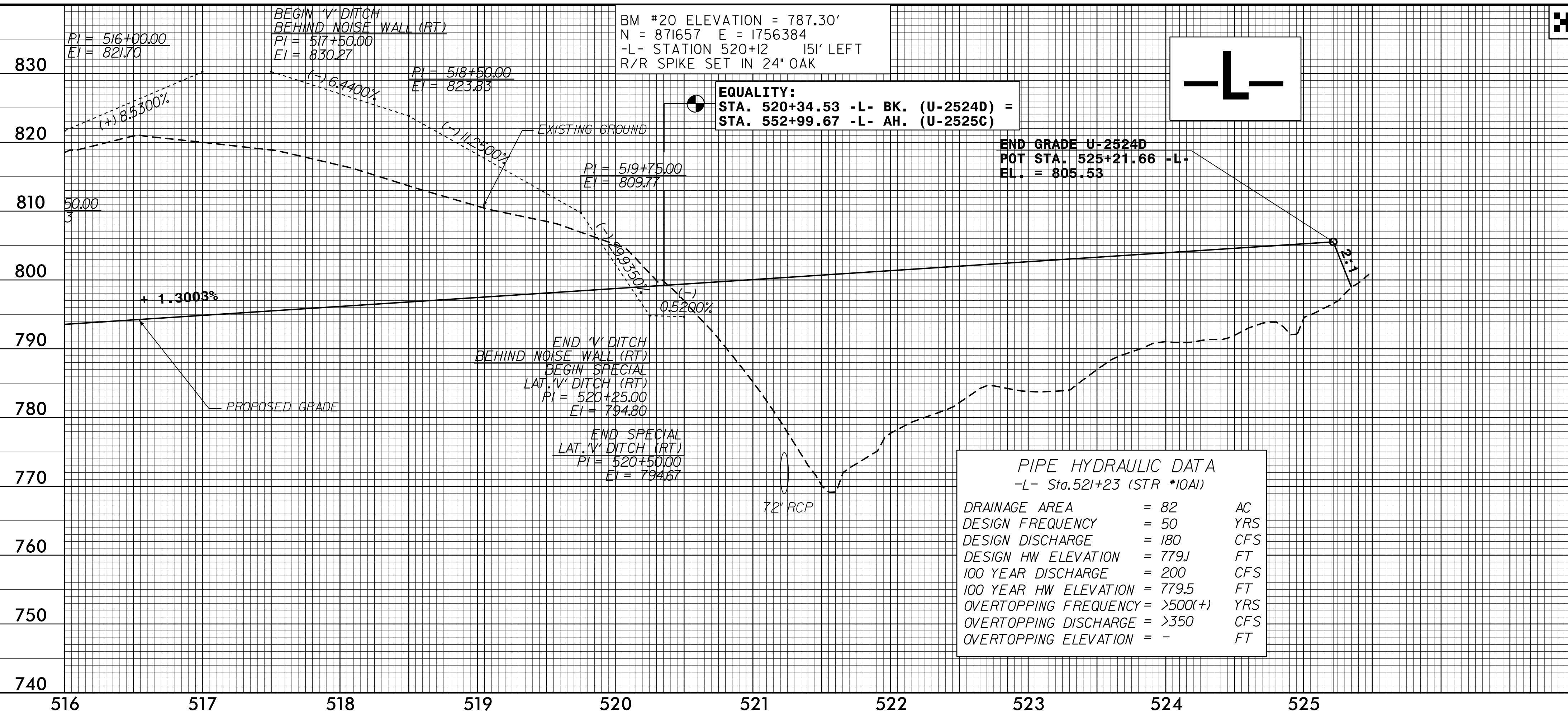

**EQUALITY:**  
 STA. 520+34.53 -L- BK. (U-2524D) =  
 STA. 552+99.67 -L- AH. (U-2525C)

**END GRADE U-2524D**  
 POT STA. 525+21.66 -L-  
 EL. = 805.53

**END 'V' DITCH  
 BEHIND NOISE WALL (RT)**  
 BEGIN SPECIAL  
 LAT. 'V' DITCH (RT)  
 PI = 520+25.00  
 EI = 794.80

**END SPECIAL  
 LAT. 'V' DITCH (RT)**  
 PI = 520+50.00  
 EI = 794.67

PIPE HYDRAULIC DATA		
-L- Sta. 521+23 (STR *10AI)		
DRAINAGE AREA	= 82	AC
DESIGN FREQUENCY	= 50	YRS
DESIGN DISCHARGE	= 180	CFS
DESIGN HW ELEVATION	= 779.1	FT
100 YEAR DISCHARGE	= 200	CFS
100 YEAR HW ELEVATION	= 779.5	FT
OVERTOPPING FREQUENCY	= >500(+)	YRS
OVERTOPPING DISCHARGE	= >350	CFS
OVERTOPPING ELEVATION	= -	FT

DITCH LEGEND	
RIGHT DITCH	-----

**NOTE:**  
 SEE SHEETS 9 & 10 FOR -L- PLAN

**HNTB**  
 HNTB NORTH CAROLINA, P.C.  
 249 S. 51st Street, Suite 200  
 Raleigh, North Carolina 27609  
 NC License No. C-1584

**PLANS PREPARED BY:**  
**PARSONS**  
 RALEIGH, NORTH CAROLINA, (99) 854-1345  
 NC LICENSE NO. F-0246  
 FOR NORTH CAROLINA DEPT. OF TRANSPORTATION

PROJECT REFERENCE NO.	SHEET NO.
U-2524D	19

ROADWAY DESIGN ENGINEER	HYDRAULICS ENGINEER
<i>(Signature)</i>	<i>(Signature)</i>

**DOCUMENT NOT CONSIDERED FINAL  
 UNLESS ALL SIGNATURES COMPLETED**

21:11:53 2016 2:35:53 \\msb01\project\U2524D\_RDY\_PSH\_19.dgn  
 5:55:53 USER:NAME