

# I-73 EXIT 95A TO I-85 N RAMP D AND LOOP C

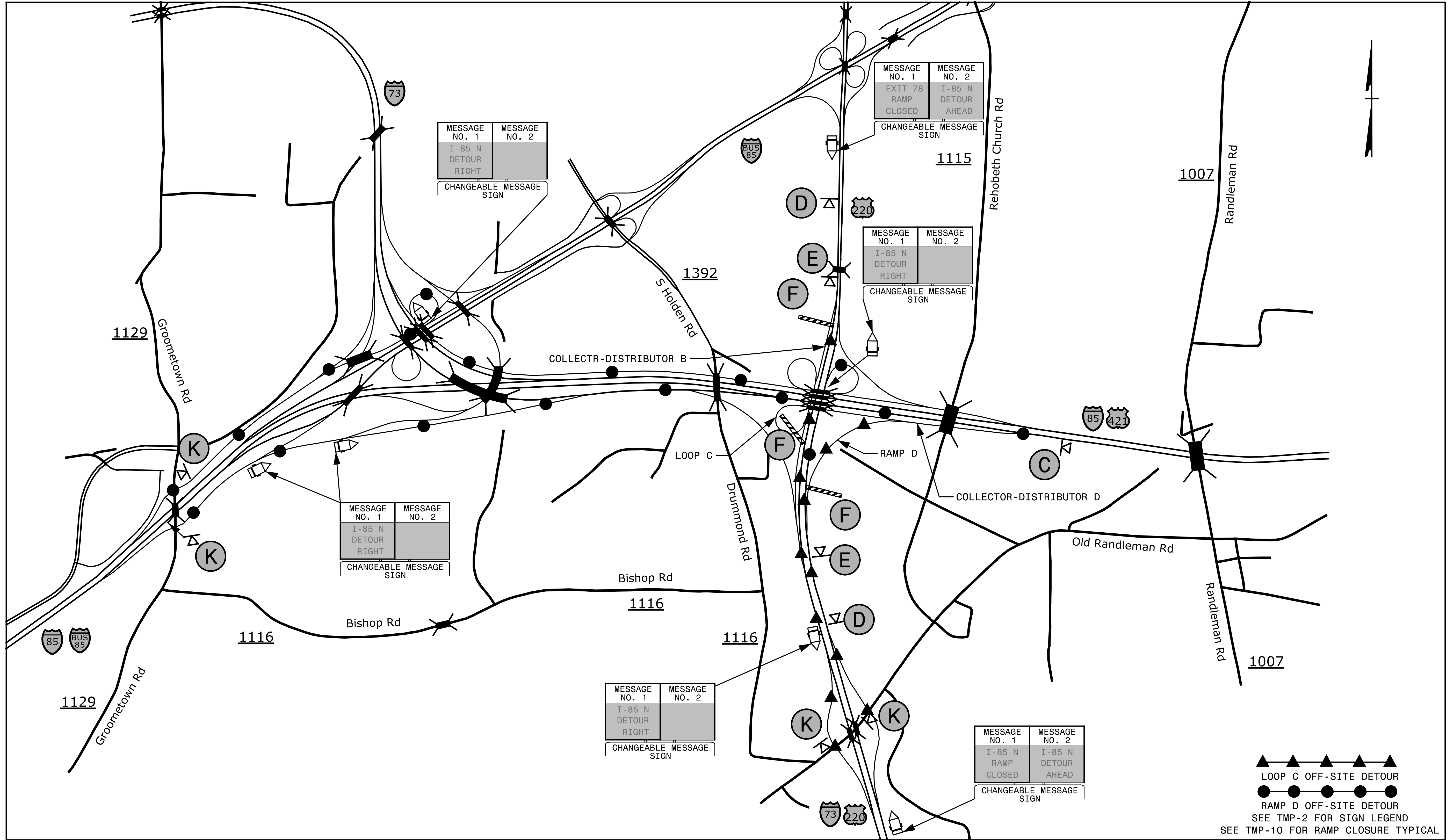

5/26/2016  
G:\Traffic\TR16.006.00 NCDOT 2016 Traffic LSA\TR16.006.04 (I-5854)\I-5854 TMP-8.dgn  
SWiller

**SEPI**  
ENGINEERING & CONSTRUCTION

1025 Wade Avenue  
Raleigh, NC 27605  
Tel: 919-789-9977  
Fax: 919-789-9591  
License: C-2197

APPROVED: *Steve Miller*  
DATE: 6/13/2016

SEAL

DOCUMENT NOT CONSIDERED FINAL  
UNLESS ALL SIGNATURES COMPLETED

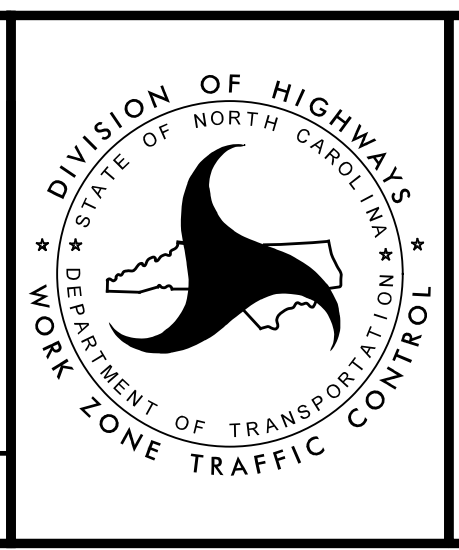

DIVISION OF HIGHWAYS  
STATE OF NORTH CAROLINA  
DEPARTMENT OF TRANSPORTATION  
WORK ZONE TRAFFIC CONTROL

**OFF-SITE  
DETOUR  
DETAIL**