

I-85 EXIT 122C RAMP A

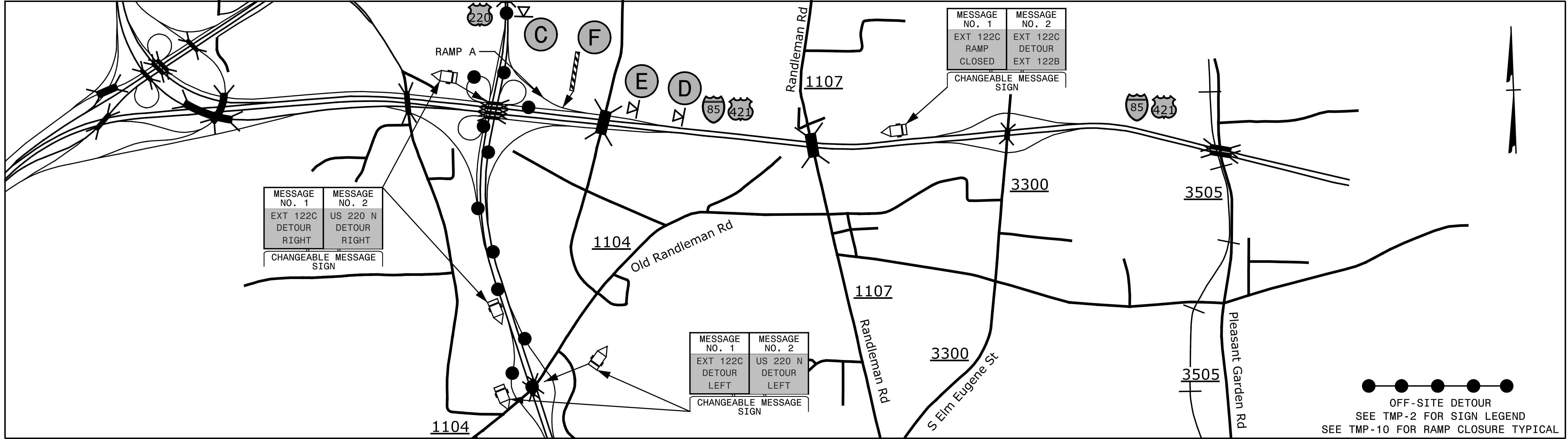

I-73 EXIT 95B LOOP A

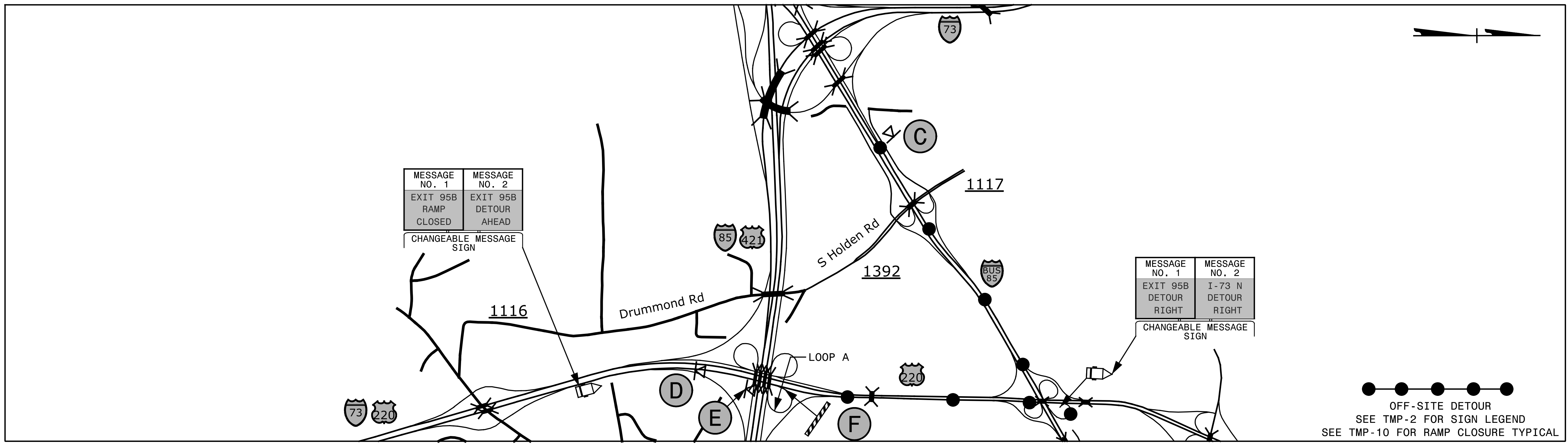

5/25/2016 G:\Traffic\TR16.006.00 NCDOT 2016 Traffic LSA\TR16.006.04 (I-5854)\I-5854 TMP-6.dgn

SEPI
ENGINEERING & CONSTRUCTION

1025 Wade Avenue
Raleigh, NC 27605
Tel: 919-789-9977
Fax: 919-789-9591
License: C-2197

APPROVED: Steve Miller
DATE: 6/13/2016

SEAL

DOCUMENT NOT CONSIDERED FINAL
UNLESS ALL SIGNATURES COMPLETED

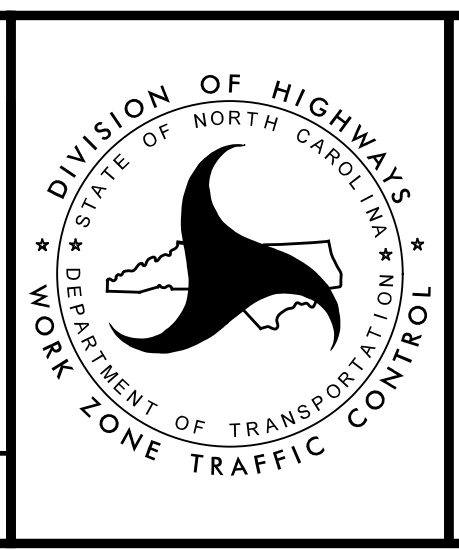

DIVISION OF HIGHWAYS
STATE OF NORTH CAROLINA
DEPARTMENT OF TRANSPORTATION
WORK ZONE TRAFFIC CONTROL

**OFF-SITE
DETOUR
DETAIL**