

PLAN VIEW FOR RETAINING WALL NO. 4 & NO. 5
 N.T.S.

ESTIMATED RETAINING WALL NO. 6 QUANTITIES	
MSE RETAINING WALL NO. 6	2,600 SF
CIP MSE RETAINING WALL NO. 6 (ALTERNATE)	

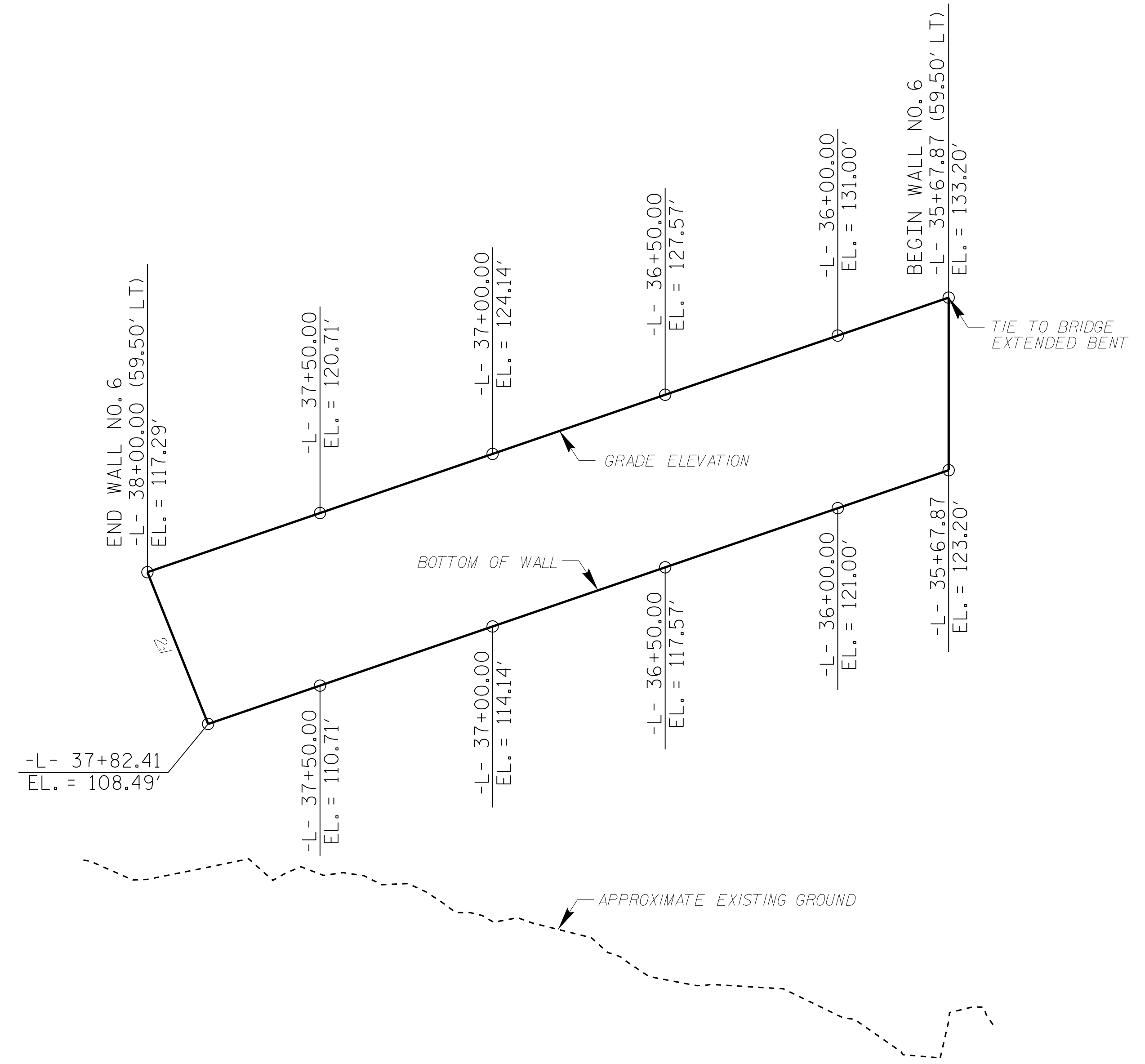

WALL ENVELOPE FOR RETAINING WALL NO. 6
 EXPOSED WALL FACE VIEW, N.T.S.

PROJECT NO.: B-4490 (33727.1.1)
 CUMBERLAND COUNTY
 STATION: 35+68.00 -L-
 SHEET 5 OF 11