

PROJECT REFERENCE NO. B-4490	SHEET NO. EC-10/CONST.10
RW SHEET NO.	
ROADWAY DESIGN ENGINEER	HYDRAULICS ENGINEER

CLEARING AND GRUBBING  
EROSION CONTROL FOR  
CONSTRUCTION SHEET 10

NOTE:  
PLACE TEMPORARY ROCK SEDIMENT DAMS TYPE - B  
AND TEMPORARY ROCK SILT CHECKS TYPE - A AT  
DRAINAGE OUTLETS.

NOTE:  
UTILIZE FABRIC INSERT INLET PROTECTION DEVICE IN LIEU OF ROCK  
INLET SEDIMENT TRAP TYPE C AT LOCATIONS WHERE RIST-C CANNOT  
BE PROPERLY INSTALLED OR IN AREAS WHERE RIST-C MAY POND WATER  
ON ROADWAY OPEN TO TRAFFIC.

8/17/99  
31-AUG-2015 15:55  
D:\enviro\enviro\B4490-EC.psh.10.dgn  
ENVIRONMENTAL  
ENGINEERING

MATCH LINE SEE SHEET 9  
-L- STA. 38+40.00

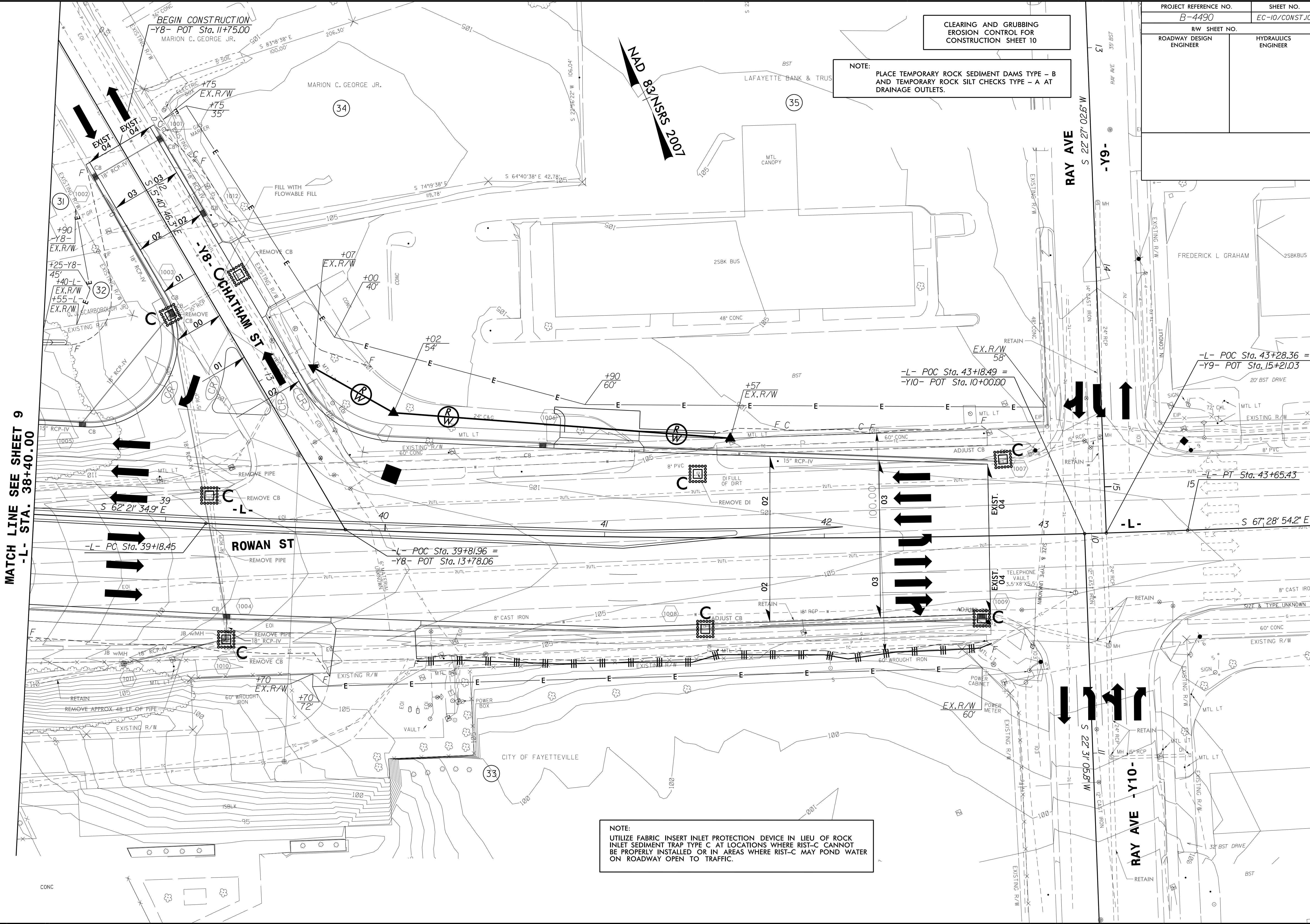

NAD 83/NRS 2007

