

PROJECT REFERENCE NO.	SHEET NO.
B-4490	EC-5/CONST.5
RW SHEET NO.	
ROADWAY DESIGN ENGINEER	HYDRAULICS ENGINEER

NOTE: PLACE TEMPORARY ROCK SEDIMENT DAMS TYPE - B AND TEMPORARY ROCK SILT CHECKS TYPE - A AT DRAINAGE OUTLETS.

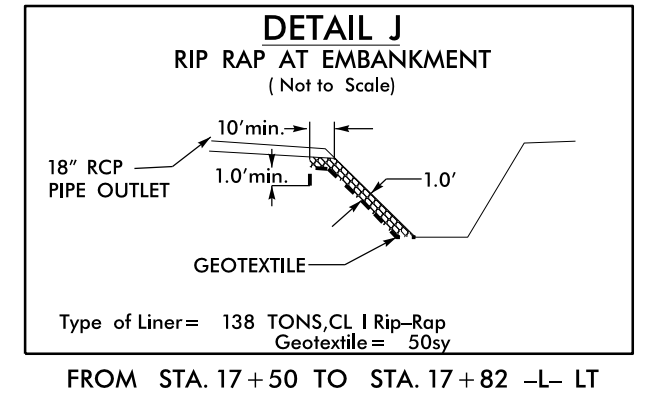

8/17/99
21-AUG-2015 15:33
R:\E\4490\Drawings\B4490-EC.pch_05.dgn
R:\E\4490\Drawings\REV\REV1.dwg

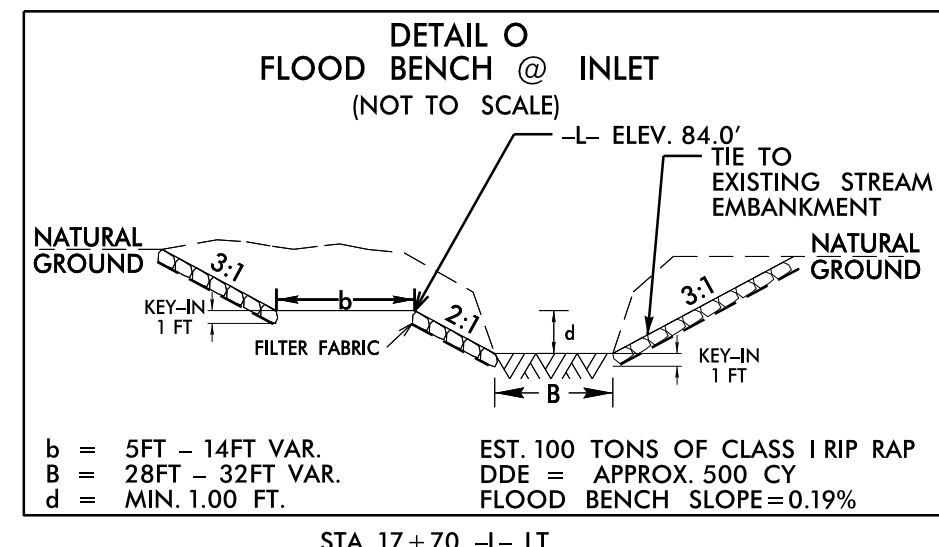
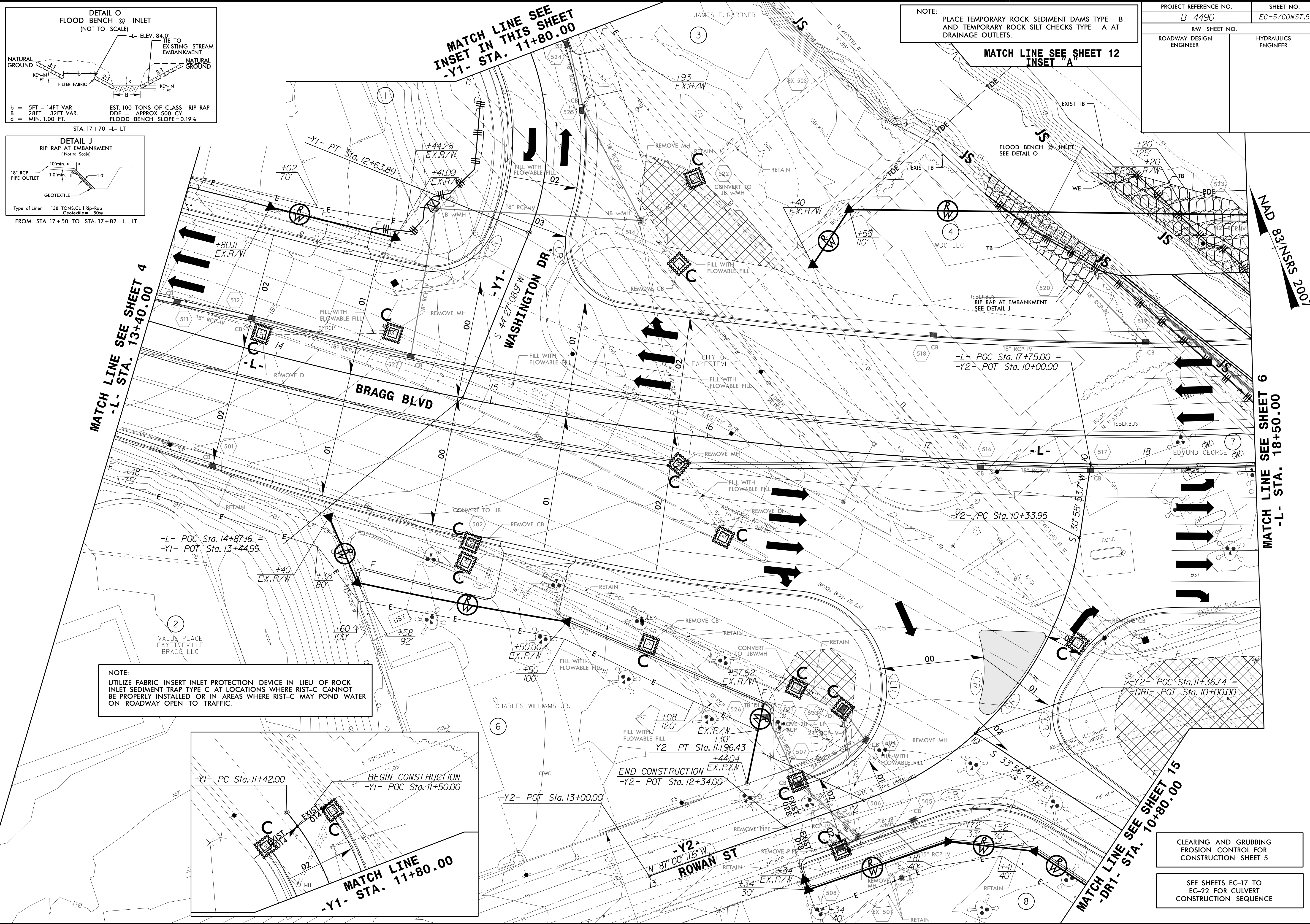

NOTE: UTILIZE FABRIC INSERT INLET PROTECTION DEVICE IN LIEU OF ROCK INLET SEDIMENT TRAP TYPE C AT LOCATIONS WHERE RIST-C CANNOT BE PROPERLY INSTALLED OR IN AREAS WHERE RIST-C MAY POND WATER ON ROADWAY OPEN TO TRAFFIC.

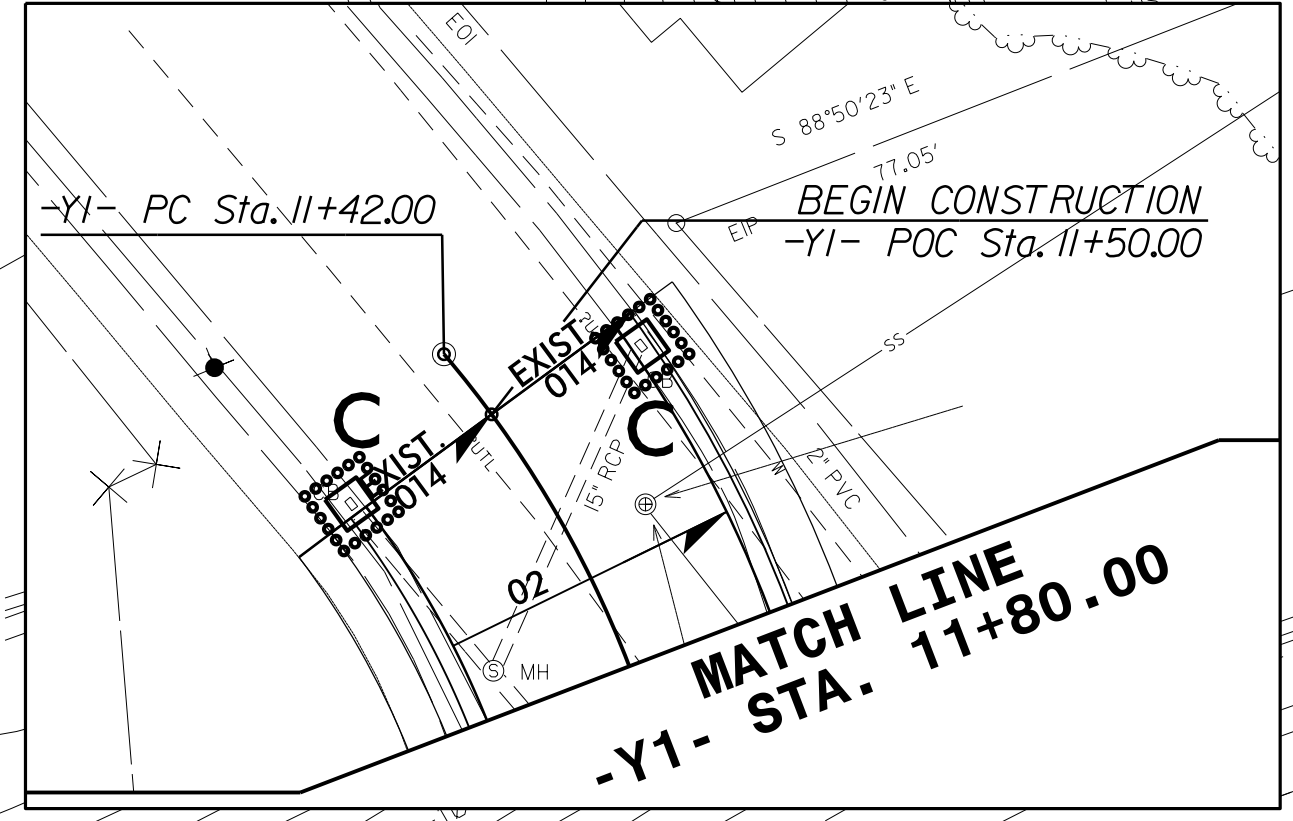

CLEARING AND GRUBBING EROSION CONTROL FOR CONSTRUCTION SHEET 5
SEE SHEETS EC-17 TO EC-22 FOR CULVERT CONSTRUCTION SEQUENCE