

ARC OFFSETS (LEFT SIDE)

(SPANS "N", "P", "O", "S", "T" AND "V")

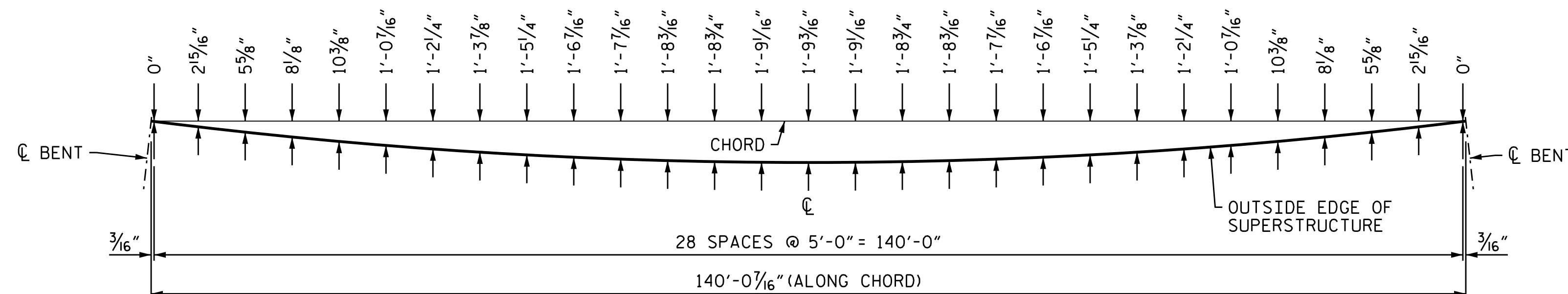

ARC OFFSETS (RIGHT SIDE)

(SPANS "N", "P", "O", "S", "T" AND "V")

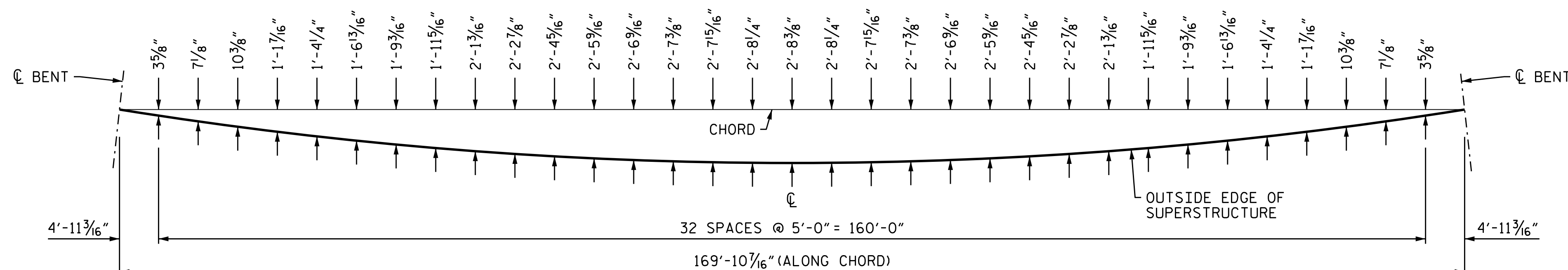

ARC OFFSETS (LEFT SIDE)

(SPANS "O", "R" AND "U")

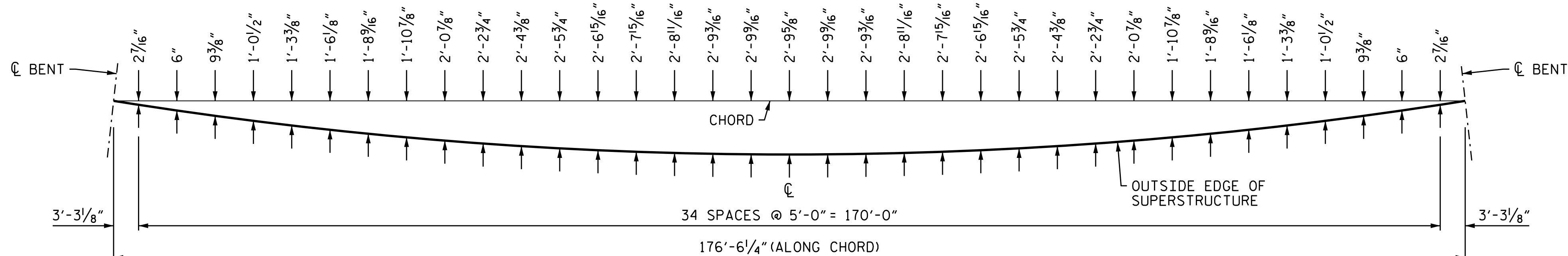

ARC OFFSETS (RIGHT SIDE)

(SPANS "O", "R" AND "U")

PROJECT NO. B-4929
PENDER COUNTY
 STATION: 38+13.81 -L2-

STEEL ALTERNATE

6/1/2016

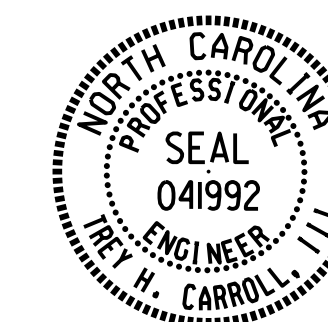

DocuSigned by:
 T. H. Carroll, III
 C61626EDD0C748E

STATE OF NORTH CAROLINA DEPARTMENT OF TRANSPORTATION RALEIGH					
SUPERSTRUCTURE					
ARC OFFSETS					
REVISIONS					
NO.	BY:	DATE:	NO.	BY:	DATE:
1			3		
2			4		
SHEET NO.					S-234
TOTAL SHEETS					278

DRAWN BY : K. WHITE DATE : FEB 2016
 CHECKED BY : T. H. CARROLL DATE : FEB 2016
 DESIGN ENGINEER OF RECORD: T. H. CARROLL DATE : MAY 2016

DOCUMENT NOT CONSIDERED
 FINAL UNLESS ALL
 SIGNATURES COMPLETED