

NOTES

FOR NOTES, SEE SHEET 1 OF 5.

FOR BAR TYPES, SEE SHEET 5 OF 5.

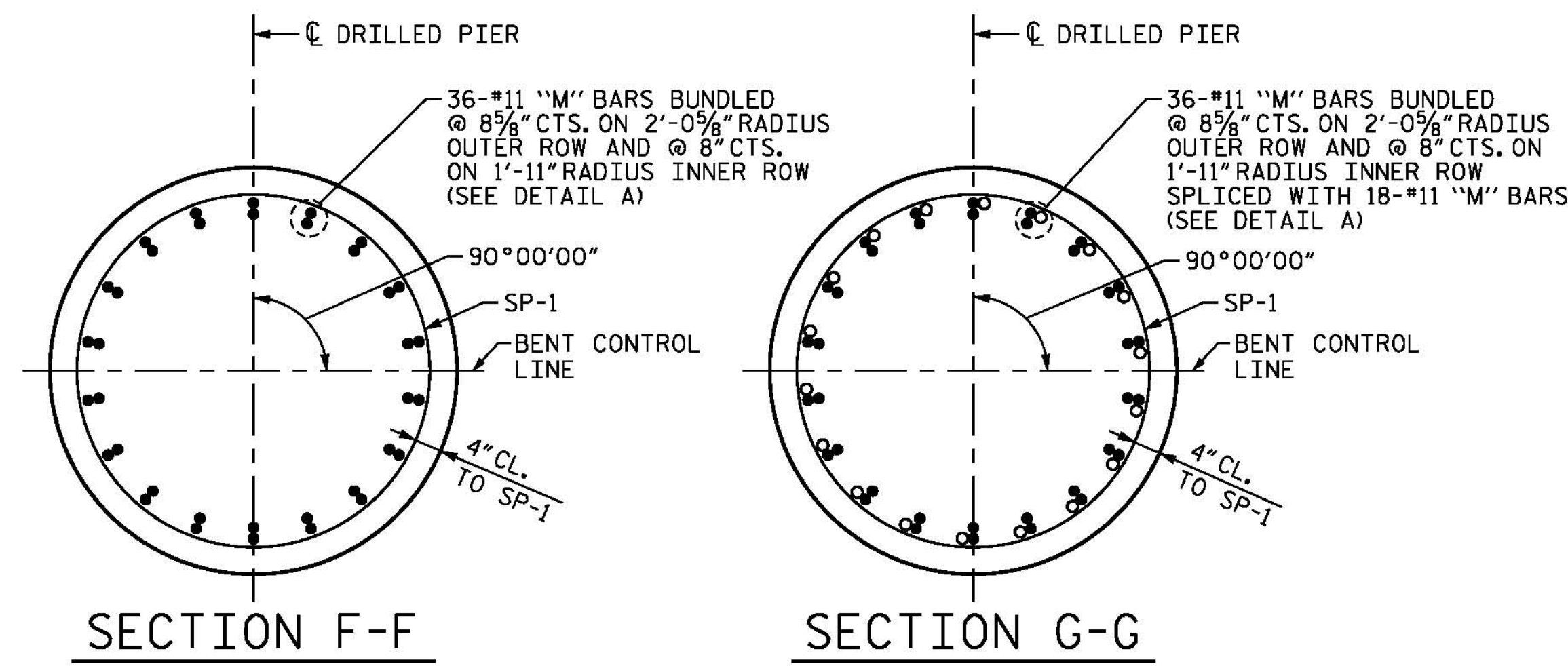
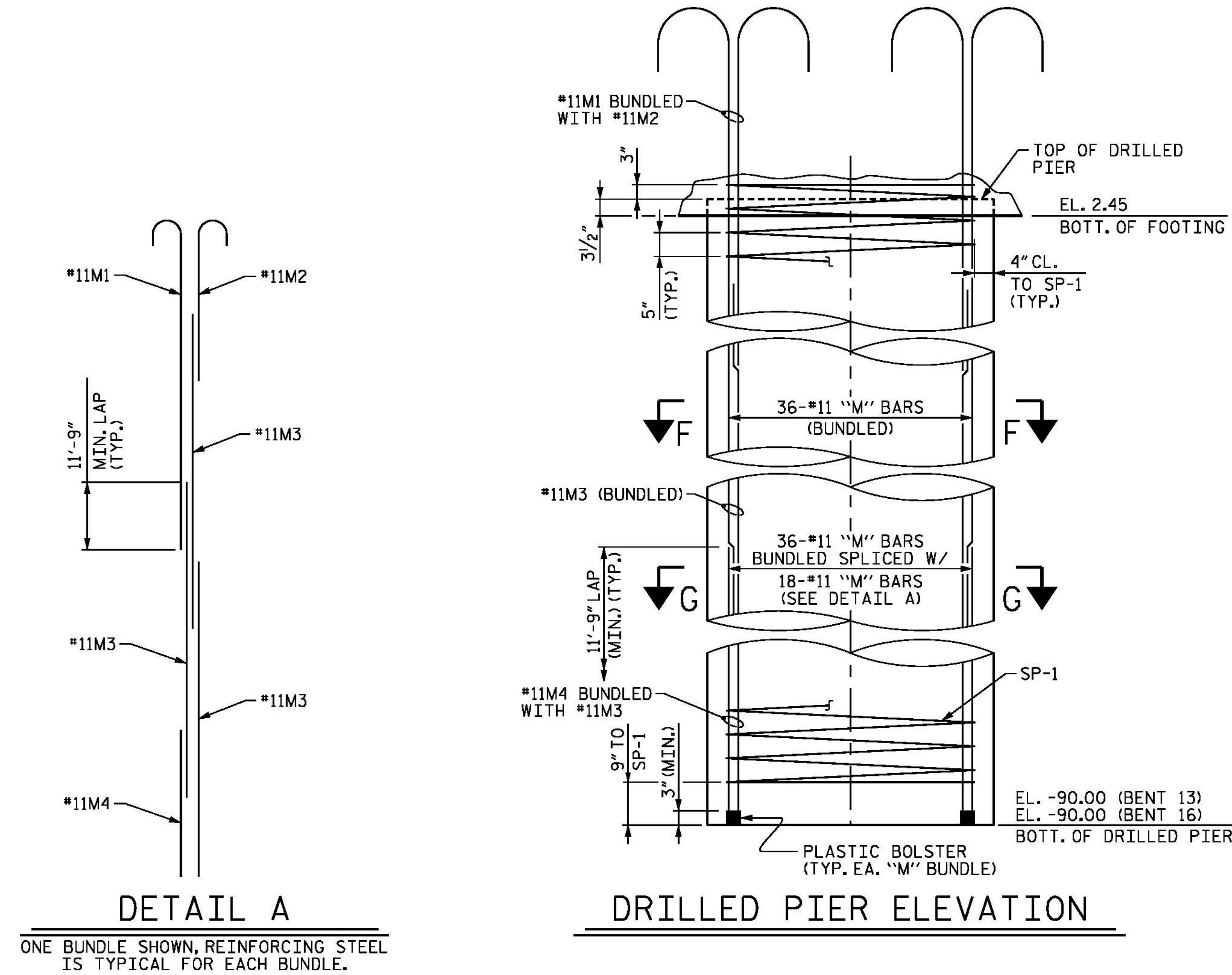

BILL OF MATERIAL

BENT 13

BAR	NUMBER	SIZE	TYPE	LENGTH	WEIGHT	BAR	NUMBER	SIZE	TYPE	LENGTH	WEIGHT
B1	10	#11	1	53'-0"	2816	T1	93	9	STR	54'-4"	17180
B2	10	#11	STR	49'-10"	2648	T2	134	9	STR	24'-4"	11086
B3	8	#10	STR	40'-4"	1388	T3	83	6	STR	24'-4"	3034
B4	6	#10	STR	42'-0"	1084	T4	20	6	STR	54'-4"	1632
B5	8	#10	2	10'-0"	344	T5	138	5	STR	7'-2"	1032
B6	8	#10	3	10'-0"	344	T6	316	5	9	8'-6"	2801
B7	14	#7	STR	49'-10"	1426						
B8	2	#7	STR	47'-4"	193	U1	116	4	9	6'-0"	465
B9	2	#7	STR	44'-8"	183	U2	10	4	9	7'-4"	49
B10	20	#4	STR	6'-3"	84	U3	5	4	9	8'-2"	27
B11	10	#4	STR	5'-2"	35	U4	5	4	9	8'-0"	27
B12	24	#4	STR	4'-6"	72						
B13	20	#4	STR	12'-2"	163	V1	36	11	4	47'-5"	9069
						V2	36	11	4	48'-3"	9229
D1	26	#6	STR	39'-4"	1536	V3	72	11	8	21'-2"	8097
D2	48	#5	9	10'-4"	517						
M1	144	#11	4	46'-2"	35321						
M2	144	#11	4	22'-10"	17469						
M3	432	#11	STR	50'-0"	114761						
M4	144	#11	STR	26'-8"	20402						
S1	110	#5	5	4'-1"	468						
S2	66	#5	6	19'-0"	1308						
S3	2	#5	6	18'-9"	39						
S4	2	#5	6	18'-4"	38						
S5	2	#5	6	17'-11"	37						
S6	2	#5	6	17'-5"	36						
S7	2	#5	6	17'-0"	35						
S8	2	#5	6	16'-7"	35						
S9	2	#5	6	16'-2"	34	SP-1	8	*	10	3,019'-5"	25,194
S10	2	#5	6	15'-8"	33						
S11	2	#5	6	15'-3"	32						
S12	2	#5	6	14'-10"	31						
S13	2	#5	6	14'-5"	30						
S14	2	#5	6	18'-11"	39						
S15	2	#5	6	18'-7"	39						
S16	2	#5	6	18'-3"	38						
S17	2	#5	6	17'-9"	37						
S18	2	#5	6	17'-5"	36						
S19	2	#5	6	17'-0"	35						
S20	2	#5	6	16'-7"	35						
S21	2	#5	6	16'-3"	34						
S22	2	#5	6	15'-10"	33						
S23	2	#5	6	15'-5"	32						
S24	2	#5	6	15'-0"	31						
S25	24	#5	6	20'-4"	509						
S26	530	#5	7	14'-1"	7785						
S27	1060	#5	11	4'-6"	4975						
EPOXY COATED REINFORCING STEEL LBS. 280,328											
EPOXY COATED SPIRAL COLUMN REINFORCING STEEL LBS. 25,194											
CLASS "AA" CONCRETE BREAKDOWN											
POUR #2 - FOOTING C.Y. 412.4											
POUR #3 - STRUT C.Y. 61.5											
POUR #4 - COLUMNS C.Y. 91.8											
POUR #5 - CAP C.Y. 75.4											
CLASS "AA" CONCRETE C.Y. 641.1											
5'-0" Ø DRILLED PIERS QUANTITIES:											
DRILLED PIER LIN. FT. 741.9											
POUR 1 - DRILLED PIER C.Y. 539.6											
PERMANENT STEEL CASING FOR 5'-0" Ø DRILLED PIERS LIN. FT. 245.9											
CSL TUBES LIN. FT. 3,770											

\* THE SP-1 SPIRAL REINFORCING STEEL SHALL BE W31 OR D-31 COLD DRAWN WIRE OR #5 PLAIN DEFORMED BAR.

PROJECT NO. B-4929

PENDER COUNTY

STATION: 38+13.81 -L2-

SHEET 4 OF 5

STATE OF NORTH CAROLINA  
DEPARTMENT OF TRANSPORTATION  
RALEIGH

SUBSTRUCTURE

BENTS 13 AND 16  
BILL OF MATERIALS

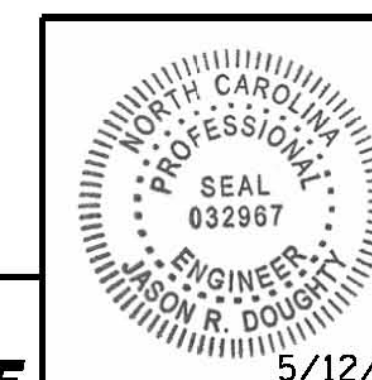

DocuSigned by:  
Jason R. Doughty

**PARSONS BRINCKERHOFF**  
434 FAYETTEVILLE STREET  
SUITE 1500  
RALEIGH, NC 27601  
LICENSE NO. F-0165

DOCUMENT NOT CONSIDERED FINAL  
UNLESS ALL SIGNATURES COMPLETED

REVISIONS

NO.	BY:	DATE:	NO.	BY:	DATE:
1			3		
2			4		

SHEET NO.  
**S-173**  
TOTAL SHEETS  
278

5/10/2016  
400\_339\_B4929\_SMU\_IB13\_4.dgn

DESIGNED BY: E. ULLMER DATE: MAR 2016  
DRAWN BY: M. HOBBS DATE: MAR 2016  
CHECKED BY: B. LOFLIN DATE: MAR 2016  
DESIGN ENGINEER OF RECORD: J. DOUGHTY DATE: MAY 2016