

NOTES

FOR NOTES, SEE SHEET 1 OF 5.

BAR TYPES

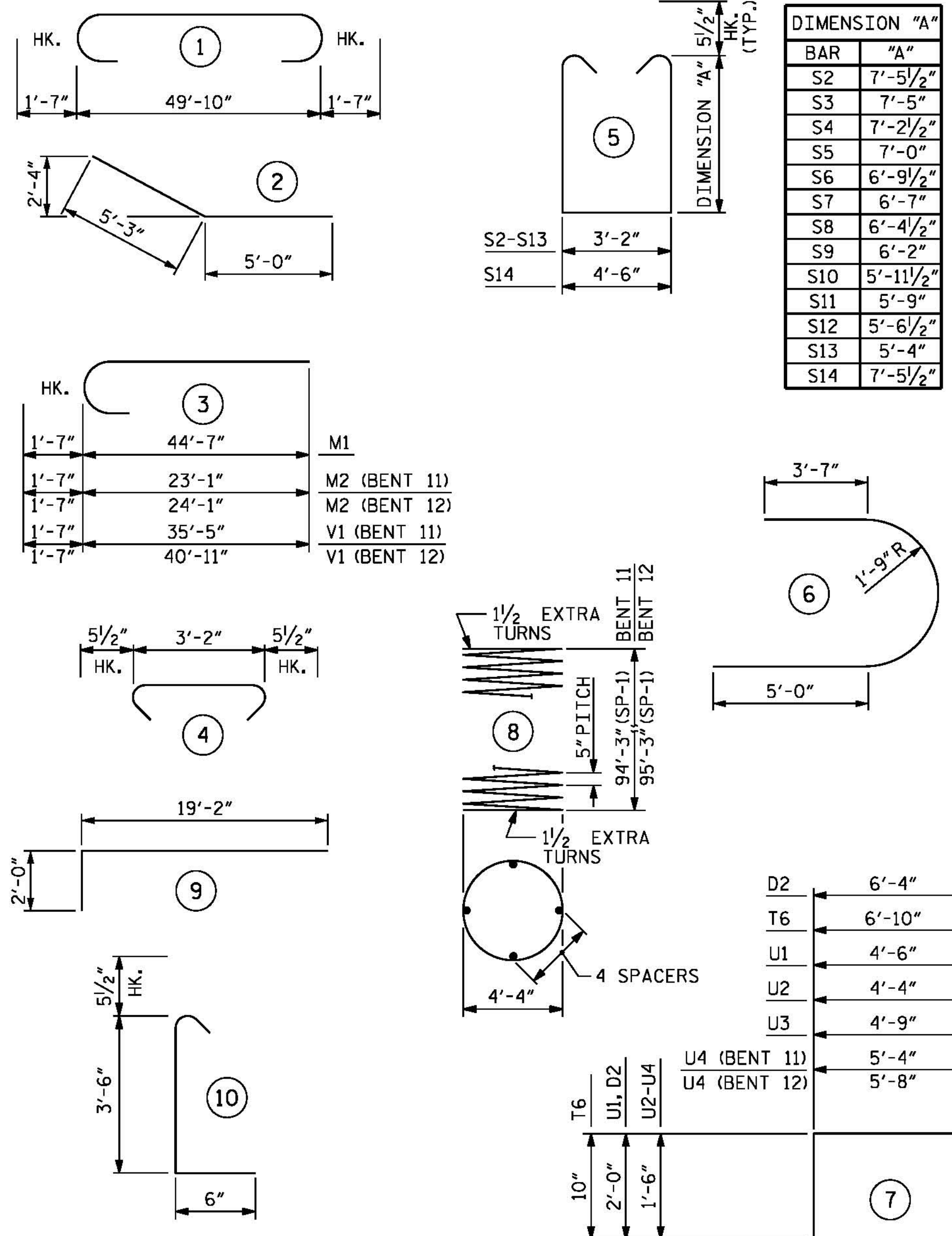

ALL BAR DIMENSIONS ARE OUT TO OUT.

* THE SP-1 SPIRAL REINFORCING STEEL SHALL BE W31 OR D-31 COLD DRAWN WIRE OR #5 PLAIN DEFORMED BAR.

BILL OF MATERIAL

BENT 12

BAR	NUMBER	SIZE	TYPE	LENGTH	WEIGHT	BAR	NUMBER	SIZE	TYPE	LENGTH	WEIGHT
B1	10	#11	1	53'-0"	2816	T1	93	#9	STR	54'-4"	17180
B2	10	#11	STR	49'-10"	2648	T2	134	#9	STR	24'-4"	11086
B3	8	#10	STR	40'-4"	1388	T3	83	#6	STR	24'-4"	3034
B4	6	#10	STR	42'-0"	1084	T4	20	#6	STR	54'-4"	1632
B5	16	#10	2	10'-3"	706	T5	138	#5	STR	7'-2"	1032
B6	14	#7	STR	49'-10"	1426	T6	316	#5	7	8'-6"	2801
B7	2	#7	STR	47'-4"	193						
B8	2	#7	STR	44'-8"	183	U1	66	#4	7	8'-6"	375
B9	10	#4	STR	10'-11"	73	U2	10	#4	7	7'-4"	49
B10	10	#4	STR	22'-1"	148	U3	5	#4	7	7'-9"	29
B11	24	#4	STR	4'-6"	72	U4	5	#4	7	8'-8"	26
B12	10	#4	STR	5'-2"	35						
						V1	72	#11	3	42'-6"	16258
						V2	72	#11	9	21'-2"	8097
D1	26	#6	STR	39'-4"	1536						
D2	48	#5	7	10'-4"	517						
M1	144	#11	3	46'-2"	35321						
M2	144	#11	3	25'-8"	19637						
M3	432	#11	STR	50'-0"	114761						
M4	144	#11	STR	29'-8"	22697						
S1	110	#5	4	4'-1"	468						
S2	66	#5	4	19'-0"	1308						
S3	4	#5	5	18'-11"	79						
S4	4	#5	5	18'-6"	77						
S5	4	#5	5	18'-1"	75						
S6	4	#5	5	17'-8"	74						
S7	4	#5	5	17'-3"	72						
S8	4	#5	5	16'-10"	70						
S9	4	#5	5	16'-5"	68						
S10	4	#5	5	16'-0"	67						
S11	4	#5	5	15'-7"	65						
S12	4	#5	5	15'-2"	63						
S13	4	#5	5	14'-9"	62						
S14	24	#5	5	20'-4"	509						
S15	154	#5	6	14'-1"	2262						
S16	308	#5	10	4'-6"	1446						
EPOXY COATED REINFORCING STEEL LBS. 273,605											
EPOXY COATED SPIRAL COLUMN REINFORCING STEEL LBS. 26,002											
CLASS "AA" CONCRETE BREAKDOWN											
POUR #2 - FOOTING C.Y. 412.4											
POUR #3 - STRUT C.Y. 61.5											
POUR #4 - COLUMNS C.Y. 79.2											
POUR #5 - CAP C.Y. 75.7											
CLASS "AA" CONCRETE C.Y. 628.8											
5'-0" Ø DRILLED PIERS QUANTITIES:											
DRILLED PIER LIN. FT. 765.9											
POUR 1 - DRILLED PIER C.Y. 557.1											
PERMANENT STEEL CASING FOR 5'-0" Ø DRILLED PIERS LIN. FT. 197.9											
CSL TUBES LIN. FT. 3,890											

PROJECT NO. B-4929
PENDER COUNTY
 STATION: 38+13.81 -L2-

SHEET 5 OF 5

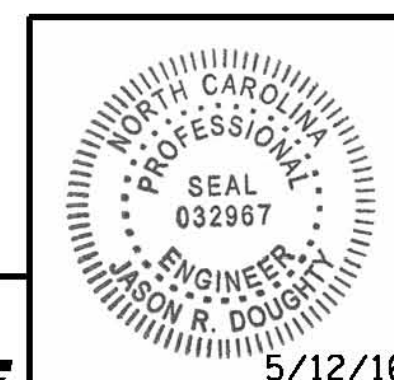

PARSONS BRINCKERHOFF
 434 FAYETTEVILLE STREET
 SUITE 1500
 RALEIGH, NC 27601
 LICENSE NO. F-0165

DocuSigned by:
 Jason R Doughty
 00F1C88448274F7...

STATE OF NORTH CAROLINA
 DEPARTMENT OF TRANSPORTATION
 RALEIGH
 SUBSTRUCTURE
 BENTS 11 AND 12
 BILL OF MATERIALS

REVISIONS						SHEET NO.
NO.	BY:	DATE:	NO.	BY:	DATE:	TOTAL SHEETS
1			3			278
2			4			

DOCUMENT NOT CONSIDERED FINAL UNLESS ALL SIGNATURES COMPLETED

5/10/2016 400_331_B4929_SMJ_IB11_5.dgn

DESIGNED BY: E. ULLMER DATE: MAR 2016
 DRAWN BY: M. HOBBS DATE: MAR 2016
 CHECKED BY: B. LOFLIN DATE: MAR 2016
 DESIGN ENGINEER OF RECORD: J. DOUGHTY DATE: MAY 2016