

PLAN OF GIRDER

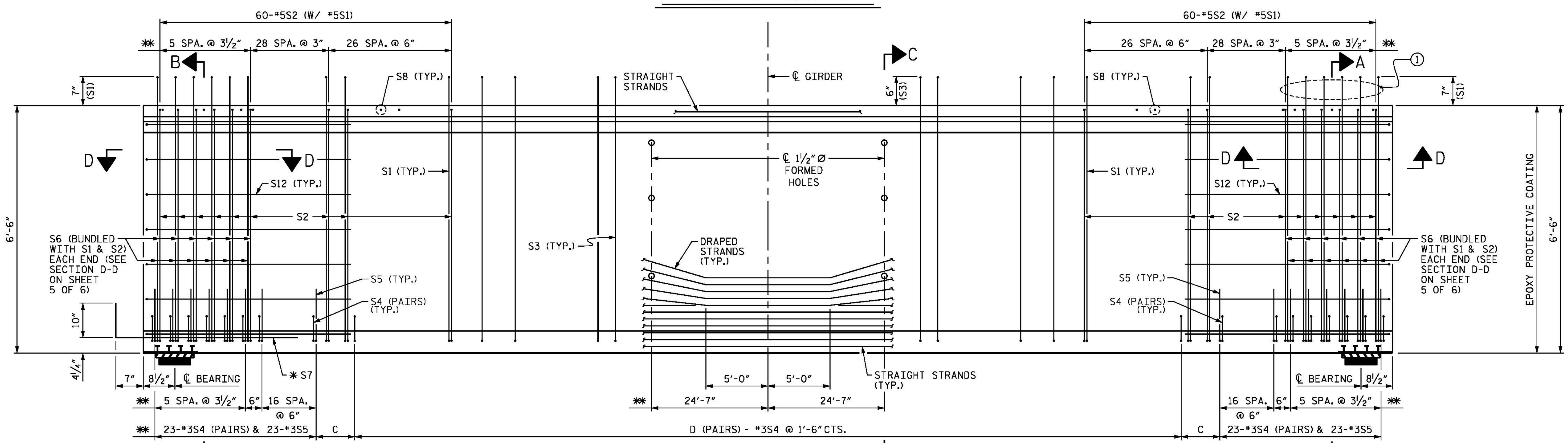

ELEVATION OF GIRDER

(FOR NOTES, SEE SHEET 1 OF 6)

SPANS S, V AND Y GIRDER DIMENSIONS							
GIRDER	L	A	B	C	D	E	F
GDRS. S1 AND V1	146'-3 1/4"	1'-5 5/8"	37	1'-5 5/8"	83	8 1/8"	129
GDRS. S2 AND V2	147'-5 7/8"	1'-3 15/16"	38	1'-3 15/16"	84	9 7/16"	130
GDRS. S3 AND V3	148'-8 1/2"	1'-2 1/4"	39	1'-2 1/4"	85	10 3/4"	131
GDRS. S4 AND V4	149'-11 1/8"	1'-0 9/16"	40	1'-0 9/16"	86	6 1/16"	133
GDRS. S5 AND V5	151'-1 7/8"	10 15/16"	41	10 15/16"	87	7 7/16"	134
GDRS. Y1 - Y5	140'-9 1/8"	11 9/16"	34	11 9/16"	80	11 1/16"	123

PROJECT NO. B-4929
PENDER COUNTY
 STATION: 38+13.81 -L2-

SHEET 4 OF 6

STATE OF NORTH CAROLINA
 DEPARTMENT OF TRANSPORTATION
 RALEIGH
 SUPERSTRUCTURE
F.I.B. 78"
 PRESTRESSED
 CONCRETE GIRDER
 (SPANS S, V AND Y)

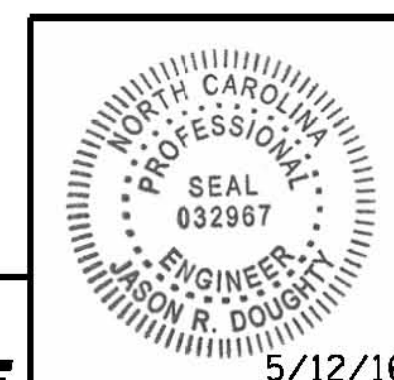

PARSONS BRINCKERHOFF
 434 FAYETTEVILLE STREET
 SUITE 1500
 RALEIGH, NC 27601
 LICENSE NO. F-0165

DocuSigned by:
 Jason R. Doughty
 00F1C8648274F7...

REVISIONS					SHEET NO.
NO.	BY:	DATE:	NO.	BY:	DATE:
1			3		
2			4		

TOTAL SHEETS: 278

DESIGNED BY: B. LOFLIN DATE: FEB 2016
 DRAWN BY: M. HOBBS DATE: FEB 2016
 CHECKED BY: J. SHERMAN DATE: FEB 2016
 DESIGN ENGINEER OF RECORD: J. DOUGHTY DATE: MAY 2016

**DOCUMENT NOT CONSIDERED FINAL
 UNLESS ALL SIGNATURES COMPLETED**

5/10/2016 400_181_B4929_SMJ_FIB78_08.dgn