

8/17/09

-LI- DETOUR AND -Y2- DETOUR

PROJECT REFERENCE NO. B-4929	SHEET NO. 2B-7
RW SHEET NO.	
ROADWAY DESIGN ENGINEER	HYDRAULICS ENGINEER
DOCUMENT NOT CONSIDERED FINAL UNLESS ALL SIGNATURES COMPLETED	



NAD 83/NA 2011

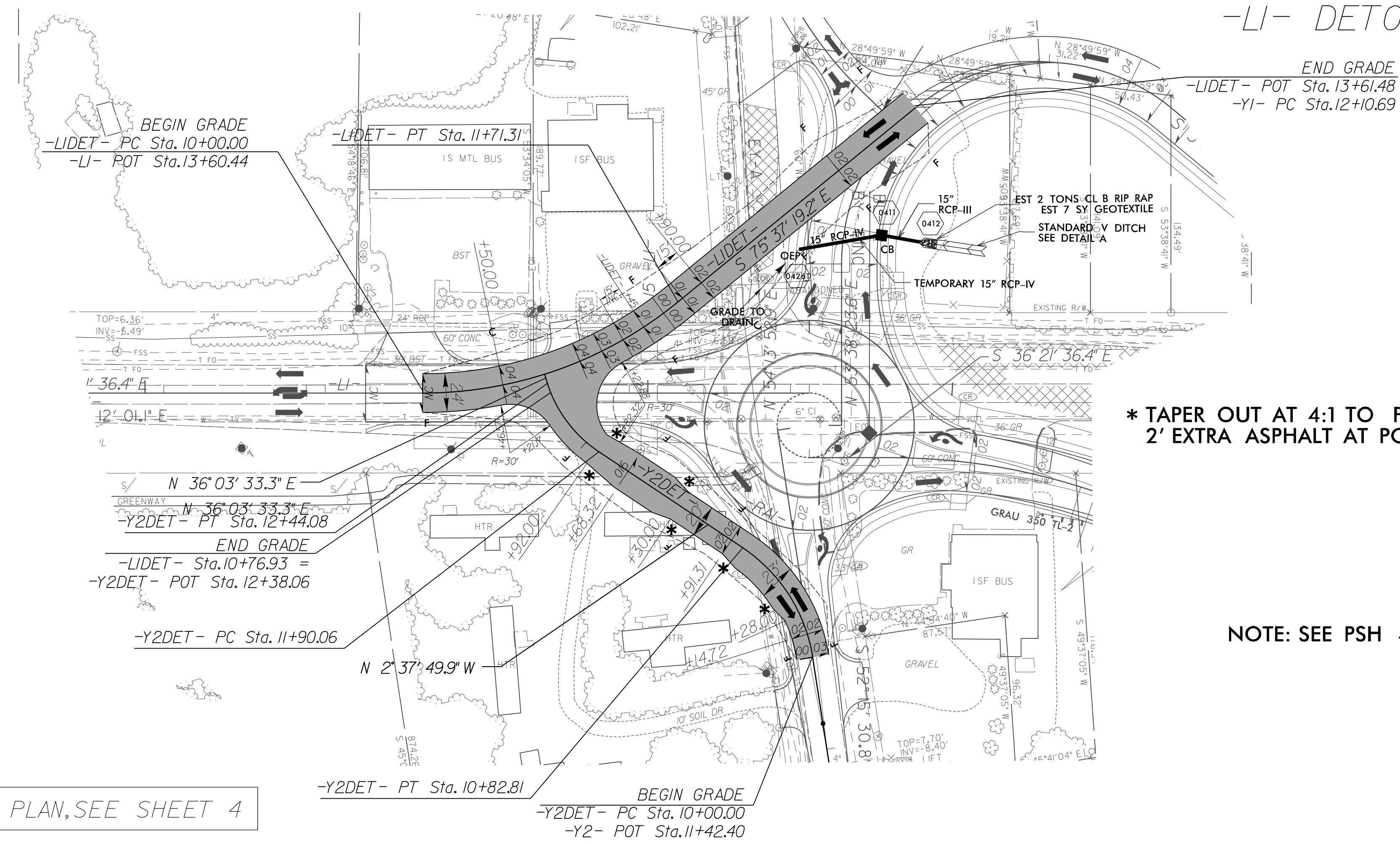

* TAPER OUT AT 4:1 TO PROVIDE 11' LANES AND 2' EXTRA ASPHALT AT POLE LOCATIONS.

-LI- DETOUR - CURVE DATA
 PI Sta 10+75.00
 $\Delta = 39' 15" 42.7" (LT)$
 $D = 22' 55" 05.9"$
 $L = 171.3'$
 $T = 89.17'$
 $R = 250.00'$

-Y2- DETOUR - CURVE DATA
 PI Sta 10+43.95 PI Sta 12+18.14
 $\Delta = 47' 26" 54.82" (LT)$ $\Delta = 38' 41" 23.25" (LT)$
 $D = 57' 17" 44.81"$ $D = 71' 37" 11.01"$
 $L = 82.81'$ $L = 54.02'$
 $T = 43.95'$ $T = 28.09'$
 $R = 100.00'$ $R = 80.00'$

NOTE: SEE PSH 4 FOR RIGHT OF WAY INFORMATION

SEE SHEET 10 FOR -LI- PROFILE
 SEE SHEET 12 FOR -Y1- PROFILE
 SEE SHEET 14 FOR -Y2- PROFILE

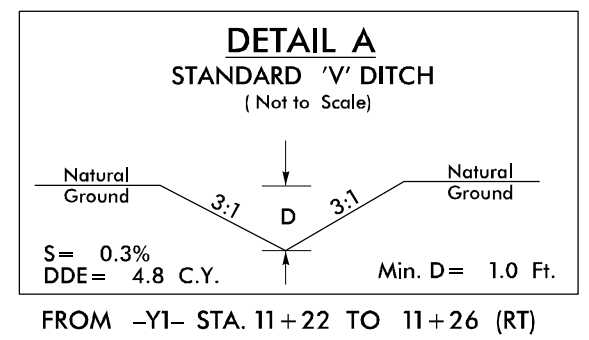

FOR ROADWAY PLAN, SEE SHEET 4

REVISIONS

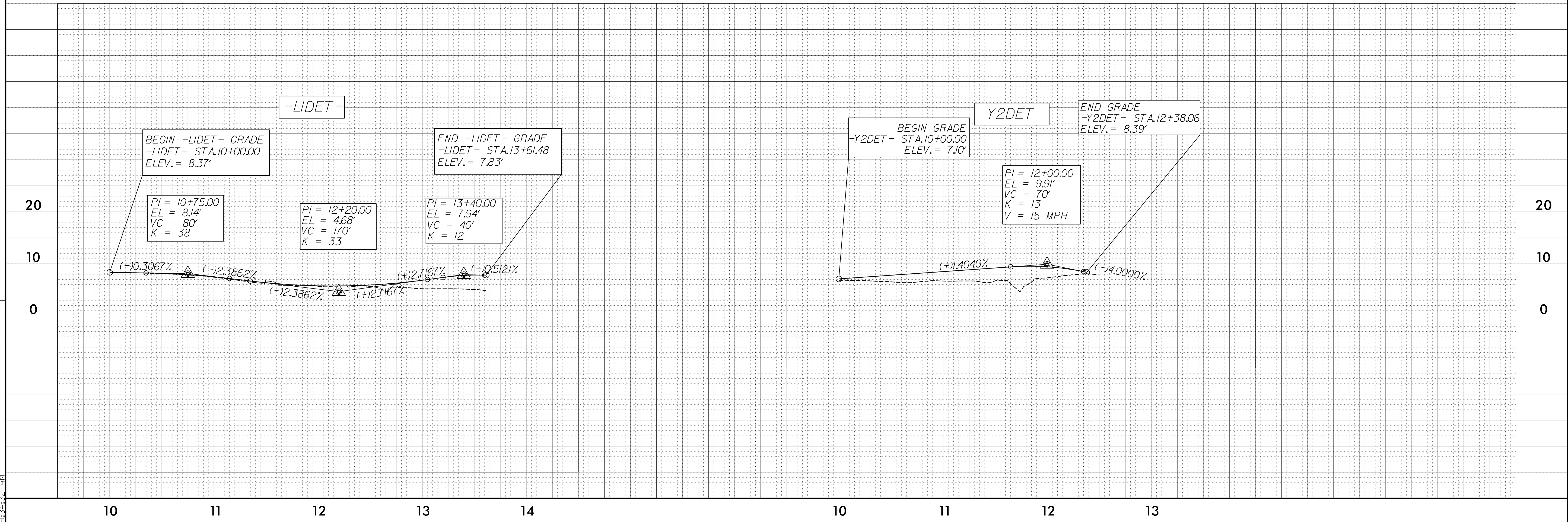

8/27/2016
 R:\Projects\B4929\Proj\B4929_Rdy_dtl_detour.dgn
 9:41:32 AM