

**This electronic collection of documents is provided  
for the convenience of the user  
and is Not a Certified Document –**

**The documents contained herein were originally issued  
and sealed by the individuals whose names and license  
numbers appear on each page, on the dates appearing  
with their signature on that page.**

**This file or an individual page  
shall not be considered a certified document.**

**CONTRACT: C203888 TIP PROJECT: W-5203AA**

STATE OF NORTH CAROLINA  
DIVISION OF HIGHWAYS

**CROSS - SECTIONS**

**SECTIONS**

**CROSS-SECTION TITLE SHEET**

**CROSS-SECTION SUMMARY**

**STA. 416+00.00 -L- TO STA. 437+10.00 -L- (5 SCALE)**

**STA. 425+00.00 -L- TO STA. 427+50.00 -L- (10 SCALE)**

**SHEET NO's.**

**X-1A**

**X-1B**

**X-1 THRU X-10**

**X-11**

STATE	STATE PROJECT REFERENCE NO.	SHEET NO.	TOTAL SHEETS
N.C.	W-5203AA	X-1A	13
STATE PROJ. NO.	F. A. PROJ. NO.	DESCRIPTION	
45333.1.FS27	HSIP-0117(029)	PE	
45333.3.27	HSIP-0117(029)	CONST	

STATE OF NORTH CAROLINA  
DIVISION OF HIGHWAYS

Approximate quantities only. Unclassified Excavation,  
Borrow Excavation, Fine Grading, and Clearing & Grubbing will  
be paid for at the contract lump sum price for "Grading."

NOTE: EMBANKMENT DOES NOT INCLUDE BACKFILL FOR UNDERCUT

## CROSS-SECTION SUMMARY

Station	Uncl. Exc.	Embt	Station	Uncl. Exc.	Embt	Station	Uncl. Exc.	Embt	Station	Uncl. Exc.	Embt	Station	Uncl. Exc.	Embt	Station	Uncl. Exc.	Embt
L	(cu. yd.)	(cu. yd.)		(cu. yd.)	(cu. yd.)		(cu. yd.)	(cu. yd.)		(cu. yd.)	(cu. yd.)		(cu. yd.)	(cu. yd.)		(cu. yd.)	(cu. yd.)
416+00.00	0	0															
416+50.00	0	0															
417+00.00	0	0															
417+10.00	0	0															
417+25.00	0	0															
417+50.00	0	0															
418+00.00	13	11															
418+50.00	12	14															
419+00.00	10	16															
419+50.00	9	19															
420+00.00	9	20															
420+50.00	8	26															
421+00.00	7	36															
421+50.00	7	45															
422+00.00	8	47															
422+50.00	10	42															
423+00.00	13	32															
423+50.00	13	21															
424+00.00	16	12															
424+50.00	24	3															
425+00.00	31	0															
425+50.00	33	0															
426+00.00	31	0															
426+45.00	21	0															
426+50.00	2	0															
427+00.00	0	0															
427+38.00	57	2															
427+50.00	10	0															
428+00.00	29	0															
428+50.00	23	0															
429+00.00	22	0															
429+50.00	23	0															
430+00.00	26	0															
430+50.00	22	4															
431+00.00	17	13															
431+50.00	16	19															
432+00.00	16	23															
432+50.00	12	27															
433+00.00	10	28															
433+50.00	10	23															
434+00.00	9	19															
434+50.00	9	18															
435+00.00	10	17															
435+50.00	12	13															
435+70.00	0	0															
435+85.00	0	0															
436+00.00	0	0															
436+50.00	0	0															
437+00.00	0	0															
437+10.00	0	0															

25-MAY-2016 15:28  
 J:\W\5203AA\Roadway\XSC\W-5203AA\_RDY\_XPL\_1B.dgn  
 8/17/99

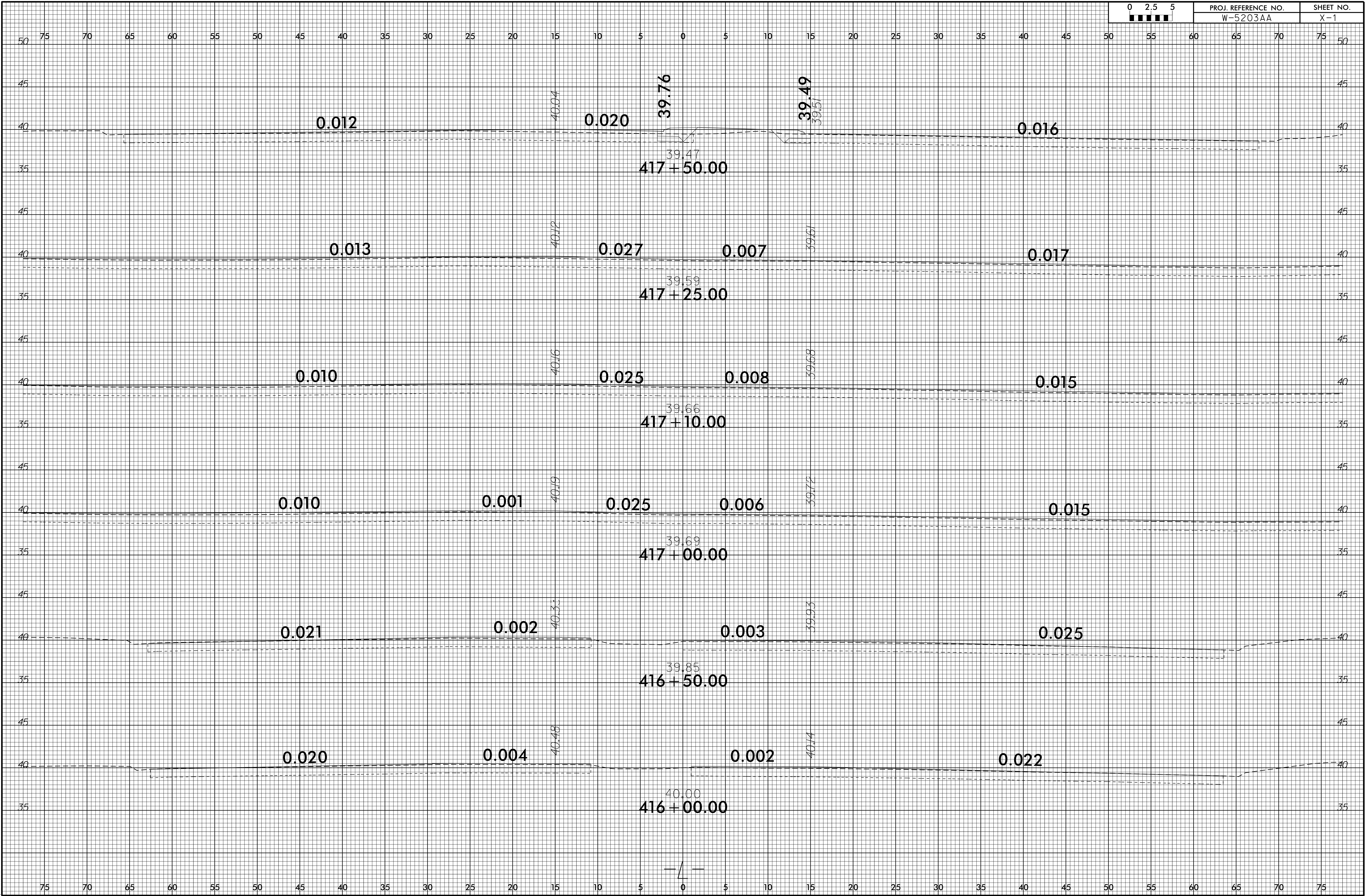

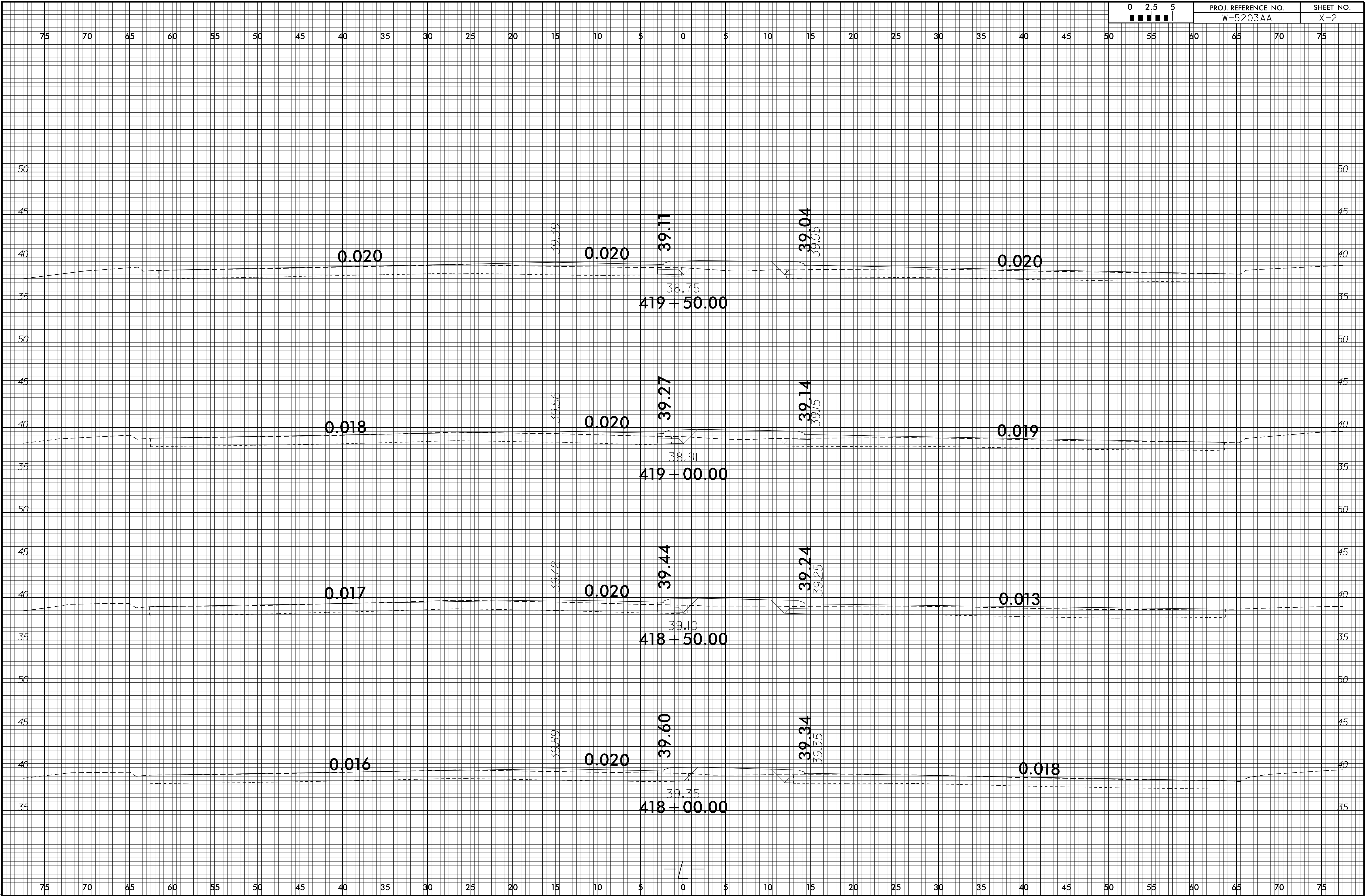

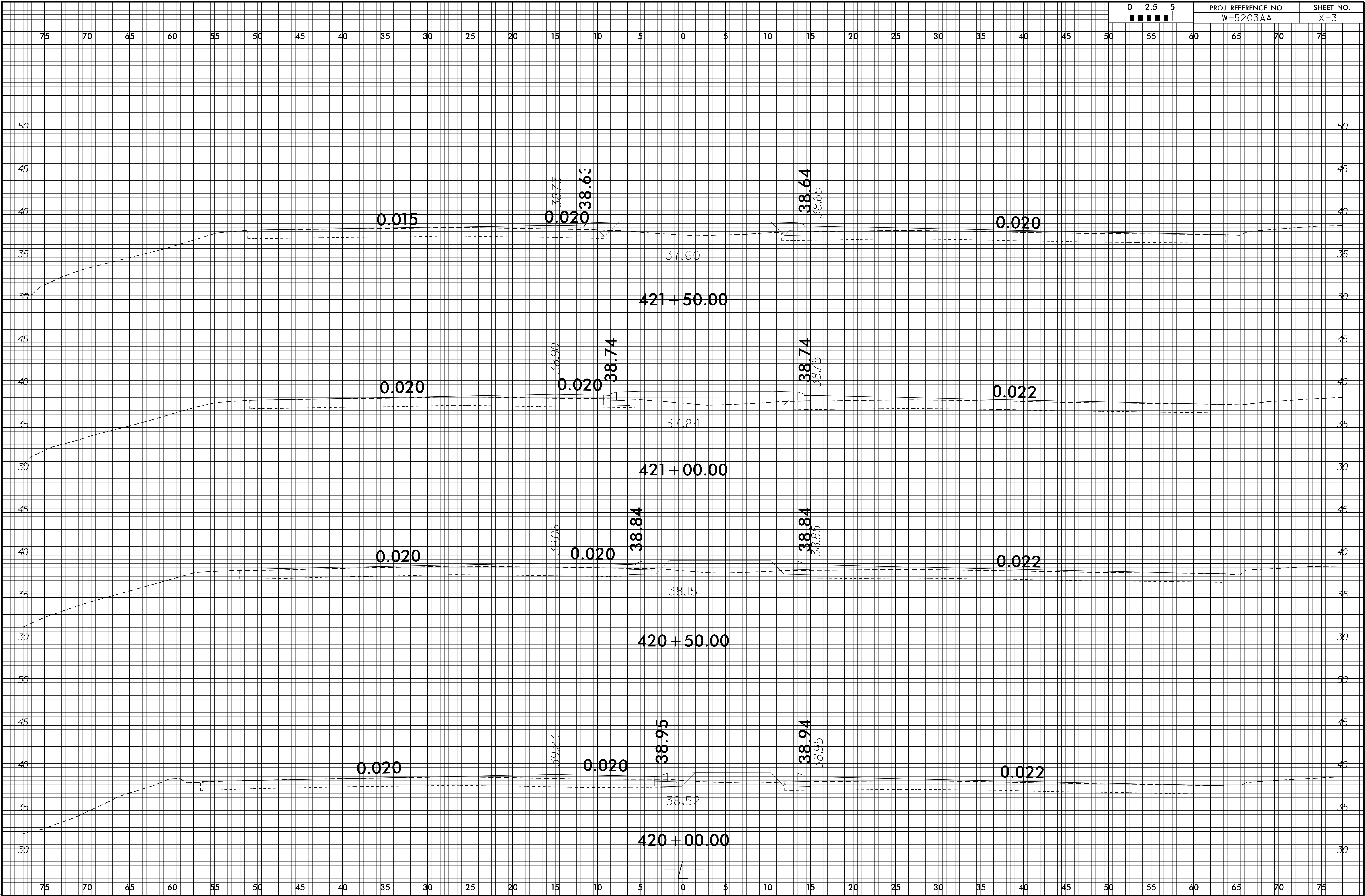

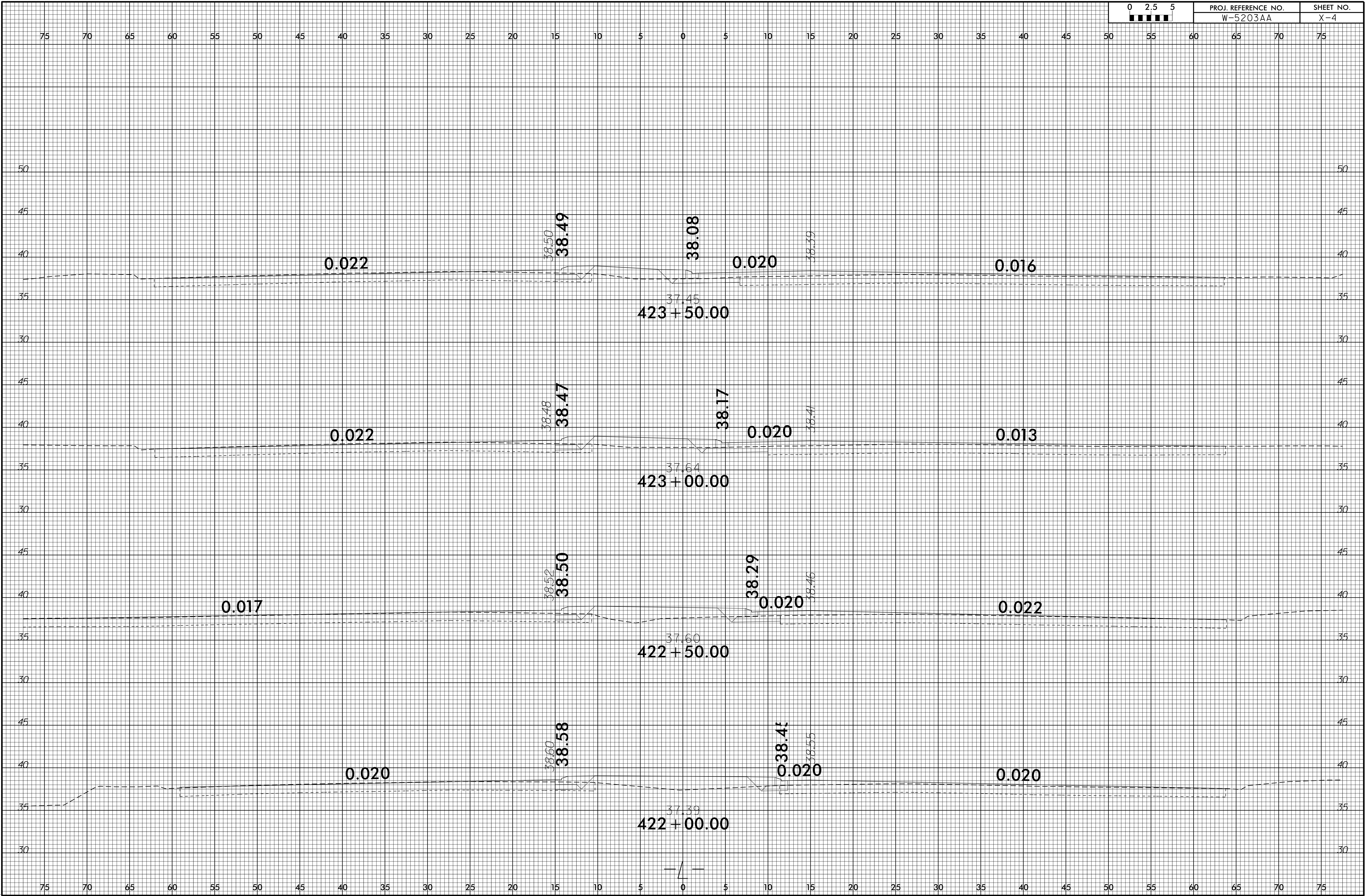

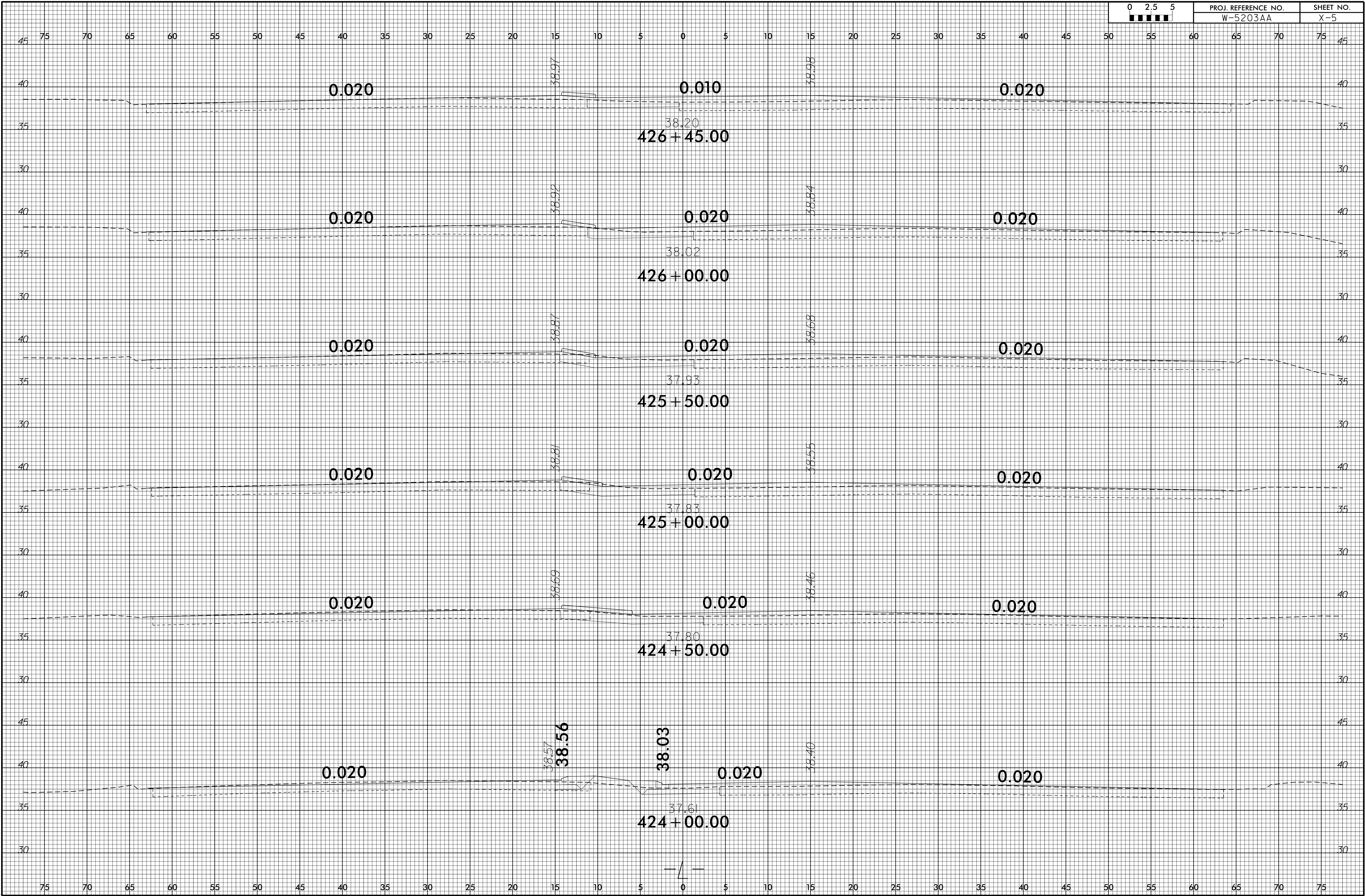
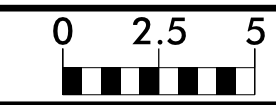



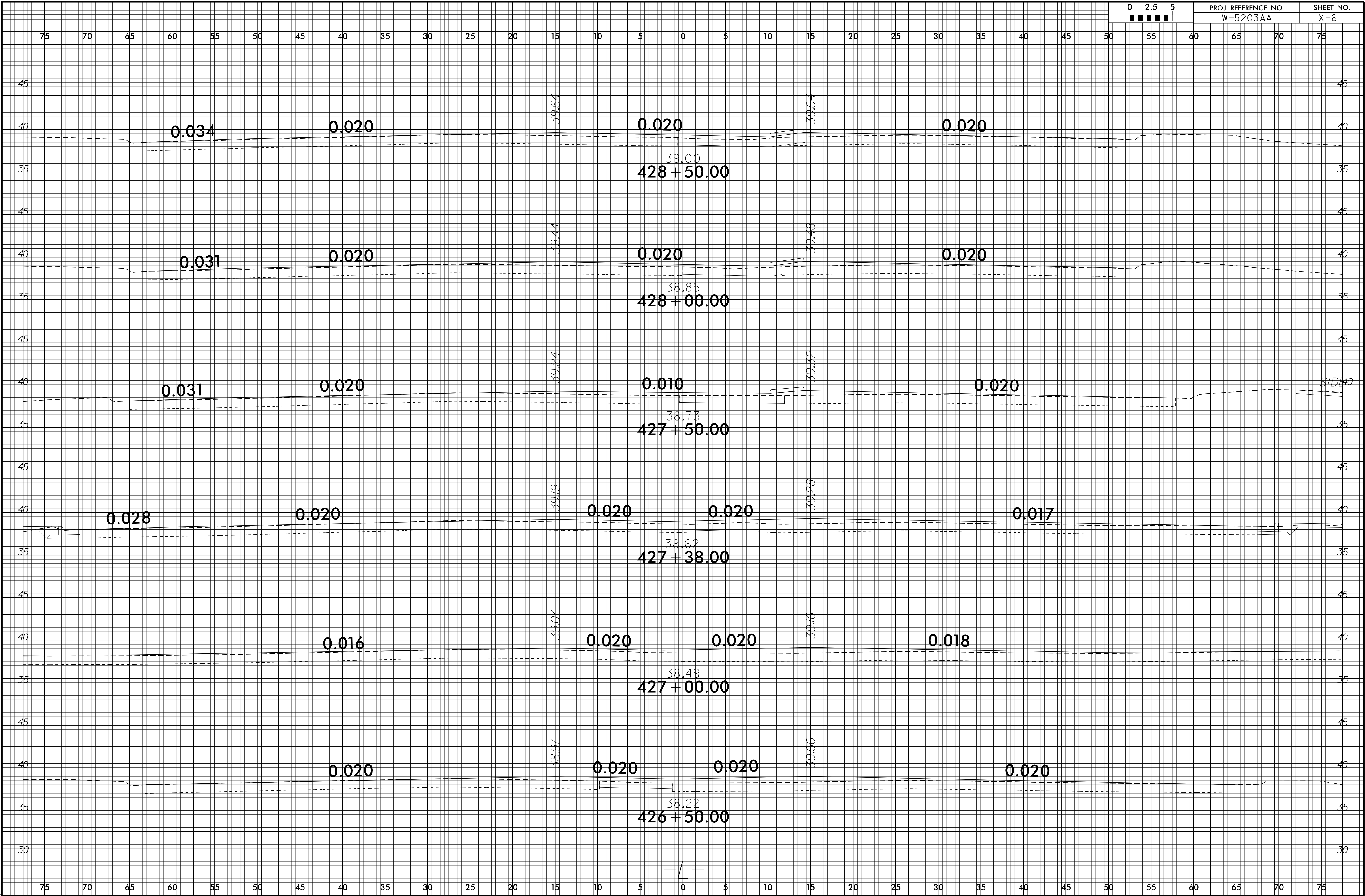

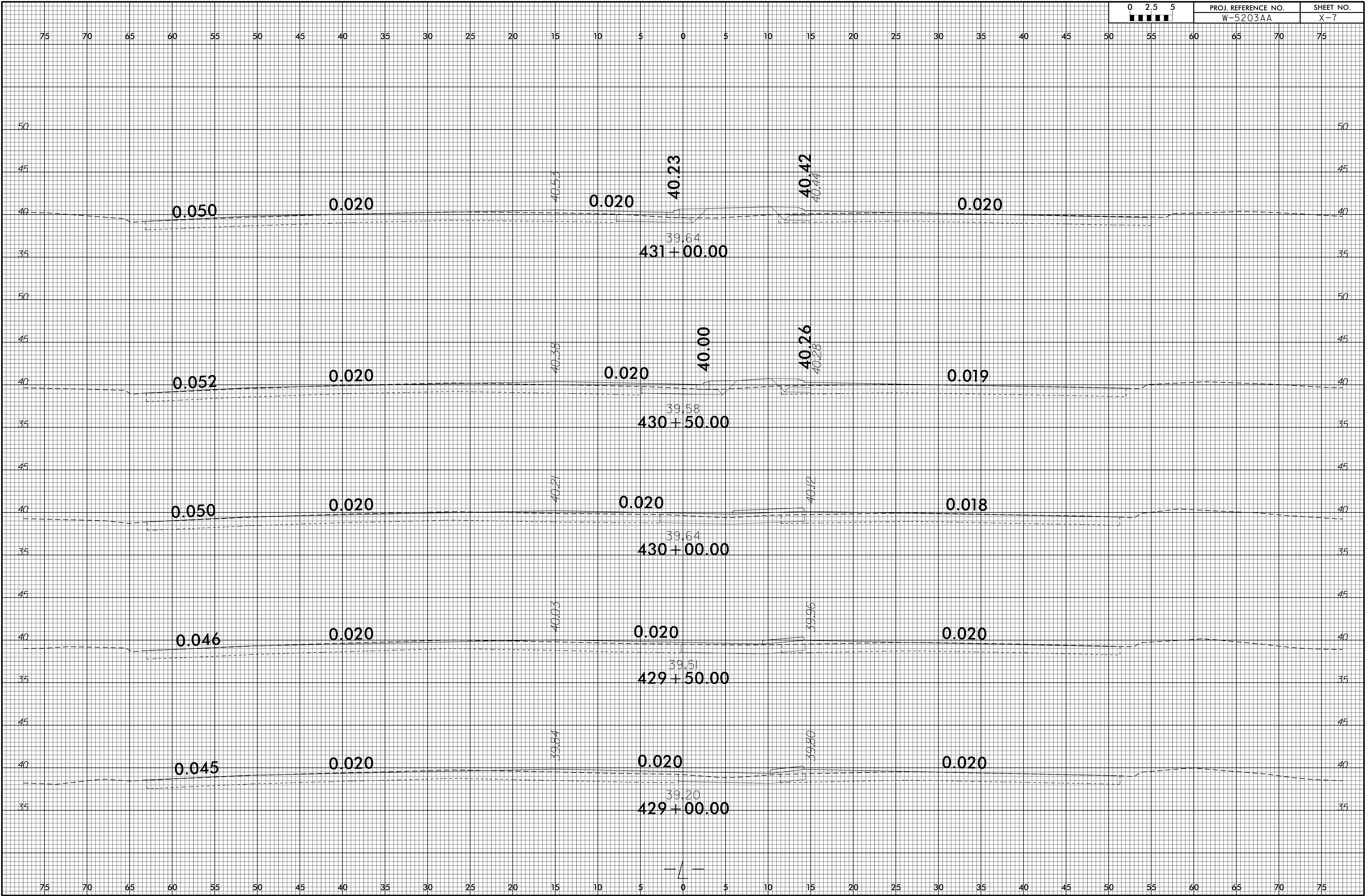



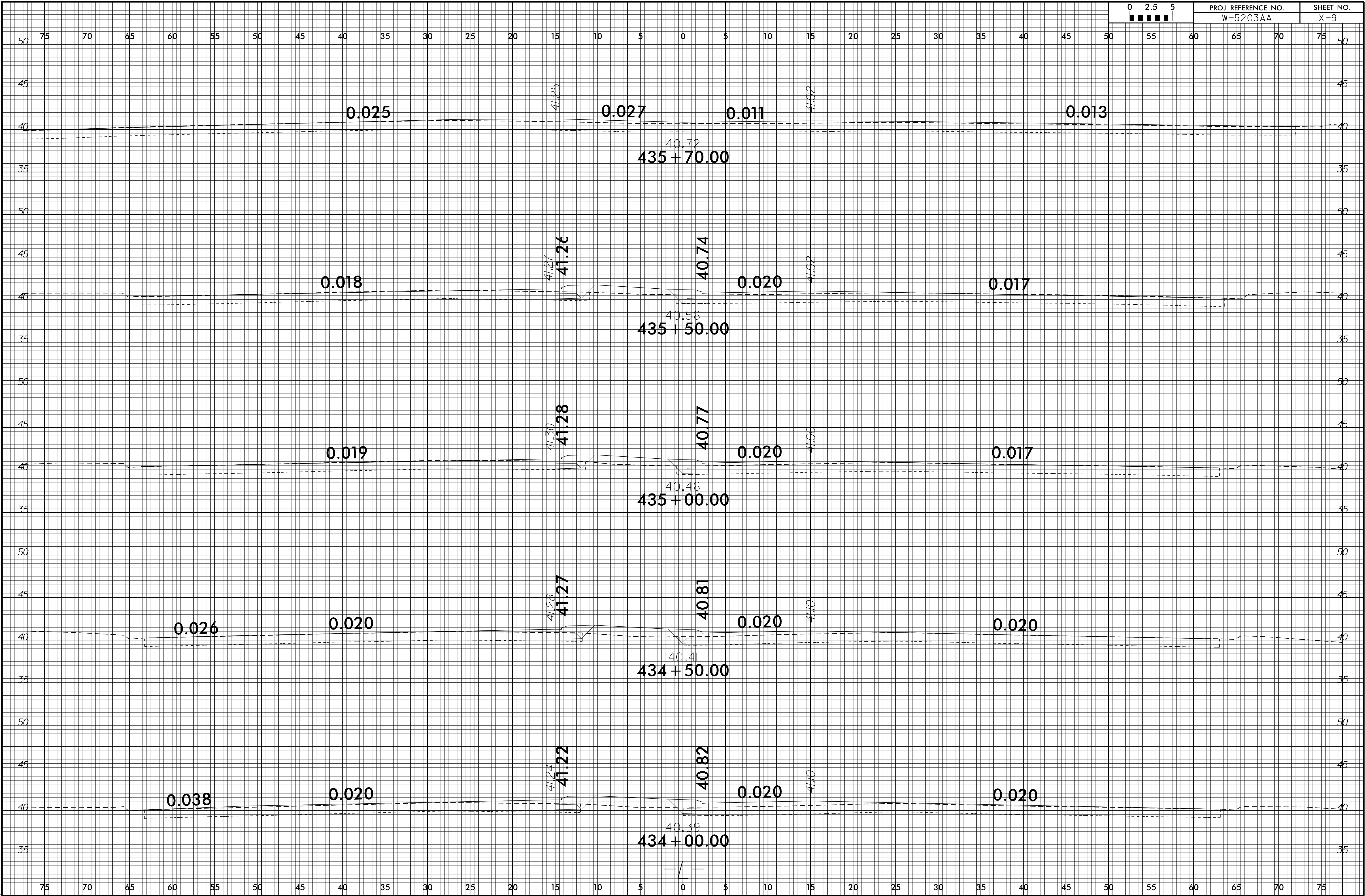

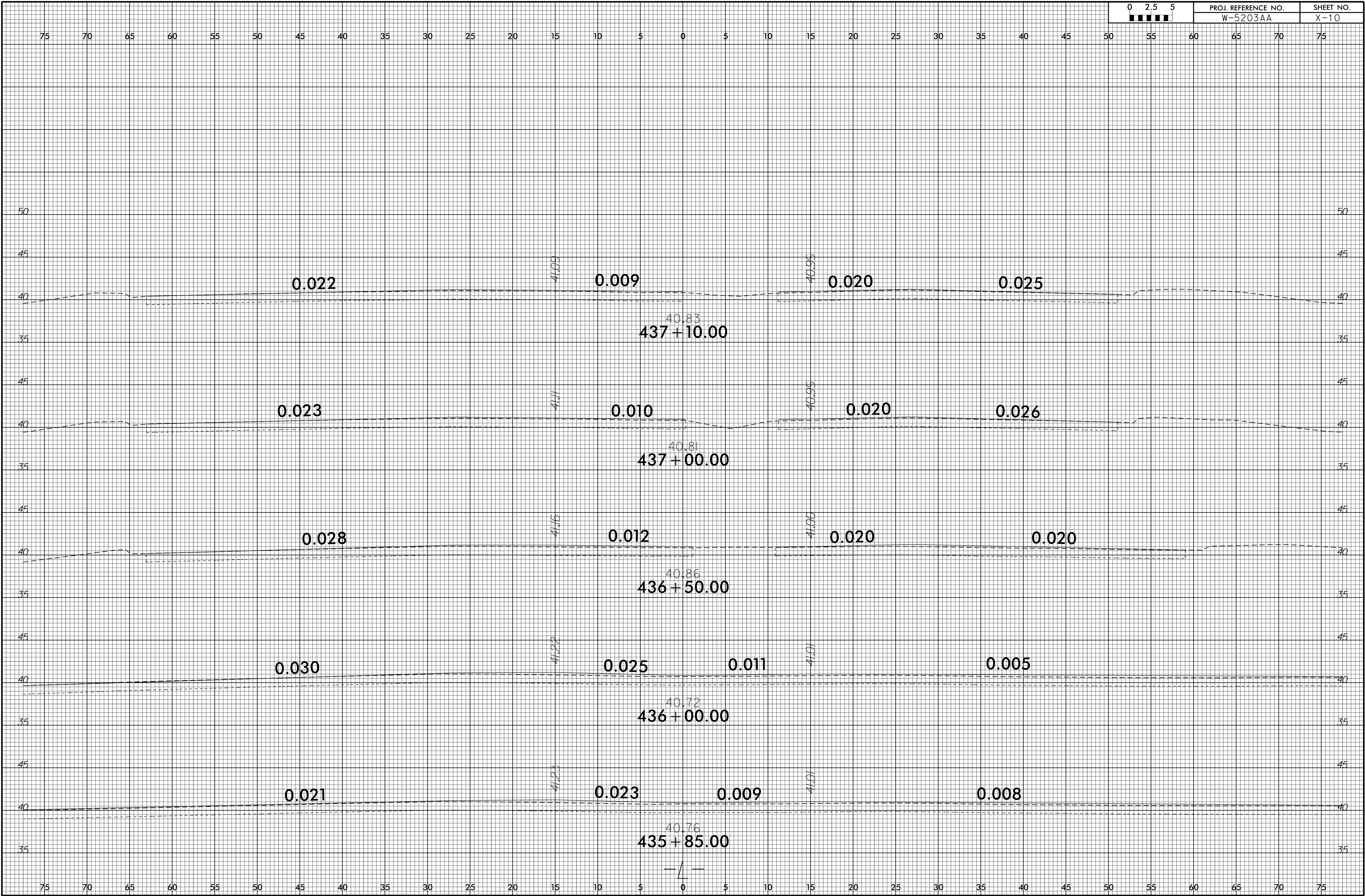

150 140 130 120 110 100 90 80 70 60 50 40 30 20 10 0 10 20 30 40 50 60 70 80 90 100 110 120 130 140 150

50

50

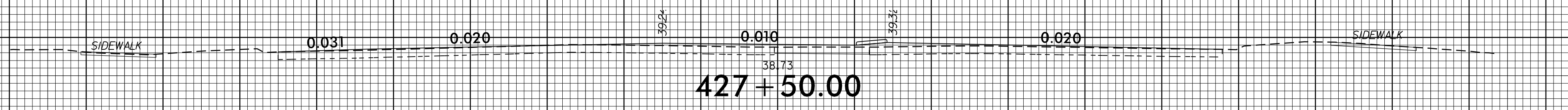

427 + 50.00

40

40

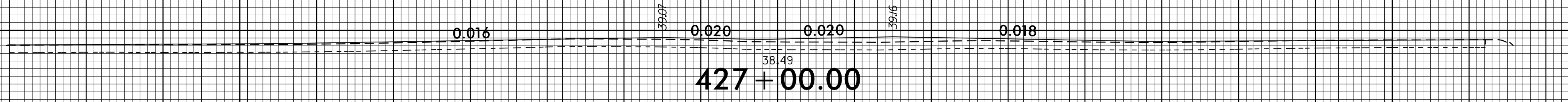

427 + 00.00

40

40

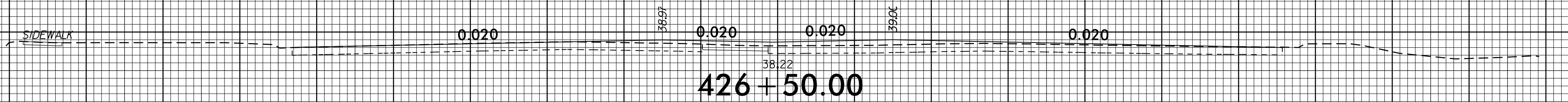

426 + 50.00

30

30

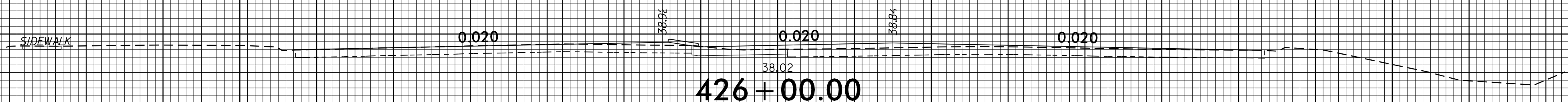

426 + 00.00

40

40

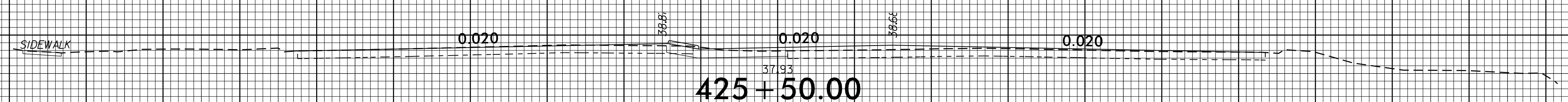

425 + 50.00

40

40

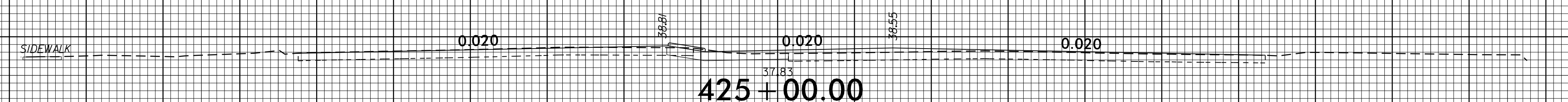

425 + 00.00

150 140 130 120 110 100 90 80 70 60 50 40 30 20 10 0 10 20 30 40 50 60 70 80 90 100 110 120 130 140 150