

5/14/1999

-L-
 PI Sta 412+73.27
 $\Delta = 10^\circ 14' 38.6" (RT)$
 $D = 1^\circ 00' 00.0"$
 $L = 1,024.41'$
 $T = 513.57'$
 $R = 5,729.58'$

-Y1-
 PI Sta 11+87.31
 $\Delta = 19^\circ 27' 52.3" (LT)$
 $D = 1^\circ 27' 33.0"$
 $L = 169.86'$
 $T = 85.76'$
 $R = 500.00'$

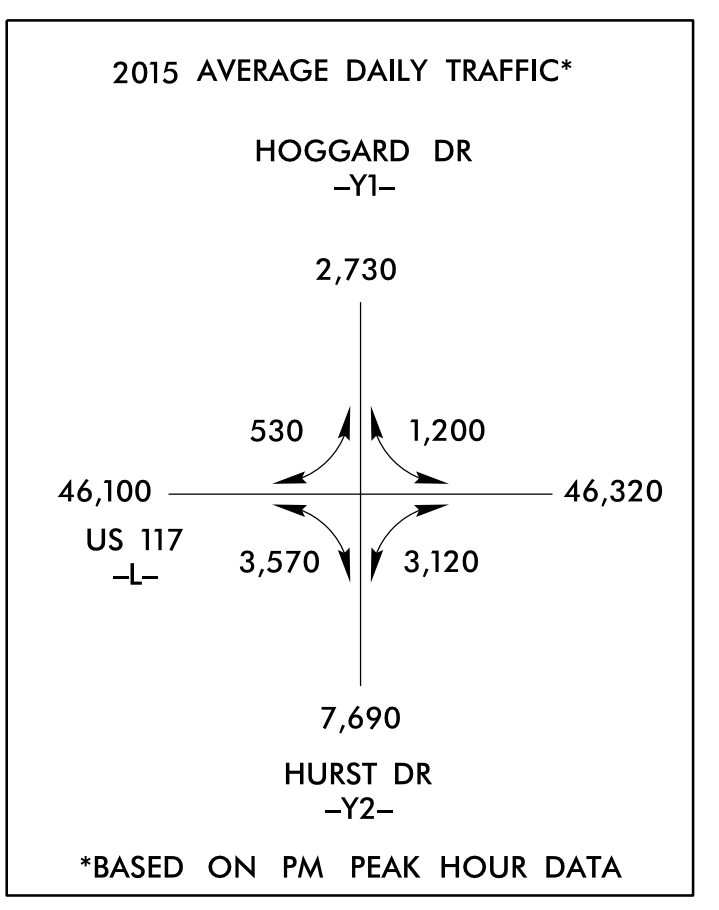

PLANS PREPARED BY:
PARSONS
 RALEIGH, NORTH CAROLINA, (919) 854-1345
 NC LICENSE NO. F-0246
 FOR NORTH CAROLINA DEPT. OF TRANSPORTATION
SUNGATE DESIGN GROUP, P.A.
 915 JONES FRANKLIN ROAD
 RALEIGH, NORTH CAROLINA 27606
 TEL (919) 859-2243 FAX (919) 859-4258
 ENG FIRM LICENSE NO. C480

PROJECT REFERENCE NO. W-5203AA	SHEET NO. 4
ROADWAY DESIGN ENGINEER SEAL 37950 JASON M. PERRY 6/9/2016	HYDRAULICS ENGINEER SEAL 026971 JAMES W. CROFTON 6/9/2016
DOCUMENT NOT CONSIDERED FINAL UNLESS ALL SIGNATURES COMPLETED	

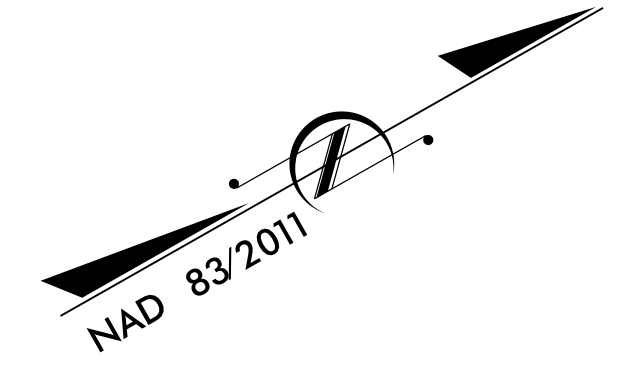

BEGIN TIP PROJECT W-5203AA
 BEGIN CONSTRUCTION
 -L- POC Sta. 416+00.00
 US 117 NB - MP 4.959
 US 117 SB - MP 10.598

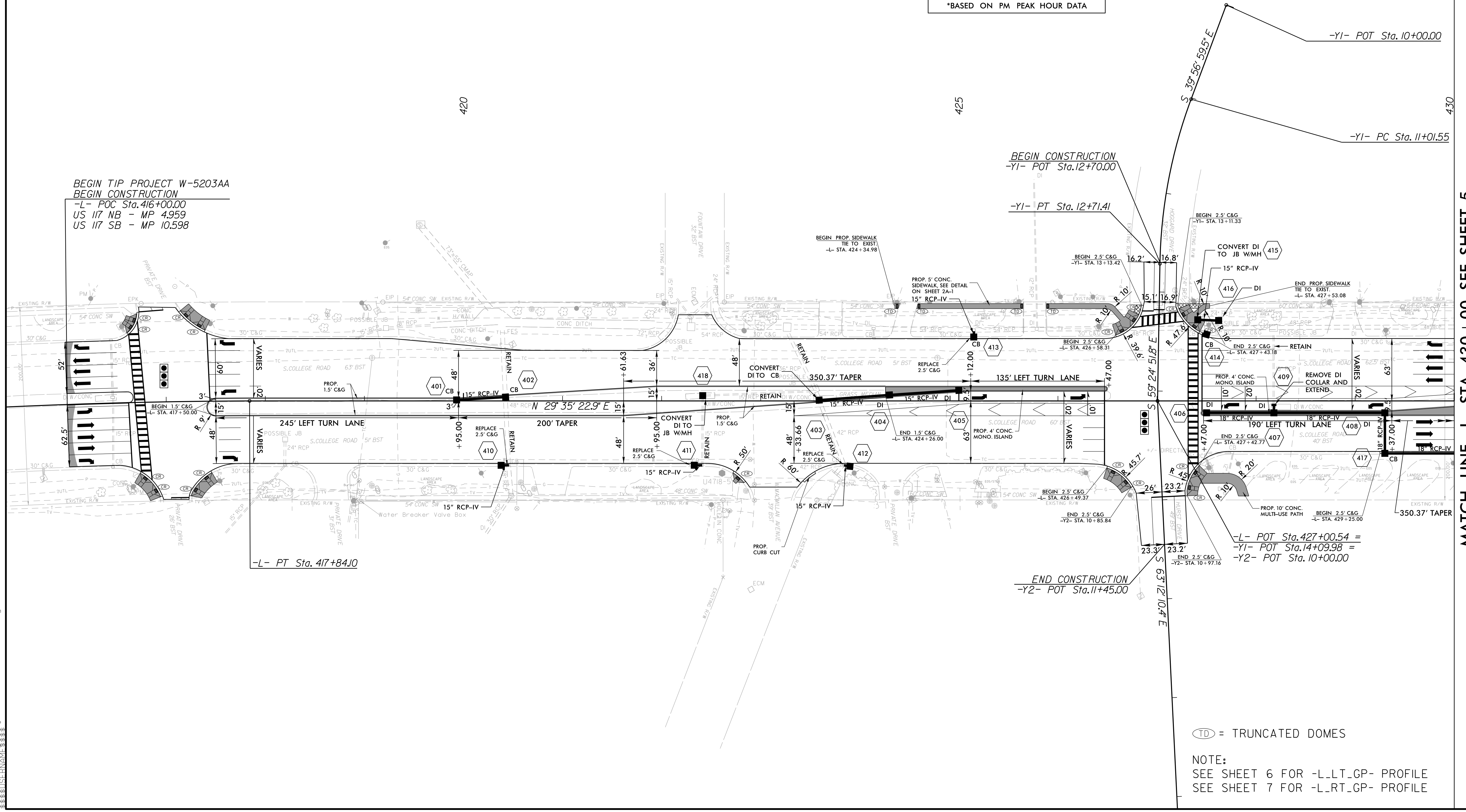

MATCH LINE -L- STA 430+00 SEE SHEET 5

(TD) = TRUNCATED DOMES

NOTE:
 SEE SHEET 6 FOR -L.LT.GP- PROFILE
 SEE SHEET 7 FOR -L.RT.GP- PROFILE

I:\W-5203AA\2016\5203AA_PSH_04.dgn