

SURVEY CONTROL W5203-AA

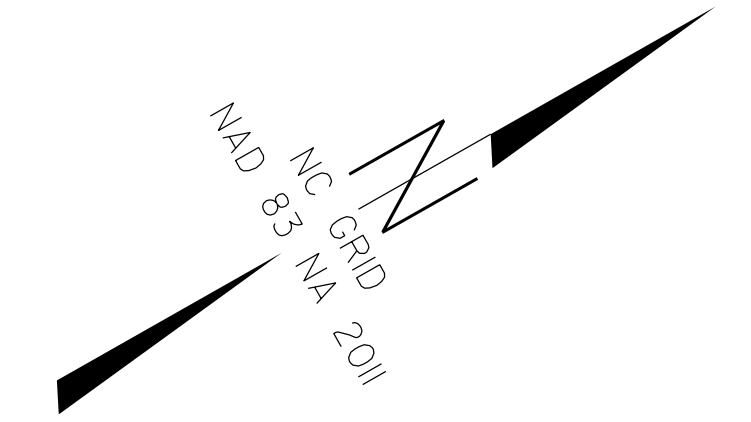

BL1	POINT	DESC.	NORTH	EAST	ELEVATION	L STATION	OFFSET
	U47184	GPS CAP & REBAR	172847.2240	2337348.2870	39.53	412+64.47	93.77 RT
	U47185	GPS CAP & REBAR	173728.0040	2337795.8400	37.66	422+61.00	72.99 RT
	BL1	TRV CAP & REBAR	174426.3300	2338111.0210	39.11	430+23.88	2.25 RT
	BL2	TRV CAP & REBAR	175027.8370	2338452.7890	40.23	437+15.70	2.43 RT
	BL3	TRV CAP & REBAR	175654.7280	2338809.5430	41.34	444+37.00	3.10 RT
	BL4	TRV CAP & REBAR	176155.7930	2339084.5060	41.46	450+08.49	5.21 LT
	BL5	TRV CAP & REBAR	176824.4750	2339463.0440	42.06	457+76.88	6.23 LT
	BL6	TRV CAP & REBAR	177432.9570	2339895.7400	40.89	465+19.67	69.58 RT
	BL7	TRV CAP & REBAR	177915.9160	2340166.5630	39.69	470+73.37	66.60 RT
	BL8	TRV CAP & REBAR	178558.6930	2340532.1470	39.55	478+12.84	67.12 RT
	BL9	TRV CAP & REBAR	179057.8590	2340815.3870	40.74	483+86.76	66.94 RT
	W52031	GPS CAP & REBAR	179750.5280	2341086.9310	42.73	OUTSIDE PROJECT LIMITS	
	W52032	GPS CAP & REBAR	180673.1550	2341308.5100	42.21	OUTSIDE PROJECT LIMITS	

 BM8 ELEVATION = 42.85
 N 172728 E 2337276
 L STATION 411+25.00 75 RIGHT
 RR SPIKE

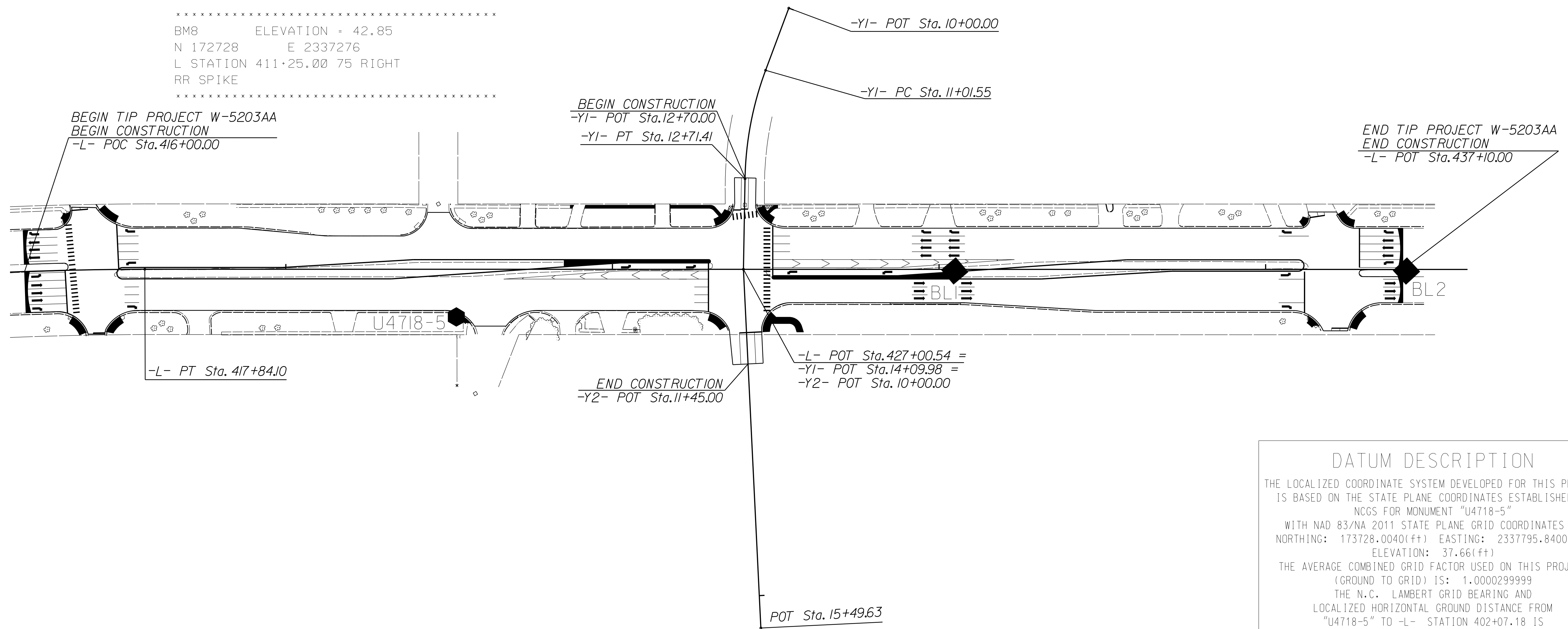

DATUM DESCRIPTION

THE LOCALIZED COORDINATE SYSTEM DEVELOPED FOR THIS PROJECT IS BASED ON THE STATE PLANE COORDINATES ESTABLISHED BY NCGS FOR MONUMENT "U4718-5" WITH NAD 83/NA 2011 STATE PLANE GRID COORDINATES OF NORTHING: 173728.0040(±) EASTING: 2337795.8400(±) ELEVATION: 37.66(±)

THE AVERAGE COMBINED GRID FACTOR USED ON THIS PROJECT (GROUND TO GRID) IS: 1.0000299999

THE N.C. LAMBERT GRID BEARING AND LOCALIZED HORIZONTAL GROUND DISTANCE FROM "U4718-5" TO -L- STATION 402+07.18 IS S 37°03'38" W 555.71'

ALL LINEAR DIMENSIONS ARE LOCALIZED HORIZONTAL DISTANCES
 VERTICAL DATUM USED IS NAVD 88

NOTE: DRAWING NOT TO SCALE

7622999
 25 MAY 2016 15:30 \\proj\W5203AA_LS_1C-1-160308.dgn