

**This electronic collection of documents is provided  
for the convenience of the user  
and is Not a Certified Document –**

**The documents contained herein were originally issued  
and sealed by the individuals whose names and license  
numbers appear on each page, on the dates appearing  
with their signature on that page.**

**This file or an individual page  
shall not be considered a certified document.**

CONTRACT: **W-5510**

TIP PROJECT:

CONTRACT:

STATE OF NORTH CAROLINA  
DIVISION OF HIGHWAYS

**FORSYTH COUNTY**

LOCATION: SR 4315 (S MAIN STREET) FROM I-BUS-40 RAMP TO SR 4278 (S CHERRY STREET), AND SR 2648 (OLD WINSTON ROAD)

TYPE OF WORK: GRADING, DRAINAGE, PAVING, SIGNALS, SIGNING AND PAVEMENT MARKINGS

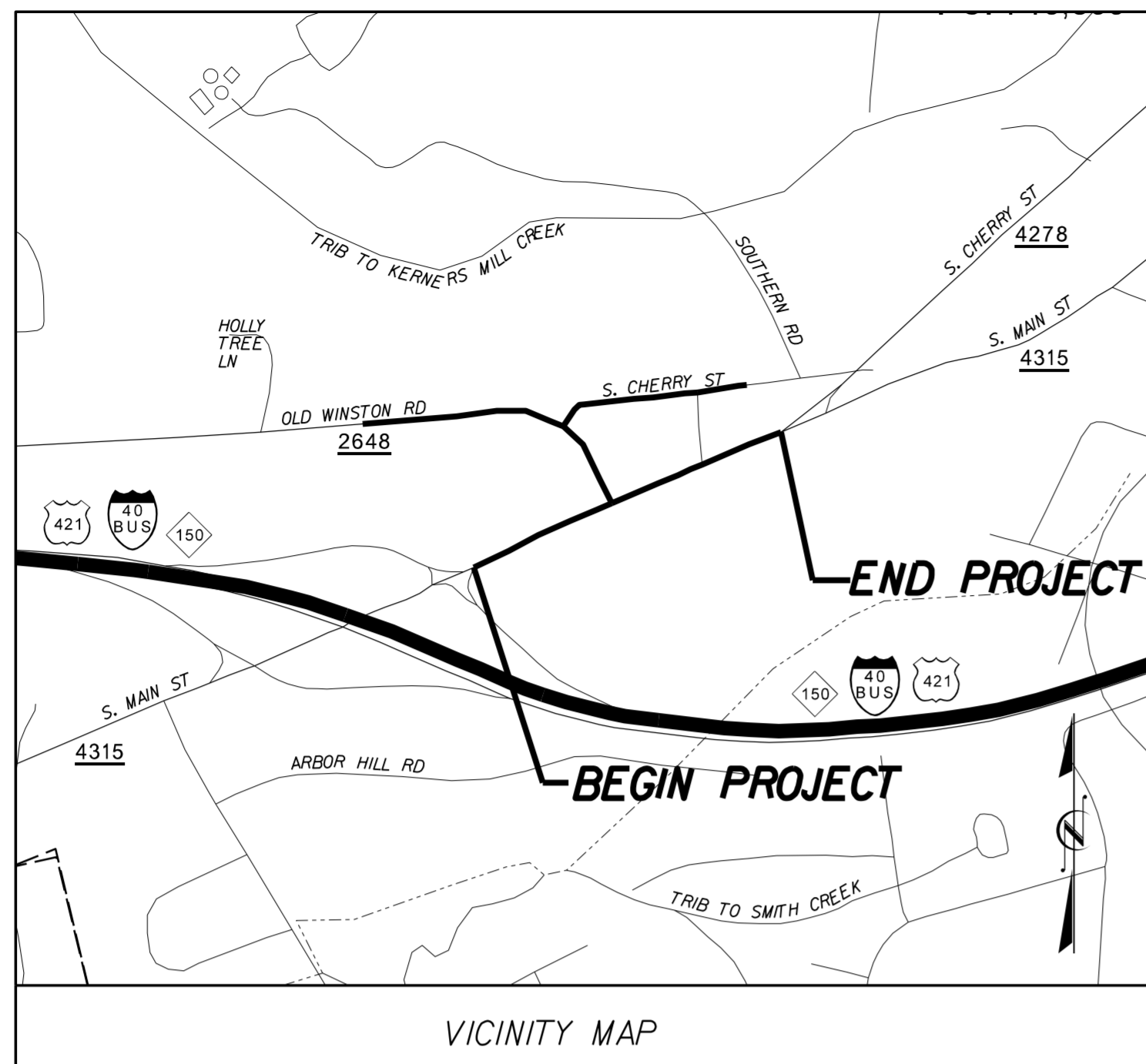

TOWN OF KERNERSVILLE

100% PLANS

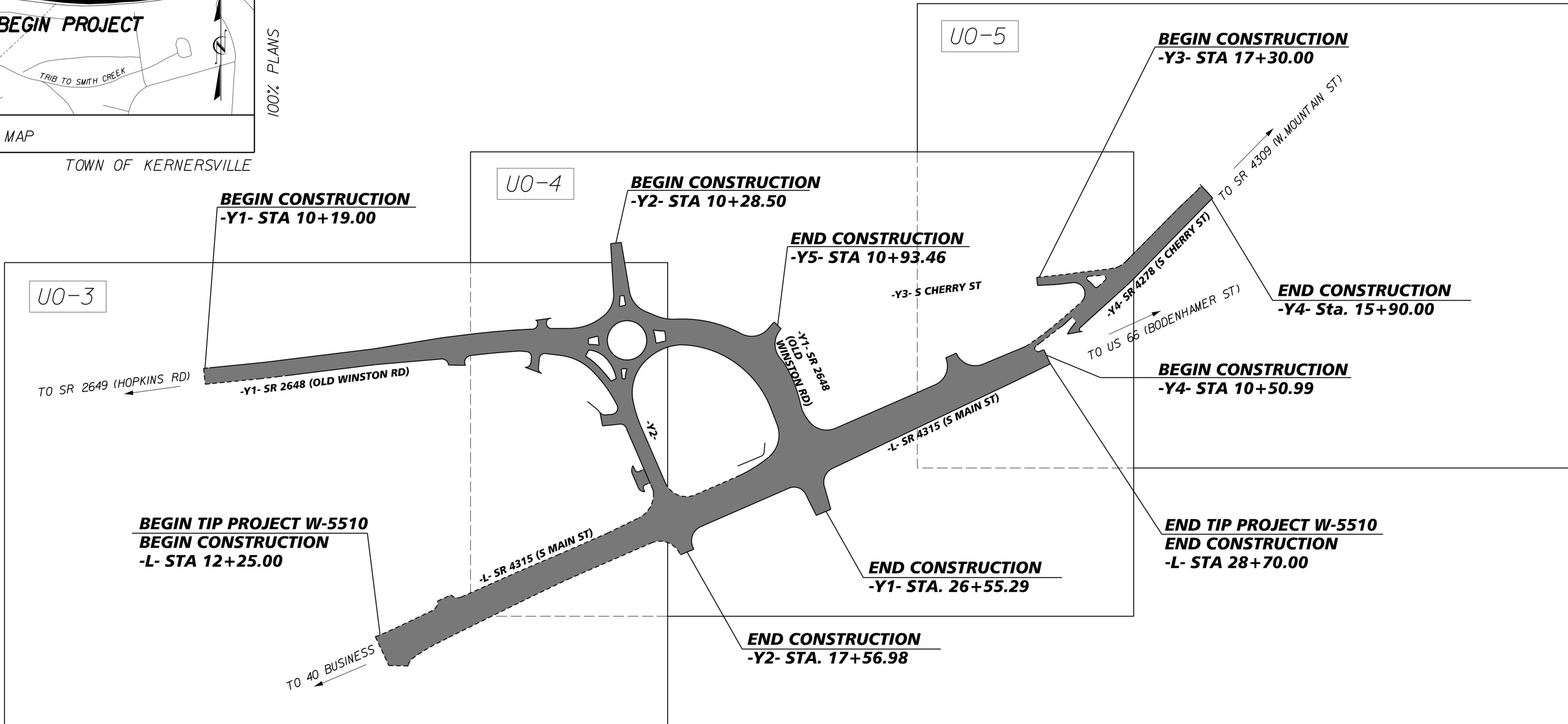

NC DOT CONTACT: BRETT ABERNATHY  
DIVISION 9, PROJECT MANAGER  
(336) 747-7800

STATE	STATE PROJECT REFERENCE NO.	SHEET NO.	TOTAL SHEETS
N.C.	W-5510	UO-1	
STATE PROJ. NO.	F.A. PROJ. NO.	DESCRIPTION	
50080.1.1	HSIP-4315(2)	PE	
50080.2.1	HSIP-4315(2)	RW / UTILITIES	
50080.3.1	HSIP-4315(2)	CONST	

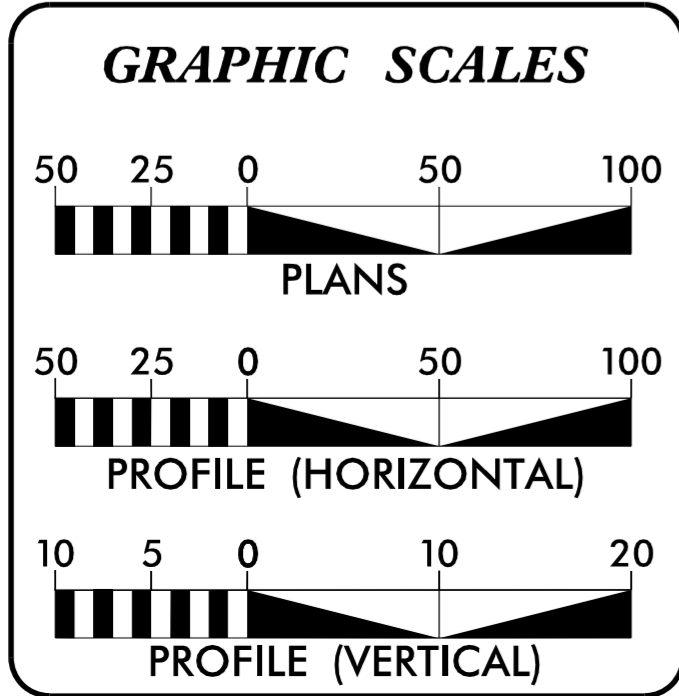

**INDEX OF SHEETS**

SHEET NO.	DESCRIPTION
UO-1	TITLE SHEET
UO-2	LEGEND
UO-3 THRU UO-5	UTILITY BY OTHERS PLAN SHEETS

**UTILITY OWNERS ON PROJECT**

(A) POWER: DUKE ENERGY: LARRY ROBINSON 336-209-6631  
 (B) TELEPHONE: AT&T: JIM BROOKS 336-788-0150  
 (C) TELEPHONE: CENTURY LINK: BRIAN MCNIFF 336-996-5999  
 (D) FIBERTECH: JOHN SMITH 585-743-1796  
 (E) CABLE: TWC: ERIC VIVOD 336-231-6109  
 (F) GAS: PIEDMONT: ANDY RUMLEY 336-222-7108

PLANS PREPARED FOR THE NCDOT BY: Kimley-Horn and Associates, Inc.  
 2012 STANDARD SPECIFICATIONS

RIGHT OF WAY DATE: JULY 22, 2015

LETTING DATE: FEBRUARY 16, 2016

CH ENGINEERING  
 3220 GLEN ROYAL RD. RALEIGH, NC 27617  
 TELE 919.788.0224 FAX 919.788.0232  
 NC LICENSE #P-0189

ERIC M. TWEED, PE  
 UTILITY ENGINEER

DIVISION OF HIGHWAYS  
STATE OF NORTH CAROLINA

STATE HIGHWAY DESIGN ENGINEER

1/5/2016 \$FILEL\$

5/14/99

# STATE OF NORTH CAROLINA DIVISION OF HIGHWAYS

**CH ENGINEERING**  
 3220 GLEN ROYAL RD. RALEIGH, NC 27617  
 TELE 919.788.0224 FAX 919.788.0232  
 NC LICENSE #P-0189

PROJECT REFERENCE NO.	SHEET NO.
W-5510	U0-2

## UTILITIES PLAN SHEET SYMBOLS

### PROPOSED WATER SYMBOLS

Water Line (Sized as Shown)	
11¼ Degree Bend	
22½ Degree Bend	
45 Degree Bend	
90 Degree Bend	
Plug	
Tee	
Cross	
Reducer	
Gate Valve	
Butterfly Valve	
Tapping Valve	
Line Stop	
Line Stop with Bypass	
Blow Off	
Fire Hydrant	
Relocate Fire Hydrant	
Remove Fire Hydrant	
Water Meter	
Relocate Water Meter	
Remove Water Meter	
Water Pump Station	
RPZ Backflow Preventer	
DCV Backflow Preventer	
Relocate RPZ Backflow Preventer	
Relocate DCV Backflow Preventer	

### PROPOSED SEWER SYMBOLS

Gravity Sewer Line (Sized as Shown)	
Force Main Sewer Line (Sized as Shown)	
Manhole (Sized per Note)	
Sewer Pump Station	

### PROPOSED MISCELLANEOUS UTILITIES SYMBOLS

Power Pole	
Telephone Pole	
Joint Use Pole	
Telephone Pedestal	
Utility Line by Others (Type as Shown)	
Trenchless Installation	
Encasement by Open Cut	
Encasement	

Thrust Block	
Air Release Valve	
Utility Vault	
Concrete Pier	
Steel Pier	
Plan Note	
Pay Item Note	

### EXISTING UTILITIES SYMBOLS

Power Pole		*Underground Power Line	
Telephone Pole		*Underground Telephone Cable	
Joint Use Pole		*Underground Telephone Conduit	
Utility Pole		*Underground Fiber Optics Telephone Cable	
Utility Pole with Base		*Underground TV Cable	
H-Frame Pole		*Underground Fiber Optics TV Cable	
Power Transmission Line Tower		*Underground Gas Pipeline	
Water Manhole		Aboveground Gas Pipeline	
Power Manhole		*Underground Water Line	
Telephone Manhole		Aboveground Water Line	
Sanitary Sewer Manhole		*Underground Gravity Sanitary Sewer Line	
Hand Hole for Cable		Aboveground Gravity Sanitary Sewer Line	
Power Transformer		*Underground SS Forced Main Line	
Telephone Pedestal		Underground Unknown Utility Line	
CATV Pedestal		SUE Test Hole	
Gas Valve		Water Meter	
Gas Meter		Water Valve	
Located Miscellaneous Utility Object		Fire Hydrant	
Abandoned According to Utility Records		Sanitary Sewer Cleanout	
End of Information			

\*For Existing Utilities  
 Utility Line Drawn from Record (Type as Shown)   
 Designated Utility Line (Type as Shown)

I:\4\2016\Kernersville Roundabout\Utilities\W5510\_SYM\_U02.dgn





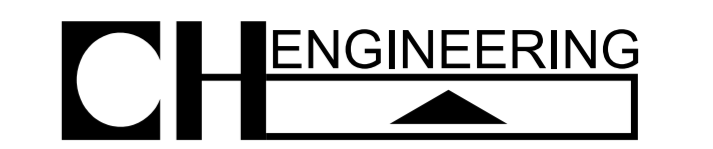



Kimley-Horn  
and Associates, Inc.  
P.O. BOX 33068  
RALEIGH, N.C. 27636-3068

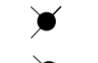
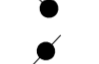
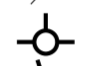

3220 GLEN ROYAL RD. RALEIGH, NC 27617  
TELE 919.788.0224 FAX 919.788.0232  
NC LICENSE #P-0189

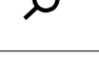
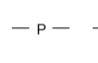
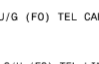
NC GRID NAD 83  
- NAD 2011

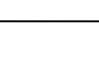
### LEGEND

-  EXISTING JOINT POWER AND TELEPHONE POLE
-  EXISTING POWER POLE
-  EXISTING TELEPHONE POLE
-  PROPOSED JOINT POWER AND TELEPHONE POLE
-  PROPOSED POWER POLE
-  PROPOSED TELEPHONE POLE
-  EXISTING UG TELEPHONE LINE
-  EXISTING OH POWER LINE
-  PROPOSED U/G (FO) TELEPHONE LINE
-  PROPOSED O/H (FO) TELEPHONE LINE
-  PROPOSED UG TELEPHONE LINE
-  PROPOSED O/H TELEPHONE LINE

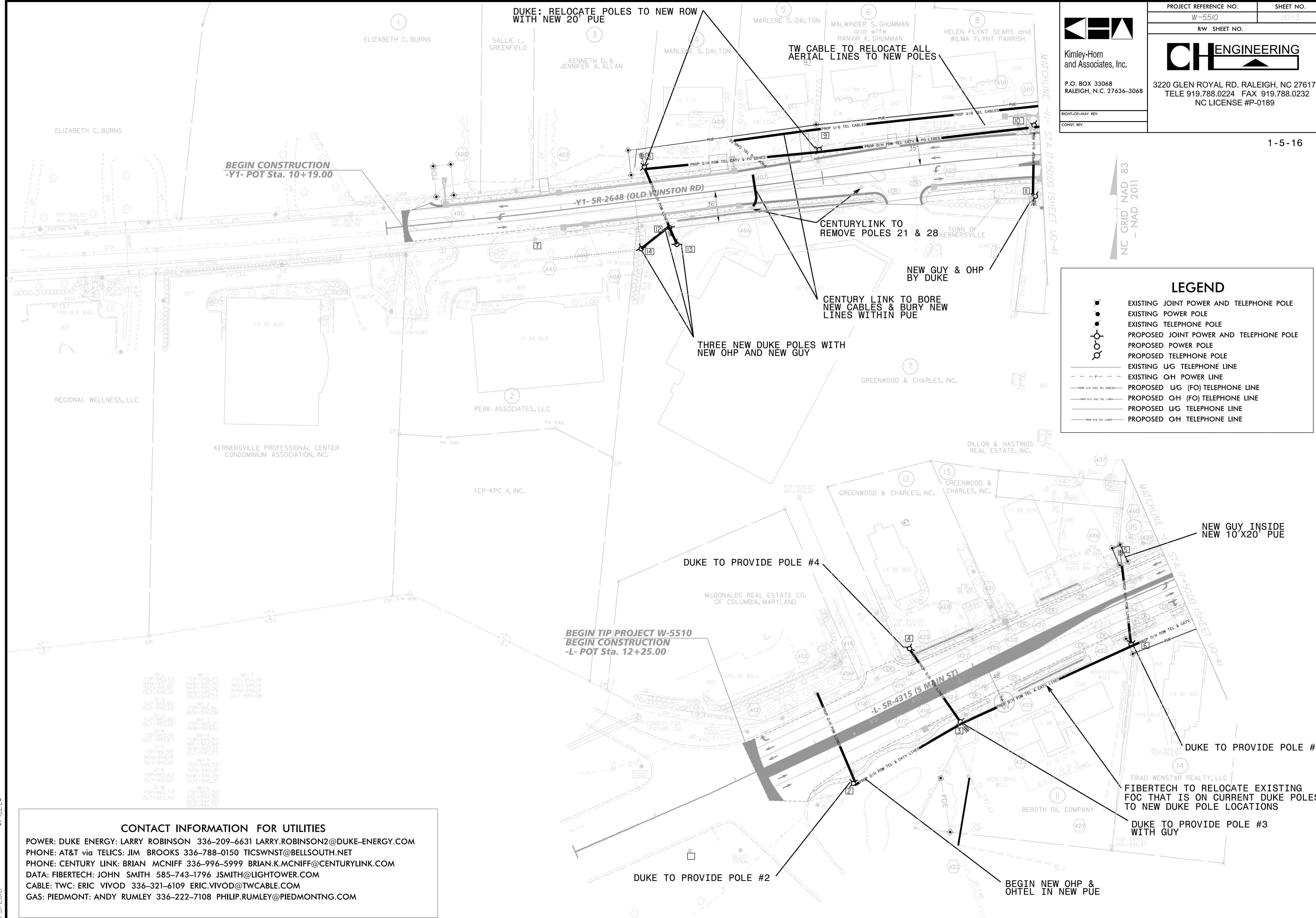

DH-1 TOP=943.93 INWI=937.09 INIE=946.82 OUT=936.94	MH-1 TOP=949.07 INWI=945.40 INIE=949.18 OUT=942.27	MH-7 TOP=954.28 INWI=949.13 INIE=949.08 OUT=949.08
DH-2 TOP=944.66 OUT=940.26	MH-2 TOP=951.96 INWI=946.06	
DH-3 TOP=950.86 OUT=950.26	MH-3 TOP=955.21 INWI=948.21	
DH-4 TOP=953.14 OUT=943.81	MH-4 TOP=949.34 INWI=943.00 OUT=940.77	
DH-5 TOP=951.50 INWI=948.19 OUT=948.15	MH-5 TOP=948.33 INWI=940.18 OUT=940.15	
DH-6 TOP=953.82 OUT=951.52	MH-6 TOP=950.00 INWI=944.95 INIE=944.80 OUT=944.15	
DH-8 TOP=965.74 OUT=963.44		

**CONTACT INFORMATION FOR UTILITIES**  
 POWER: DUKE ENERGY: LARRY ROBINSON 336-209-6631 LARRY.ROBINSON2@DUKE-ENERGY.COM  
 PHONE: AT&T via TELICS: JIM BROOKS 336-788-0150 TICSWNST@BELLSOUTH.NET  
 PHONE: CENTURY LINK: BRIAN MCNIFF 336-996-5999 BRIAN.K.MCNIFF@CENTURYLINK.COM  
 DATA: FIBERTECH: JOHN SMITH 585-743-1796 JSMITH@LIGHTOWER.COM  
 CABLE: TWC: ERIC VIVOD 336-321-6109 ERIC.VIVOD@TWCABLE.COM  
 GAS: PIEDMONT: ANDY RUMLEY 336-222-7108 PHILIP.RUMLEY@PIEDMONTNG.COM

\$FILEL\$  
1/5/2016

**CONTACT INFORMATION FOR UTILITIES**

POWER: DUKE ENERGY: LARRY ROBINSON 336-209-6631 LARRY.ROBINSON2@DUKE-ENERGY.COM  
 PHONE: AT&T via TELICS: JIM BROOKS 336-788-0150 TICSWNST@BELLSOUTH.NET  
 PHONE: CENTURY LINK: BRIAN MCNIFF 336-996-5999 BRIAN.K.MCNIFF@CENTURYLINK.COM  
 DATA: FIBERTECH: JOHN SMITH 585-743-1796 JSMITH@LIGHTTOWER.COM  
 CABLE: TWC: ERIC VIVOD 336-321-6109 ERIC.VIVOD@TWCABLE.COM  
 GAS: PIEDMONT: ANDY RUMLEY 336-222-7108 PHILIP.RUMLEY@PIEDMONTNG.COM

FIBERTECH TO PLACE OH CABLES ON NEW POLES

CENTURYLINK TO BURY LINES BENEATH FUTURE SIDEWALK

TW CABLE TO PLACE OH CABLES ON NEW POLES

AT&T TO PLACE OH TEL ON NEW POLES

BEGIN CONSTRUCTION  
 -Y2- POT STA 18+28.10

DUKE TO RELOCATE POLES TO NEW ROW

APPROXIMATE PROPOSED UTILITY EASEMENT (NOT BY NCDOT)

CENTURYLINK TO BURY LINES

DUKE TO SET NEW POLE AT NEW ROW

CENTURYLINK TO REMOVE POLES 52 & 68

OLD WINSTON ROAD (PUBLIC ROW VARIES) N RD

DUKE TO SET NEW POLE IN EASEMENT

BEGIN CONSTRUCTION  
 -Y4- POT STA 10+77.09 TWO PHASE

END NCDOT PROJECT

OUTPARCEL 2  
 2.05 AC. +/- TWO PHASE

CENTURYLINK TO REMOVE POLES 47, 48 & 51

NEW GUY POLE BY DUKE

OUTPARCEL 1  
 0.98 AC. +/- TWO PHASE

SOUTH MAIN STREET (PUBLIC ROW VARIES)

END TIP PROJECT W-5510  
 END CONSTRUCTION  
 -L- POC Sta. 28+70.00

DUKE TO RELOCATE POLES SALLIE L. GREENFIELD

DUKE TO SET POLE AT ROW WITH GUY IN 10'X20' PUE

NEW 20' AUE  
 TW CABLE TO PLACE OH CABLES ON NEW POLES

DUKE TO RELOCATE POLES

DUKE TO RELOCATE POLES

END CONSTRUCTION  
 -Y1- POT STA 26+55.29

FIBERTECH TO RELOCATE EXISTING FOC THAT IS ON CURRENT DUKE POLES TO NEW DUKE POLE LOCATIONS

DUKE TO RELOCATE POLES TO NEW ROW

NEW 20' AUE

PROJECT REFERENCE NO. W-5510	SHEET NO. 00-4
RW SHEET NO.	
<b>CH ENGINEERING</b>	
Kimley-Horn and Associates, Inc.	
P.O. BOX 33068 RALEIGH, N.C. 27636-3068	3220 GLEN ROYAL RD. RALEIGH, NC 27617 TELE 919.788.0224 FAX 919.788.0232 NC LICENSE #P-0189
RIGHT-OF-WAY REV.	
CONST. REV.	

**LEGEND**

- EXISTING JOINT POWER AND TELEPHONE POLE
- EXISTING POWER POLE
- EXISTING TELEPHONE POLE
- PROPOSED JOINT POWER AND TELEPHONE POLE
- PROPOSED POWER POLE
- PROPOSED TELEPHONE POLE
- EXISTING U/G POWER LINE
- EXISTING OH POWER LINE
- PROPOSED U/G (FO) TELEPHONE LINE
- PROPOSED OH (FO) TELEPHONE LINE
- PROPOSED U/G TELEPHONE LINE
- PROPOSED OH TELEPHONE LINE

\$FILEL\$  
1/5/2016

**CONTACT INFORMATION FOR UTILITIES**

POWER: DUKE ENERGY: LARRY ROBINSON 336-209-6631 LARRY.ROBINSON2@DUKE-ENERGY.COM  
 PHONE: AT&T via TELICS: JIM BROOKS 336-788-0150 TICSWNST@BELLSOUTH.NET  
 PHONE: CENTURY LINK: BRIAN MCNIFF 336-996-5999 BRIAN.K.MCNIFF@CENTURYLINK.COM  
 DATA: FIBERTECH: JOHN SMITH 585-743-1796 JSMITH@LIGHTTOWER.COM  
 CABLE: TWC: ERIC VIVOD 336-321-6109 ERIC.VIVOD@TWCABLE.COM  
 GAS: PIEDMONT: ANDY RUMLEY 336-222-7108 PHILIP.RUMLEY@PIEDMONTNG.COM



Kimley-Horn  
and Associates, Inc.

P.O. BOX 33068  
RALEIGH, N.C. 27636-3068

RIGHT-OF-WAY REV.  
CONST. REV.



3220 GLEN ROYAL RD. RALEIGH, NC 27617  
TELE 919.788.0224 FAX 919.788.0232  
NC LICENSE #P-0189

PROJECT REFERENCE NO. W-55/0  
SHEET NO. 00-5  
RW SHEET NO.

NC GRID NAD 83  
- NAD 2011

END CONSTRUCTION  
-Y4- POC Sta. 15+90.00

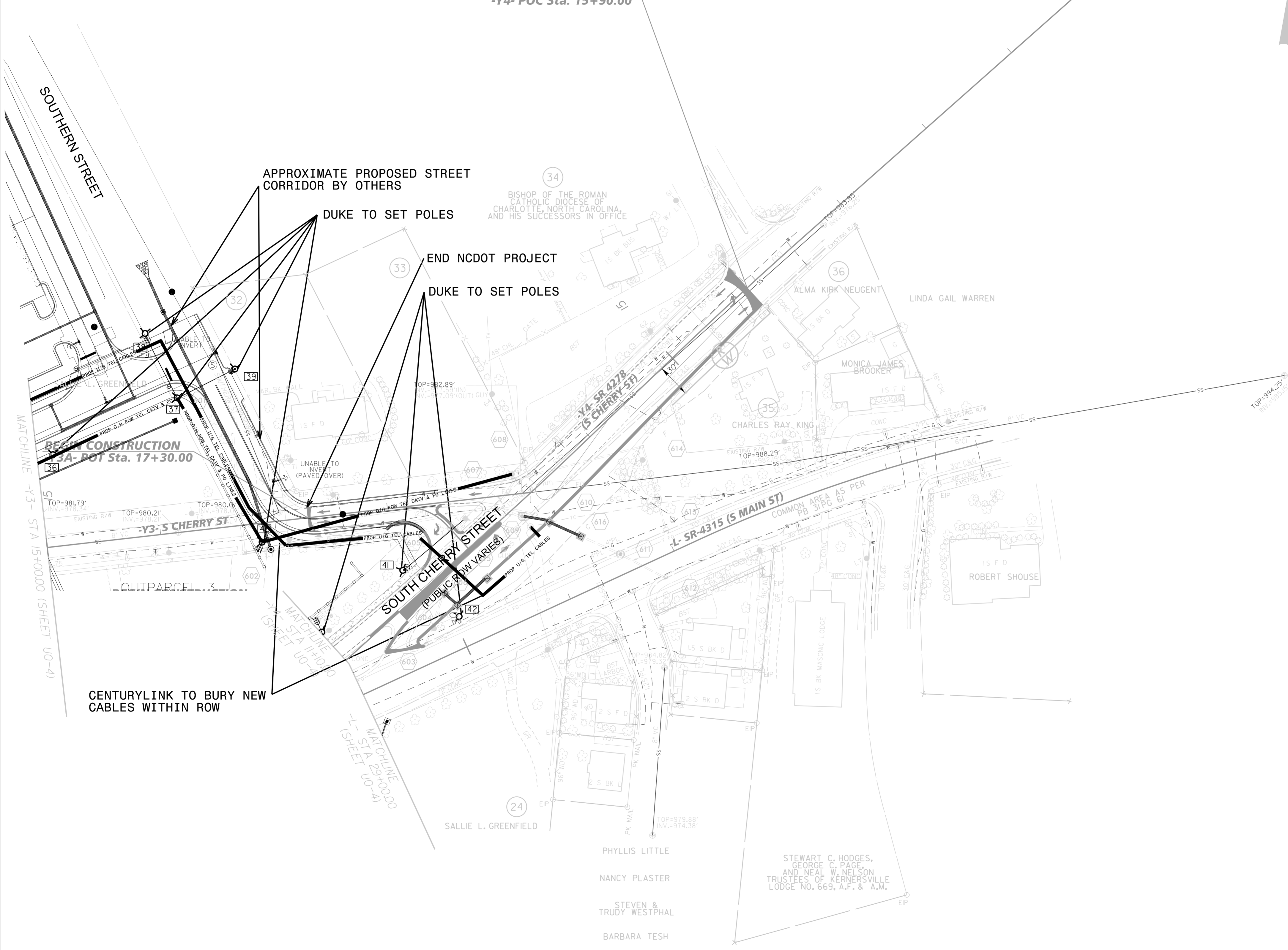

CENTURYLINK TO BURY NEW  
CABLES WITHIN ROW

APPROXIMATE PROPOSED STREET  
CORRIDOR BY OTHERS

DUKE TO SET POLES

END NCDOT PROJECT

DUKE TO SET POLES

BEGIN CONSTRUCTION  
-Y3A- POC Sta. 17+30.00

**LEGEND**

- EXISTING JOINT POWER AND TELEPHONE POLE
- EXISTING POWER POLE
- EXISTING TELEPHONE POLE
- PROPOSED JOINT POWER AND TELEPHONE POLE
- PROPOSED POWER POLE
- PROPOSED TELEPHONE POLE
- EXISTING UG TELEPHONE LINE
- EXISTING OH POWER LINE
- PROPOSED UG (FO) TELEPHONE LINE
- PROPOSED OH (FO) TELEPHONE LINE
- PROPOSED UG TELEPHONE LINE
- PROPOSED OH TELEPHONE LINE

1/5/2016 \$FILEL\$