

Kimley»Horn
 P.O. BOX 33068
 RALEIGH, N.C. 27636-3068

PROJECT REFERENCE NO. W-5510 SHEET NO. 6
 R/W SHEET NO.

ROADWAY DESIGN ENGINEER HYDRAULICS ENGINEER

DocuSigned by:
 Matt West
 ACT1A1D0798425 1/4/2016

DocuSigned by:
 Larry Robinson
 CE178297105643E 1/4/2016

**DOCUMENT NOT CONSIDERED FINAL
 UNLESS ALL SIGNATURES COMPLETED**

-Y3A-	-Y4-	-Y4-
PI Sta 18+35.45 Δ = 53° 56' 48.9" (RT) D = 114' 35' 29.6" L = 47.08' T = 25.45' R = 50.00'	PI Sta 13+43.21 Δ = 1° 34' 12.7" (LT) D = 1° 55' 21.6" L = 81.67' T = 40.84' R = 2.980.00'	PI Sta 15+84.25 Δ = 2° 12' 03.5" (RT) D = 1° 25' 56.6" L = 153.66' T = 76.84' R = 4.000.00'

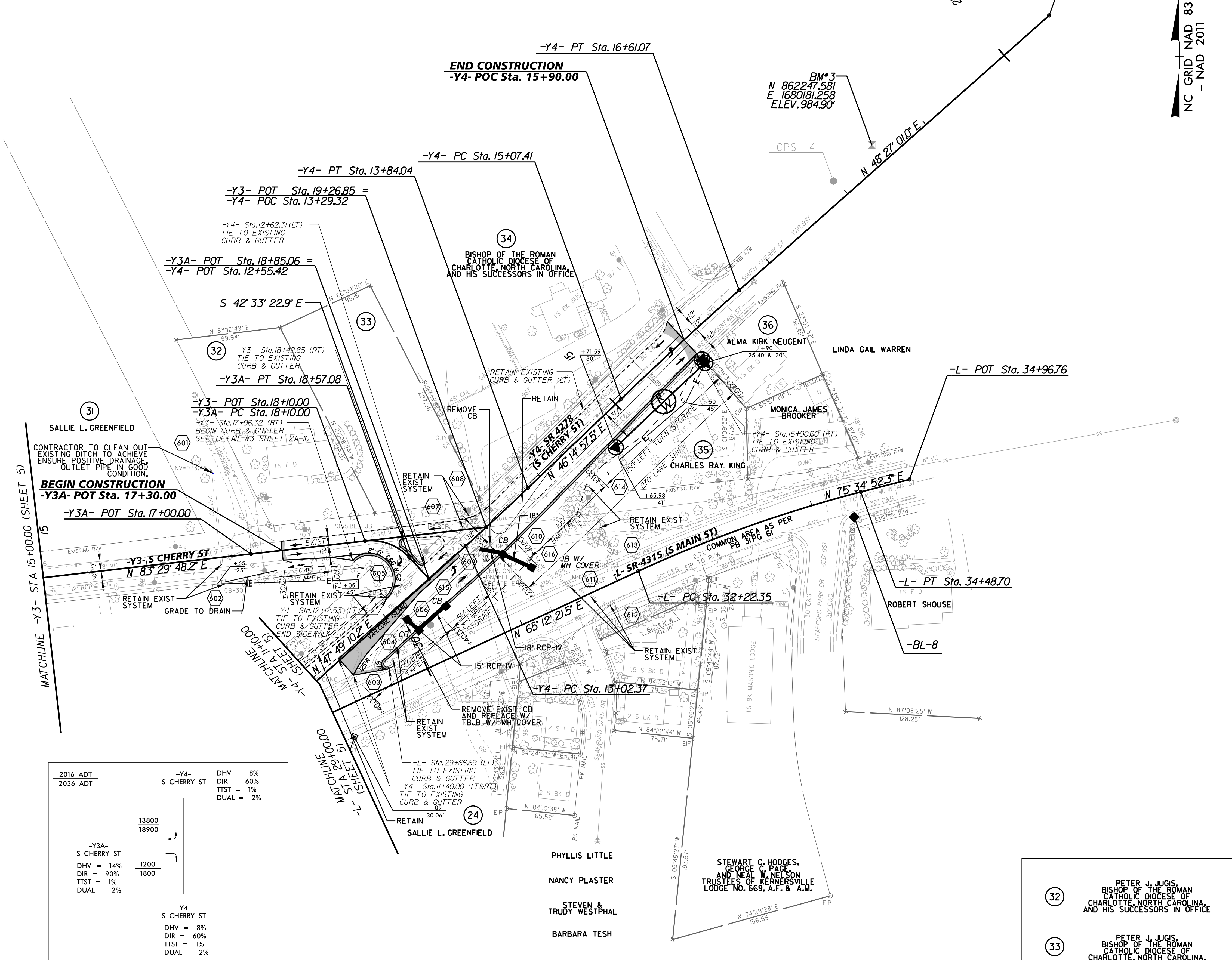

2016 ADT 2036 ADT	-Y4- S CHERRY ST	DHV = 8% DIR = 60% TTST = 1% DUAL = 2%
-Y3A- S CHERRY ST	-Y4- S CHERRY ST	DHV = 8% DIR = 60% TTST = 1% DUAL = 2%

CB-27 TOP=984.26' OUT=979.87'	MH-10 TOP=982.42' IN(E)=979.86' INV=978.59'	DI-7 TOP=983.12' IN(S)=981.08' OUT=981.01'
CB-28 TOP=981.79' IN(S)=978.16' OUT=978.08'	MH-11 TOP=987.02' IN(S)=983.73' OUT=980.67'	
CB-29 TOP=981.33' IN(W)=977.42' IN(S)=977.41' OUT=977.26'		
CB-30 TOP=979.76' IN(E)=976.19' OUT=976.13'		
CB-31 TOP=982.78' IN(E)=980.41' OUT=980.39'		
CB-32 TOP=982.67' IN(E)=979.80' OUT=979.49'		
CB-33 TOP=987.76' OUT=984.32'		

**SEE SHEET NO. 7 FOR -L- PROFILE
 SEE SHEET NO. 8 FOR -Y1- PROFILE
 SEE SHEET NO. 9 FOR -Y2- PROFILE
 SEE SHEET NO. 9 FOR -Y3- PROFILE
 SEE SHEET NO. 9 FOR -Y3A- PROFILE
 SEE SHEET NO. 10 FOR -Y4- PROFILE**

OBLITERATION OF EXISTING ASPHALT PAVEMENT

(32) PETER J. JUGIS
 BISHOP OF THE ROMAN CATHOLIC DIOCESE OF CHARLOTTE, NORTH CAROLINA AND HIS SUCCESSORS IN OFFICE

(33) PETER J. JUGIS
 BISHOP OF THE ROMAN CATHOLIC DIOCESE OF CHARLOTTE, NORTH CAROLINA AND HIS SUCCESSORS IN OFFICE

K:\VAL_Roadway\01036245 - Kerneville\Roadway\Pro\W5510_RDY_PSH06.dgn 12/22/2015