

PROJECT REFERENCE NO. B-4490	SHEET NO. EC-6/CONST.6
RW SHEET NO.	
ROADWAY DESIGN ENGINEER	HYDRAULICS ENGINEER

NOTE:  
UTILIZE FABRIC INSERT INLET PROTECTION DEVICE IN LIEU OF ROCK INLET SEDIMENT TRAP TYPE C AT LOCATIONS WHERE RIST-C CANNOT BE PROPERLY INSTALLED OR IN AREAS WHERE RIST-C MAY POND WATER ON ROADWAY OPEN TO TRAFFIC.

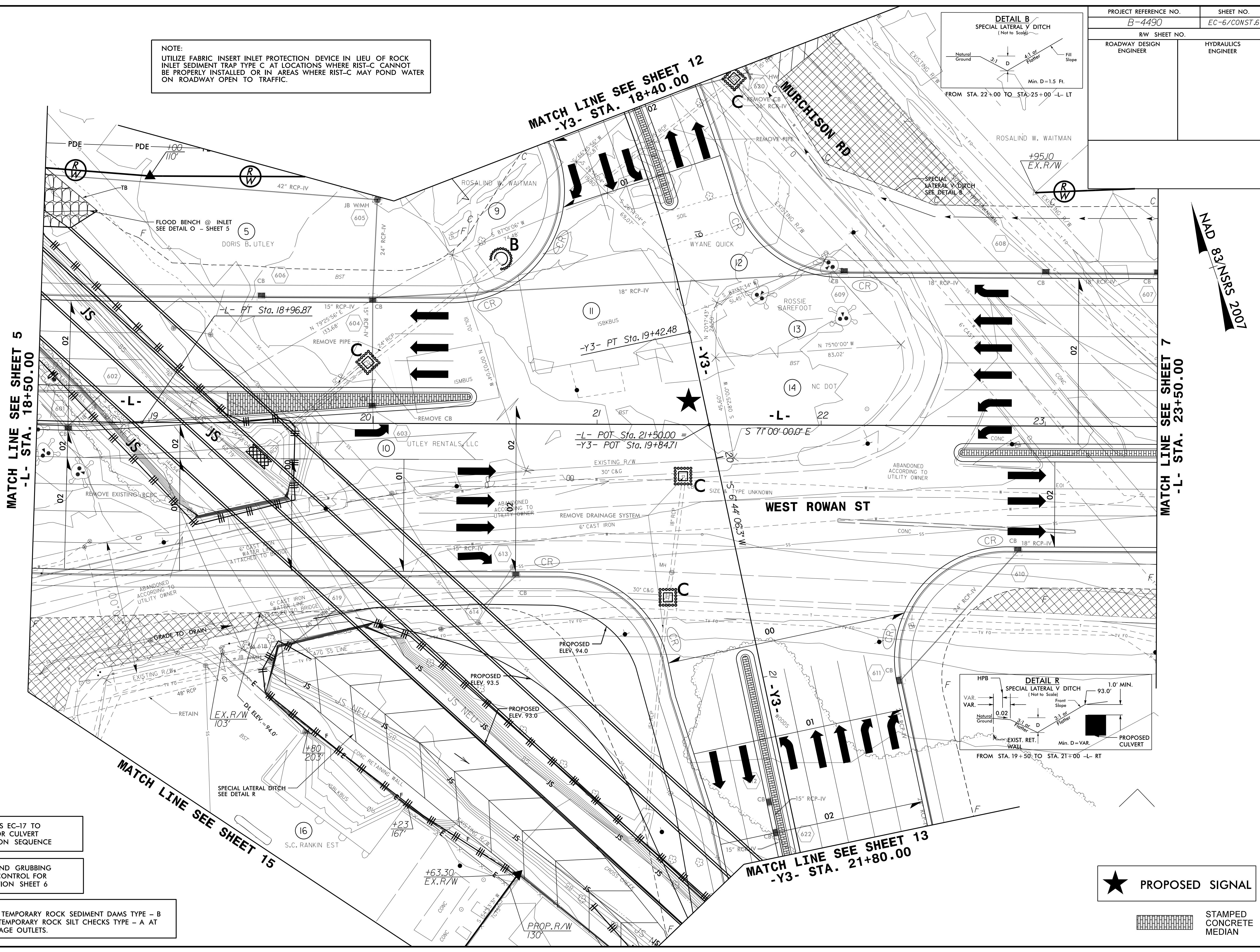
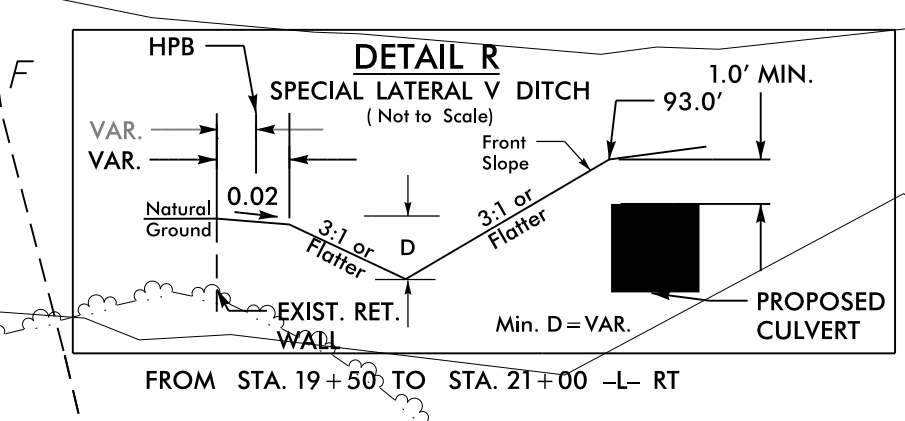
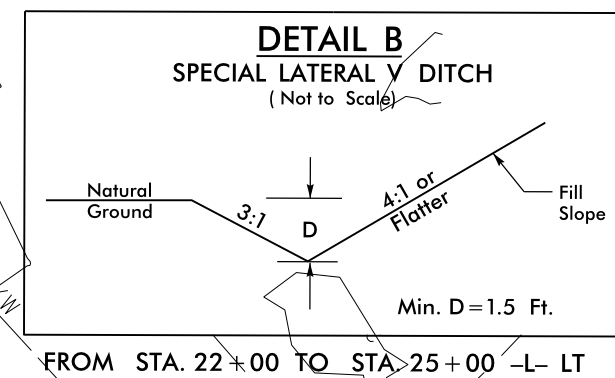

NAD 83/NSRS 2007

SEE SHEETS EC-17 TO EC-22 FOR CULVERT CONSTRUCTION SEQUENCE

CLEARING AND GRUBBING EROSION CONTROL FOR CONSTRUCTION SHEET 6

NOTE:  
PLACE TEMPORARY ROCK SEDIMENT DAMS TYPE - B AND TEMPORARY ROCK SILT CHECKS TYPE - A AT DRAINAGE OUTLETS.

★ PROPOSED SIGNAL

STAMPED CONCRETE MEDIAN

8/17/99  
21-AUG-2015 15:37  
R:\Projects\B4490\Drawings\B4490-EC-psch\_06.dgn  
REVISIONS: 1  
REV: 1  
DATE: 8/17/99